

- NOTES**
1. THE STRUCT. STEEL AND FINISHING SEE STRUCTURAL DRAWINGS.
 2. THE FINISH DRAWINGS SEE MECH DWGS IN OTHER DIVISIONS.
 3. DIMENSIONS TO FACE UNLESS OTHERWISE NOTED.
 4. EXISTING WORK IS TO BE PRESERVED AND REPAIRED AS NECESSARY.
 5. EXISTING WORK IS TO BE DEMOLISHED AND RECONSTRUCTED AS NECESSARY.
 6. EXISTING WORK IS TO BE REPAIRED AND FINISHED AS NECESSARY.

Heery Adams, Inc.
Mech./Elect. Engineers

Gaudreau, Inc.
Architectural Engineers

McCormick & Company
CORPORATE HEADQUARTERS
LOVETON BUSINESS CENTER
BALTIMORE COUNTY, MARYLAND

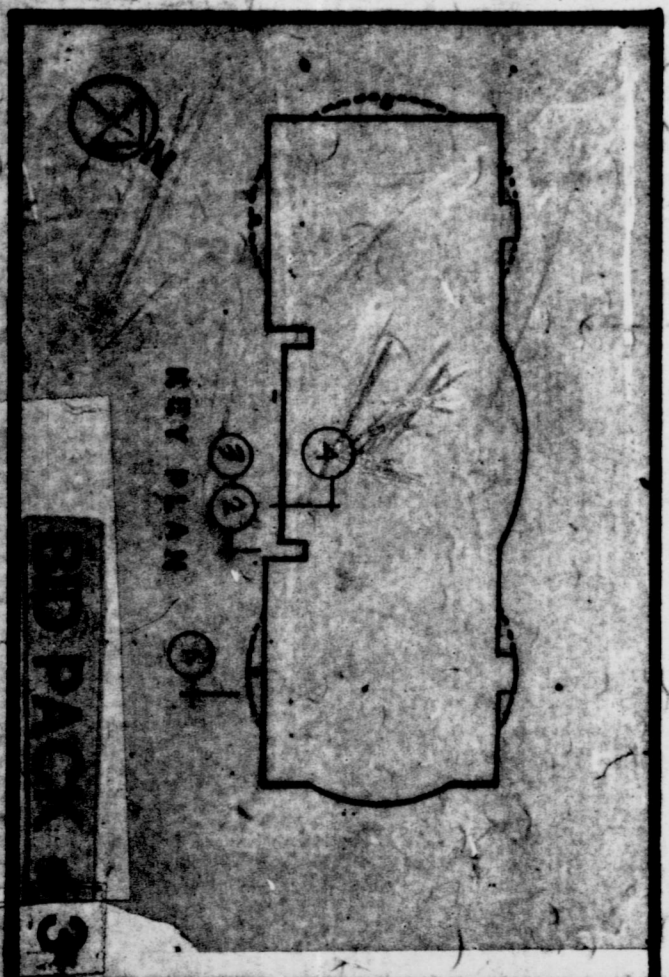

REVISIONS		WALL SECTIONS	
NO.	DATE	DESCRIPTION	BY
1	11-14-78	ISSUED FOR PERMITS	WJ
2	11-17-78	REVISED	WJ
3	1-3-79	REVISED	WJ

PROJ. NO. 8914.10
DATE 08/14/78
DWG. NO. A-19