

- SECTION NOTES:** (WHEN TOOK TO DRAW E-3)
1. PACE THROUGH FROM A NORMAL POWER CIRCUIT AND VOICE/DATA WIRING THIS FURNITURE. EXACT LOCATION SHALL BE COORDINATED WITH SYSTEMS MANUFACTURER. SEE DETAIL 4/E-13.
  2. MOUNT DOUBLE DUPLEX RECEPTACLE 72" AFF ON TTB.
  3. MOUNT RECEPTACLE BEHIND UNDERCOUNTER REFRIGERATOR.
  4. MOUNT RECEPTACLE FOR COFFEE MAKER 6" ABOVE COUNTER BACKSPLASH.
  5. MOUNT RECEPTACLE FOR TOASTER 6" ABOVE COUNTER ON TABLE TOP AS REQUIRED.
  6. MOUNT 6" ABOVE TABLE TOP.
  7. HAVE NORMAL POWER AND VOICE/DATA CONNECTION TO SYSTEMS FURNITURE AS DIRECTED BY SYSTEMS FURNITURE MANUFACTURER. SEE DETAIL 4/E-13.
  8. PROVIDE 8" x 12" IN 3/4" C. LIGHT WIRE SHALL INCLUDE 3" x 6" PHASE WIRE. 3" x 6" METALLIC WIRE AND 2" x 4" BONDING WIRE. SEE DETAIL 4/E-13.
  9. MOUNT RECEPTACLE BEHIND UNDERCOUNTER REFRIGERATOR.
  10. MOUNT RECEPTACLE BEHIND UNDERCOUNTER REFRIGERATOR.
  11. MOUNT RECEPTACLE BEHIND UNDERCOUNTER REFRIGERATOR.
  12. MOUNT ALL DEVICES 6" ABOVE TABLE TOP IN THIS ROOM.
  13. MOUNT 48" AFF ADJACENT TO LIGHT SWITCH.
  14. MOUNT 48" AFF.
  15. MOTOR FURNISHED WITH ELECTRICALLY OPERATED CURTAIN. EXACT LOCATION OF MOTOR TO BE COORDINATED WITH MANUFACTURER.
  16. MOUNT TWO REMOTE CONTROL SWITCHES FOR CURTAINS FURNISHED BY MANUFACTURER ON WALL 48" AFF ADJACENT TO SWITCHES FOR BLINDS.
  17. MOTOR FURNISHED WITH ELECTRICALLY OPERATED BLIND. EXACT LOCATION OF MOTOR TO BE COORDINATED WITH MANUFACTURER.
  18. MOUNT FOUR REMOTE CONTROL SWITCHES FOR BLINDS FURNISHED BY MANUFACTURER ON WALL 48" AFF ADJACENT TO SWITCHES FOR BLINDS.
  19. MOUNT 48" AFF.
  20. MOUNT 48" AFF.
  21. SEE DETAIL 9/E-13 FOR EXACT LOCATION OF ELECTRICAL EQUIPMENT.
  22. SEE DETAIL 10/E-13 FOR EXACT LOCATION OF ELECTRICAL EQUIPMENT.
  23. MOUNT 48" AFF.
  24. 15(A)-C-4E. ROUTE IN EAST MECHANICAL SHED TO MEZANINE NEXT TO NORTH WALL.
  25. 3P, 30A WESS IN NEAR 1. ENCLOSURE. MOUNT AT UNIT MAINTAINING NATIONAL ELECTRICAL CODE CLEARANCES.
  26. MOUNT 48" AFF.
  27. MOUNT 48" AFF.
  28. MOUNT 48" AFF.
  29. MOUNT 48" AFF.
  30. MOUNT 48" AFF.
  31. MOUNT 48" AFF.
  32. MOUNT 48" AFF.
  33. MOUNT 48" AFF.
  34. MOUNT 48" AFF.
  35. MOUNT 48" AFF.
  36. MOUNT 48" AFF.
  37. MOUNT 48" AFF.
  38. MOUNT 48" AFF.
  39. MOUNT 48" AFF.
  40. MOUNT 48" AFF.
  41. MOUNT 48" AFF.
  42. MOUNT 48" AFF.
  43. MOUNT 48" AFF.
  44. MOUNT 48" AFF.
  45. MOUNT 48" AFF.
  46. MOUNT 48" AFF.
  47. MOUNT 48" AFF.
  48. MOUNT 48" AFF.
  49. MOUNT 48" AFF.
  50. MOUNT 48" AFF.
  51. MOUNT 48" AFF.
  52. MOUNT 48" AFF.
  53. MOUNT 48" AFF.
  54. MOUNT 48" AFF.
  55. MOUNT 48" AFF.
  56. MOUNT 48" AFF.
  57. MOUNT 48" AFF.
  58. MOUNT 48" AFF.
  59. MOUNT 48" AFF.
  60. MOUNT 48" AFF.
  61. MOUNT 48" AFF.
  62. MOUNT 48" AFF.
  63. MOUNT 48" AFF.
  64. MOUNT 48" AFF.
  65. MOUNT 48" AFF.
  66. MOUNT 48" AFF.
  67. MOUNT 48" AFF.
  68. MOUNT 48" AFF.
  69. MOUNT 48" AFF.
  70. MOUNT 48" AFF.
  71. MOUNT 48" AFF.
  72. MOUNT 48" AFF.
  73. MOUNT 48" AFF.
  74. MOUNT 48" AFF.
  75. MOUNT 48" AFF.
  76. MOUNT 48" AFF.
  77. MOUNT 48" AFF.
  78. MOUNT 48" AFF.
  79. MOUNT 48" AFF.
  80. MOUNT 48" AFF.
  81. MOUNT 48" AFF.
  82. MOUNT 48" AFF.
  83. MOUNT 48" AFF.
  84. MOUNT 48" AFF.
  85. MOUNT 48" AFF.
  86. MOUNT 48" AFF.
  87. MOUNT 48" AFF.
  88. MOUNT 48" AFF.
  89. MOUNT 48" AFF.
  90. MOUNT 48" AFF.
  91. MOUNT 48" AFF.
  92. MOUNT 48" AFF.
  93. MOUNT 48" AFF.
  94. MOUNT 48" AFF.
  95. MOUNT 48" AFF.
  96. MOUNT 48" AFF.
  97. MOUNT 48" AFF.
  98. MOUNT 48" AFF.
  99. MOUNT 48" AFF.
  100. MOUNT 48" AFF.
  101. MOUNT 48" AFF.
  102. MOUNT 48" AFF.
  103. MOUNT 48" AFF.
  104. MOUNT 48" AFF.
  105. MOUNT 48" AFF.
  106. MOUNT 48" AFF.
  107. MOUNT 48" AFF.
  108. MOUNT 48" AFF.
  109. MOUNT 48" AFF.
  110. MOUNT 48" AFF.
  111. MOUNT 48" AFF.
  112. MOUNT 48" AFF.
  113. MOUNT 48" AFF.
  114. MOUNT 48" AFF.
  115. MOUNT 48" AFF.
  116. MOUNT 48" AFF.
  117. MOUNT 48" AFF.
  118. MOUNT 48" AFF.
  119. MOUNT 48" AFF.
  120. MOUNT 48" AFF.
  121. MOUNT 48" AFF.
  122. MOUNT 48" AFF.
  123. MOUNT 48" AFF.
  124. MOUNT 48" AFF.
  125. MOUNT 48" AFF.
  126. MOUNT 48" AFF.
  127. MOUNT 48" AFF.
  128. MOUNT 48" AFF.
  129. MOUNT 48" AFF.
  130. MOUNT 48" AFF.
  131. MOUNT 48" AFF.
  132. MOUNT 48" AFF.
  133. MOUNT 48" AFF.
  134. MOUNT 48" AFF.
  135. MOUNT 48" AFF.
  136. MOUNT 48" AFF.
  137. MOUNT 48" AFF.
  138. MOUNT 48" AFF.
  139. MOUNT 48" AFF.
  140. MOUNT 48" AFF.
  141. MOUNT 48" AFF.
  142. MOUNT 48" AFF.
  143. MOUNT 48" AFF.
  144. MOUNT 48" AFF.
  145. MOUNT 48" AFF.
  146. MOUNT 48" AFF.
  147. MOUNT 48" AFF.
  148. MOUNT 48" AFF.
  149. MOUNT 48" AFF.
  150. MOUNT 48" AFF.
  151. MOUNT 48" AFF.
  152. MOUNT 48" AFF.
  153. MOUNT 48" AFF.
  154. MOUNT 48" AFF.
  155. MOUNT 48" AFF.
  156. MOUNT 48" AFF.
  157. MOUNT 48" AFF.
  158. MOUNT 48" AFF.
  159. MOUNT 48" AFF.
  160. MOUNT 48" AFF.
  161. MOUNT 48" AFF.
  162. MOUNT 48" AFF.
  163. MOUNT 48" AFF.
  164. MOUNT 48" AFF.
  165. MOUNT 48" AFF.
  166. MOUNT 48" AFF.
  167. MOUNT 48" AFF.
  168. MOUNT 48" AFF.
  169. MOUNT 48" AFF.
  170. MOUNT 48" AFF.
  171. MOUNT 48" AFF.
  172. MOUNT 48" AFF.
  173. MOUNT 48" AFF.
  174. MOUNT 48" AFF.
  175. MOUNT 48" AFF.
  176. MOUNT 48" AFF.
  177. MOUNT 48" AFF.
  178. MOUNT 48" AFF.
  179. MOUNT 48" AFF.
  180. MOUNT 48" AFF.
  181. MOUNT 48" AFF.
  182. MOUNT 48" AFF.
  183. MOUNT 48" AFF.
  184. MOUNT 48" AFF.
  185. MOUNT 48" AFF.
  186. MOUNT 48" AFF.
  187. MOUNT 48" AFF.
  188. MOUNT 48" AFF.
  189. MOUNT 48" AFF.
  190. MOUNT 48" AFF.
  191. MOUNT 48" AFF.
  192. MOUNT 48" AFF.
  193. MOUNT 48" AFF.
  194. MOUNT 48" AFF.
  195. MOUNT 48" AFF.
  196. MOUNT 48" AFF.
  197. MOUNT 48" AFF.
  198. MOUNT 48" AFF.
  199. MOUNT 48" AFF.
  200. MOUNT 48" AFF.

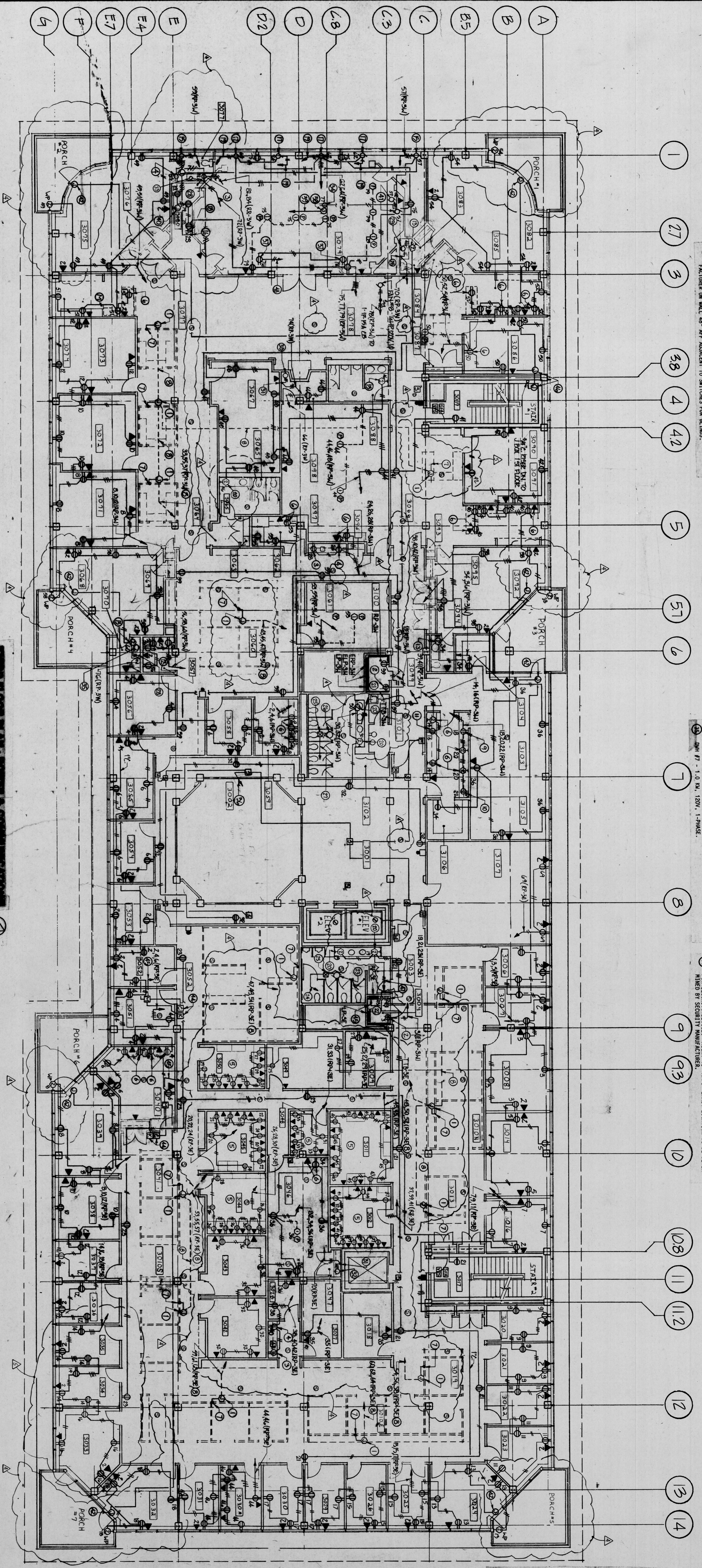

NO.	DATE	DESCRIPTION
1	8/13/70	CONSTRUCTION SET
2	8/14/70	DATE

PROJ. NO.	DWG. NO.
8914.10	E-3
DATE	8/11/70

NO.	DATE	DESCRIPTION
1	8/13/70	CONSTRUCTION SET
2	8/14/70	DATE

**BID PACKAGE #3**

**THIRD FLOOR PLAN**  
**POWER AND COMMUNICATIONS**

**McCormick & Company**  
 CORPORATE HEADQUARTERS  
 LOVETON BUSINESS CENTER  
 BALTIMORE COUNTY, MARYLAND

Henry Adams, Inc.  
 Mech./Elect. Engineers

Faisant Associates, Inc.  
 Structural Engineers

Gaudreau, Inc.  
 Architects/Planners/Engineers  
 Baltimore

810 Light Street Baltimore, Maryland 21202

DATE: 8/11/70

DWG. NO.: E-3

H.A. 208 NO. 1017292