

\* SEE NOTES ON SHEET SIX \*  
**FIRST FLOOR PLAN**  
 1/4" = 1'-0"

APPROXIMATE GROSS SQUARE FEET  
 (HEATED SPACE INCL. ALL WALLS EXCEPT EXT. MASONRY)

MAIN	1545	NON-HEATED/OTHER	
MAST. SUITE	752	SIDE PORCH	272
GUEST WING	671	VERANDA	352
THIS LEVEL	2968	GARAGE	676+
FLOOR 2	1600±	FALCONY	88
TOTAL	4568	LOFT	992
		BASEMENT	N/A

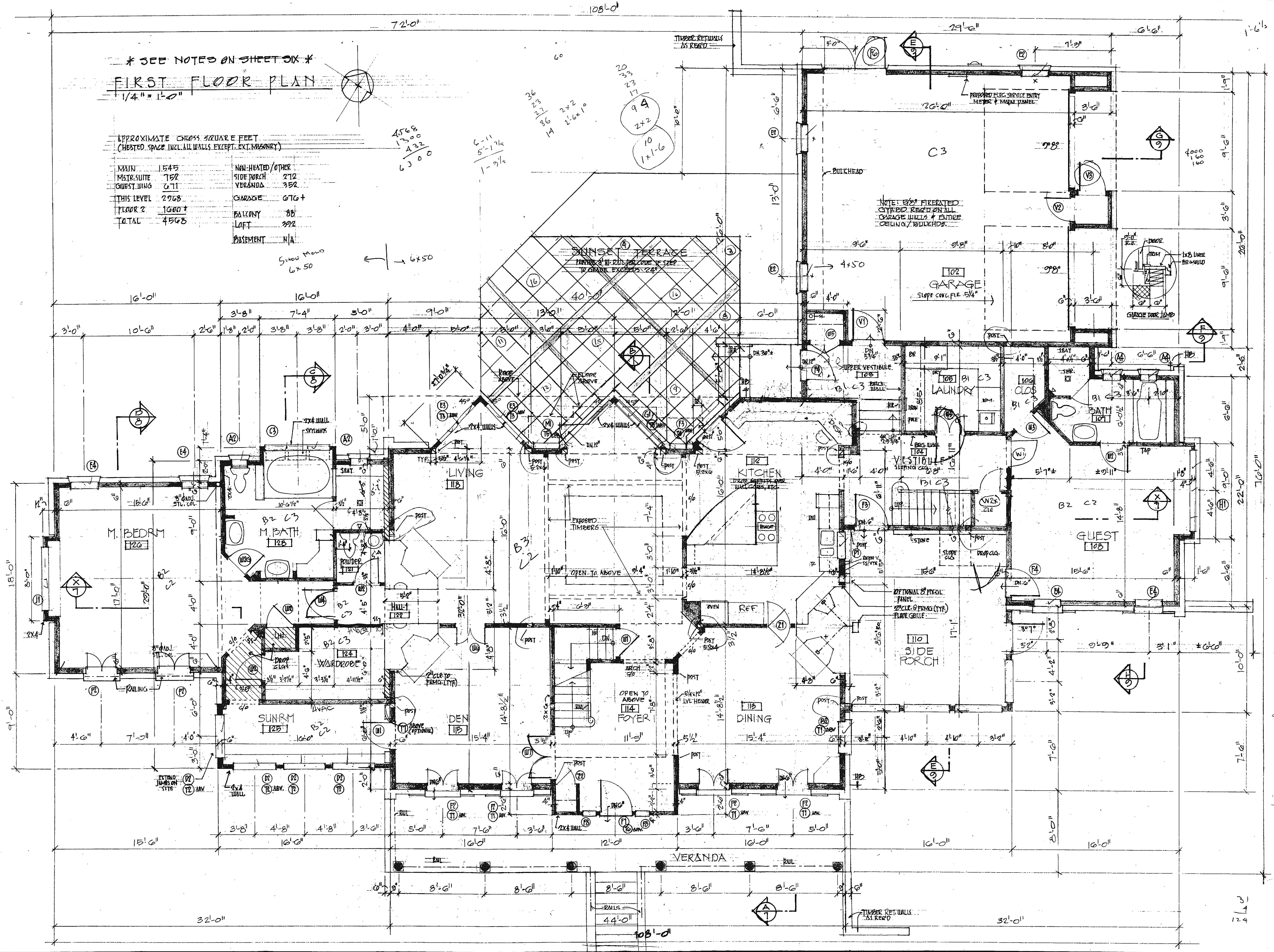

DATE
12. JUNE 2000
18. JULY 2000

PROPOSED NEW SINGLE FAMILY HOME  
 THE DRIPPS RESIDENCE  
 TOWSON - BALTIMORE COUNTY - MD

KMA - KEVIN MCKENNA ARCHITECTS  
 P.O. BOX 722 COLUMBIA MD 21045  
 TEL. 410.381.1717 FAX. 410.381.0929  
 WWW.K.E.A. ARCHITECT.COM



DRAWN
CHECKED
SCALE
JOB NO.
SHEET
THREE
OF SHEETS

COPYRIGHT © 2000: KEVIN MCKENNA ARCHITECTS

DATEPLOT.COM 3000 CLARENCE ST. SAN ANTONIO, TX 78204

STOCKDRAFTING FORM NO. 101-36 RC