

BUILDING SECTION (B)

1/4" = 1'-0"

BUILDING SECTION (A)

1/4" = 1'-0"

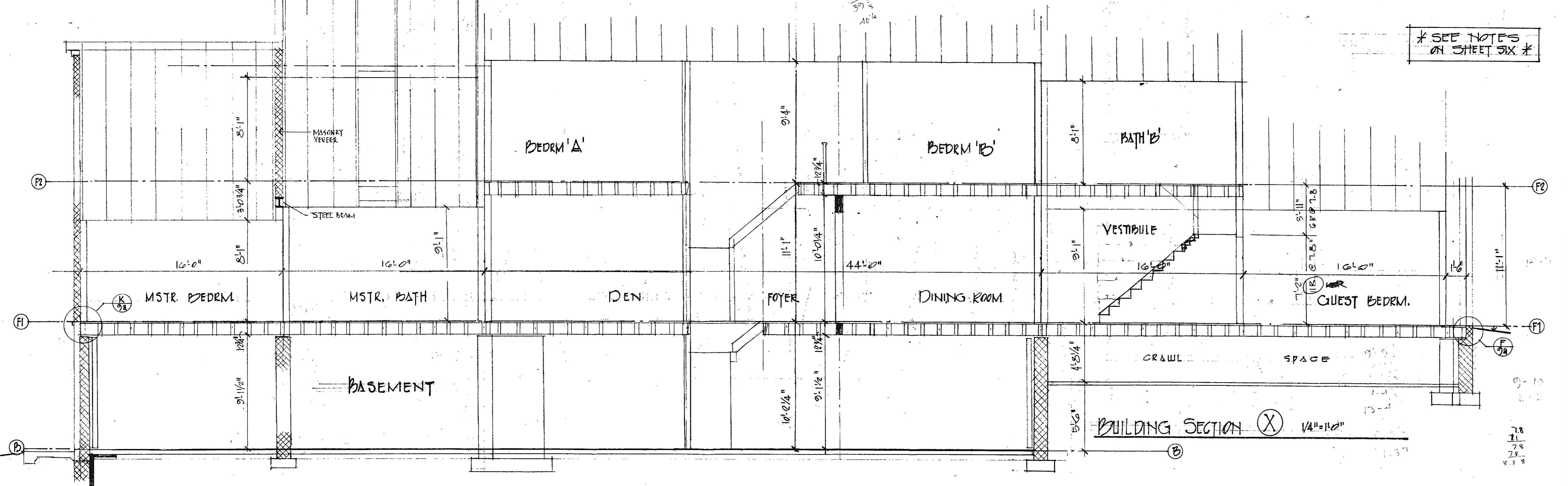
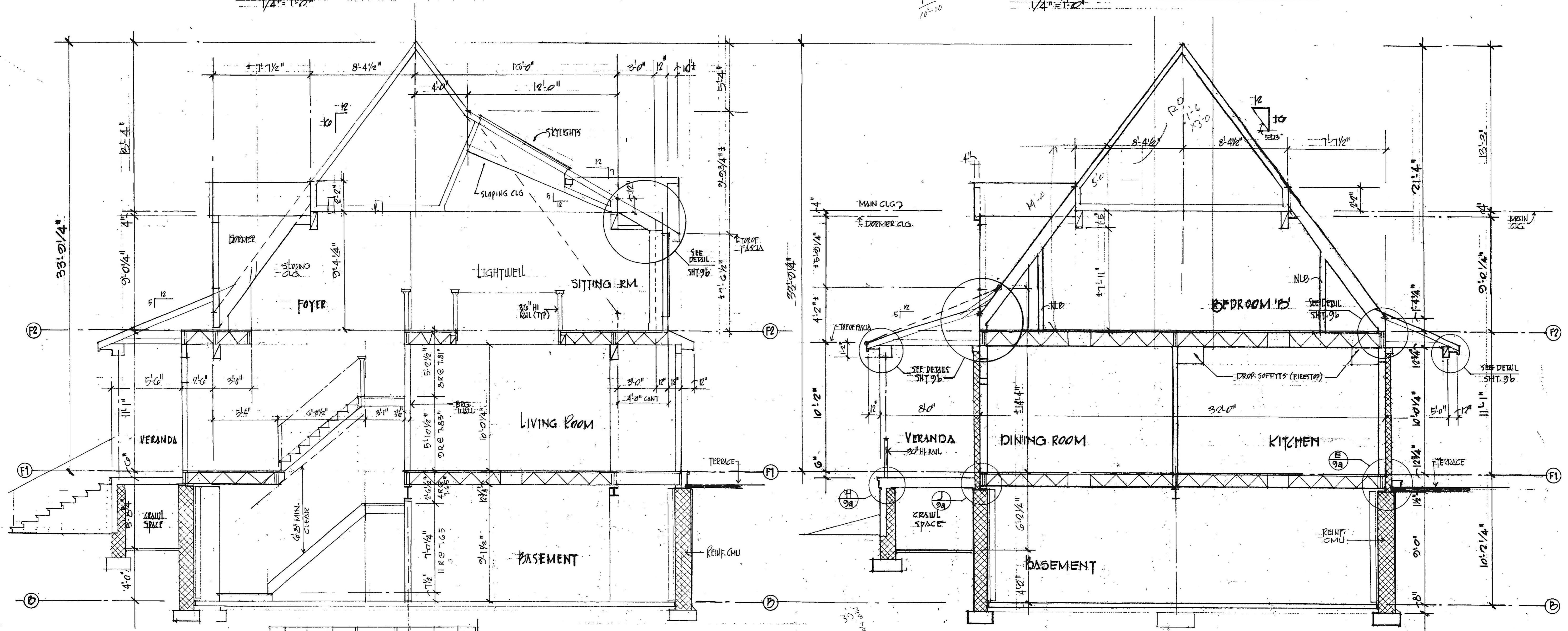

DATES	
12 JUNE 2000	
18 JULY 2000	

PROPOSED NEW SINGLE FAMILY HOME
 THE DRIPPS RESIDENCE
 TOWSON - BALTIMORE COUNTY - MD

KMA - KEVIN MCKENNA ARCHITECTS
 P.O. BOX 722 COLUMBIA MD 21045
 TEL. 410.381.5817 FAX. 410.381.0929
 WWW.KEVINMCKENNA-ARCHITECT.COM

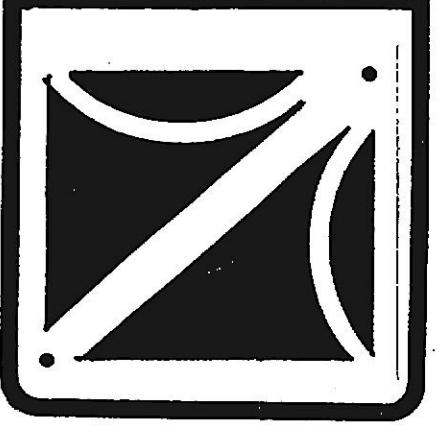

DRAWN
CHECKED
SCALE
JOB NO.
SHEET
SEVEN
OF SHEETS

COPYRIGHT © 2000: KEVIN MCKENNA ARCHITECTS

DATEPLOT COMP. 700 90 CLARENCE ST. SAN MATEO, CA 94062

STOCKDRAFTING FORM NO. 101-32 RC