



ARCHITECTS

9738 Briarcliffe Lane · Ellicott City, Maryland 21042
410.730.4300 Fax 410.988.2174 E-Mail JPCArchitects@verizon.net

Professional Certification:
I certify that these documents were prepared and approved by me, and that I am a duly licensed Architect under the laws of the State of Maryland, License Number #5297-A, Expiration Date: 06/27/2021



Professional Seal and Signature

Proposed Home Plans

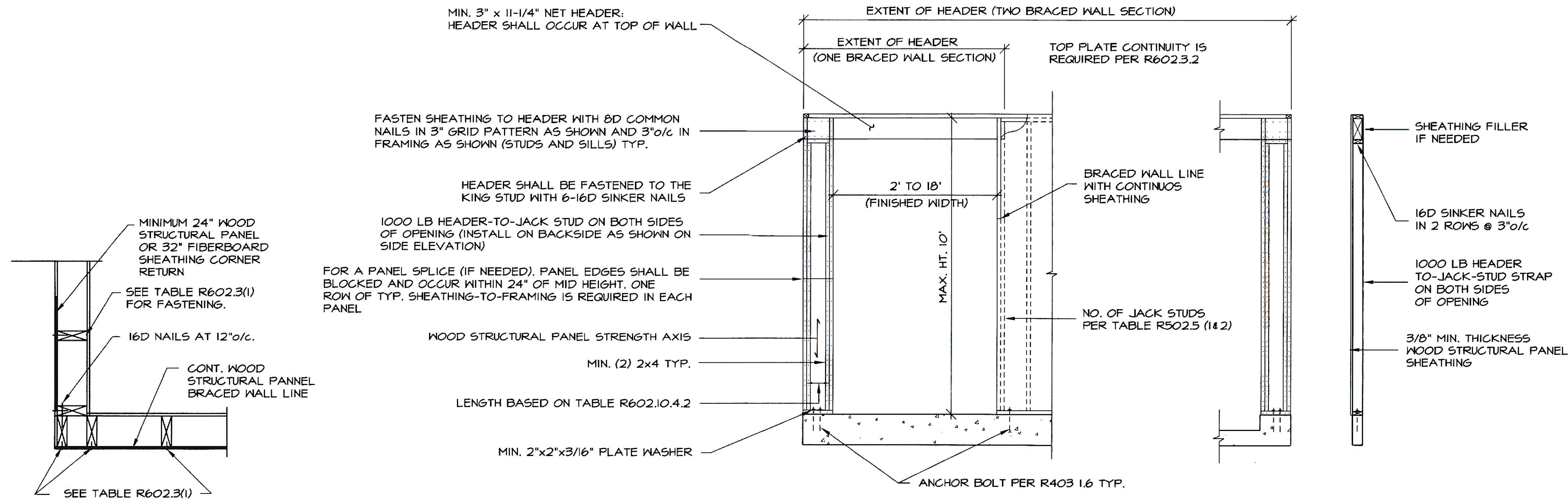

MINIMUM WOOD FASTENING SCHEDULE		
DESCRIPTION	FASTENER	SKETCH
SOLE PLATE TO JOIST OR BLOCKING	16d @ 16"o/c FACE NAIL	
STUD TO SOLE PLATE	(3) 8d TOENAIL OR (2) 16d END NAIL	
TOP PLATE TO STUD	(2) 16d END NAIL	
DOUBLE TOP PLATE	10d @ 24"o/c FACE NAIL	
DOUBLE TOP PLATE SPLICE (MIN. 1'-0\"/>		

- NOTES:
- REFERENCE IBC 2015, TABLE 602.3.1 FOR ADDITIONAL CONNECTIONS AND/OR ALTERNATES
 - ALL NAILS REFERENCED ABOVE REFER TO COMMON BOX NAILS.
 - USE 1/2" PLYWOOD SHEATHING AT ALL EXTERIOR STUDS (TYP.)
 - INSTALL 2x BLOCKING (WIDTH TO MATCH DEPTH OF WALL) MID HEIGHT AT ALL STUD BEARING WALLS (TYP.)
 - PROVIDE PRESSURE TREATED LUMBER FOR ALL PLATES IN CONTACT WITH MASONRY OR CONCRETE
 - PROVIDE DOUBLE JACK STUDS AND DOUBLE FULL HEIGHT STUDS AT ALL OPENINGS SEE DETAIL F/55
 - ALL BUILT UP WOOD POSTS ATTACHED WITH (2)12d NAILS @ 12"o/c

IE TYPICAL CORNER WALL N.T.S.

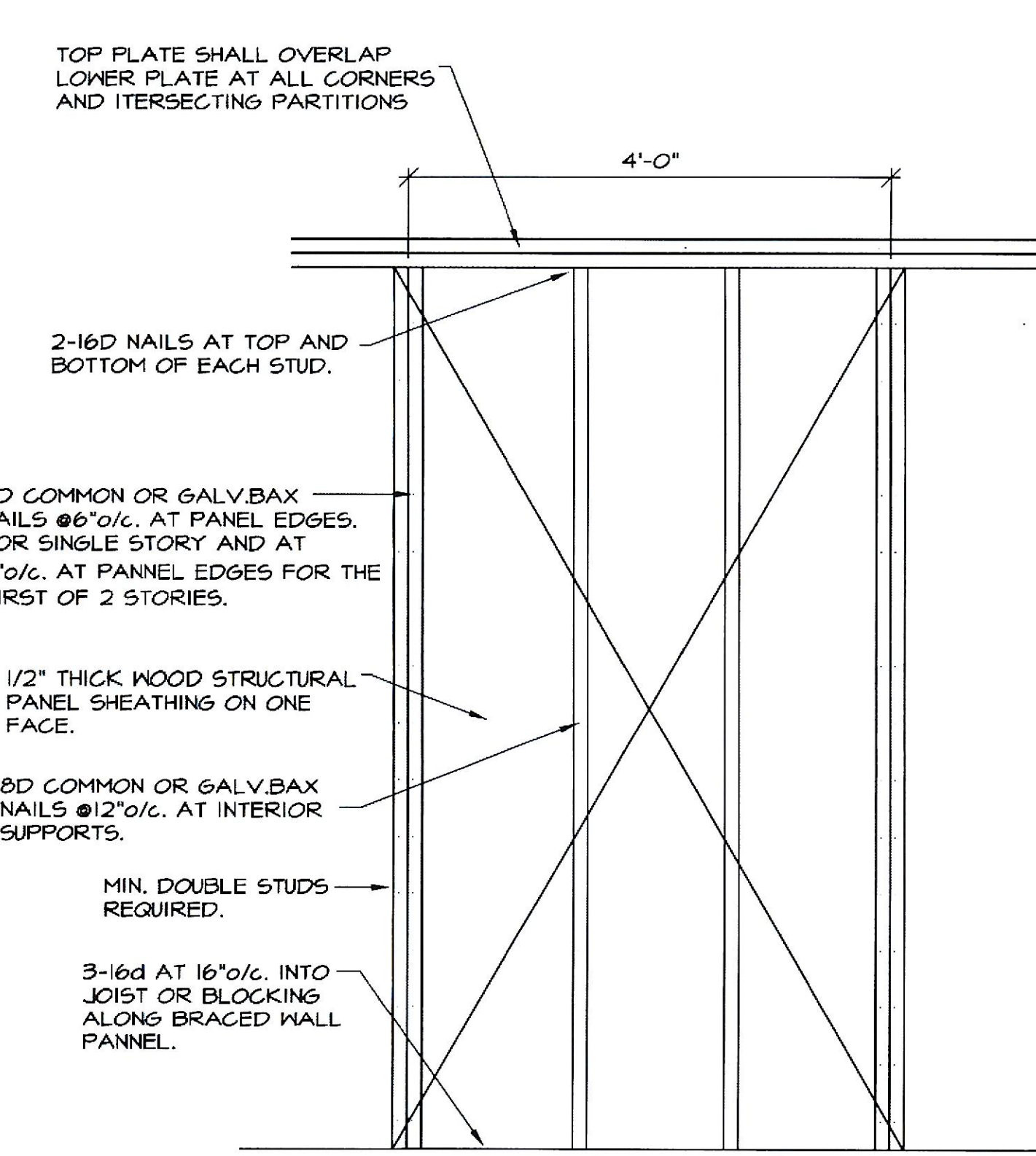

IA OVER CONCRETE OR MASONRY FOUNDATION

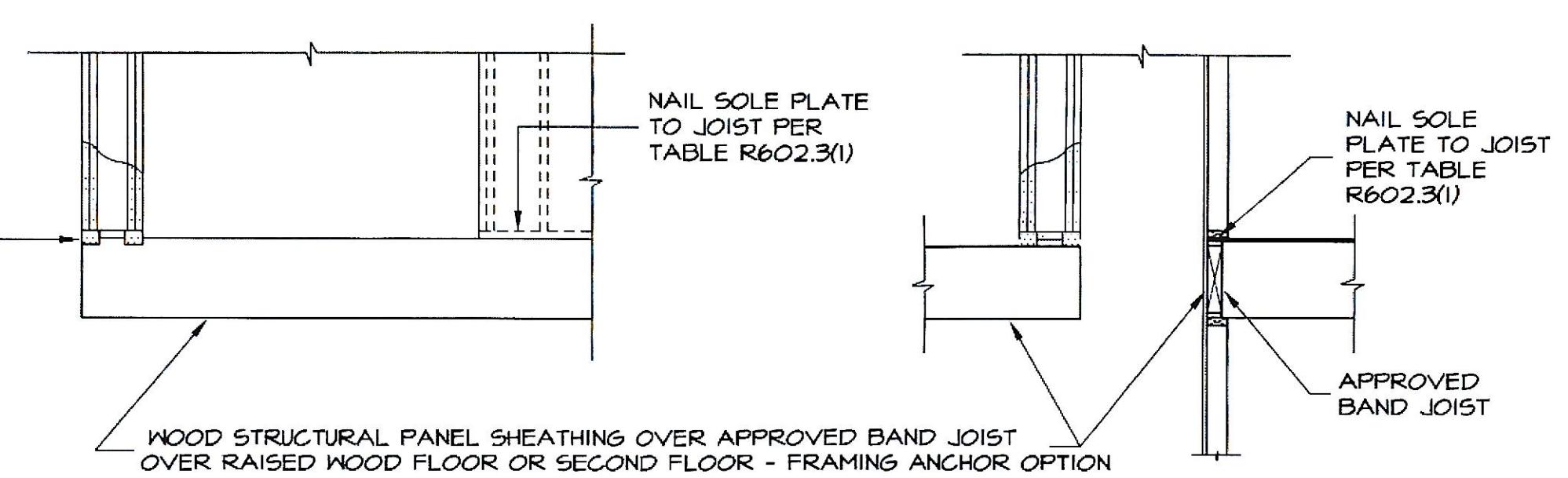

IB OVER RAISED WOOD FLOOR OR SECOND FLOOR FRAMING ANCHOR OPTION "A"

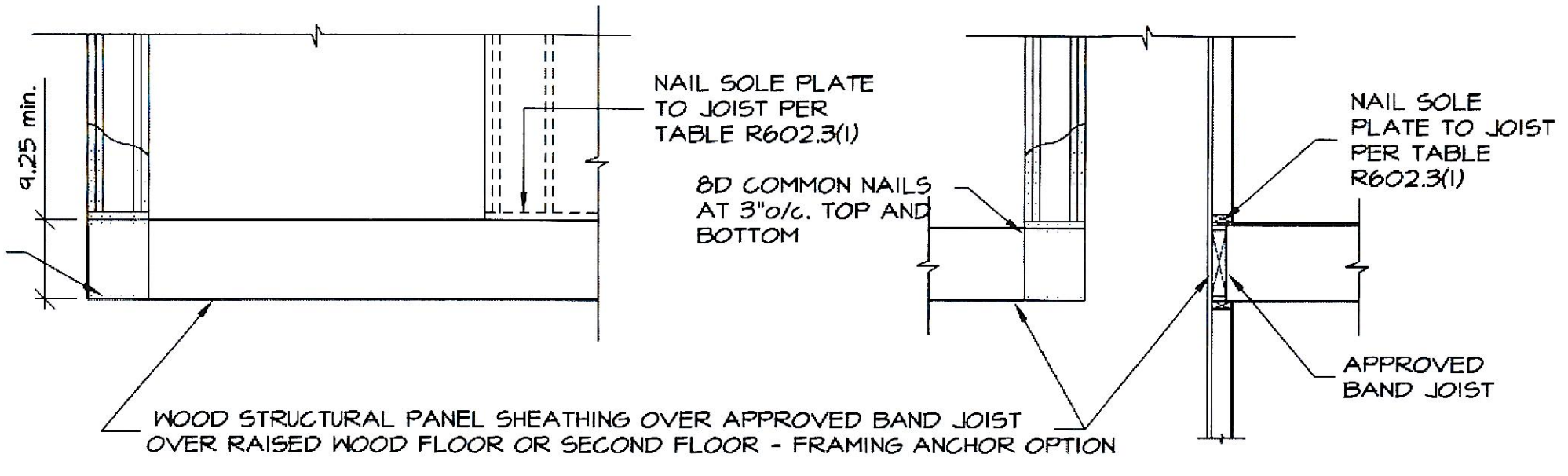

IC OVER RAISED WOOD FLOOR OR SECOND FLOOR FRAMING ANCHOR OPTION "B"



Method CS-PF (Continuously Sheathed Portal Frame Panel)

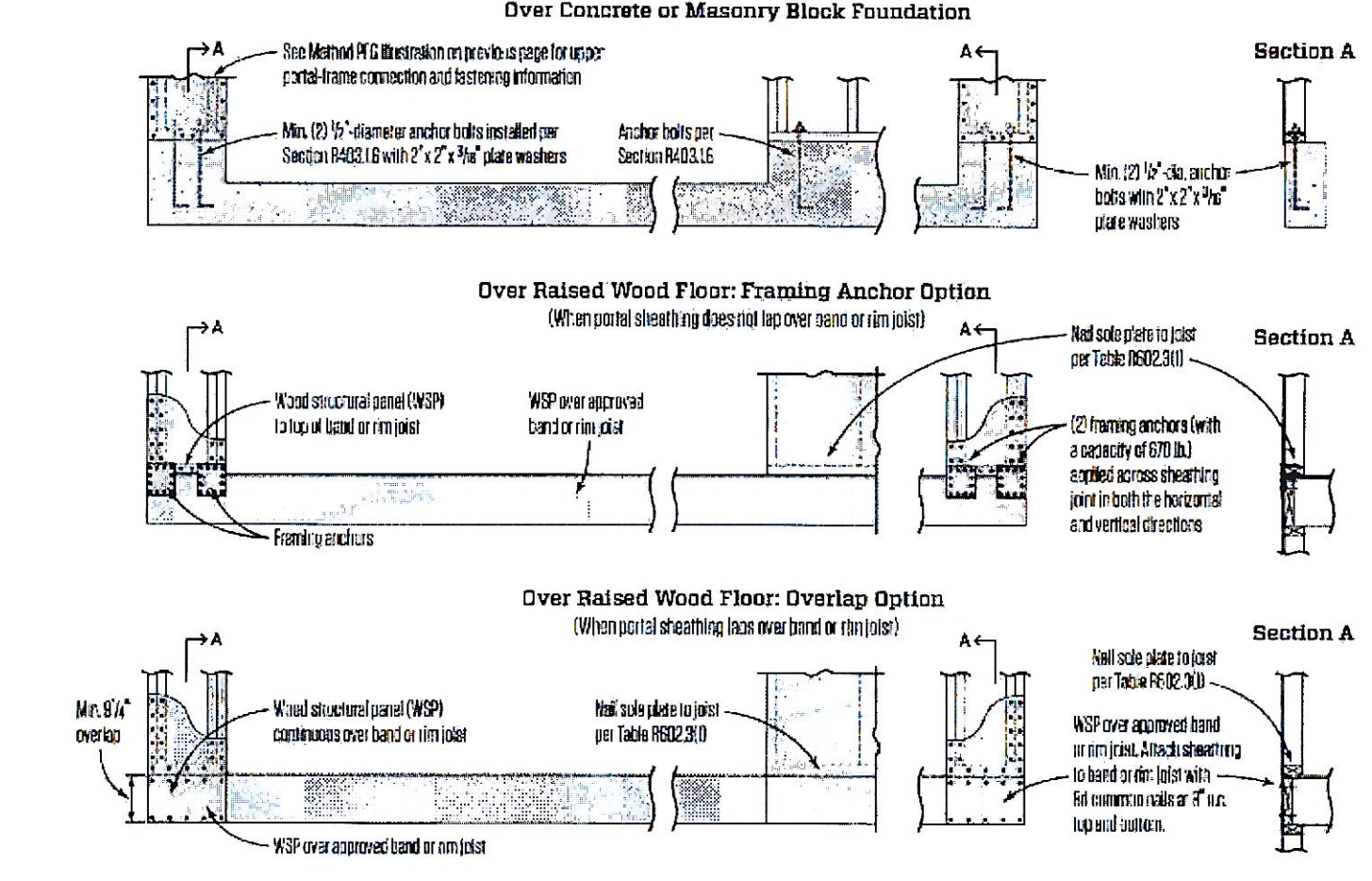

ID (WSP) STANDARD BRACED WALL PANNEL N.T.S.

(CS-PF) CONTINUOUS PORTAL FRAME DETAIL N.T.S.

1721 Lake Avenue
Shady Side, Maryland 20764

Revisions		
Number	Description	Date

Sheet Title:
PORTAL FRAME DETAILS

Scale: **AS NOTED**
Date: **DECEMBER 1, 2019**
Project Number: **2019.42**
Drawn By: **JPC**
Sheet Number:

S.4