

7/16" OSB SHEATHING EXP. 1, 24/16 TO BE FASTENED TO JOISTS/ TRUSSES WITH 8d RING SHANK NAILS AT 6" O.C. ON EDGES AND 12" O.C. IN FIELD.

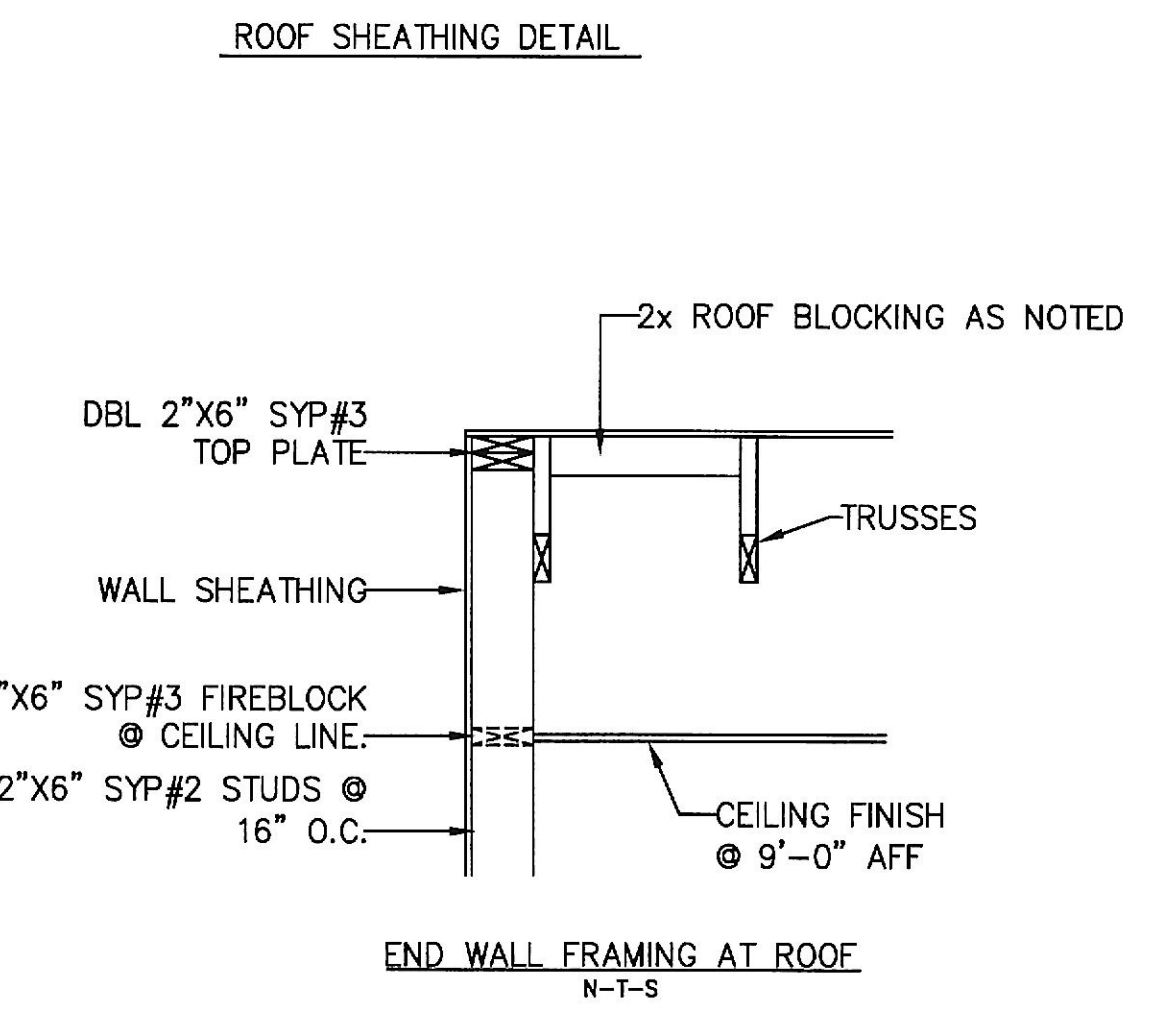

GENERAL CROSS SECTION NOTES:

- UNLESS OTHERWISE SPECIFIED, ALL STEEL SHALL COMPLY WITH ASTM A36, YIELD STRENGTH 36 KSI
- ALL LAG SCREWS SHALL COMPLY WITH ANSI/ASME B18.2.1. Fyb = 60 KSI MINIMUM
- SEE FOUNDATION PLAN FOR PIER AND THE TIE DOWN ANCHORAGE LOCATIONS, ORIENTATIONS AND SPECIFICATIONS.
- WHERE 1" STAPLES ARE SPECIFIED THIS SHALL MEAN 1" PENETRATION INTO THE HOLDING MEMBER
- FOR TIE DOWN STRAP FASTENERS PROVIDE 1/4" MINIMUM SPACE BETWEEN ALL STAPLES AND 3/4" MINIMUM SPACE BETWEEN ALL NAILS UNLESS OTHERWISE PERMITTED BY STRAP MANUFACTURER'S LISTING. ALL FASTENERS SHALL BE INSTALLED IN CENTER 1/3 RD OF THE STRAP WIDTH. DO NOT INSTALL SIDE BY SIDE, IN NO CASE SHALL SPLITTING OF WOOD BE PERMITTED.
- WHERE KRAFTBACK OR OTHER VAPOR RETARDERS ARE SPECIFIED THEY SHALL BE INSTALLED ON THE INTERIOR SIDE OF THE ASSEMBLY UNLESS OTHERWISE SPECIFIED.
- ALL VAPOR RETARDERS ON THE EXPOSED INSULATION SHALL BE FOIL FACE TYPE VAPOR RETARDERS WITH A FLAMESPREAD RATING <25 AND SMOKE DEVELOPMENT RATING < 450. SEE GENERAL NOTES ON COVER SHEET FOR INTERIOR FINISH MATERIAL RATING CLASSIFICATIONS.

RIDGE BEAM CONSTRUCTION

RIDGE BEAM CONSTRUCTION:
 4 LAYERS 3/4" x 24" PLYWOOD, RATED SHEATHING, EXP.-1, 48/24 INDEX, (STRUCT.1 - 5 PLY / SLAYER) EACH SIDE OF EACH MARRIAGE LINE CONTINUOUS OVER SPANS.

NOTES:
 1 PLYWOOD FACE GRAIN MUST BE PARALLEL TO THE RIDGE BEAM SPAN.
 2 ALL PLYWOOD BUTT JOINTS MUST BE STAGGERED 24" MINIMUM.
 3 ALL RIDGE BEAM PLYWOOD LAMINATIONS MUST BE THE SAME DEPTH, THICKNESS, AND GRADE OF PLYWOOD. NO LUMBER OR PLYWOOD FLANGES ARE PERMITTED.
 4 PLYWOOD MUST BE MANUFACTURED IN ACCORDANCE WITH PS 1-09.
 5 PLYWOOD LAMINATIONS IN EACH HALF OF THE UNITS MUST BE GLUE-NAILED TO ADJACENT LAYERS IN ACCORDANCE WITH PDS SUPPLEMENT #5, WITH AN ADHESIVE COMPLYING WITH ASTM D2559. SEE APPROVED PACKAGE FOR MECHANICAL FASTENER SPECIFICATIONS AND SPACING REQUIREMENTS.
 6 PLYWOOD MUST NOT BE TREATED WITH A FIRE RETARDANT PROCESS.
 7 MOISTURE CONTENT MUST BE 15% OR LESS AT TIME OF BEAM CONSTRUCTION.
 8 RIDGE BEAMS MUST EXTEND CONTINUOUS OVER ENTIRE LENGTH OF ALL SUPPORT COLUMNS & HEADERS.
 9 INSTALL 2x4 SYP#3 MINIMUM RIDGE BEAM BEARING STIFFENER OVER SUPPORT COLUMNS & HEADER WHEN SPECIFIED ON FLOOR PLAN. STIFFENER HEIGHT SHALL NOT BE LESS THAN RIDGE BEAM HEIGHT LESS 4 INCHES. FASTEN THE FACE OF THE STIFFENER TO THE RIDGE BEAM WITH 100% GLUE COVERAGE AND 6-16 GA. x 2-1/2" STAPLES.

INTERIOR FINISH MATERIALS:
 CEILING: CLASS 'A' 2X2 SUSPENDED CEILING INSTALLED PER MANUFACTURER'S SPECIFICATIONS
 WALL: 1/2" VINYL CLAD GYPSUM BOARD
 INTERIOR FINISHES SHALL BE CLASS 'A' FOR EXITS & OTHER THAN EXITS SHALL BE 'A' OR 'B'.
 FLOOR: CARPET TILES PER PLAN.
 FLOOR FINISHES SHALL BE NO LESS THAN CLASS II LISTED PRODUCT

EXTERIOR FINISH MATERIALS:
 ROOF: MULEHIDE 45 MIL (BLACK) EPDM FULLY ADHERED OVER 7/16" OSB DECKING W/ MULEHIDE FR ADHESIVE
 WALL: JAMES HARDIE SIERRA PANEL SIDING INSTALLED OVER HOUSE WRAP & 7/16" OSB STRUCTURAL SHEATHING.

STATE OF MARYLAND PACKAGE REFERENCES:
 FRAME I-BEAM DESIGN - C10.1
 FLOOR SYSTEM DESIGN - C5.2
 MATELINE COLUMNS - C27.5
 MATELINE PLYWOOD BEAMS - C29.2
 OVERTURNING AND SLIDING - D24.6 -24.7
 LONGITUDINAL TIE DOWN - D25.0



PROFESSIONAL CERTIFICATION. I HEREBY CERTIFY THAT THESE DOCUMENTS WERE PREPARED OR APPROVED BY ME, AND THAT I AM A DULY LICENSED PROFESSIONAL ENGINEER UNDER THE LAWS OF THE STATE OF MARYLAND, LICENSE NO. 50207, EXPIRATION DATE: 11-30-2022.

RADCO APPROVED
 Jan 08, 2021
 RESOURCES, APPLICATIONS, DESIGN & CONTROLS, INC.
 EASTERN NATIONAL REGION
 5801 BENJAMIN CENTER DRIVE, SUITE 102
 TAMPA, FL 33634
 (813) 243-0370 - O | (813) 243-1314 - F
 www.radcoinc.com

THIRD PARTY DESIGN APPROVAL & INSPECTION AGENCY

TITAN MODULAR SYSTEMS, INC.	
162 INDUSTRIAL DRIVE * ALMA, GA 31510 912-632-3344 (PH) * 912-632-3345 (FX)	
DATE: 12-31-20	ENGINEERS: JAMES ALLEN CHAPMAN, P.E.
SCALE: N-T-S	AMERICUS, GA 31719
CODES: MD, NC, VA	
TMS-5886 A-G - 84'x60' - BUSINESS	
CROSS SECTION	PAGE: 8 / 8