

NOTE:  
 1. WOOD FRAMING WESTERN HEMLOCK E=1,540,000 OR BETTER  
 2. REPLACE ALL JOIST WHICH SHOW SIGNS OF ROT

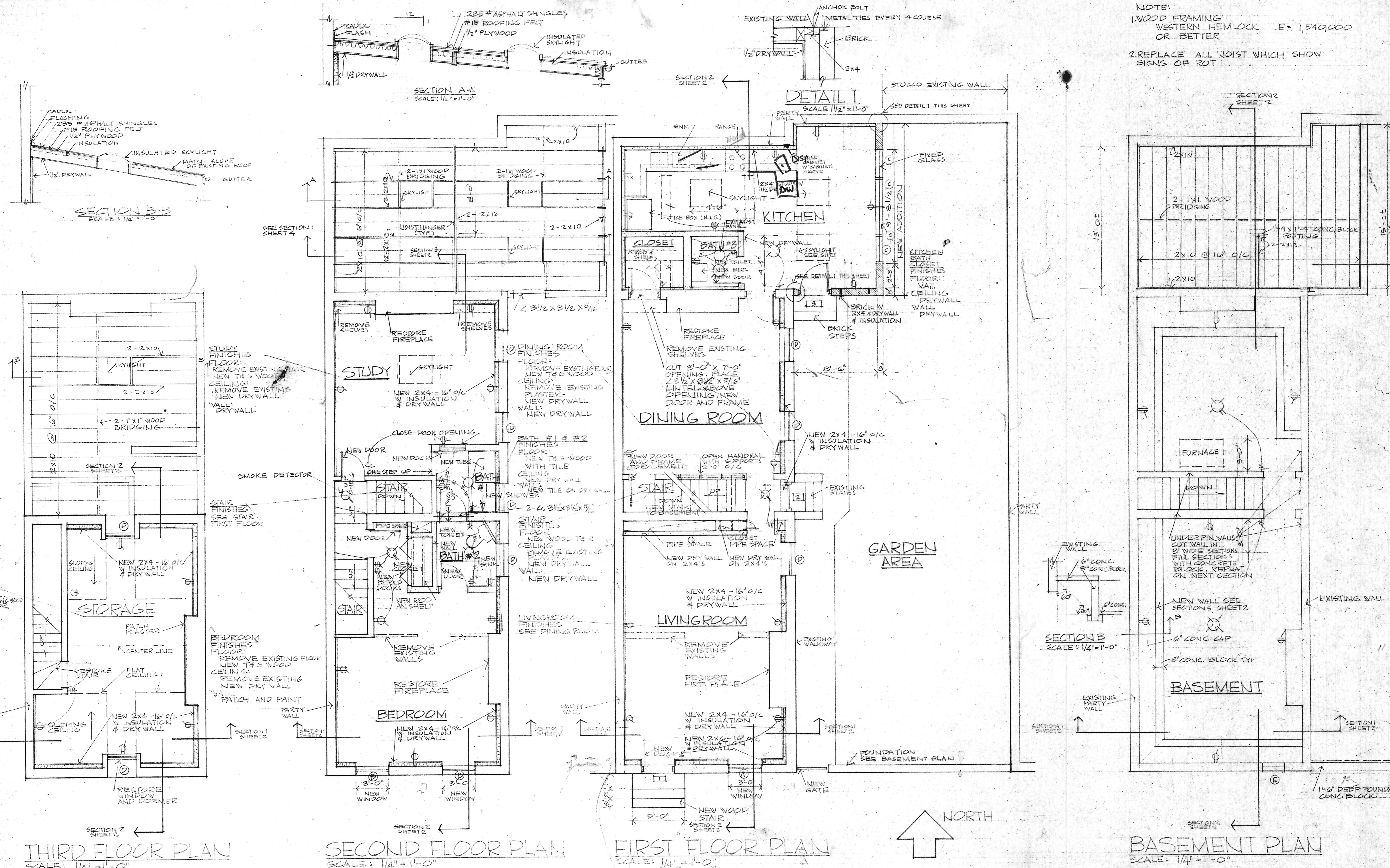

1802 THAMES STREET  
 BALTIMORE, MARYLAND

MR. AND MRS. KEOGH  
 RESIDENCE

JOHN J. KEZMERSKI, AIP  
 ARCHITECT 3006A  
 6047 CAMELBACK LANE  
 COLUMBIA, MARYLAND 21045  
 997-4807