

WINDOW SCHEDULE		
MARK	SIZE (NOMINAL)	REMARKS
⊙	3'-0" x 6'-0"	NEW WINDOWS 7 WOOD AND HEAVY PLANK ARCHITRAVE
⊙	3'-0" x 5'-6"	NEW WINDOWS 3 PLANK ARCHITRAVE
⊙	6'-0" x 6'-8"	NEW WINDOWS 4 PLANK ARCHITRAVE
⊙	REFURBISH EXISTING	WITH METAL BARS
⊙	2'-8" x 1'-4"	
DOOR SCHEDULE (EXTERIOR ONLY)		
MARK	SIZE (NOMINAL)	REMARKS
11	3'-0" x 6'-8"	WITH FOUR PANEL TRANSOM 2 3/4" x 1'-4" WOOD AND HEAVY PLANK ARCHITRAVE
12	REFURBISH EXISTING	
13	3'-0" x 6'-8"	
COLOR SCHEDULE (EXTERIOR ONLY)		
FRONT WINDOWS, DOOR, AND TRANSOM PAINT - WHITE		
ROOF - BLACK		
BRICK - EXPOSED		

**FINAL CONSTRUCTION PLANS**  
APPROVED FOR CONFORMANCE WITH DISPOSITION AGREEMENT  
DEPARTMENT OF HOUSING AND COMMUNITY DEVELOPMENT

RECOMMENDATION TO DHCD  
 APPROVED  APPROVED AS NOTED  
 NOT APPROVED  REVISE AND RESUBMIT

REVIEW IS ONLY FOR COMPLIANCE WITH EXTERIOR FACADE GUIDELINES PREPARED BY ROBERT ENY AND FOR EXTERIOR AID UNDER COMPLIANCE WITH THE BALTIMORE CITY BUILDING CODE, CURRENT EDITION.  
BY *C.A. Moore* DATE 12/3/78  
LAPICKI/SMITH ASSOCIATES  
617 PARK AVE. BALTIMORE, MD. 21201 685-4300

WARD 2  
SECTION 6  
BLOCK 1862

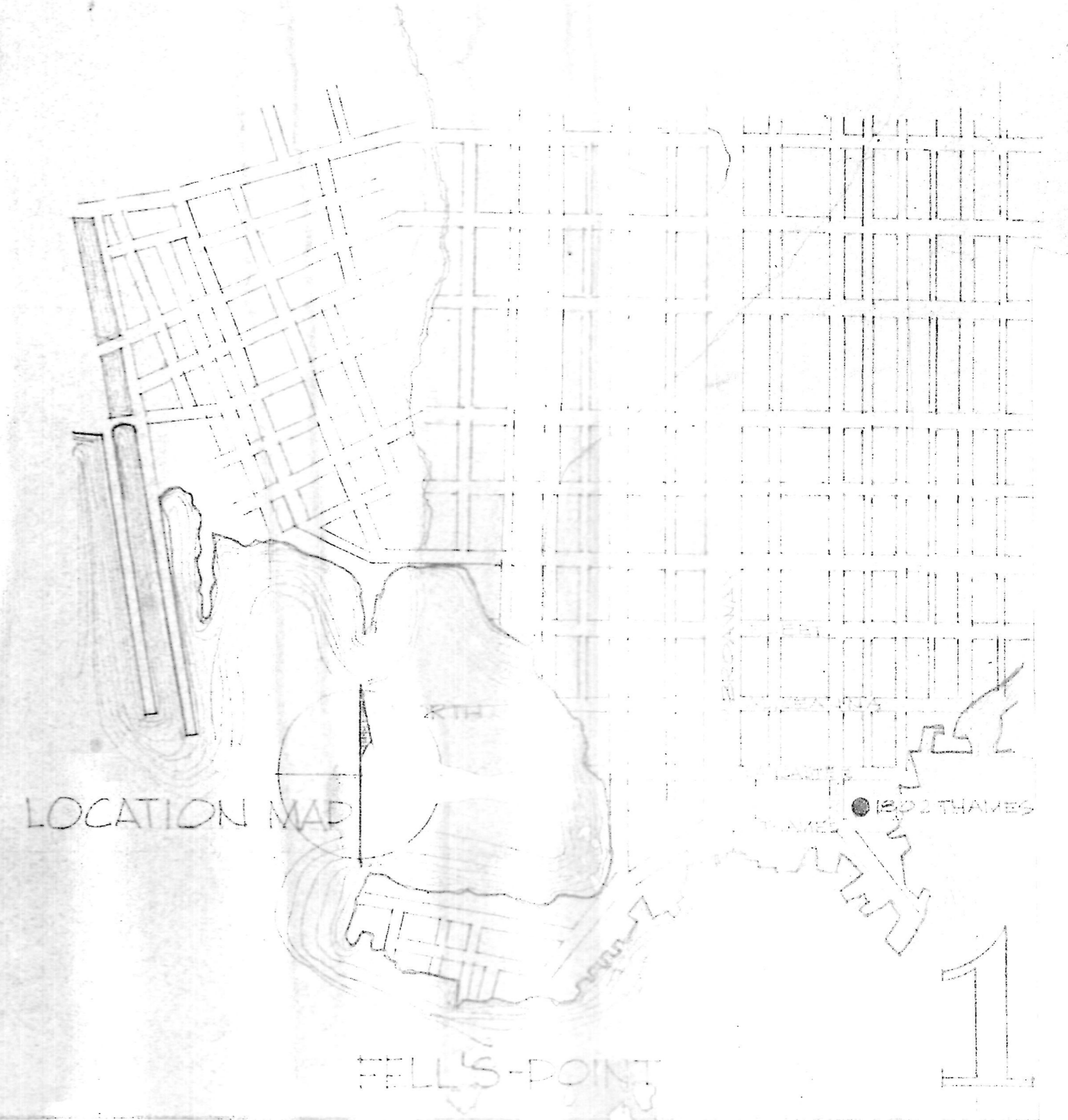
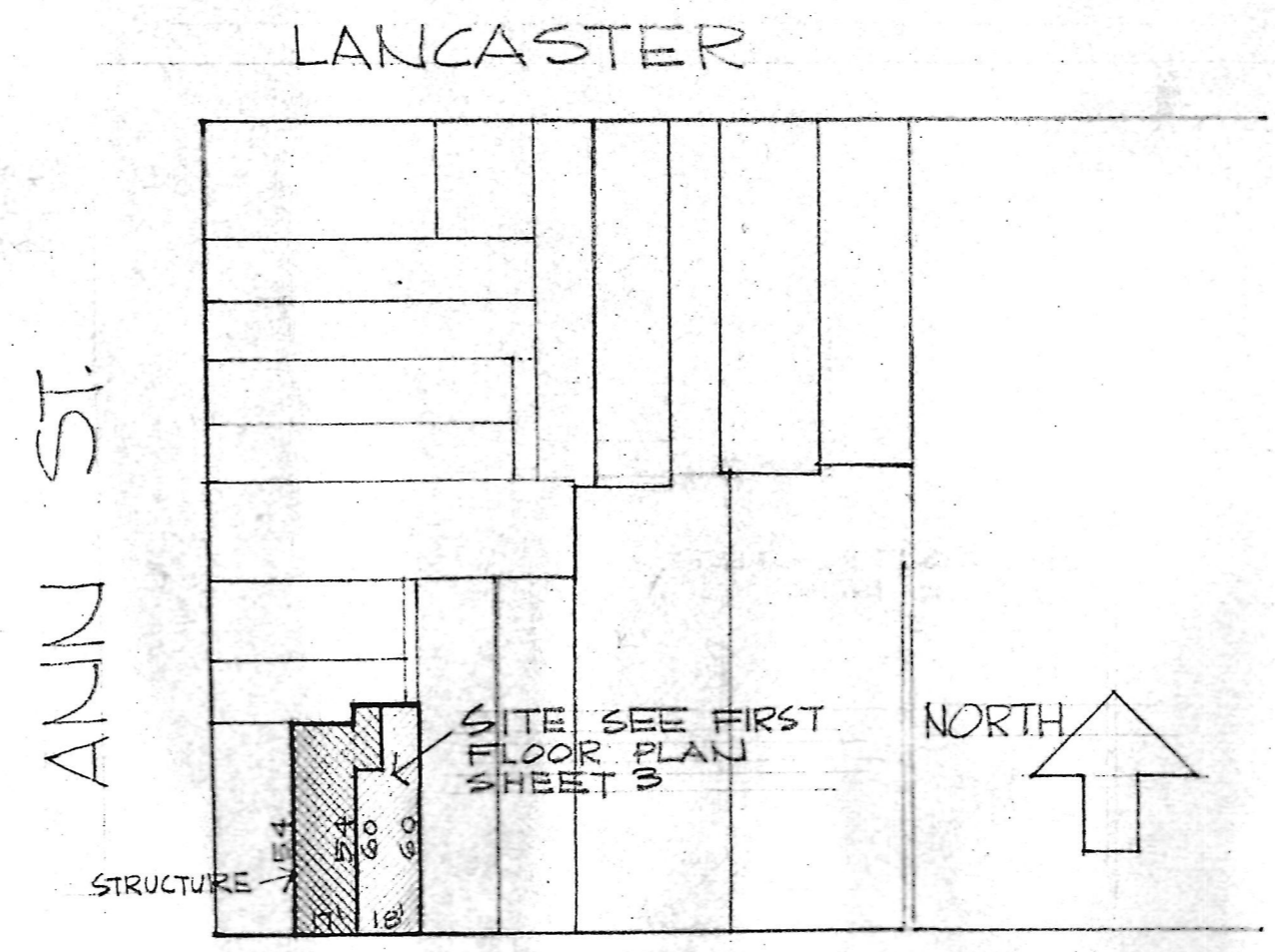

1802 THAMES STREET  
BALTIMORE, MARYLAND

MR. AND MRS. KEOGH  
RESIDENCE

JOHN J. KEZMERSKI, AIP  
ARCHITECT 3006A  
6047 CAMELBACK LANE  
COLUMBIA, MARYLAND 21045  
397-4307

358-8550 - office

110-8814-16