

February 23, 2021

Little Leaves business use is an outpatient clinic providing medical care in the form of behavioral therapy services to its patients. The services are provided pursuant to a physician order by registered behavior technicians (RBT) and board certified behavior analysts (BCBA) (collectively referred to as "Clinicians") with the assistance of behavioral specialists.

- Little Leaves maintains a 1:1 Clinician to patient ratio.
- The Little Leaves clinic in Howard County will serve a maximum of 24 patients at any given time.
- Little Leaves patients bring their own food.

Little Leaves clinics are similar to other outpatient therapy clinics that maintain appropriate clinician to patient ratios without a physician present (such as physical, speech and occupational therapy centers).

*Manita Major*  
Manita Major  
President, Little Leaves Behavioral Services

Little Leaves Behavioral Services  
9727 Georgia Ave | Silver Spring MD 20910 | Tel (202) 420-8359 | (202) 318-2531  
www.littleleaves.org

REVISIONS	DATE	DESCRIPTION
1		
2		
3		
4		
5		
6		
7		
8		
9		
10		
11		
12		
13		
14		
15		
16		
17		
18		
19		
20		
21		
22		
23		
24		
25		
26		
27		
28		
29		
30		
31		
32		
33		
34		
35		
36		
37		
38		
39		
40		
41		
42		
43		
44		
45		
46		
47		
48		
49		
50		
51		
52		
53		
54		
55		
56		
57		
58		
59		
60		
61		
62		
63		
64		
65		
66		
67		
68		
69		
70		
71		
72		
73		
74		
75		
76		
77		
78		
79		
80		
81		
82		
83		
84		
85		
86		
87		
88		
89		
90		
91		
92		
93		
94		
95		
96		
97		
98		
99		
100		

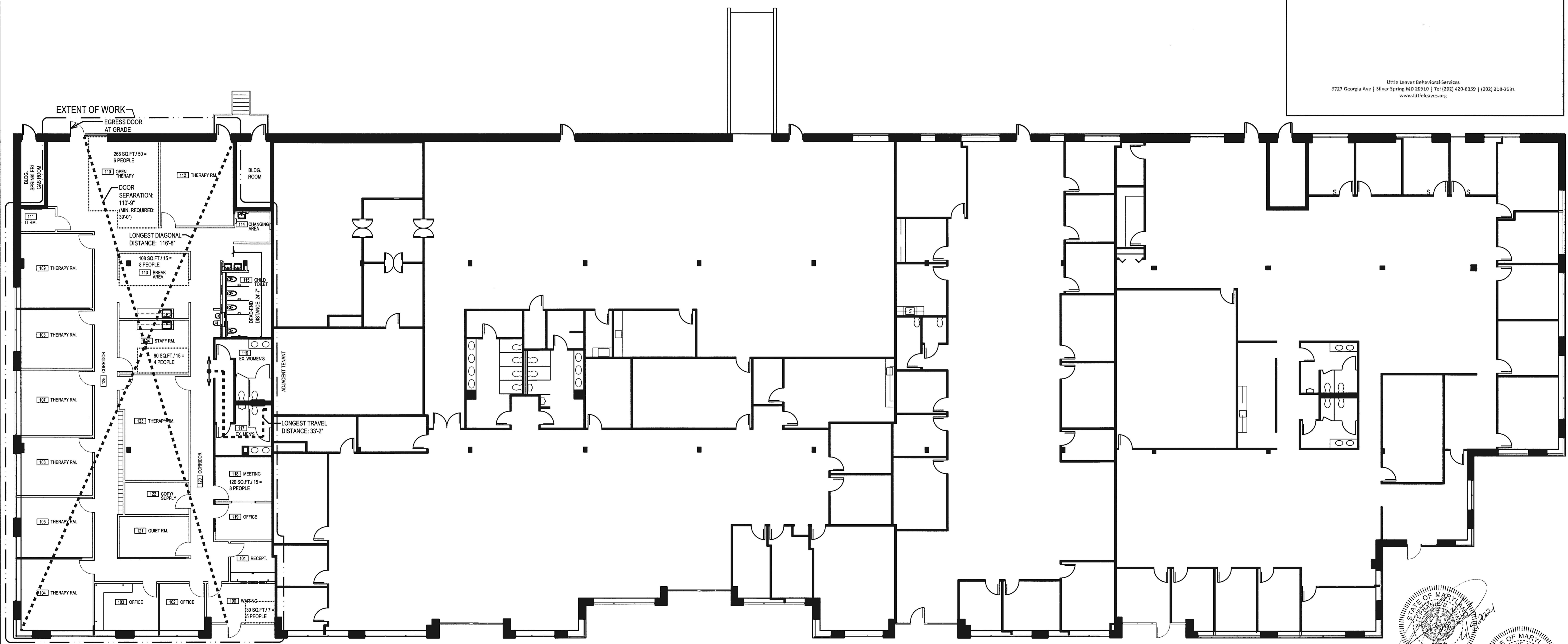

PLAN NORTH  
SCALE 3/32" = 1'-0"  
CRITICAL DIMENSIONS SHALL NOT BE SCALED  
EXISTING CONDITIONS HAVE BEEN PARTIALLY  
FIELD VERIFIED BY ARJUM AE.



**CODE ANALYSIS PLAN**  
**GROUND LEVEL**  
Stephanie B Nunn  
Digitally signed by Stephanie B Nunn  
Date: 2021.03.03 19:11:21 -05'00'

**RECEIVED**  
APR 09 2021  
LICENSES & PERMITS  
DIVISION

REVIEWED FOR  
CODE COMPLIANCE  
Department of Inspections,  
Licenses and Permits  
Howard County  
Date: 03/05/21  
By: Adolphe Huriaux