

SCALE 1/8" = 1'-0"
CRITICAL DIMENSIONS SHALL NOT BE SCALED
EXISTING CONDITIONS HAVE BEEN PARTIALLY
FIELD VERIFIED BY Arnum AE.

**POWER FLOOR PLAN
NEW WORK - ELECTRICAL**

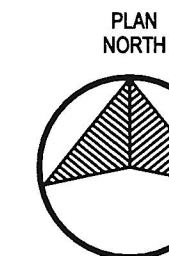
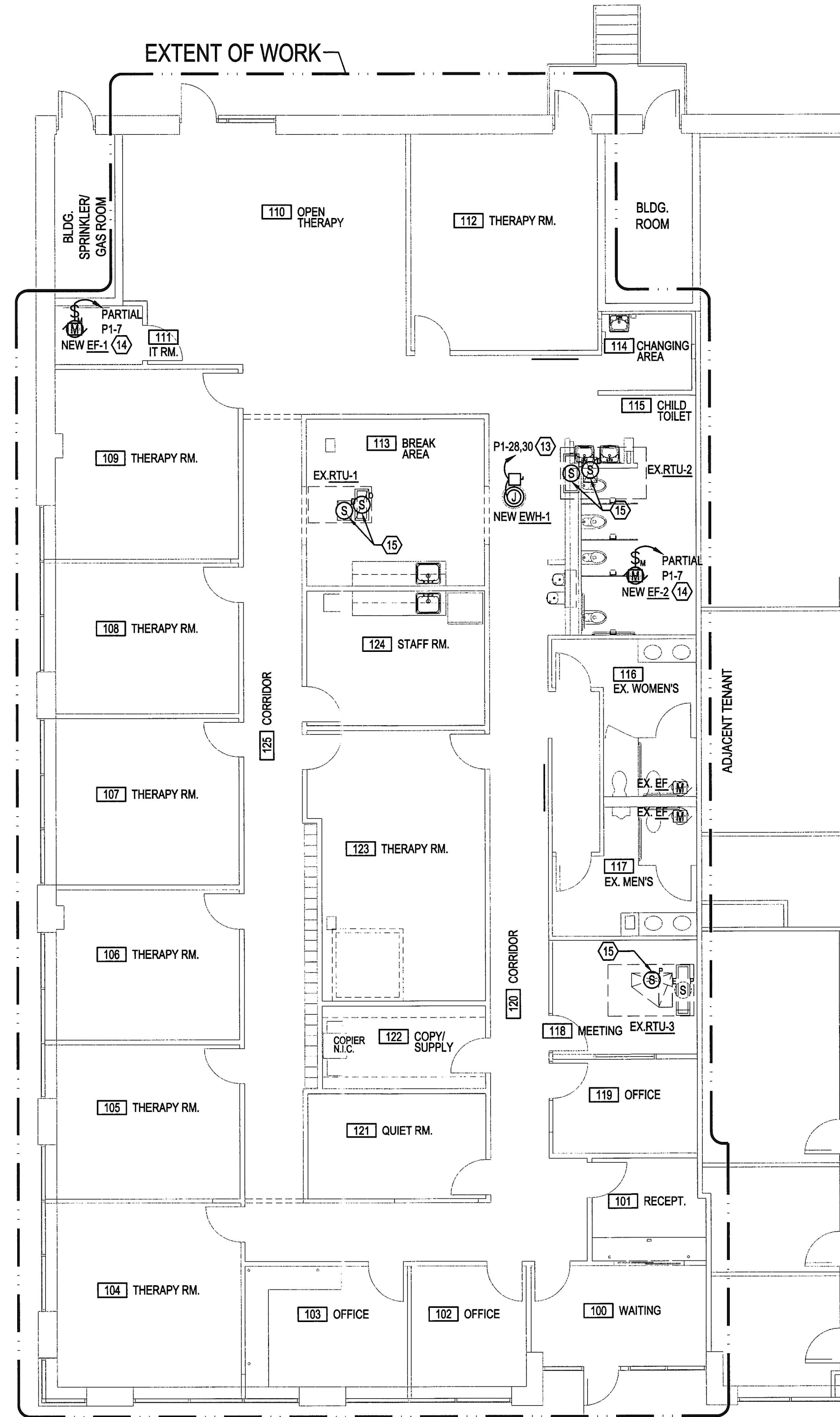

SCALE 1/8" = 1'-0"
CRITICAL DIMENSIONS SHALL NOT BE SCALED
EXISTING CONDITIONS HAVE BEEN PARTIALLY
FIELD VERIFIED BY Arnum AE.

**MECHANICAL POWER FLOOR PLAN
NEW WORK - ELECTRICAL**

- GENERAL NOTES:**
- REFER TO DRAWING E1 FOR SYMBOLS, ABBREVIATIONS AND SPECIFICATIONS.
 - REFER TO DRAWING E6 FOR ELECTRICAL RISER DIAGRAM AND DRAWING E7 FOR ELECTRICAL SCHEDULES.
 - ALL RECEPTACLES SHALL BE TAMPER PROOF. PROVIDE THROUGHOUT SUITE 7150-A.

- DRAWING NOTES:**
- EX. PANEL P1 (100A MLO, 208Y/120V, 3PH, 4W).
 - COPIER. COORDINATE POWER REQUIREMENTS PRIOR TO INSTALLATION.
 - CABLE TELEVISION. PROVIDE RECESSED CLOCK RECEPTACLE, CATV CONNECTION AND DATA CONNECTION. COORDINATE FINAL LOCATION IN FIELD PRIOR TO INSTALLATION.
 - REFRIGERATOR.
 - COFFEE MAKER.
 - MICROWAVE.
 - GARBAGE DISPOSAL.
 - PROVIDE POWER FOR TENANT PROVIDED IT EQUIPMENT RACK. COORDINATE REQUIREMENTS IN FIELD WITH TENANT REPRESENTATIVE.
 - PROVIDE WIRELESS ACCESS POINT AT THIS LOCATION. COORDINATE MOUNTING HEIGHT AND POSITIONING OF JUNCTION BOX WITH TENANT REPRESENTATIVE IN FIELD PRIOR TO INSTALLATION.
 - SECURITY CAMERAS BY OTHERS. COORDINATE MOUNTING HEIGHT AND POSITIONING OF JUNCTION BOX WITH TENANT REPRESENTATIVE IN FIELD PRIOR TO INSTALLATION.
 - COPPER GROUND BUS BAR. REFER TO GROUND BUS BAR NOTES ON THIS DRAWING. CONNECT #6 AWG BARE COPPER GROUNDING ELECTRODE BETWEEN GROUND BUS BAR AND BUILDING STEEL. EXTEND 6'-0" MINIMUM FROM CEILING ON RIGHT SIDE OF TELECOM BACKBOARD.
 - PROVIDE POWER FOR BUZZER RELEASE BUTTON.
 - EW-1 (208V, 1PH, 3KW). PROVIDE NFSS (30A, 208V, 1PH) IN NEMA 1 ENCLOSURE. PROVIDE (2) #12 & #12 GROUND IN 3/4"C.
 - EF-1 & EF-2 (135V, 120V, 1PH). PROVIDE MOTOR RATE SWITCH.
 - PROVIDE DUCT DETECTORS AT EX. DUCTWORK.
 - PROVIDE POWER FOR WATER FOUNTAIN.
 - PROVIDE POWER FOR WATER COOLER.

- SECURITY SYSTEM NOTES:**
- CONTRACTOR SHALL CONFIRM EQUIPMENT REQUIRED AT EACH DOOR AND SELECT THE APPROPRIATE ROUGH-IN FOR EACH DEVICE FROM THE ROUGH-IN REQUIREMENTS DRAWING PROVIDED BY TENANT.
 - PROVIDE AND INSTALL BACK BOXES, CONDUIT WEND BUSHINGS FOR ALL DEVICES SHOWN IN ACCORDANCE WITH THE TYPICAL ROUGH-IN DRAWINGS.
- CR** CARD READER. PROVIDE GANG BOX AT 42" AFF TO CENTER AND 12" MAX. FROM EDGE OF DOOR FRAME. STUB-UP 3/4" CONDUIT TO ABOVE CEILING WITH PULL-STRING. ALL CARD READERS SHALL COMPLY WITH IBC CODE REQUIREMENTS AND SHALL ALLOW FREE EGRESS IN THE DIRECTION OF EGRESS.
- ES** ELECTRIC STRIKE. CONDUIT STUBBED INTO STRIKE POCKET. STUB-UP EMPTY 3/4" CONDUIT WITH PULL WIRE ABOVE ACCESSIBLE CEILING.
- EH** ELECTRIC HINGE. CONDUIT STUBBED INTO POWER TRANSFER HINGE. STUB-UP EMPTY 3/4" CONDUIT WITH PULL WIRE ABOVE ACCESSIBLE CEILING.

- GROUND BUS BAR NOTES:**
- PROVIDE A COPPER GROUND BUS BAR (1/4"-THICK BY 4"-HIGH) MOUNTED ON WALL AS INDICATED ON THE FLOOR PLANS. BUS BAR SHALL HAVE INSULATED STAND-OFFS TO PROVIDE BUS BAR ISOLATION.
 - PROVIDE A #6 AWG COPPER GROUNDING ELECTRODE CONDUCTOR AT GROUND BUS BAR THAT SHALL BE BONDED TO BUILDING STEEL OR OTHER COMPONENT OF BUILDING GROUNDING GRID.
 - PROVIDE A SIX-FOOT LONG #6 AWG COPPER GROUNDING ELECTRODE CONDUCTOR BONDED TO GROUND BUS BAR FOR FUTURE CONNECTION TO TENANT TELECOM EQUIPMENT GROUNDING TERMINALS. COORDINATE WITH TENANT FOR LOCATION OF TERMINATION POINTS OF CONDUCTOR.
 - ALL GROUNDING CONNECTIONS AND INSTALLATIONS SHALL FULLY COMPLY WITH NATIONAL ELECTRICAL CODE (NEC).

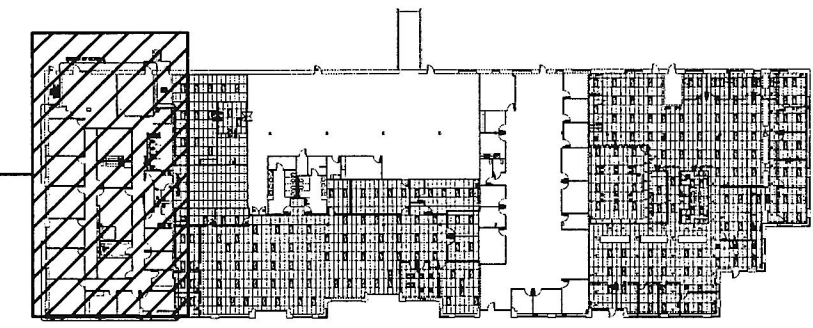

KEY PLAN
NO SCALE

Gregory Baldwin
Digitally signed by Gregory Baldwin
Date: 2021.03.04 10:20:00 -05'00'

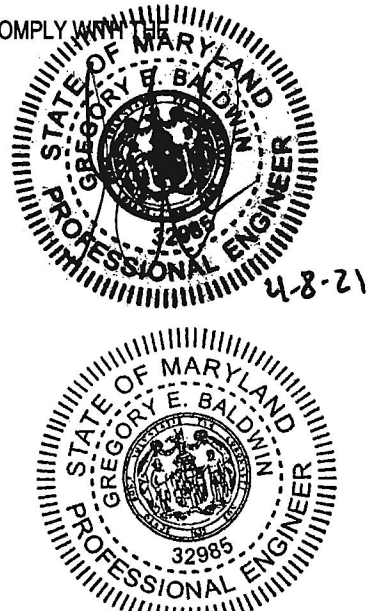

PROJECT MANAGER	COPT. CORPORATE OFFICE PROPERTIES TRUST
PROJECT MANAGER	871 COLUMBIA GATEWAY DRIVE, SUITE 200
PROJECT MANAGER	COLUMBIA, MARYLAND 21046
PROJECT MANAGER	PHONE: 443.285.5884
PROJECT MANAGER	WWW.ARIUMAE.COM
ARCHITECT (MEP) ENGINEER	ARIUM AE
PROJECT MANAGER	LITTLE LEAVES BEHAVIORAL SERVICES
PROJECT MANAGER	7150 COLUMBIA GATEWAY DRIVE
PROJECT MANAGER	COLUMBIA, MD 21046
PROJECT MANAGER	ISSUE DATE: 03 MAR 2021
PROJECT MANAGER	PROJECT FILE NAME: CS05-L1B5
PROJECT MANAGER	BY: DL
PROJECT MANAGER	SM: CB
PROJECT MANAGER	PK: GB
PROJECT MANAGER	DATE: 2021.03.04
PROJECT MANAGER	COPYRIGHT © 2021, Arnum AE, LLC

RECEIVED

APR 09 2021

LICENSES & PERMITS
DIVISION

REVIEWED FOR
CODE COMPLIANCE
Department of Inspections,
Licenses and Permits
Howard County
Date: 04/07/21
By: Don Craemer