

I CERTIFY THAT THESE DOCUMENTS WERE PREPARED OR APPROVED BY ME, AND I AM A DULY LICENSED ARCHITECT UNDER THE LAWS OF THE STATE OF MARYLAND, LICENSE NO. 10916. EXPIRATION DATE 2018.11.10.

OWNERSHIP OF DOCUMENTS NOTICE
 DRAWINGS AND SPECIFICATIONS, AS INSTRUMENTS OF SERVICE, ARE THE EXCLUSIVE PROPERTY OF RATCLIFFE ARCHITECTS. THESE DOCUMENTS ARE NOT TO BE REPRODUCED IN ANY FORM AND THEY SHALL NOT BE USED BY ANY ENTITY EXCEPT BY WRITTEN AUTHORIZATION AND PERMISSION FROM AND AGREEMENT WITH THE DESIGNER.
 COPYRIGHT ACT 1976

NEW CONSTRUCTION PLANS FOR

THE BLAZE RESIDENCE

RESIDENCE AT LOT 4 CROMWELL PASTURE
 7303 BRIGHTSIDE ROAD
 RUXTON, MD 21012

RELEASE SCHEDULE

DATE	SUMMARY
2020.09.02	PERMIT
2020.12.14	CNST REV. 1
2021.01.05	CNST REV. 2

SCALE: As indicated

DWG TITLE:

FOUNDATION PLAN

A1.1

1/5/2021 11:48:04 AM

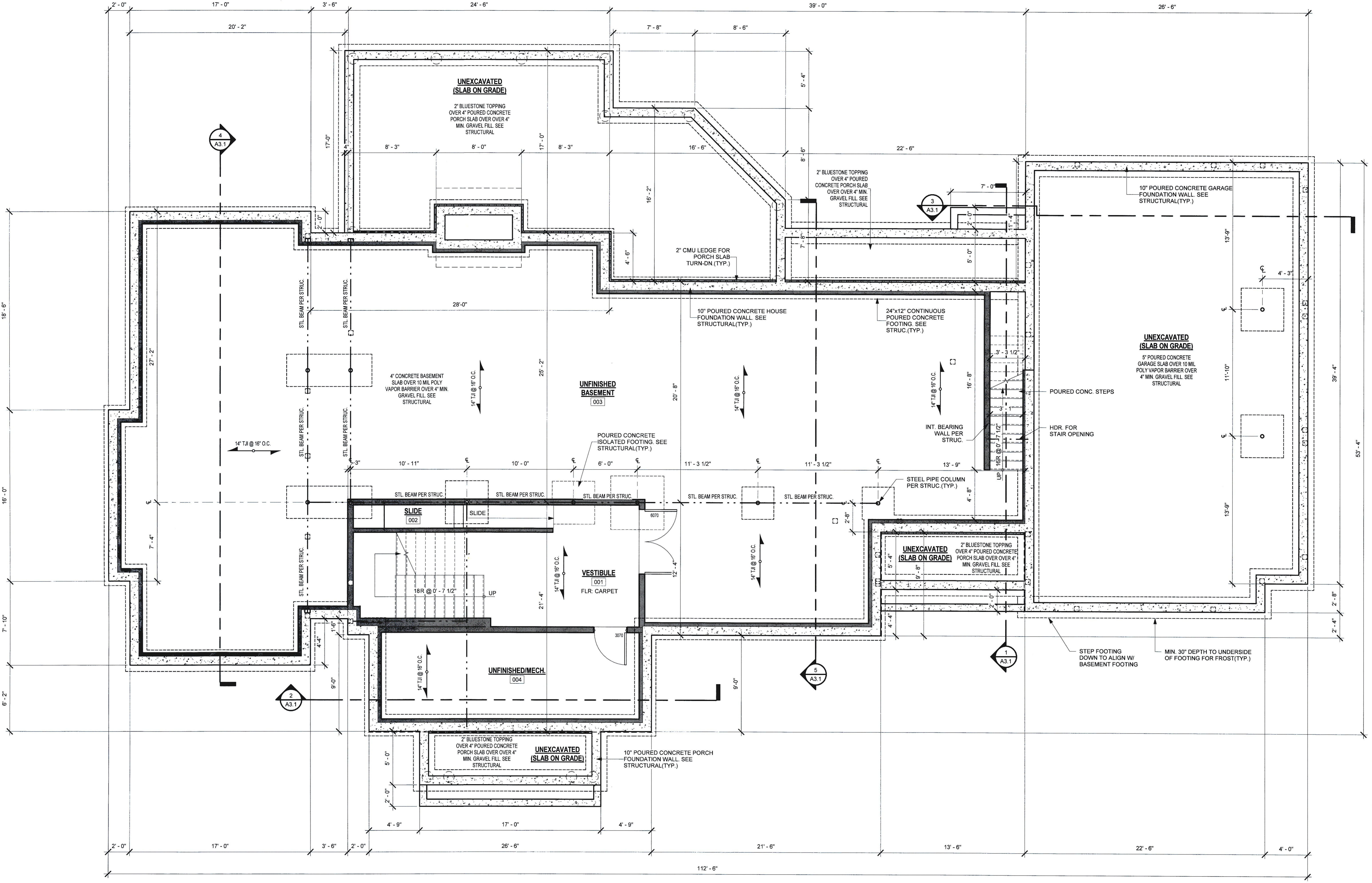

FOUNDATION PLAN NOTES

- ALL DIMENSIONS SHALL BE FIELD VERIFIED BY THE CONTRACTOR. ALL DISCREPANCIES SHALL BE IMMEDIATELY REPORTED TO THE ARCHITECT.
- ALL EXTERIOR DIMENSIONS TAKEN FROM FACE OF MASONRY / CONCRETE U.N.O.
- ALL EXTERIOR WALLS ARE LOAD BEARING WALLS.

FOUNDATION PLAN
 1/4" = 1'-0"

