

Roof walls are 2 layers of 5/8" dry wall.

SECOND FLOOR PLAN ADDITION - POWER
 SCALE: 1/8" = 1'-0"
 0 2' 4' 8' 16'

- PLAN NOTES**
- CONNECT TO 120 VOLT NORMAL POWER CIRCUIT(S) IN RESIDENT ROOM (REFER TO 1/4" SCALE UNIT PART PLANS ON DRAWING E3.2).
 - CONNECT TO 120 VOLT GENERATOR POWER CIRCUIT(S) IN RESIDENT ROOM (REFER TO 1/4" SCALE UNIT PART PLANS ON DRAWING E3.2).
 - CONNECT TO RECEPTACLE IN RESIDENT BATHROOM (REFER TO UNIT PART PLANS).
 - JUNCTION BOX FOR POWER TO MOTORIZED DAMPER - COORDINATE EXACT LOCATION PRIOR TO ROUGH-IN.
 - CONNECT TO ROOM LIGHTING CIRCUIT AND CONTROLS.
 - JUNCTION BOX FOR SMOKE DAMPER - CONNECT TO FIRE ALARM SYSTEM AS REQUIRED.

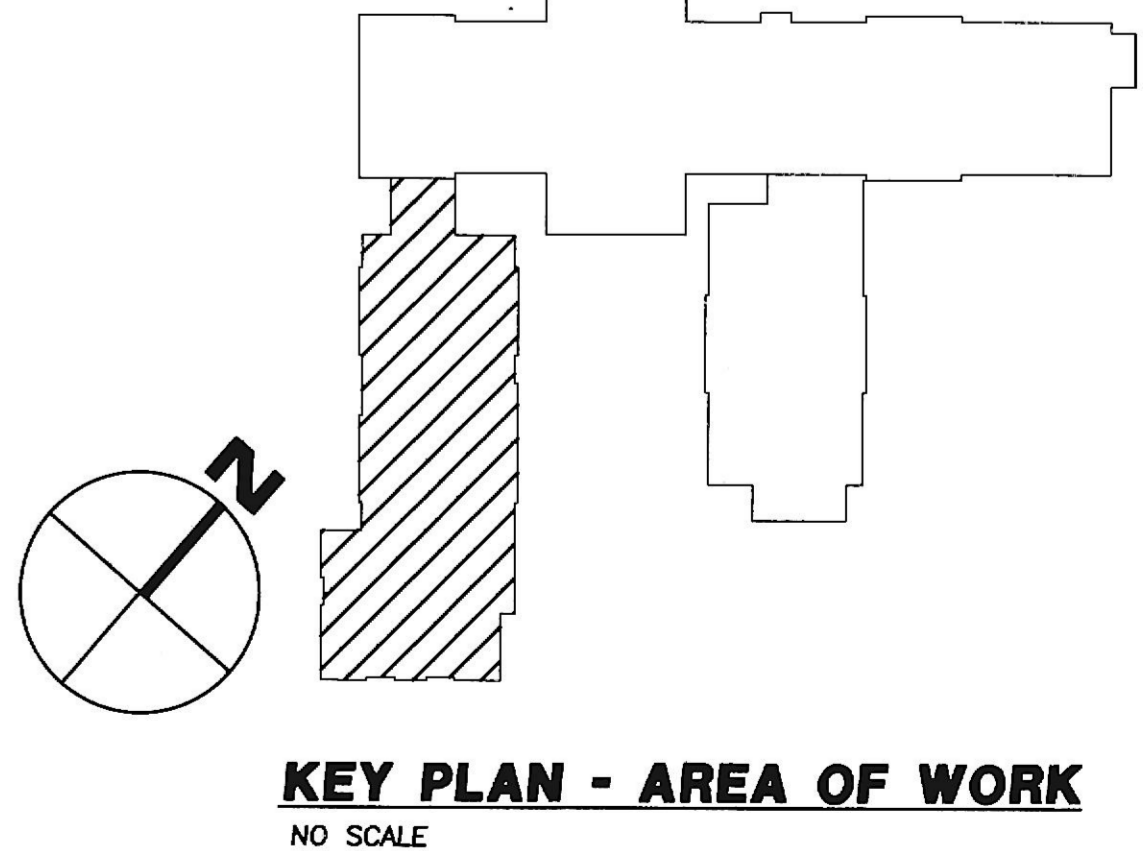

REVISION	BY
PERMIT COMMENTS	
REVISION 2	

Professional Certification
 I certify that these documents were prepared or approved by me, and that I am duly licensed Professional Engineer under the laws of the State of Maryland, license number 22792, expiration date August 04, 2020.

SRBR
 MEP Consulting Engineers since 1959
 757 Frederick Road Suite 300 -
 Crownsville, Maryland 21228
 Phone: 410-869-7282
 Web: www.SRBRengineers.com

Lorien Nursing - Elkridge Addition
 7615 Washington Blvd
 Elkridge, Maryland 21075

SECOND FLOOR PLAN ADDITION - POWER

DATE	May 31, 2019
SCALE	As Noted
DRAWN	
JOB	
SECRET	

REVISION 2 05/31/2019
 SRBR No:18131

E1.6
 OF SHEETS