

- PLAN NOTES**
1. CONNECT TO LIGHTING AT TOP OF SHAFT.
 2. CONNECT TO EXISTING EXTERIOR SECURITY LIGHTING CIRCUIT NEH-2.
 3. CONNECT CIRCUIT VIA LIGHTING CONTACTOR (PHOTOCELL ON/TIMECLOCK OFF).
 4. NEH-12 (SPLIT CIRCUIT).
 5. LIGHTING IN PUBLIC TOILET TO BE 120 VOLT - CONNECT EXHAUST FAN TO 120 VOLT LIGHTING CIRCUIT FOR COMMON POWER AND CONTROL. PUBLIC TOILET LIGHTING AND EXHAUST FANS ON GROUND, FIRST, SECOND AND THIRD LEVELS ALL TO BE ON THE SAME 120 VOLT CIRCUIT SERVING GROUND FLOOR PUBLIC TOILET.
 6. CONNECT UP TO CIRCUIT 'AP1-46' ON FIRST FLOOR.
 7. CONNECT UP TO CIRCUIT 'AH1-23' ON FIRST FLOOR.
 8. CIRCUIT TO BE TIMELOCK ON/TIMECLOCK OFF. SEE GROUND FLOOR ELECTRIC ROOM PART PLAN NURSING ON DRAWING E4.1 FOR ADDITIONAL INFORMATION.
 9. CONNECT TO EMERGENCY LIGHTING CIRCUIT IN THIS CORRIDOR.
 10. CONNECT TO NORMAL LIGHTING CIRCUIT IN THIS CORRIDOR.

GENERAL NOTES:

1. ALL EXIT SIGNS AND EMERGENCY/NIGHTLIGHTS SHALL BE WIRED AHEAD OF ALL LOCAL SWITCHING.

WORK PREVIOUSLY SHOWN IN THIS AREA HAS BEEN REMOVED FROM THE SCOPE.

GROUND FLOOR PLAN - LIGHTING
SCALE: 1/8" = 1'-0"
0 2' 4' 8' 16'

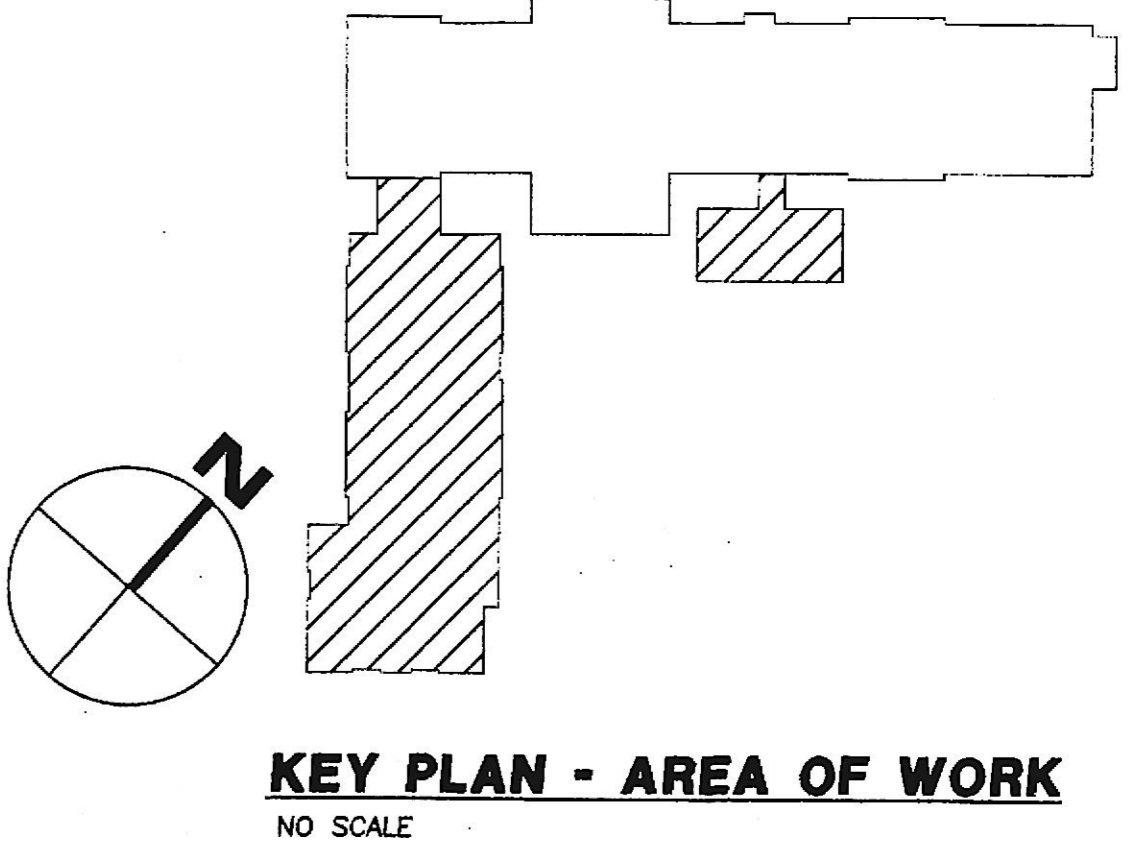

REVISION 1	BY
PERMIT COMMENTS	
REVISION 2	
ADDENDUM #2	

Professional Certification I certify that these documents were prepared or approved by me, and that I am duly licensed Professional Engineer under the laws of the State of Maryland, license number 22792, expiration date August 04, 2020.

SRBR
MEP Consulting Engineers since 1959
757 Frederick Road Suite 300 - Catonsville, Maryland 21228
Phone: 410-609-7252
Web: www.SRBRengineers.com

Lorien Nursing - Elkridge Addition
 7615 Washington Blvd
 Elkridge, Maryland 21075

GROUND FLOOR PLAN LIGHTING

DATE	Dec. 08, 2019
SCALE	As Noted
DRAWN	
JOB	
SHEET	

ADDENDUM #2 12/06/2019
SRBR No: 18131

E2.2
OF SHEETS