

# CHESAPEAKE MEDICAL

1312 BELLONA AVE., SUITE 102  
LUTHERVILLE, MD. 21093

OWNER

LASER ASSETS /  
CHESAPEAKE MEDICAL IMAGING  
122 Defense Highway  
Annapolis, Md 21401  
Phone: (410) 703-5912  
contact: Steve Linhard  
email: slinhard@cmimail.net

ARCHITECT

HOFMANN ASSOCIATES, INC.  
606 Baltimore Ave., Suite 102  
Towson, Maryland 21204  
Phone: (410) 828-9090  
Fax: (410) 828-4433  
contact: Bob Hofmann  
email: rth@haiarchitects.com

MECHANICAL ELECTRICAL  
AND PLUMBING ENGINEER

SIEGEL, RUTHERFORD,  
BRADSTOCK & RIDGEWAY, INC.  
757 Frederick Road, Suite 300  
Catonsville, MD 21228  
ph (410) 869-7282 / fax (410) 869-7362  
contact: William F. Stevens  
email: bstevens@srbr.com

STRUCTURAL ENGINEER

MINCIN, PATEL, MILANO, INC.  
6511 Harford Road  
Baltimore, Maryland 21214  
Phone: (410) 254-7500  
Fax: (410) 254-7100  
contact: Paul Milano  
email: pmilano@mpm-engr.com



HOFMANN  
ASSOCIATES, INC.  
606 Baltimore Ave.  
Suite 102  
Towson, Maryland 21204  
410.828.9090  
fax 410.828.4433

Professional Certification:  
I certify that these documents were  
prepared or approved by me,  
and that I am a duly licensed architect  
under the laws of the State of Maryland.  
License Number: 3114-A  
Expiration Date: 5/13/2015



CHESAPEAKE  
MEDICAL IMAGING

ABBREVIATIONS

AT	AT	EA	EACH	ID	INSIDE DIAMETER	Q.T.	QUARRY TILE
A.B.	ANCHOR BOLT	E.F.	EXHAUST FAN	IG	INSULATED GLASS	R	RISER
ACT.	ACOUSTICAL	EL	ELEVATION	INCL	INCLUDE (D) (ING)	R./RAD.	RADIUS
	CEILING TILE	ELEC	ELECTRIC	INSUL.	INSULATION	R.D.	ROOF DRAIN
ADA	AMERICAN	ELEV.	ELEVATION	INT.	INTERIOR	R.L.	RAIN LEADER
	DISABILITY ACT	EMER	EMERGENCY	INV	INVERT	RM.	ROOM
A.F.F.	ABOVE FINISH FLOOR	E.P.	ELECTRICAL PANEL	J.C.	JANITOR'S CLOSET	R.O.	ROUGH OPENING
ALT.	ALTERNATE	E.Q.	EQUAL	JT.	JOINT	RTU	ROOF TOP UNIT
ALUM.	ALUMINUM	EQUIP.	EQUIPMENT	J.C.	JANITOR'S CLOSET		
APPROX.	APPROXIMATE	EST	ESTIMATE	LIAP	LAY IN ACOUSTICAL	SD	SOAP DISPENSER
ARCH.	ARCHITECTURAL	E.W.	EACH WAY	LAV.	LAVATORY	SHT.	SHEET
AUTO	AUTOMATIC	E.W.H.	ELECTRIC	L.P. (LP)	LOW POINT	SNTD	SANITARY NAPKIN / TAMPON VENDOR
			WATER HEATER	LT	LIGHT	SPEC.	SPECIFICATIONS
BD.	BOARD	EXIST./EXTG.	EXISTING	MACH.	MACHINE	SQ	SQUARE
BLDG.	BUILDING	EXP	EXPPOSED, EXPANSION	MAS	MASONRY	S/S	STAINLESS STEEL
BLK.	BLOCK	EXP.JT./E.J.	EXPANSION JOINT	MAX.	MAXIMUM	STL.	STEEL
BM.	BEAM	EXT.	EXTERIOR	MECH.	MECHANICAL	STOR.	STORAGE
B.O.	BOTTOM			MET./MTL	METAL	STRUCT.	STRUCTURAL
BRNG./BRG.	BEARING	FACP	FIRE ALARM			SYST.	SYSTEM
BRK.	BRICK		CONTROL PANEL				
		F.D.	FLOOR DRAIN				
CEIL./CLG.	CEILING	F.E.	FIRE EXTINGUISHER	MEZZ.	MEZZANINE	TEL.	TELEPHONE
CJT.	CONTROL JOINT	F.E.C.	FIRE EXTINGUISHER	MFR	MANUFACTURE (ER)	TEMP.	TEMPERED
CL	CENTERLINE		CABINET	MG	MIRROR (GLASS)	T&G	TONGUE GROOVE
CLO.	CLOSET	FIN.	FINISH (ED)	MH	MANHOLE	TJ	TOP OF JOIST
CMU	CONCRETE	FLG.	FLASHING	M.H.	METAL HALIDE	TPD	TOILET TISSUE DISPENSER
	MASONRY UNIT	FLR./FL.	FLOOR (ING)	MIN.	MOUNTING HEIGHT		
COL.	COLUMN	FLUOR.	FLUORESCENT	MISC.	MISCELLANEOUS	THK.	THICK (NESS)
CONC.	CONCRETE	FND	FOUNDATION	M.O.	MASONRY OPENING	TYP.	TYPICAL
CONST.	CONSTRUCTION	F.R.	FIRE RATED	MULL.	MULLION		
CONT.	CONTINUOUS	FTG	FOOTING	M.W.P.	MEMBRANE	U.C.	UNDER CUT
CORR.	CORRIDOR				WATERPROOFING	UL	UNDERWRITERS LABORATORY
CT	CERAMIC TILE	GA.	GAUGE	N	NORTH, NEUTRAL	V.B.	VAPOR BARRIER,
		GALV.	GALVANIZED	N.I.C.	NOT IN CONTRACT	V.C.T.	VINYL COVE BASE
D	DRAIN	G.B.	GRAB BAR(S)	N.T.S.	NOT TO SCALE		VINYL COMPOSITION
DEM	DEMOLISH.	G.C.	GENERAL CONTRACTOR	NO.	NUMBER		TILE
	DEMOLITION	GDRAL	GUARDRAIL(S)	NOM.	NOMINAL		
DF	DRINKING FOUNTAIN	GYP.BD./GWB	GYPSUM WALL BOARD	OA	OVERALL	VERT.	VERTICAL
DIA.	DIAMETER			O.C.	ON CENTER	VEST.	VESTIBULE
DIM.	DIMENSION	H.B.	HOSE BIB	O.D.	OUTSIDE DIAMETER		
DN.	DOWN	H.C.	HOLLOW CORE	OPNG.	OPENING	W	WEST, WIDE, WIDTH
DO	DITTO	HDCP.	HANDICAPPED	OPP.	OPPOSITE	W/	WITH, WIDE
D.P.	DAMP PROOFING	HGT./HT.	HEIGHT	PART'N	PARTITION	W/IN	WITHIN
DR	DOOR	H.M.	HOLLOW METAL	PTD.	PAINTED	W/OUT	WITHOUT
DS	DOWNSPOUT	HOR.	HORIZONTAL	PTD	PAPER TOWEL	WC	WATER CLOSET
DTL	DETAIL	H.P.	HIGH POINT	PWD	PLYWOOD	WD.	WOOD
DWG.	DRAWING	HRAL	HANDRAIL(S)				
		HWH	HOT WATER HEATER				

GRAPHIC SYMBOLS

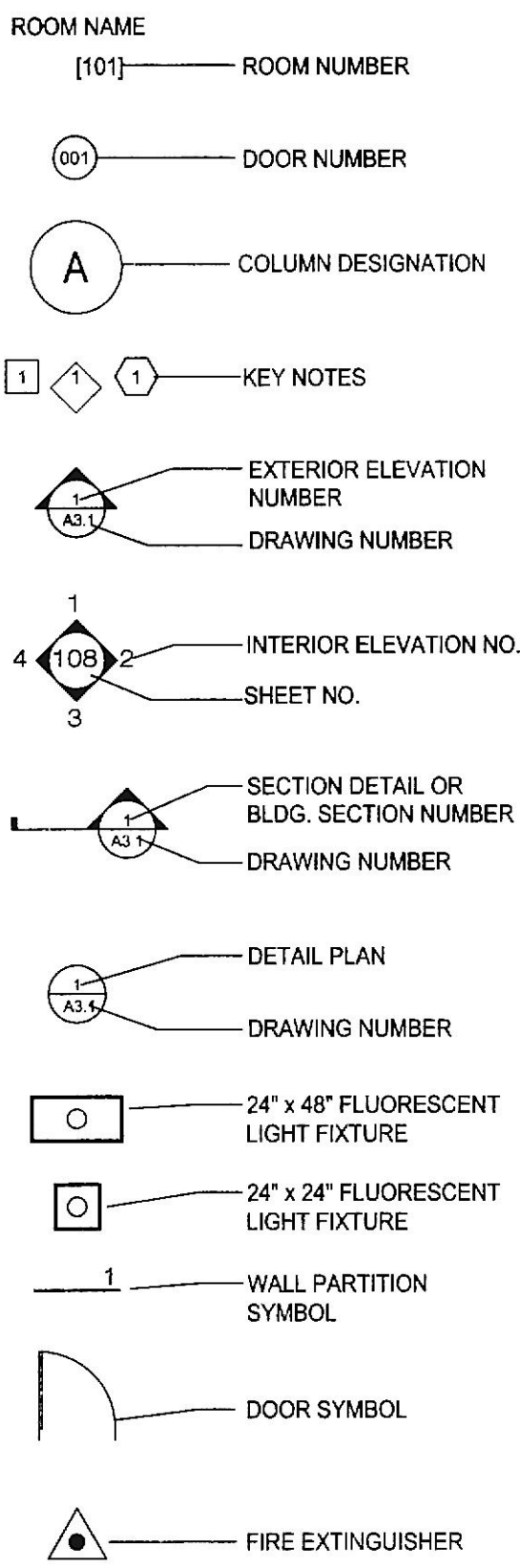

MATERIAL SYMBOLS

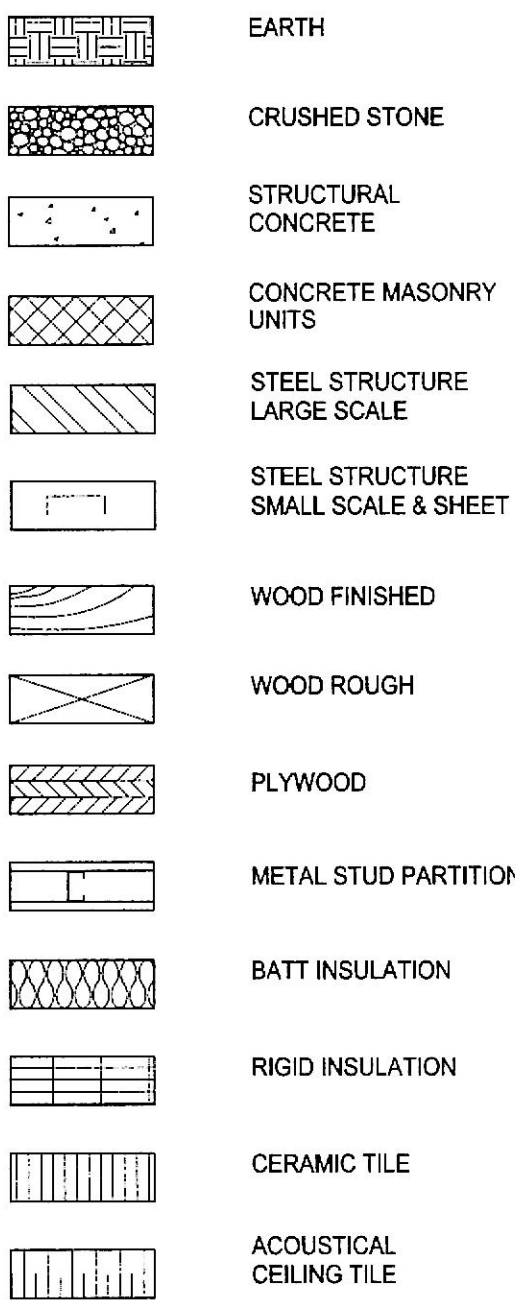

GENERAL NOTES

- A. GC IS RESPONSIBLE FOR SHOP DRAWING REVIEW.
- B. GC TO NOTIFY ARCHITECT FOR THE FOLLOWINGS:
1. DIMENSIONAL INCONSISTENCIES, ERROR AND OMISSIONS
  2. COORDINATION PROBLEMS BETWEEN DRAWINGS OR BETWEEN DRAWINGS AND SPECIFICATIONS
  3. AREAS OF INFORMATION INADEQUATE FOR ACCURATE BIDDING OR CONSTRUCTION
  4. INFORMATION THAT MIGHT CAUSE CONFLICTS OF SCOPE OR SEQUENCING BETWEEN TRADES
  5. ITEMS THAT MIGHT INADVERTENTLY RESULT IN UNDESIRABLE AESTHETICS
  6. DETAILS THAT CAN BE LESS EXPENSIVELY CREATED
  7. DETAILS THAT DO NOT SEEM TO HAVE A FAIR COST/BENEFIT BALANCE
  8. DETAILS THAT THREATEN THE OVERALL PROJECT BUDGET COMPLIANCE
- C. THE GC'S RECOMMENDATIONS MUST BE MADE WITH TACT AND DIPLOMACY AND FAIR IDEA OF GAINS IF RECOMMENDED CHANGES ARE MADE.

LOCATION PLAN

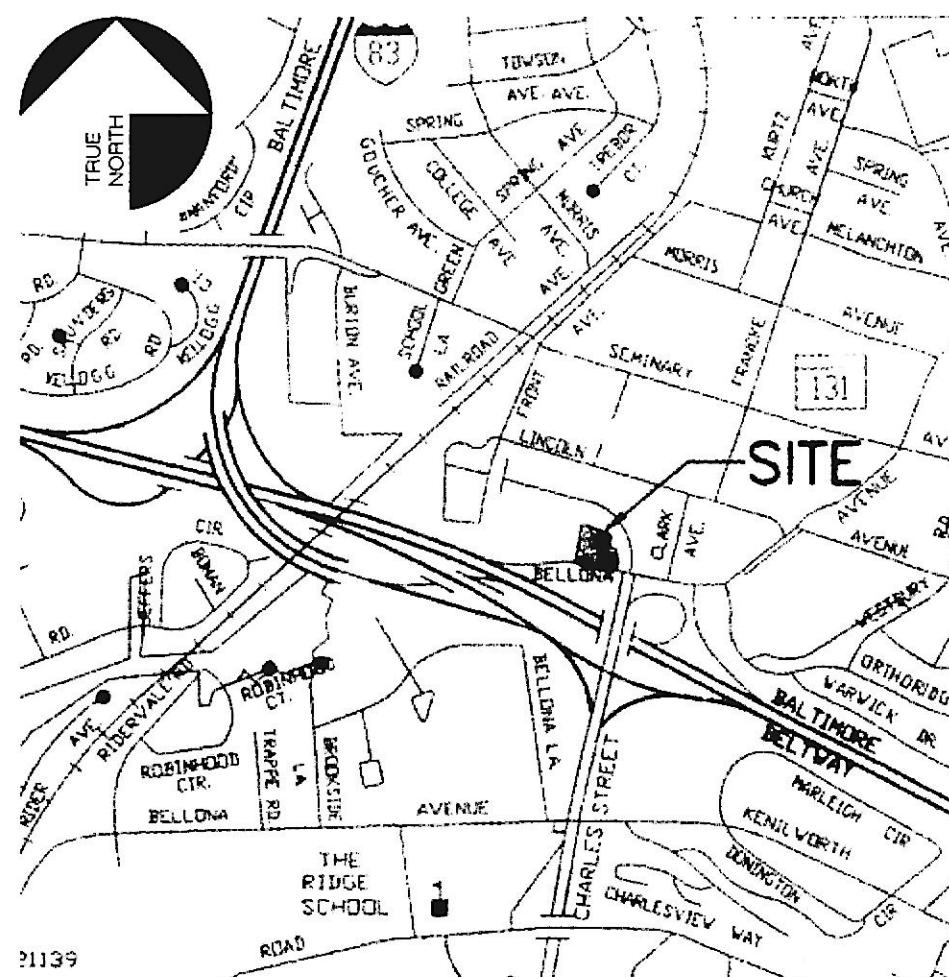

BUILDING CODE DATA

1. CODE INFORMATION:
- ALL WORK SHALL COMPLY WITH STATE AND LOCAL CODES AND ORDINANCES INCLUDING THE LATEST EDITION IN FORCE OF THE FOLLOWING CODES:
- 2012 LIFE SAFETY CODE (N.F.P.A. - 101)
  - 2012 INTERNATIONAL BUILDING CODE
  - 2012 INTERNATIONAL MECHANICAL CODE
  - 2012 INTERNATIONAL PLUMBING CODE
  - 2012 INTERNATIONAL ENERGY CONSERVATION CODE
  - 2011 NATIONAL ELECTRICAL CODE
  - 2012 ACCESSIBLE AND USEABLE BUILDINGS AND FACILITIES - ICC A117.1-2009
- ALL WORK SHALL BE PERFORMED ACCORDING TO JOINT REQUIREMENTS AND DECISIONS OF ALL LOCAL AUTHORITIES.
2. DESIGN CRITERIA:
- USE GROUP : B (BUSINESS)  
CLINIC, OUTPATIENT
- CONSTRUCTION TYPE : 2B
- HEIGHT BUILDING : 39'
- NUMBER OF STORIES : 3
- ALL BUILDING AREAS : 26,450 sq. ft.
- EXISTING BUILDING OCCUPANTS : 26,450 / 100
- TOTAL OCCUPANT LOAD : = 265 PERSONS
- ARCHITECTURAL ALTERATIONS : 4,145 sq. ft.
- ALTERED BUILDING OCCUPANTS : 4,145 / 100
- ALTERATION OCCUPANT LOAD : = 42 PERSONS
3. BUILDING SHALL BE FULLY SPRINKLED AS PER MARYLAND STATE FIRE PREVENTION CODE ARTICLE 38-A.
4. BLOCKING: ALL WOOD USED FOR BLOCKING, BULKHEAD FRAMING AND SIMILAR PURPOSES, SHALL BE FIRE TREATED WOOD IN ACCORDANCE WITH:
- AWPA-C27-74 FOR PLYWOOD, AWPA-C20-74 FOR LUMBER.
5. EMERGENCY LIGHTING SHALL BE PROVIDED BY APPROVED EMERGENCY LIGHT PACKS WITH FULLY AUTOMATIC BATTERY BACK-UP AND LOAD SWITCHES. LIGHTS SHALL BE PROVIDED AT ALL ALL EMERGENCY EXITS IN ACCORDANCE WITH 2012 NFPA 101.

DRAWING INDEX

- ARCHITECTURE
- C COVER SHEET
  - D 1 DEMOLITION
  - A 1 FLOOR PLAN
  - A 2 REFLECTED CEILING PLAN
  - A 3 SCHEDULES AND DETAILS
- STRUCTURAL
- S 1 PARTIAL STRUCTURAL PLANS
  - S 2 SECTIONS AND DETAILS
- MECHANICAL
- M 101 FLOOR PLAN MECHANICAL
  - M 102 ROOF PLAN MECHANICAL
  - M 201 MECH. SCHEDL. AND DETAILS
  - M 302 MECHANICAL DETAILS
  - P 100 COVERSHEET PLUMBING
  - P 101 FLOOR PLAN PLUMBING
  - P 201 PLUMB. SCHEDL. AND DETAILS
  - P 301 PLUMBING SPECIFICATIONS
- ELECTRICAL
- E 001 ELECTRICAL LEGND AND NOTES
  - ED101 ELECTRICAL DEMOLITION PLANS
  - E 100 SITE AND SERVICE PLAN ELECT.
  - E 101 FLOOR PLAN ELECTRICAL
  - E 102 FLOOR PLAN LIGHTING
  - E 103 ROOF PLAN ELECTRICAL
  - E 200 ELECT. SPECS. AND DETAILS

PROJECT NAME:  
CHESAPEAKE MEDICAL  
1312 BELLONA AVE., SUITE 102  
LUTHERVILLE, MD. 21093  
DEVELOPER / OWNER:  
CHESAPEAKE MEDICAL IMAGING

ISSUE DATE	
11/03/14	PERMIT SET
11/17/14	BID SET
11/20/14	ADDENDUM 1

THE CONCEPTS, IDEAS, DESIGNS AND IMAGES ARE INTENDED ONLY FOR THE PROJECT SPECIFIED ON THIS SHEET AND ARE THE SOLE PROPERTY OF HOFMANN ASSOCIATES, INC. THEY ARE NOT TO BE REPRODUCED OR USED BY OTHERS WITHOUT WRITTEN PERMISSION BY HOFMANN ASSOCIATES, INC.

COVER

