

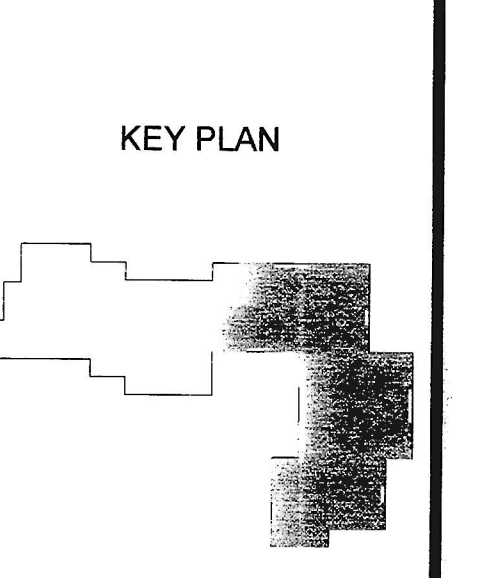

HOFMANN ASSOCIATES, INC.
 606 Baltimore Ave.
 Suite 102
 Towson, Maryland 21204
 410.828.9090
 fax 410.828.4433

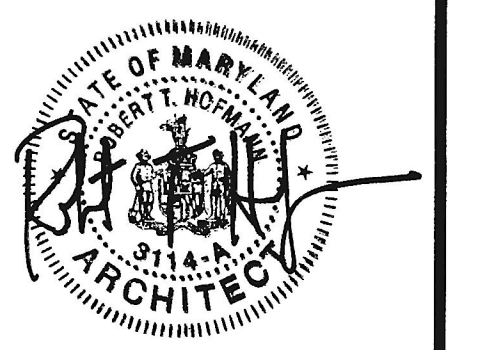

PROJECT NAME:
CHIRON EXPANSION
 6410 DOBBIN ROAD
 MANAGER/DEVELOPER/OWNER:
A.M.B.

ISSUE DATE	
02/16/10	PERMIT SET
02-17-10	REVISION
05-6-10	COUNTY COMMENTS

THE CONCEPTS, IDEAS, DESIGNS AND IMAGES ARE INTENDED ONLY FOR THE PROJECT SPECIFIED ON THIS SHEET AND ARE THE SOLE PROPERTY OF HOFMANN ASSOCIATES, INC. THEY ARE NOT TO BE REPRODUCED OR USED BY OTHERS WITHOUT WRITTEN PERMISSION BY HOFMANN ASSOCIATES, INC.

SCHEDULES, NOTES & DETAILS

A 3

RECEIVED
 MAY 7 2010
 LICENSES & PERMITS DIVISION

project no.: 10-16

SYMBOLOLOGY:

- Ⓝ DUPLEX RECEPTACLE - WALL MTD. - NEW
- Ⓧ DUPLEX RECEPTACLE - WALL MTD. - DEDICATED
- Ⓦ DOUBLE DUPLEX (QUAD) RECEPTACLE - WALL MTD. - EXIST.
- Ⓟ INFEEED FOR SYSTEM FURNITURE - WALL MTD.
- Ⓠ INFEEED FOR SYSTEM FURNITURE - POWER POLE
- Ⓡ EXIT LIGHT
- Ⓢ EMERGENCY LIGHT
- Ⓣ EXIT / EMERGENCY LIGHT
- Ⓤ REM. / RELOC. EXIST. 24" x 48" FLUORESCENT LIGHT FIXTURE
- Ⓥ EXIST. 24" x 48" FLUORESCENT LIGHT FIXTURE
- Ⓦ NEW / RELOC. 24" x 48" FLUORESCENT LIGHT FIXTURE
- Ⓧ PARTITION TYPE - SEE PARTITION SCHEDULE
- Ⓨ DOOR DESIGNATION - SEE DOOR SCHEDULE
- Ⓩ GLASS DESIGNATION - SEE GLASS SCHEDULE
- ⓐ FINISH DESIGNATION - SEE FINISH SCHEDULE
- ▭ EXISTING CONSTRUCTION TO BE REMOVED
- ▭ EXISTING CONSTRUCTION
- ▭ NEW CONSTRUCTION
- ▭ NEW DOOR HEADER
- ▭ EXISTING FULL HEIGHT PARTITION
- ▭ NEW FULL HEIGHT PARTITION

FINISH SCHEDULE:

FLOOR	BASE	WALLS
F-1 NEW LEVEL LOOP 2Goz. NYLON SOLUTION DYE DIRECT GLUE DOWN AS SELECTED BY TENANT.	4" VINYL COVE BASE BY JOHNSONITE OR EQUAL AS SELECTED BY TENANT.	PAINT W/ (2) COATS TO MATCH EXISTING SPACE
F-2 EXISTING 12"x12" V.C.T. TO BE CLEANED	EXISTING TO REMAIN	PAINT W/ (2) COATS TO MATCH EXISTING SPACE
F-3 NEW PIGMENTED FLOOR TO MATCH EXISTING	TO MATCH EXISTING	PAINT W/ (2) COATS TO MATCH EXISTING SPACE
F-4 NEWPATCH PIGMENTED FLOOR TO MATCH EXISTING AS REQUIRED IN AREAS WERE PARTITIONS ARE BEING REMOVED OR CONSTRUCTED	TO MATCH EXISTING	PAINT W/ (2) COATS TO MATCH EXISTING SPACE.
F-5 EXISTING TO REMAIN	EXISTING TO REMAIN	EXISTING TO REMAIN
F-6 NEW 12"x12" V.C.T. AS SELECTED BY TENANT	4" VINYL COVE BASE BY JOHNSONITE OR EQUAL AS SELECTED BY TENANT.	PAINT W/ (2) COATS TO MATCH EXISTING SPACE

- GENERAL NOTES:
- REPLACE ALL DAMAGED WINDOW BLINDS.
 - PROVIDE ALLOWANCE FOR (04) FIRE EXTINGUISHERS THROUGHOUT OFFICE.

FLOOR COVERING SPECIFICATIONS

- RESILIENT FLOORING (V.C.T.)
- VINYL COMPOSITION TILE TO CONFORM TO FS 55-T-312, TYPE IV.
 - SIZE 12" X 12" X 1/8" GAUGE UNLESS OTHERWISE INDICATED.
 - ARMSTRONG "EXCELLON", AZROCK OR APPROVED EQUAL.
 - SUPPLY RESILIENT TRANSITION STRIP NOT LESS THAN 1" WIDE, MADE OF RUBBER, VINYL, OR METAL.
 - LAY TILE FROM CENTER MARKS ESTABLISHED WITH PRINCIPAL WALLS. ADJUST TO AVOID USE OF CUT PIECES LESS THAN 1/2 TILE WIDTH AT PERIMETER.
- VINYL WALL BASE
- TO CONFORM TO FS 55-W-40, 4" HIGH, 0.080" GAUGE WITH MATCHING STOPS AND PERFORMED CORNER UNITS; STANDARD TOP SET COVE, UNLESS OTHERWISE NOTED.
 - ARMSTRONG, JOHNSONITE, NAPCO OR APPROVED EQUAL.
 - APPLY IN THE LONGEST LENGTHS PRACTICABLE FROM 120' ROLL STOCK.
 - THE ONLY APPROVED JOINT IS A "BUTT JOINT".

- CARPET
- CARPET SHALL BE A MINIMUM OF 26 OZ. COMMERCIAL CARPET SOLUTION DYED NYLON OF TEXTURED LOOP CONSTRUCTION WITH A WOVEN POLYPROPYLENE BACKING.
 - FLAMMABILITY: PASS PILL TEST ASTM D 2859 (D) C FF-1-70.
 - ALL CARPET SHALL MEET THE MINIMUM ADA STANDARDS FOR STATIC COEFFICIENT OF FRICTION OF 0.6 FOR ACCESSIBLE ROUTES.
 - SMOKE TEST DENSITY OF 450 OR LESS, NFPA 258.
 - INSTALLATION SHALL BE FULL CONTACT ONLY.

GENERAL NOTES:

- CONTRACTOR IS RESPONSIBLE & LIABLE FOR THE SAFETY & PROTECTION OF SITE, PROJECT WORKMEN, SC'S, THE PUBLIC, & PUBLIC PROPERTY AGAINST INJURY OR DAMAGE OF ANY TYPE FROM ANY CAUSE UNTIL FINAL ACCEPTANCE OF PROJECT. HE / SHE SHALL CARRY INSURANCE TO FULLY PROTECT HIS / HER INTERESTS & THOSE OF THE OWNER.
- ALL WORK SHALL CONFORM TO LOCAL BUILDING CODES & REGULATIONS, & SHALL BE INSTALLED ACCORDING TO THE JOINT REQUIREMENTS & DECISIONS OF ALL LOCAL AUTHORITIES.
- ALL WOOD MEMBERS SHALL BE FLAME RETARDANT.
- FLAME SPREAD RATING OF 75 OR LESS FOR INTERIOR FINISHES.
- HANDICAPPED POWDER ROOM (H.C.) INSTALL PER A.N.S.I. AND A.D.A. REQUIRED GRAB BARS, FIXTURES, & ACCESSORIES. SEE HANDICAPPED ACCESSIBILITY STANDARDS.
- PROVIDE PORTABLE FIRE EXTINGUISHERS AS PER N.F.P.A. 10, N.F.P.A. 101 IN OFFICE AREA & WAREHOUSE AREA.
- PROVIDE APPROVED BATTERY POWERED EMERGENCY LIGHTING.
- EMERGENCY LIGHTING UNITS ARE TO BE WIRED INTO THE NORMAL LIGHTING CIRCUIT & ARRANGED AS TO PROVIDE THE REQUIRED ILLUMINATION AUTOMATICALLY IN THE EVENT OF ANY INTERRUPTION OF NORMAL LIGHTING, SUCH AS ANY FAILURE OF PUBLIC UTILITY OR OUTSIDE ELECTRICAL POWER SUPPLY, OPENING OF A CIRCUIT BREAKER OR FUSE OR ANY MANUAL ACT(S) INCLUDING ACCIDENTAL OPENING OF A SWITCH CONTROLLING NORMAL LIGHTING FACILITIES.
- EXIT DOOR LOCKS, IF PROVIDED, SHALL NOT REQUIRE THE USE OF A KEY, TOOL, SPECIAL KNOWLEDGE, OR EFFORT FOR OPERATION WITHIN THE BUILDING PER 5-2.1.5.1, 101.
- H.V.A.C. SHALL COMPLY WITH THE DUCT DETECTING PROVISIONS OF SECTION 4-3 & 4-5 OF N.F.P.A. 90-A.
- ALL COUNTERTOP INSTALLATIONS SHALL COMPLY WITH A.D.A. REQUIREMENTS FOR HEIGHT & ACCESSIBILITY.
- CONTRACTOR TO FOLLOW MANUFACTURERS SPECIFICATIONS FOR EQUIPMENT & FINISHES.
- CONTRACTOR TO OBTAIN BUILDING PERMIT & PREPARE NECESSARY PLUMBING, MECHANICAL, & ELECTRICAL PLANS NEEDED FOR BUILDING PERMIT.
- CONTRACTOR TO OBTAIN SPRINKLER PERMIT & PREPARE ALL PLANS.
- CONTRACTOR TO PROVIDE SUPPORTS FOR ALL HVAC EQUIPMENT & ALL ROOF OPENINGS GREATER THAN 6"x6". SEE MECHANICAL / ELECTRICAL DRAWINGS FOR UNIT SIZE & LOCATION. SEE DTL/T01.4 FOR SUPPORT DETAIL.

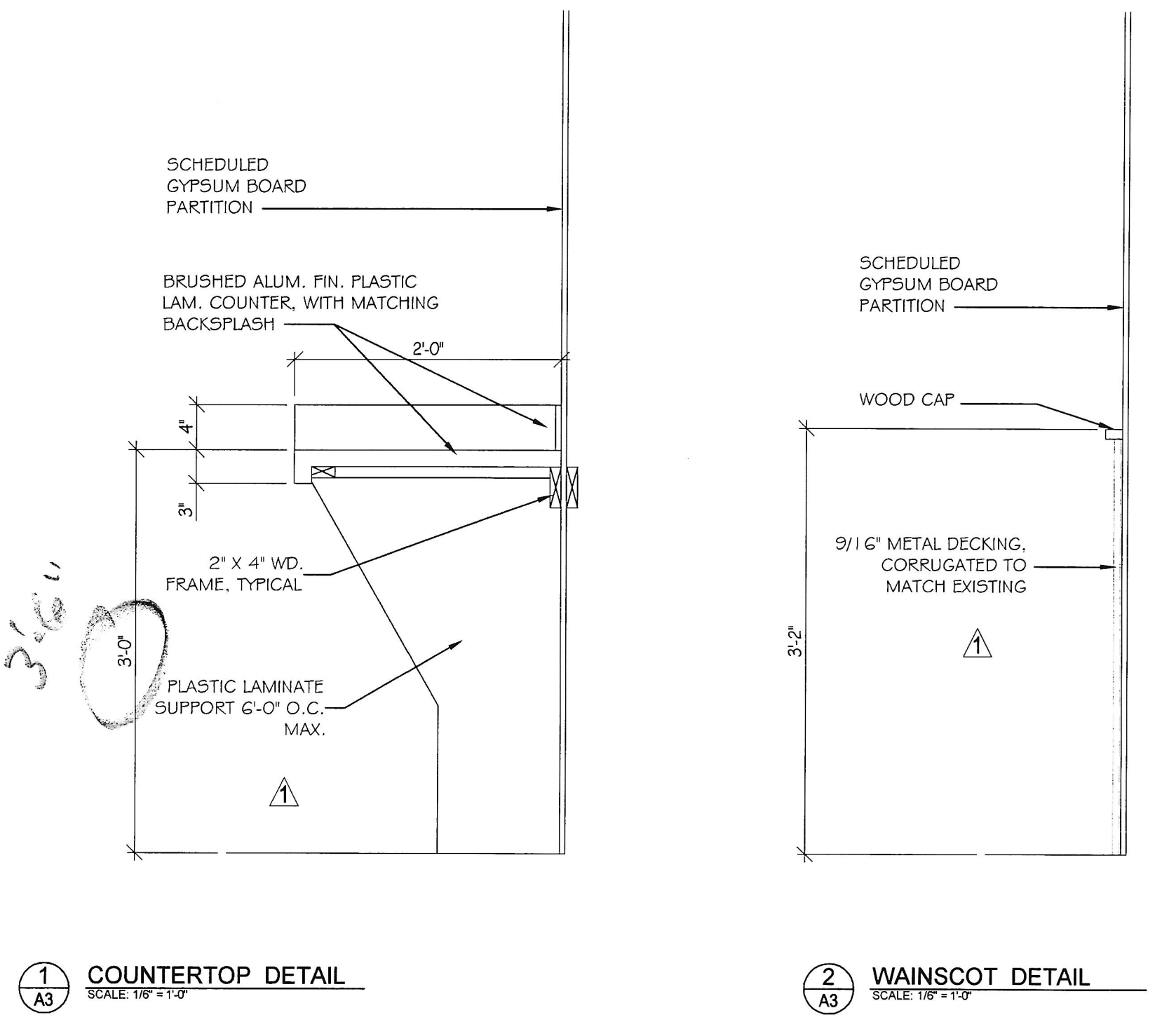

DOOR & GLASS SCHEDULE:

- ALL FRAMES ARE 2" KNOCK DOWN HOLLOW METAL UNLESS NOTED OTHERWISE
- ALL MULLIONS ARE 2" UNLESS NOTED OTHERWISE
- IF EXISTING DOORS CAN NOT BE REUSED THEN NEW DOORS TO MATCH EXISTING
- ALL EXISTING HARDWARE TO BE REPLACED WITH LEVER HANDLE A.D.A. APPROVED
- ALL NEW HARDWARE TO BE LEVER HANDLE A.D.A. APPROVED
- TENANT TO REVIEW & APPROVE HARDWARE SCHEDULE.

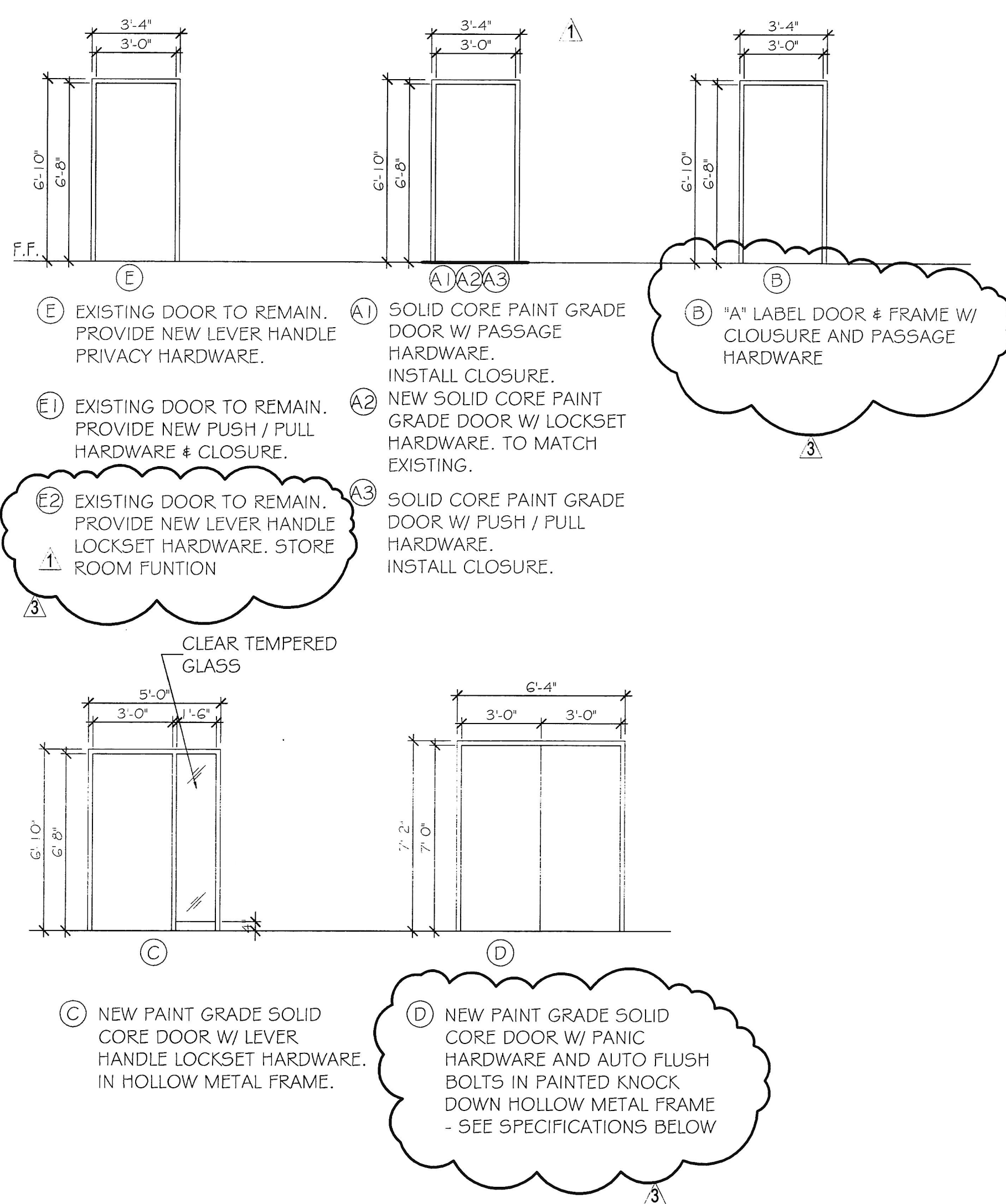

DOOR SPECIFICATIONS:

- HARDWARE GENERAL NOTES:**
- ALL DOOR HINGES TO BE STAINLESS STEEL, BALL BEARING, FULL MORTISE TYPE.
 - ALL EXTERIOR DOORS TO HAVE ALUMINUM THRESHOLD, FULL WEATHER STRIPPING, & DRIP CAP. SERVICE AS REQ'D.
 - ALL METAL DOOR FRAMES TO BE PROVIDED W/ SILENCERS.
 - ALL CYLINDRICAL LOCK SETS & LATCH SETS TO BE COMMERCIAL GRADE, LEVER HANDLED HARDWARE.
 - ALL DOORS TO BE PROVIDED W/ COMMERCIAL GRADE LEVER HANDLED HARDWARE, A.D.A. APPROVED W/ SATIN FINISH.
 - ALL INTERIOR DOORS TO BE PROVIDED W/ COMMERCIAL GRADE WALL MOUNTED FLOOR STOPS.
 - ALL INTERIOR WOODEN DOORS TO BE STAIN GRADE IN KNOCKDOWN HOLLOW METAL FRAMES.
 - MANUALLY OPERATED FLUSH BOLTS ARE NOT PERMITTED.
- HARDWARE SPECIFICATIONS:**
- PANIC BAR HARDWARE TO BE "YALE #7200M".
 - PUSH / PULL HARDWARE TO BE YALE OR APPROVED EQUAL.
 - PASSAGE HARDWARE TO BE "YALE #4301LN, STYLE: MONROE" OR APPROVED EQUAL.
 - PRIVACY HARDWARE TO BE "YALE #4302LN, STYLE: MONROE" OR APPROVED EQUAL.
 - LOCKSET HARDWARE TO BE "YALE #4307LN, STYLE: MONROE" OR APPROVED EQUAL.
 - DOOR CLOSURES TO BE "YALE #400 SERIES".

PARTITION SCHEDULE:

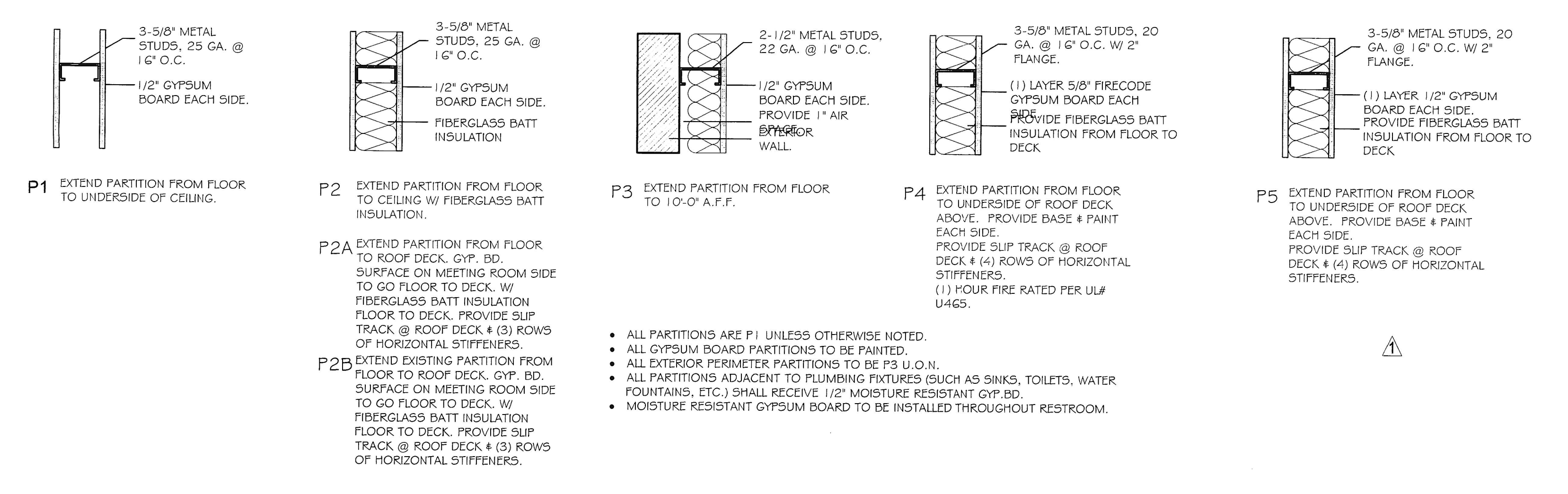

- ALL PARTITIONS ARE P1 UNLESS OTHERWISE NOTED.
- ALL GYPSUM BOARD PARTITIONS TO BE PAINTED.
- ALL EXTERIOR PERIMETER PARTITIONS TO BE FS U.O.N.
- ALL PARTITIONS ADJACENT TO PLUMBING FIXTURES (SUCH AS SINKS, TOILETS, WATER FOUNTAINS, ETC.) SHALL RECEIVE 1/2" MOISTURE RESISTANT GYP.BD.
- MOISTURE RESISTANT GYPSUM BOARD TO BE INSTALLED THROUGHOUT RESTROOM.