

**REFLECTED CEILING LEGEND**

- ACT TYPE I (TYPICAL)  
2 X 4 LAY-IN US6 INTERIORS, SQUARE EDGE, MATCH EXISTING
- ACT TYPE II  
2 X 2 LAY-IN US6 INTERIORS, SQUARE EDGE, MATCH EXISTING
- ACT TYPE III  
2 X 4 LAY-IN US6 INTERIORS, VINYL FACED WITH ALUMINUM GRID
- ACT TYPE IV  
2 X 2 LAY-IN US6 INTERIORS, VINYL FACED WITH ALUMINUM GRID
- ACT TYPE V  
2 X 2 LAY-IN ARMSTRONG "WOODWORKS"
- 5" DIA. RECESSED LED DOWNLIGHT
- EXISTING FLUORESCENT DOWNLIGHT
- 2" X 2" LED LAY-IN, ACRYLIC LENS
- EXISTING 2" X 2" FLUORESCENT LAY-IN W/ ELECTRONIC BALLAST, ACRYLIC LENS
- 2" X 4" LED LAY-IN, ACRYLIC LENS
- EXISTING 2" X 4" FLUORESCENT LAY-IN W/ ELECTRONIC BALLAST, ACRYLIC LENS
- 1" X 4" LED SURFACE-MOUNTED ACRYLIC LENS
- EXISTING FLUORESCENT SURFACE-MOUNTED ACRYLIC LENS
- WALL MOUNTED STRIP LIGHT

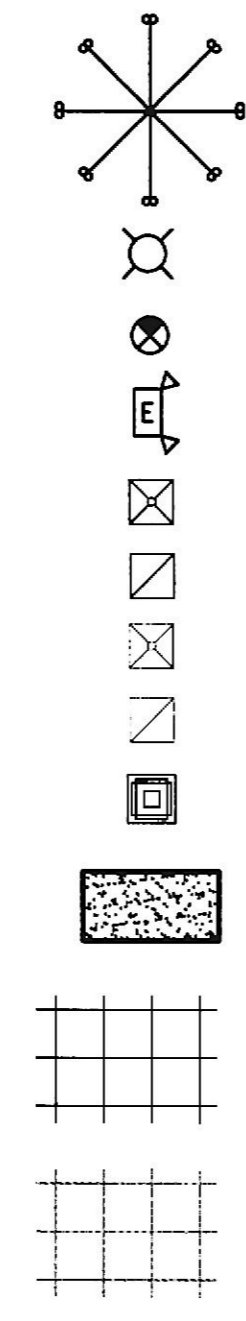

- CHANDELIER AS SELECTED BY OWNER
- 5" LED DOWN LIGHT
- EXIT SIGN
- EMERGENCY LIGHT
- SUPPLY DIFFUSER, SEE MECH FOR SIZES
- RETURN DIFFUSER, SEE MECH FOR SIZES
- EXISTING SUPPLY DIFFUSER
- EXISTING RETURN DIFFUSER
- CEILING MOUNTED UNIT HEATER
- 6"6" CEILING
- CEILING GRID
- EXISTING CEILING GRID

**RCP NOTES:**

1. ALL ACT AND GRID SHALL BE SYMMETRICALLY LOCATED IN ROOM. AVOID ACT PANELS LESS THAN 3" WIDE.
2. TYPICAL PARTITION HEIGHT EXTENDS TO 8" ABOVE FINISHED CEILING.
3. CORRIDOR PARTITIONS AND PARTITIONS INDICATED THIS SHALL EXTEND TO THE UNDERSIDE OF THE CEILING MEMBRANE, TO CONTAIN THE TRANSFER OF SMOKE.
4. PARTITIONS INDICATED THIS SHALL EXTEND FULL HEIGHT TO THE UNDERSIDE OF THE ROOF DECK TO FORM A SMOKE BARRIER WITH A 1 HR. RATING AND 45 MIN. DOORS.
5. PARTITIONS INDICATED THIS SHALL EXTEND FULL HEIGHT TO THE UNDERSIDE OF THE ROOF DECK TO FORM A SMOKE BARRIER WITH A 2 HR. RATING AND 45 MIN. DOORS.
6. TYPICAL ACT CEILING IS 9'-0" AFF.
7. TYPICAL ACT CEILING IS 9'-0" AFF.
8. 1/2" 6"6" CEILING APPLIED TO UNDERSIDE OF ROOF TRUSSES THROUGH-OUT, TAPE AND SPACKLE PAINT ALL EXPOSED AREAS.
9. APPLY (2) LAYERS OF 5/8" TYPE "X" 6"6" AT CEILING IN ALL FIRE RATED ROOMS. SEE LIFE SAFETY PLAN SHEET AG1.
10. TYPICAL CORRIDOR ACT CEILING IS 8'-0" AFF.
11. 5/8" TYPE "X" 6"6" CEILING APPLIED TO UNDERSIDE OF HANERO JOIST JOISTS
12. SUSPENDED LIGHT FIXTURES AND MECHANICAL DEVICES INDEPENDENTLY OF CEILING SUSPENSION
- B. 2. ATTIC ACCESS PANEL, SEE DETAIL R / AS1. COORDINATE LOCATION WITH MECHANICAL DUCTWORK AND PRE-FAB FRIT TRUSSES

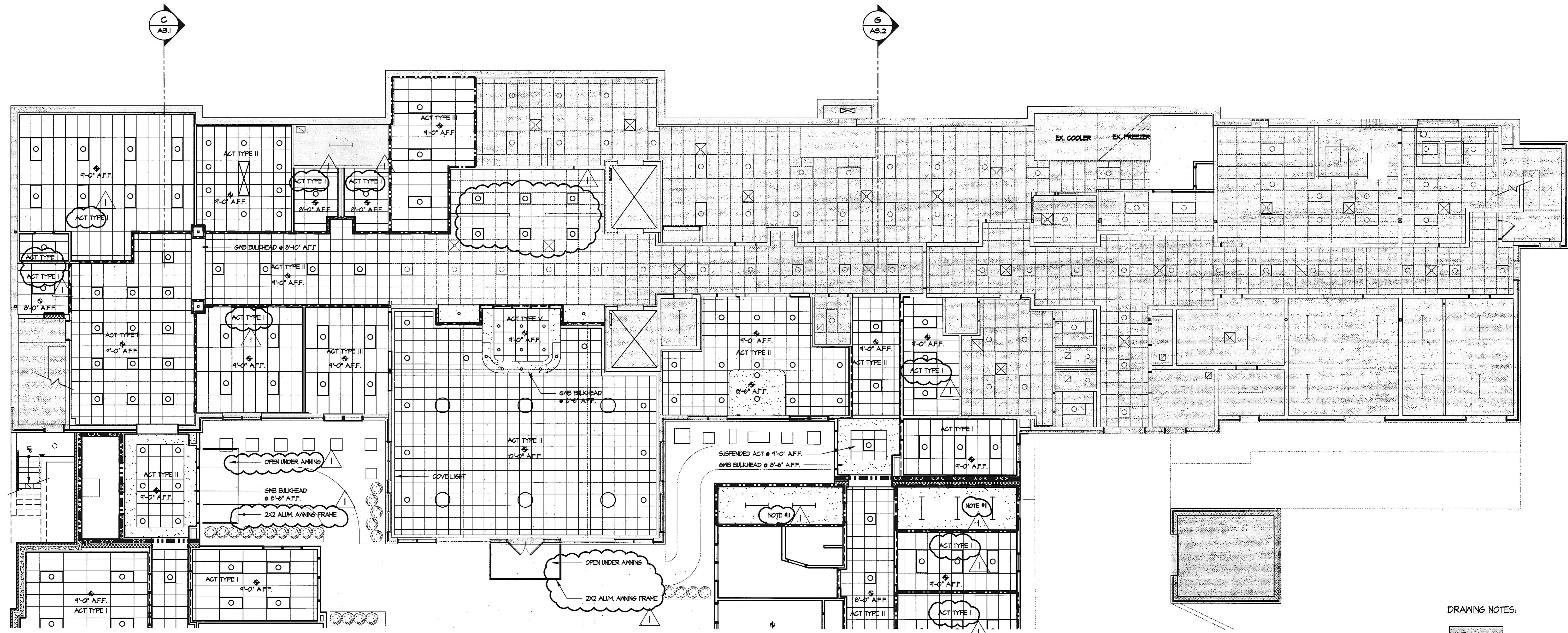

**DRAWING NOTES:**

- EXISTING NO WORK
- EXISTING - RENOVATION

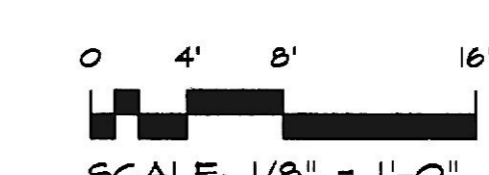
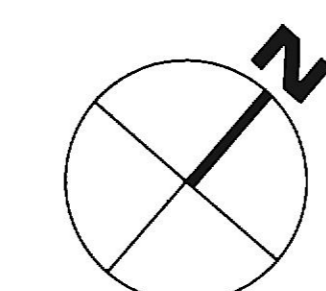

**KEY PLAN**  
1/64" = 1'-0"

REVISIONS	BY

1/26/14 PERMIT JLS  
REVISION COMMENTS

Professional Certification  
I certify that these documents were prepared or approved by me, and that I am duly licensed architect under the laws of the State of Maryland, license number 2002 A, expiration date February 25, 2020.

**Lorien Nursing - Elkridge Addition**  
 7615 Washington Blvd  
 Elkridge, Maryland 21075

**GROUND FLOOR NEW WORK CEILING PLAN**

DATE: April 4, 2019  
 SCALE: 1/8" = 1'-0"  
 DRAWN:  
 JOB:  
 SHEET: **A1.10**  
 OF SHEETS