

2ND FLOOR ICF WALLS:

11" ICF WITH 6" CONCRETE CORE

**#4 VERTICAL REBAR AT 16" OC #5 HORIZONTAL REBAR AT 16" OC
3500 PSI CONCRETE PEA GRAVEL WITH HIGH RANGE OR PLASTIZIER
MAXIMUM SLUMP 8"**

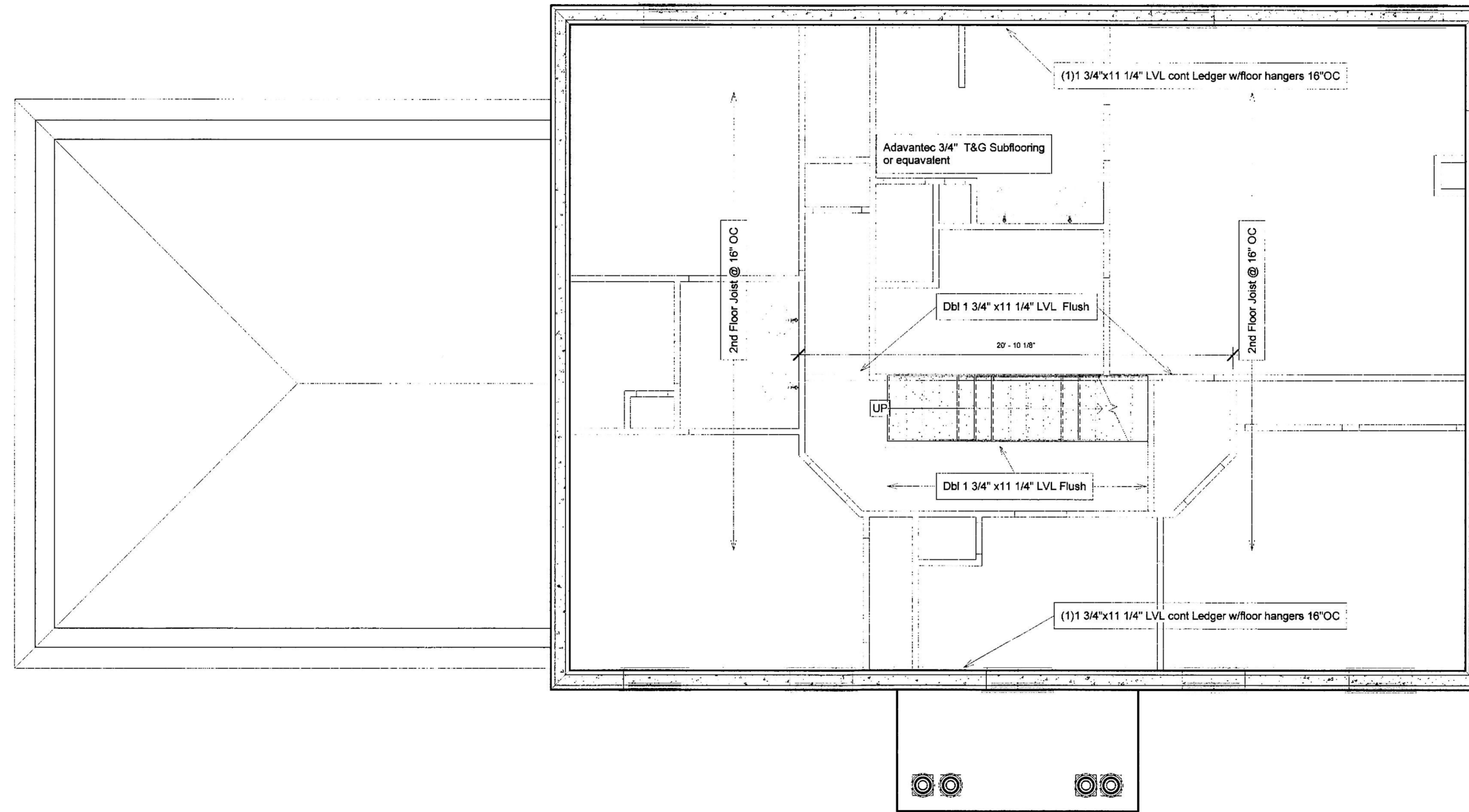

① 005b-Second Floor Framing
1/4" = 1'-0"

GNP Inc
AutoCAD
REVIT
Drawings

ICF CONSTRUCTION
1-800-713-7663
MID-ATLANTIC REGION



www.gnphouse.com

RESIDENCE FOR:
THORNE RESIDENCE
21629 Keeney Rd
Parkton, Maryland 21120



Owner	
Project Name	
2nd Floor Framing	
Project number	2021-572
Date	2-3-2021
Drawn by	Author
Checked by	Checker
S-103	
Scale	1/4" = 1'-0"