

**CEILING NOTATION**

**NOTE #1**  
RATED GMB CEILING  
Maintain 1-hour rating UL design #L501 attach 5/8" type "X" GMB directly to existing joist. Shim as required to remain flat. Duct or lighting penetrations require fire dampers and lighting penetrations require tenting for fixtures.

**NOTE #2**  
RATED, SUSPENDED GMB CEILING  
Maintain UL design for suspended GMB ceiling. Suspend rated metal framing and attach 5/8" GMB type "X". Duct penetrations require fire dampers and lighting penetrations require tenting.

**NOTE #3**  
UNRATED LAY-IN CEILING  
Install lay-in ceiling - 2'x. 4' See specification.

**NOTE #4**  
UNRATED - SUSPENDED GMB CEILING  
Install suspended GMB ceiling. No fire rating required. Install 1/2" GMB to metal hat section and black iron.

**NOTE #5**  
EXISTING SKYLIGHT AND MONITOR  
Existing skylight to remain. Remove existing wall board. Insulate throat and sloped ceiling with R-19 batt insulation with vapor barrier. Install 1/2" GMB, furr as required. Check skylight for leakage, see roof plan for additional notation.

**NOTE #6**  
GMB CEILING  
Attach 1/2" GMB with foil back vapor barrier directly to existing framing. Add framing as required. Shim or use furring. Channel to maintain level condition.

**NOTE #7**  
INSULATION  
Install continuous layer of fiberglass batt insulation R-30 to entire roof area. Maintain tight butted condition throughout. ALL DUCT WORK TO BE UNDER INSULATION.

**NOTE #8**  
LAYERS ON NORTHERN SIDE TO EXISTING PLASTER CEILING  
Patch and repair existing plaster and wood lath ceiling. Salvage center medallion and existing moldings. Clean, scale, prime and paint. All wiring to be fished thru joist.

**GENERAL NOTES**

- Maintain fire rating for 1-hour fire separation between the basement and first floor.
- Install all ceilings at elevations shown. Extend ductwork and fixtures up between joist to maintain levels shown. Variations from locations indicated due to existing framing must be verified with the architect.
- All surfaces to be painted excluding lay-in ceilings.

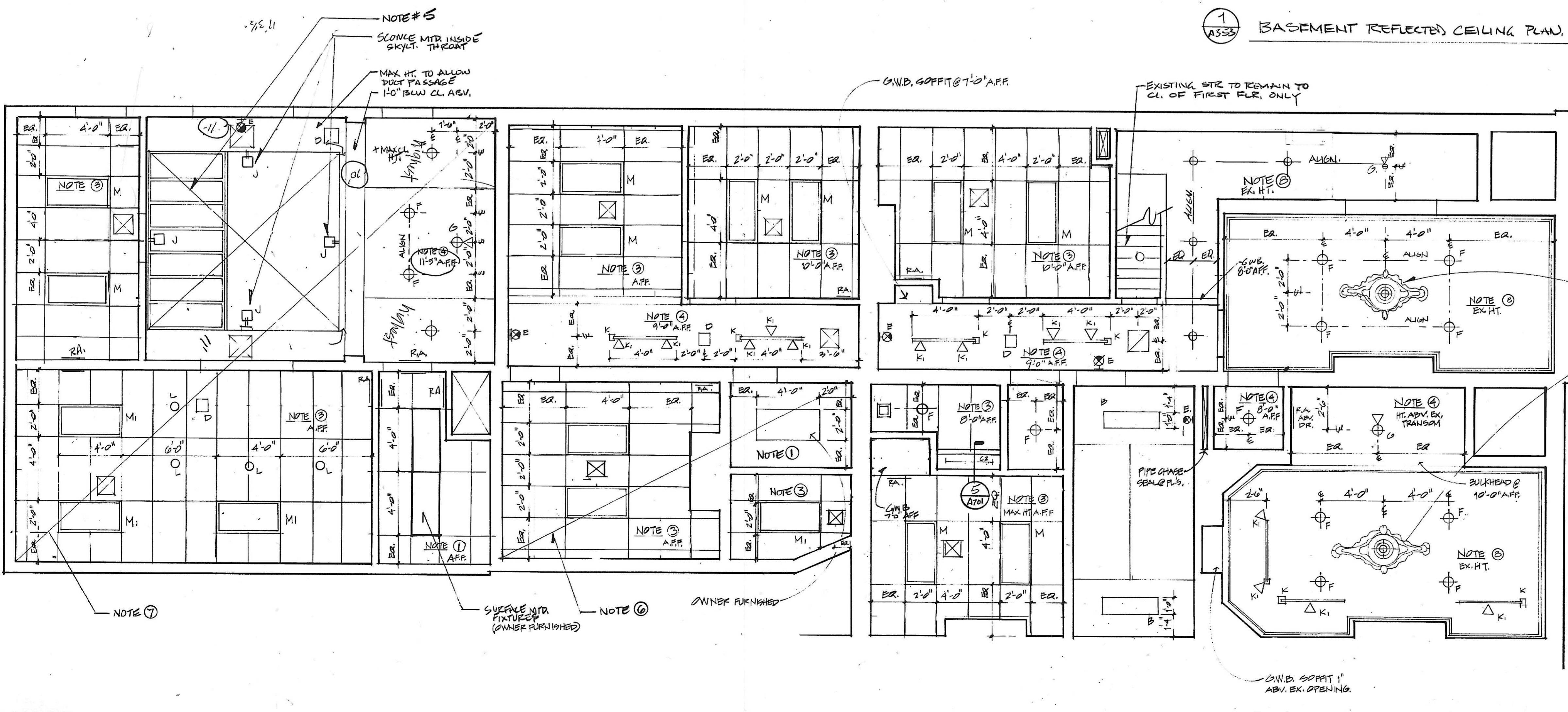

**NOTE #5**  
SLANCE MTD INSIDE SKYLIT.  
MAX. HT. TO ALLOW DUCT PASSAGE 1'-0" BELOW CL. ABOVE.

**NOTE #6**  
SURFACE MTD FIXTURES (OWNER FURNISHED)

**NOTE #7**  
OWNER FURNISHED 2x4-LAMP SURFACE FIXTURE (TYPE)

**NOTE #8**  
EX. PLASTER MEDALLION TO REMAIN - REPLACE SKYLIGHT.

**NOTE #9**  
GMB SOFFIT 1" ABOVE EX. OPENING.

NO.	DATE	DESCRIPTION
REVISIONS		

**Cho Wilks & Benn**  
218 West Saratoga Street  
Baltimore, Maryland 21201  
(301) 576-0440  
ARCHITECTS

**MARYLAND institute**

DRAWN BY: JGM      CHECKED BY:      DATE: 8-11-89

**Reflected Ceiling Plan**  
**ALTERNATE #2**  
**Basement & Contract**  
**First Floors**

PROJECT NO.: 1110      SHEET NO.:  
SCALE: 1/8" = 1'-0"  
DATE: 8-11-89  
LATEST REV: 8-11-89

**A-353**

**ALTERNATE #2**