

- GENERAL NOTES: AIR DISTRIBUTION**
- A. CONTRACTOR RESPONSIBLE FOR LOCATING ALL HORIZONTAL UNITS CONCEALED ABOVE THE CEILING SO THAT ALL REQUIRED CLEARANCES ARE MAINTAINED AND COORDINATED WITH ALL TRADES.
 - B. CONTRACTOR RESPONSIBLE FOR LOCATING ALL DAMPERS IN DUCTWORK SO THAT ACCESSIBILITY IS MAINTAINED. COORDINATE WITH CEILING SYSTEM.
 - C. PROVIDE A HIGH EFFICIENCY TAKE-OFF AND VOLUME DAMPER AT EACH GRILLE, REGISTER, AND DIFFUSER BRANCH RUNOUT. REFER TO THE DETAIL ON SHEET M600 FOR SPECIFIC REQUIREMENTS.
 - D. NO DUCTWORK TO BE ROUTED OVER ELECTRICAL PANELS/TRANSFORMERS. REFER TO ELECTRICAL PLANS FOR EQUIPMENT LOCATIONS.
 - E. REFER TO VERTICAL UNIT INSTALLATION DETAIL ON SHEET M801 FOR SPECIFIC REQUIREMENTS.
 - F. REFER TO EXHAUST/RETURN AIR CANOPY DETAIL ON SHEET M600 FOR ADDITIONAL INFORMATION FOR E-6/R-6 GRILLES.
 - G. REFER TO CEILING CASSETTE INSTALLATION DETAIL ON SHEET M801 FOR SPECIFIC REQUIREMENTS. APPLIES TO 3'X3' CASSETTES.

- KEYNOTES**
- R1 EXHAUST FAN INSTALLED ON 18" TALL CURB. TRANSITION DUCTWORK TO FAN OPENING AS REQUIRED.
 - R5 PROVIDE DUCT SUPPORTS 5'-0" ON CENTER. DUCT SUPPORTS SHALL BE COOPER, B-LINE, MODEL C-SERIES OR EQUAL.
 - R10 DUCTWORK CONTINUES INTO GYMNASIUM. REFER TO SHEET M107 FOR CONTINUATION.
 - R11 DUCTWORK DOWN TO FLOOR BELOW. REFER TO SHEET M117 FOR CONTINUATION.

VMDO

10411 Meeting Street
Prospect, Kentucky 40059
502.326.3965 • f 502.326.3691
www.vmdo.com

centa
MECHANICAL ENGINEERS

10411 Meeting Street
Prospect, Kentucky 40059
502.326.3965 • f 502.326.3691
www.centaegr.com

Catholic Diocese of Arlington
Liturgical and Parish Planning

PAUL VI CATHOLIC HIGH SCHOOL

CATHOLIC DIOCESE OF ARLINGTON
200 North Glebe Road
Arlington, VA 22203
Loudoun County ZOPA Number 2016-XXXX
VMDO Project Number 15.1188

Checked By DRH
Drawn By CMG

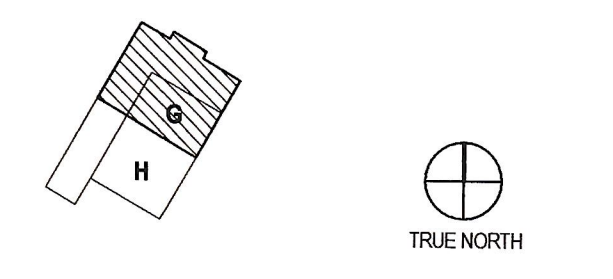
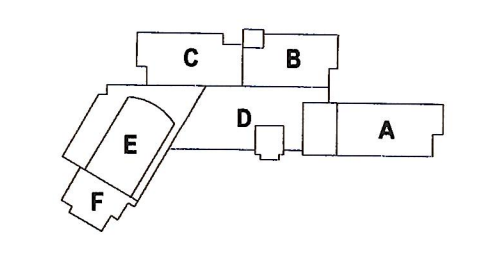

DRAWING NOT FOR CONSTRUCTION

ISSUES AND REVISIONS	
NO. SUBMITTAL	DATE
PERMIT SET	01.31.17

ROOF PLAN AREA G - MECHANICAL

M147

1 ROOF PLAN AREA G - MECHANICAL
1/8" = 1'-0"