

GENERAL NOTES: ROOF

- A. MAINTAIN ALL MANUFACTURER'S CLEARANCES ON ALL EQUIPMENT.
- B. SPILL UNIT CONDENSATE TO NEAREST ROOF DRAIN. SIZE CONDENSATE PIPE PER MANUFACTURER'S RECOMMENDATIONS.
- C. REFER TO SHEETS M403 AND M404 FOR ROOFTOP UNIT DETAILS.

KEYNOTES

- M1 EXHAUST FAN INSTALLED ON 18" TALL CURB. TRANSITION DUCTWORK TO FAN OPENING AS REQUIRED.
- M2 MAKE-UP AIR UNIT INSTALLED ON A FULL PERIMETER CURB. ROUTE THE REFRIGERANT PIPING DOWN THROUGH A NEW ROOF CURB/PIPING PORTAL. PROVIDE A ROOF PRODUCTS MODEL RPPS-80 ROOF CURB WITH PIPE CHASE. REFER TO THE PIPE PORTAL DETAIL ON SHEET M602 FOR ADDITIONAL INFORMATION. ROOF CURB SHALL BE 3'-0" AWAY FROM CONDENSING UNIT. REFRIGERANT PIPING SHALL BE SUPPORTED BY COOPER B-LINE C-SERIES ROOFTOP SUPPORTS.
- M4 CONDENSING UNIT MOUNTED ON A ROOF CURB. REFER TO DETAIL ON SHEET M602.
- M6 ROOF HYDRANT; REFERENCE PLUMBING DRAWINGS FOR ADDITIONAL DETAIL.
- M12 DUCTWORK DOWN TO FLOOR BELOW. REFER TO SHEET M114 FOR CONTINUATION.
- M13 DUCTWORK DOWN TO FLOOR BELOW. REFER TO SHEET M124 FOR CONTINUATION.
- M14 DUCTWORK DOWN TO FLOOR BELOW. REFER TO SHEET M115 FOR CONTINUATION.

VMDO

VMDO Architects
270 E. Wilson Street
Charlottesville, VA 22902
813.296.5881
vmvdo.com



10411 Meeting Street
Prophet, Kentucky 40059
502.326.3085 • F 502.326.2691
www.cmtaengr.com



PAUL VI CATHOLIC HIGH SCHOOL

CATHOLIC DIOCESE OF ARLINGTON
200 North Glebe Road
Arlington, VA 22203
Loudoun County ZCPA Number 2016-0005
VMDO Project Number 15.1188



Checked By DRH
Drawn By CMG

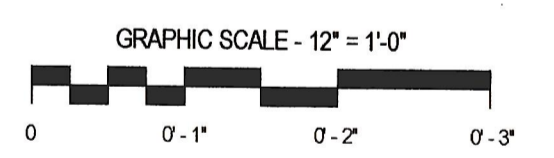
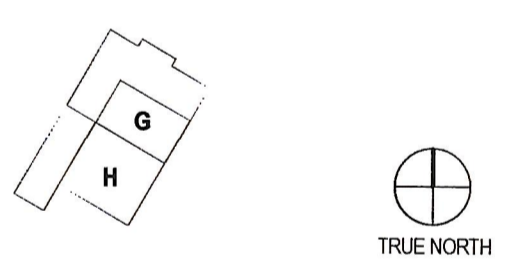
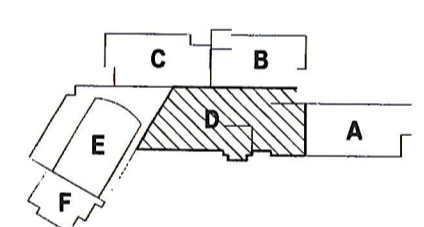

ISSUES AND REVISIONS	DATE
NO. SUBMITTAL	

ROOF PLAN - AREA D - MECHANICAL

M304

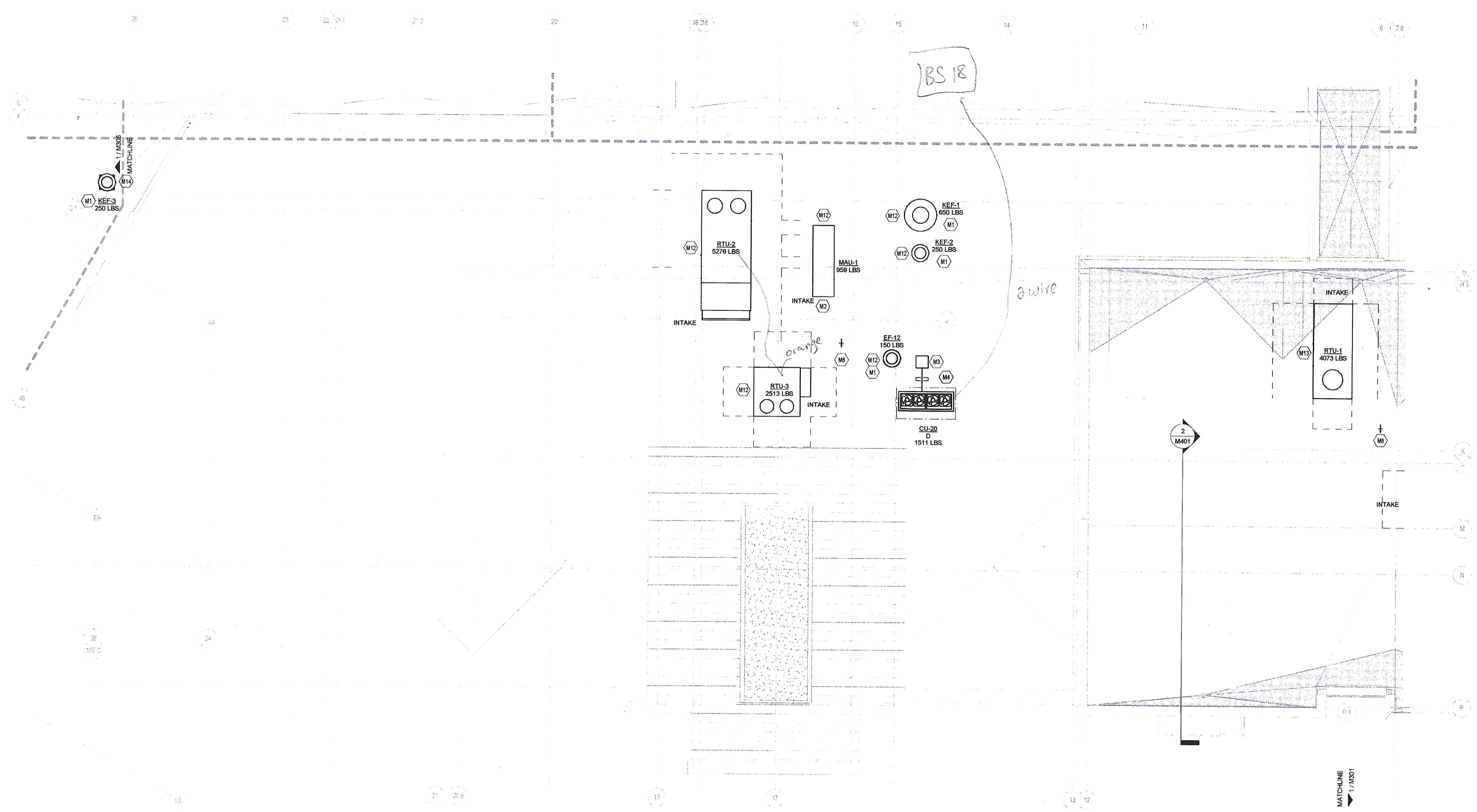

1 ROOF - MECHANICAL - AREA D
1/8" = 1'-0"