



10411 Meeting Street
Prospect, Kentucky 40059
502.326.3085 • f 502.326.2691
www.cmtaeng.com



PAUL VI CATHOLIC HIGH SCHOOL

CATHOLIC DIOCESE OF ARLINGTON
200 North Glebe Road
Arlington, VA 22203

Loudoun County ZCPA Number 2016-0005
VMDO Project Number 15.1188

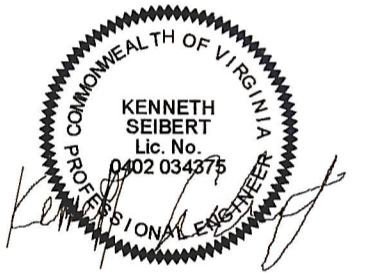

Checked By DRH
Drawn By CMG

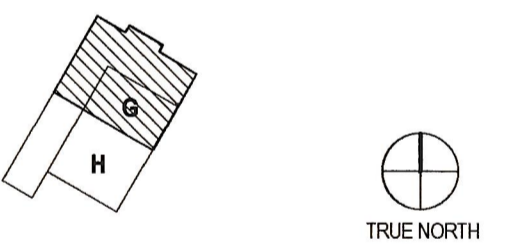
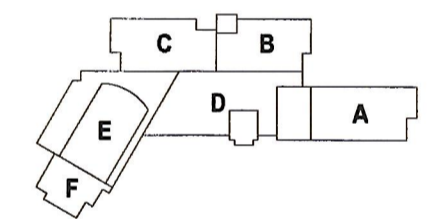

GRAPHIC SCALE - 12" = 1'-0"
0 0'-1" 0'-2" 0'-3"

NO.	SUBMITTAL	DATE
1	ADDENDUM #1	03.31.17

ROOF PLAN - AREA G - MECHANICAL

- GENERAL NOTES: ROOF**
- MAINTAIN ALL MANUFACTURER'S CLEARANCES ON ALL EQUIPMENT.
 - SPILL UNIT CONDENSATE TO NEAREST ROOF DRAIN. SIZE CONDENSATE PIPE PER MANUFACTURER'S RECOMMENDATIONS.
 - REFER TO SHEETS M403 AND M404 FOR ROOFTOP UNIT DETAILS.

- KEYNOTES**
- EXHAUST FAN INSTALLED ON 18" TALL CURB. TRANSITION DUCTWORK TO FAN OPENING AS REQUIRED.
 - ROUTE THE REFRIGERANT PIPING DOWN THROUGH A NEW ROOF CURB/PIPING PORTAL. PROVIDE A ROOF PRODUCTS MODEL RPPC-80 ROOF CURB WITH PIPE CHASE. REFER TO THE PIPE PORTAL DETAIL ON SHEET M802 FOR ADDITIONAL INFORMATION. ROOF CURB SHALL BE 3'-0" AWAY FROM CONDENSING UNIT. REFRIGERANT PIPING SHALL BE SUPPORTED BY COOPER B-LINE C-SERIES ROOFTOP SUPPORTS.
 - CONDENSING UNIT MOUNTED ON A ROOF CURB. REFER TO DETAIL ON SHEET M802.
 - PROVIDE DUCT SUPPORTS 5'-0" ON CENTER. DUCT SUPPORTS SHALL BE COOPER, B-LINE, MODEL C-SERIES OR EQUAL.
 - TERMINATE UNIT EXHAUST AT LEAST 25'-0" FROM ANY UNITS' OUTSIDE AIR INTAKE. PROVIDE DUCT WITH EPOXY WEATHER COATING AND 1/2" MESH SCREEN.
 - ROOF HYDRANT: REFERENCE PLUMBING DRAWINGS FOR ADDITIONAL DETAIL.
 - DUCTWORK DOWN TO FLOOR BELOW. REFER TO SHEET M117 FOR CONTINUATION.
 - DUCTWORK CONTINUES INTO GYMNASIUM. REFER TO SHEET M117 FOR CONTINUATION.

