

A. BROWN STORAGE REQUIREMENTS
 NOTE: EACH DRAWER OF SYSTEM HAS 34.5G OF FILING CAPACITY

INITIAL INSTALLATION
 (4) 6 DRAWER UNITS X 34.5G = 829.5
 (6) 2 DRAWER UNITS X 34.5G = 415.0
 TOTAL 36 X 34.5G = 1244.5

2ND PHASE GROWTH CAPACITY
 3G INITIAL @ 34.5G = 1244.5
 1G ADDITIONAL @ 34.5G = 553.0
 TOTAL 48 X 34.5G = 1797.5

3RD PHASE GROWTH CAPACITY
 INITIAL AND 2ND PHASE (48) 1797.5
 8 ADDITIONAL @ 34.5G 267.5
 TOTAL 60 X 34.5G 2065.0

IF ADDITIONAL GROWTH IS REQUIRED, WALL 'A' IS MOVABLE

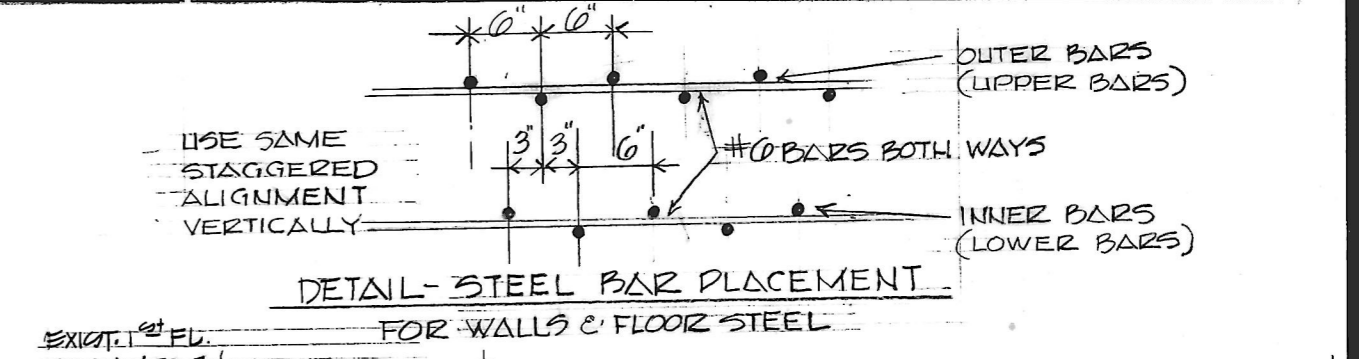

GEN. NOTES

- DEPRESS NEW CONC. TOPPING 3/4" TO ACCOMMODATE CARPET, IN WAITING AREA, RECEPTION COUPON BOOTHS 4, 5, 6, AND COUPON ROOM #7.
- RELOCATE WOOD BUMPERS ON WEST WALL OF STR. 2A, TO MATCH ELEVATIONS OF OTHER BUMPERS.
- SOME FIELD DIMS WERE TAKEN BY ARCHITECT, BUT IT WAS ASSUMED THAT ORIGINAL CONST. WAS BUILT ACCORDING TO PLAN. CHECK ALL DIMENSIONS BEFORE PROCEEDING.

REVISIONS

NO.	DATE	ITEM	REV.
1	APR 26/68	VAULT REVISION	
2	APR 26/68	DRAWING SPACE REV.	
3	APR 26/68	ADD FINISH SCHEDULE	
4	APR 26/68	ADD FINISH SCHEDULE	
5	APR 26/68	ADD FINISH SCHEDULE	
6	JULY 19/68	REVISIONS TO CAMPBELL STORE SPACE	
7	JULY 19/68	DIMENSIONS CHANGED	

FINISH SCHEDULE

SPACE	BASE	FLOOR	N. WALL	S. WALL	E. WALL	W. WALL	PAINT	CEILING
WAITING REC.	VINYL 4	CARPET	PLASTER	PLASTER	PLASTER	PLASTER	1234	ACOUSTIC
COUPON BOOTHS	VINYL 4	CARPET	PLASTER	PLASTER	PLASTER	PLASTER	1234	ACOUSTIC
BOOTH #4	VINYL 4	CARPET	PLASTER	SHT ROCK	SHT ROCK	SHT ROCK	1234	ACOUSTIC
BOOTH #5	VINYL 4	CARPET	PLASTER	SHT ROCK	SHT ROCK	SHT ROCK	1234	ACOUSTIC
BOOTH #6	VINYL 4	CARPET	PLASTER	SHT ROCK	SHT ROCK	SHT ROCK	1234	ACOUSTIC
COUPON ROOM #7	VINYL 4	V.A.T.	PLASTER	PLASTER	PLASTER	PLASTER	1234	ACOUSTIC
MECH. EQUIP.	VINYL 4	V.A.T.	CONC. BK	CONC. BK	CONC. BK	CONC. BK	1234	EX. CONST.
STORAGE RM.	VINYL 4	V.A.T.	CONC. BK	CONC. BK	CONC. BK	CONC. BK	1234	EX. CONST.
SAFE DEPOSIT	VINYL 4	V.A.T.	STEEL	STEEL	STEEL	STEEL	1234	STEEL
BANK SPACE	VINYL 4	V.A.T.	STEEL	STEEL	STEEL	STEEL	1234	STEEL
A. BROWN STOR.	VINYL 4	V.A.T.	STEEL	STEEL	STEEL	STEEL	1234	STEEL
CAMPBELL STOR.	CONC.	CONC.	CONC. BLK.	CONC. BLK.	CONC. BLK.	CONC. BLK.	2,3,4	EX. CONST.

REVISIONS

NO.	DATE	ITEM	REV.
1	APR 26/68	VAULT REVISION	
2	APR 26/68	DRAWING SPACE REV.	
3	APR 26/68	ADD FINISH SCHEDULE	
4	APR 26/68	ADD FINISH SCHEDULE	
5	APR 26/68	ADD FINISH SCHEDULE	
6	JULY 19/68	REVISIONS TO CAMPBELL STORE SPACE	
7	JULY 19/68	DIMENSIONS CHANGED	

THE ARCHITECTURAL AFFILIATION

DESIGNED BY: [Signature]

DRAWN BY: [Signature]

CHECKED BY: [Signature]

APPROVED BY: [Signature]

THE ARCHITECTURAL AFFILIATION

FOR **NOTTINGHAM FARMS INC.**

102 W. PENNSYLVANIA AVE.
TOWSON, MARYLAND 21204

ALEX BROWN BLDG.
UNDERGROUND PARKING LEVEL
VAULT AREA 1740 SQ. FT.
PLANS AND SECTIONS

JOB NO. 6822 R
SCALE: AS NOTED
DATE: 27 MAR 1968
LAST REV. JULY 22 1968

V1