

City of Houston Texas  
  
 18076069  
 REVIEWED FOR COMPLIANCE  
 Performance of this review does not relieve the applicant from full responsibility to comply with all applicable codes, ordinances and regulations  
 10/29/18

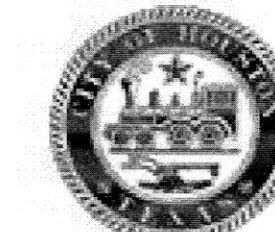

4 POP UP COVE AT GLASS  
 Scale: 3" = 1'-0"

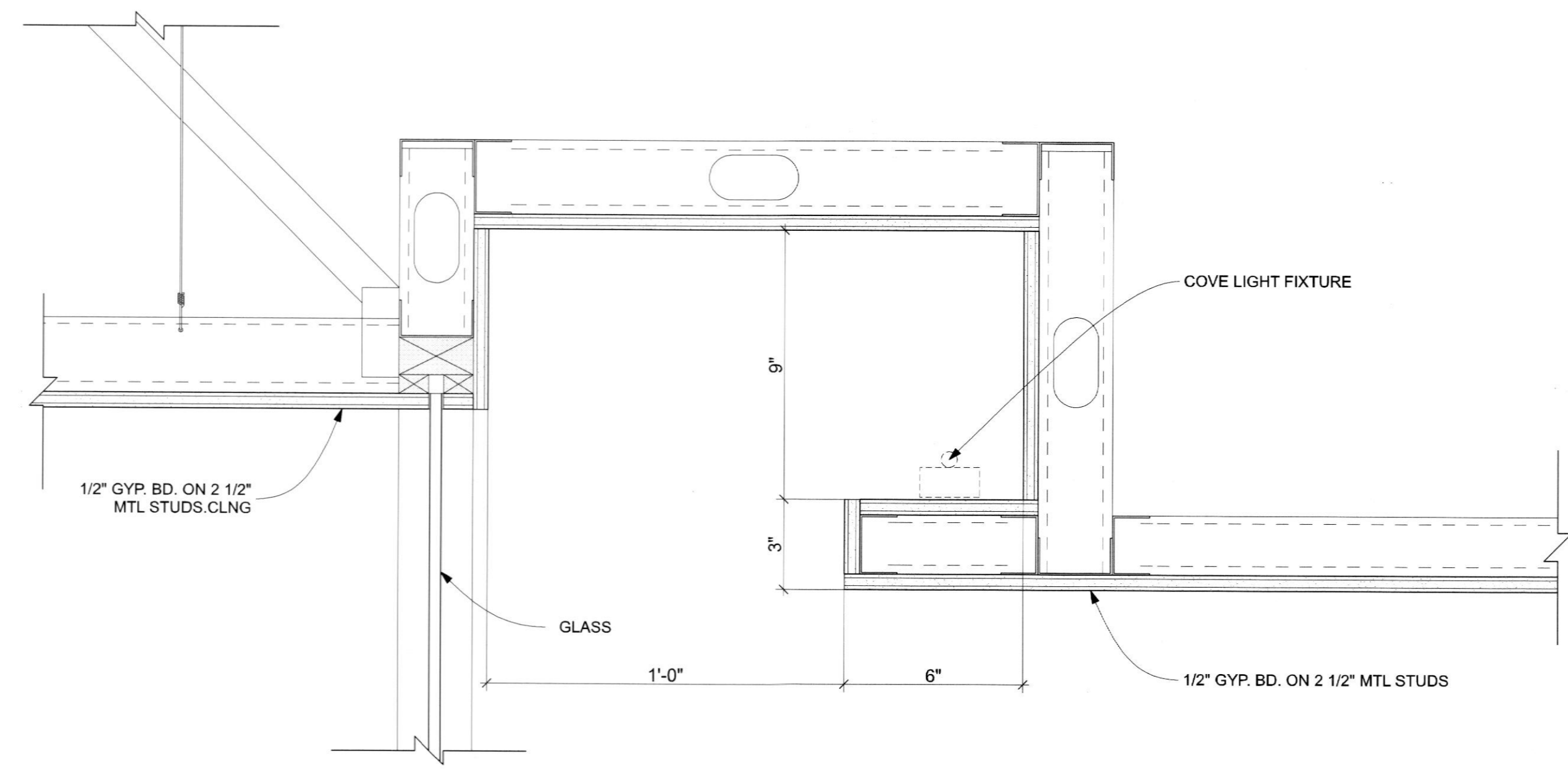
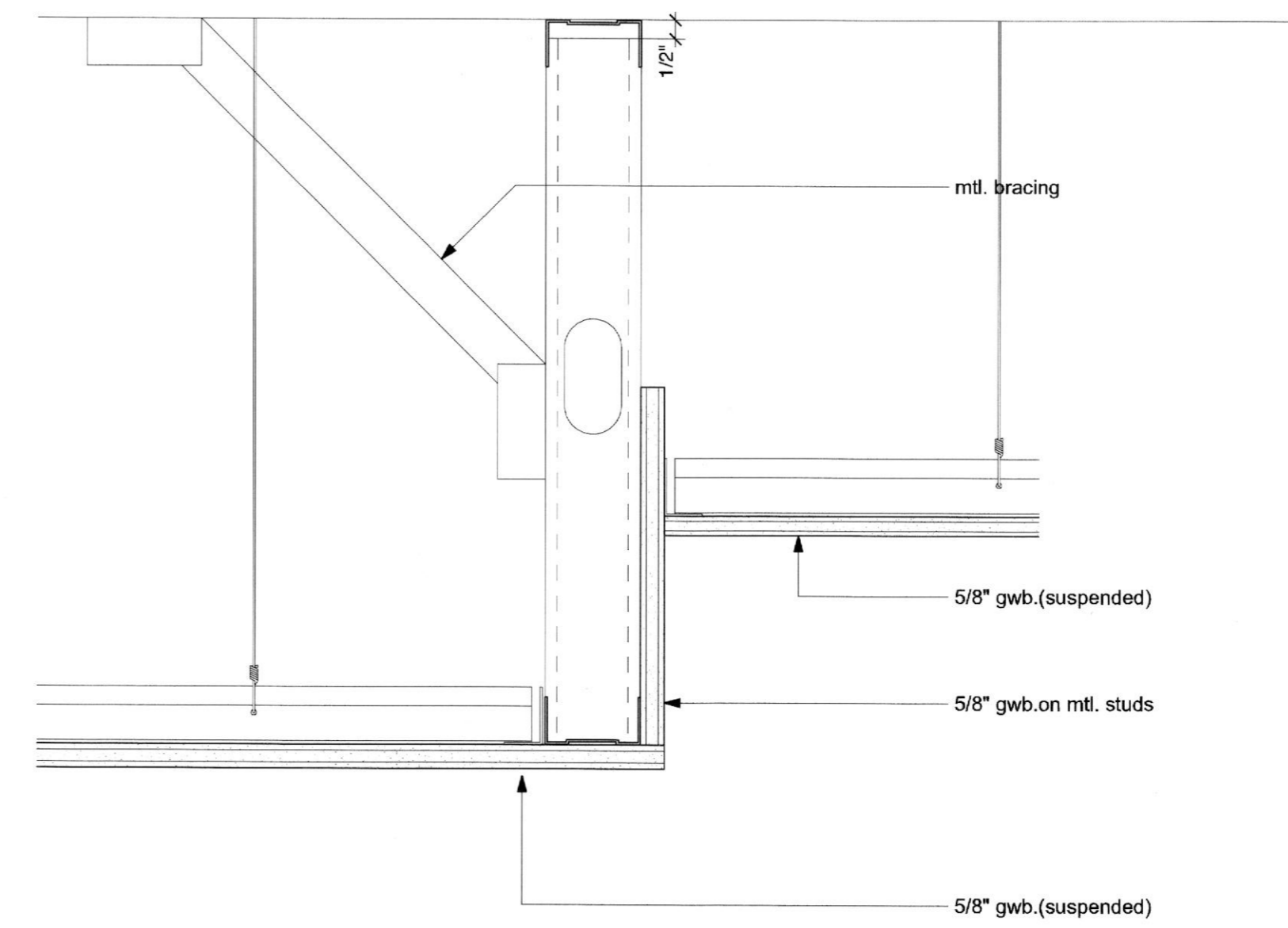

5 TYPICAL GWB BULKHEAD DETAIL  
 Scale: 3" = 1'-0"

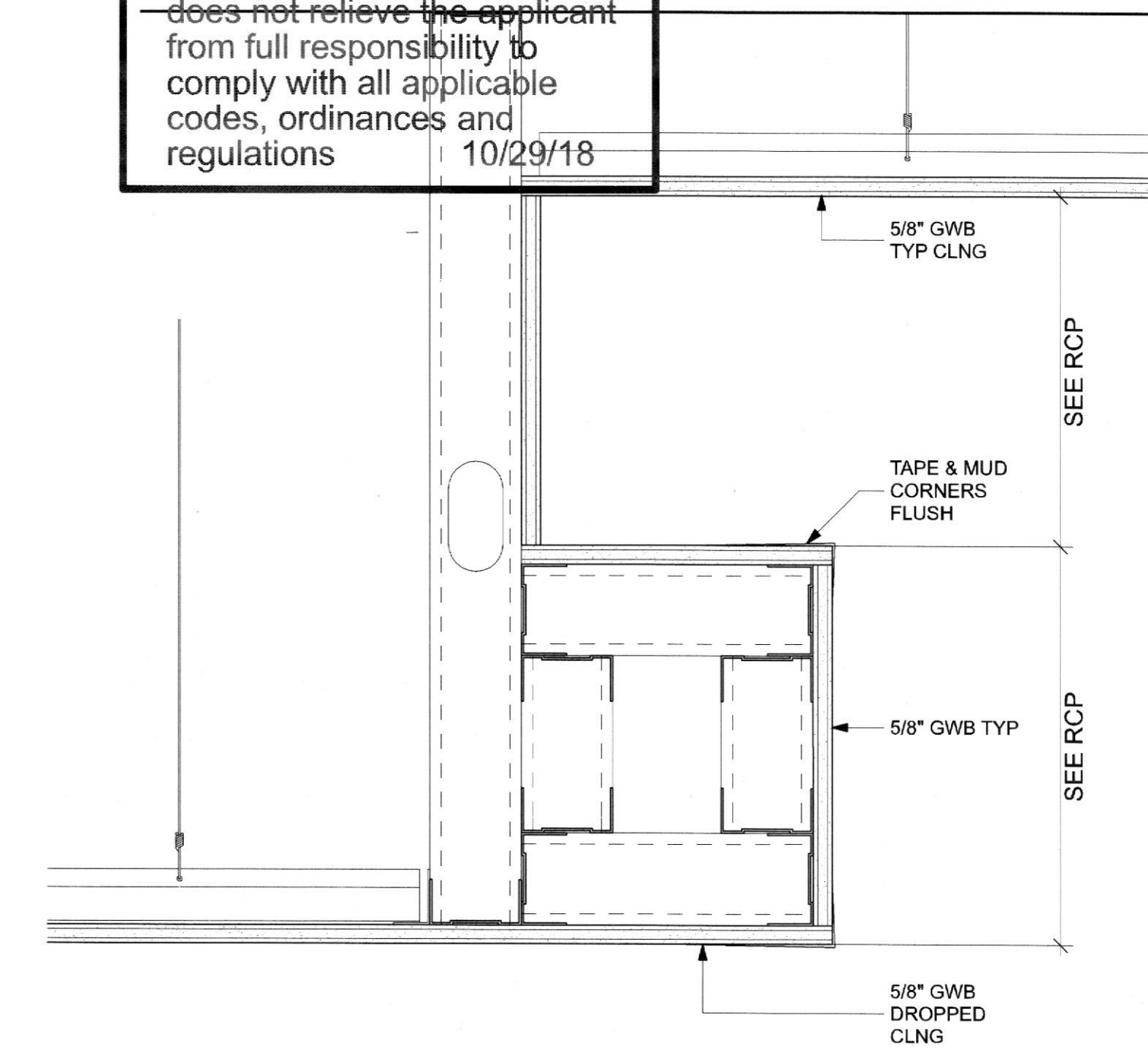

6 TYPICAL FLOATING BULKHEAD  
 Scale: 3" = 1'-0"

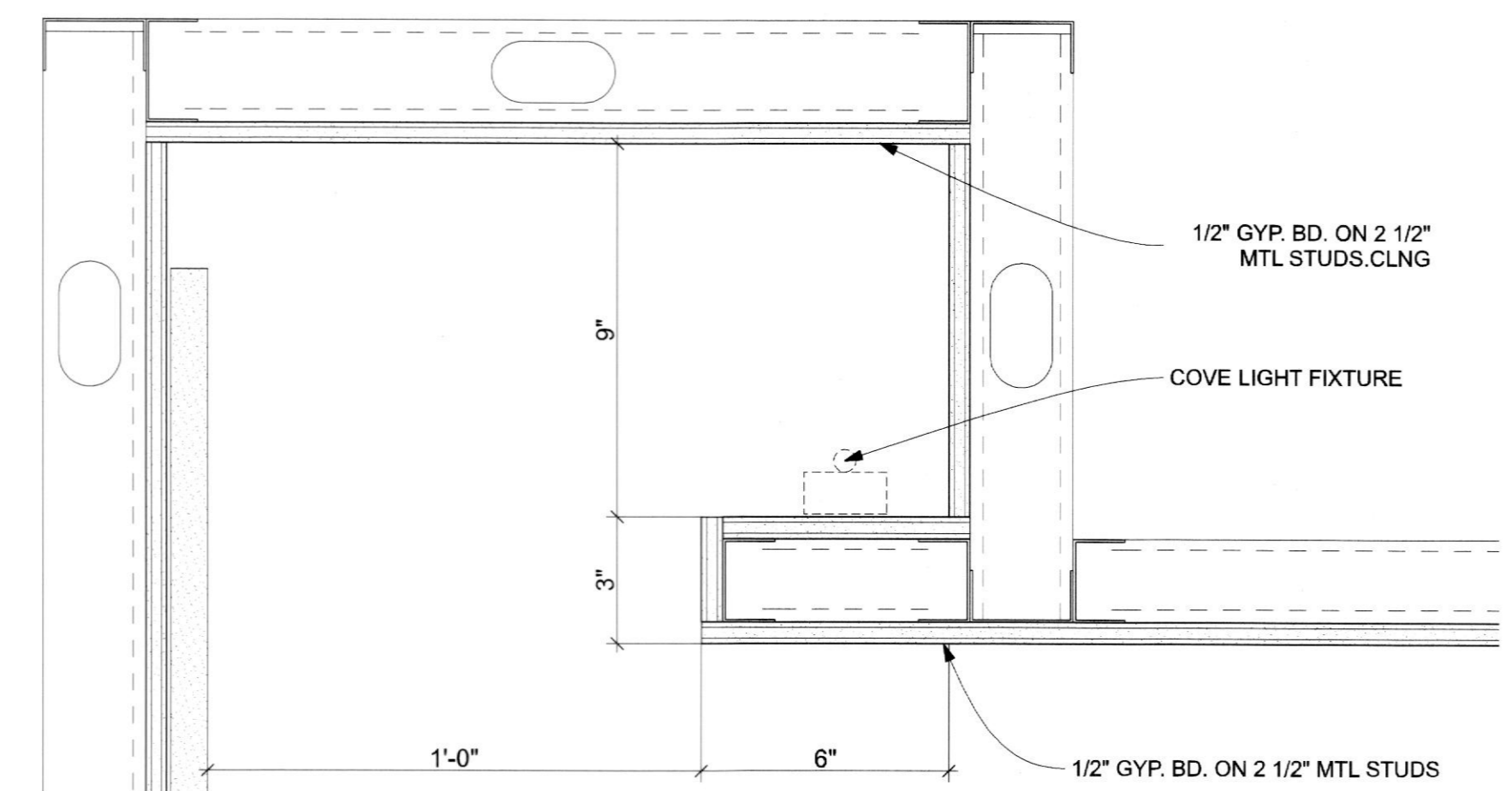

3 POP UP COVE AT FABRIC WALL  
 Scale: 3" = 1'-0"

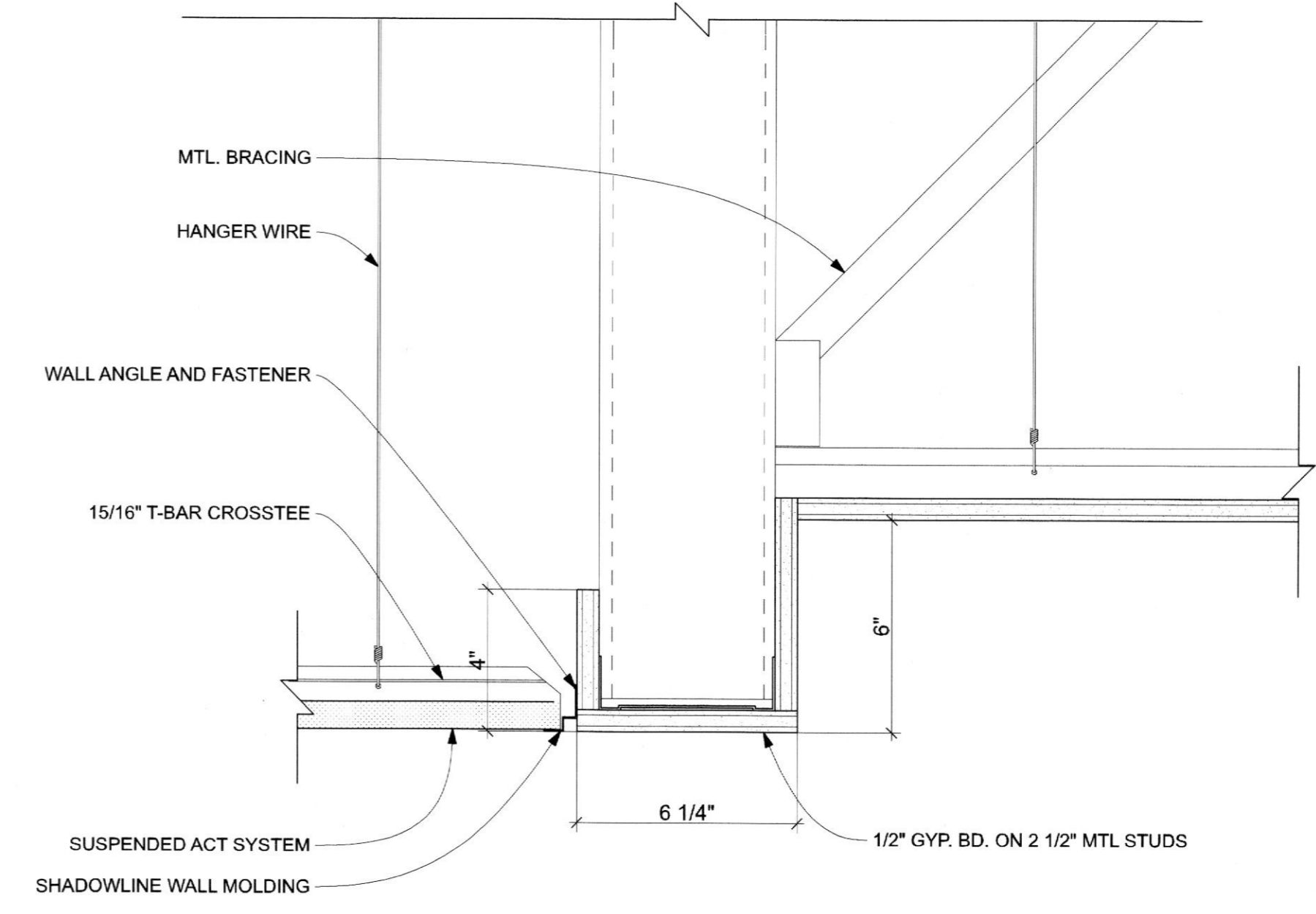

2 TYPICAL GWB TO ACT DETAIL  
 Scale: 3" = 1'-0"

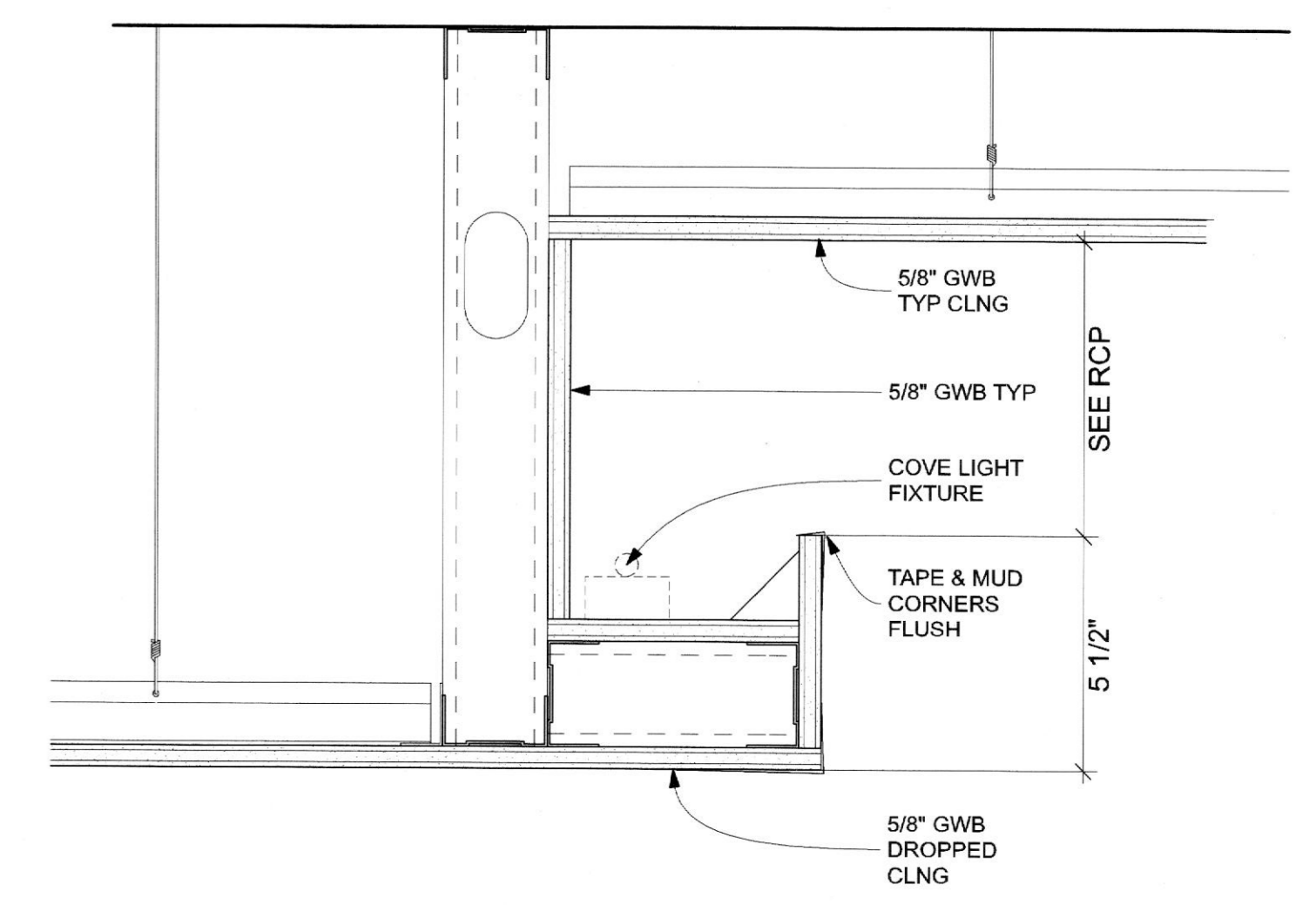

1 TYPICAL POP UP COVE  
 Scale: 3" = 1'-0"

**ARCHITECT**  
**HapstakDemetriou +**  
 ARCHITECTURE | DESIGN  
 2715 M STREET NW, 4th Floor  
 WASHINGTON, DC 20007  
 202.333.9038  
 www.hd-ad.com info@hd-ad.com

**CLIENT**  
 Alexander Smith  
 (410) 241-1224  
 afsmith11@gmail.com  
  
**STRUCTURAL ENGINEER**  
 BEI Structural Engineers  
 3930 Pender Dr. Suite 175  
 Fairfax, VA 22030

**MEP ENGINEER**  
 J.B. Wyble and Associates, P.A.  
 7950 Norfolk Ave., Bethesda, MD  
 301-654-1410  
  
**FOOD SERVICE CONSULTANT**  
 JLA Corp  
 13031 US Highway 19N, Clearwater, FL 33764  
 727-470-7862

**OUZO BAY HOUSTON**  
 4444 WESTHEIMER RD, HOUSTON, TX 77027, SUITE 130  
**PROJECT NO. 17054**  
  
 I CERTIFY THAT THESE DOCUMENTS WERE PREPARED OR APPROVED BY ME, AND THAT I AM A DULY LICENSED ARCHITECT UNDER THE LAWS OF TEXAS LICENSE NO. 26750 EXPIRATION DATE: 8/31/2018

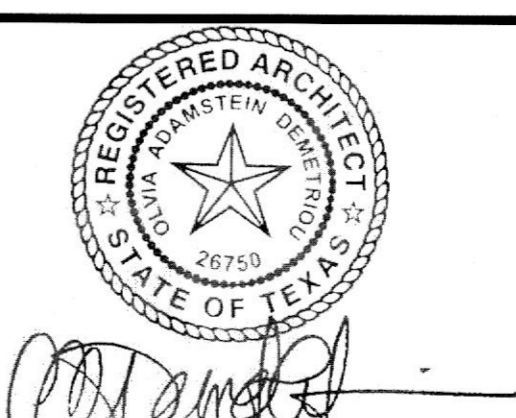

REV	DATE	ISSUED FOR
	5/16/18	PROGRESS SET
	6/20/18	PERMIT SET

REV	DATE	ISSUED FOR

**TYPICAL CEILING DETAILS**  
**A0010**  
 PRINTED: 6/21/18  
 © HapstakDemetriou+, pllc 2018