



18076069

REVIEWED FOR COMPLIANCE

Performance of this review does not relieve the applicant from full responsibility to comply with all applicable codes, ordinances and regulations. 10/29/18

CAPTIVE
Houston Office
4601 Calhoun Rd., Suite 801, Houston, TX 77063
PHONE: (818) 578-2535 FAX: (818) 572-5982

Ouzo Bay and Loch Bar
HOUSTON, TX, 77002

DATE: 5/17/2018
DWG.#: 3265879
DRAWN BY:
SCALE: 3/4" = 1'-0"
MASTER DRAWING
SHEET NO. 3

- FAN #2 A4-G-1000-200 - HEATER (MUA)
1. COILS ON FRESH HEATED MAKE UP AIR UNIT WITH 30" DIRECT DRIVE FAN AND 24" BURNER.
 2. INTAKE HOOD WITH 82 FELTS
 3. LEAK DISCHARGE - AIR FLOW RIGHT - LEFT
 4. COOLING INTERLOCK RELAY - 24VAC COIL - LOW CONTACTS - LOCKS OUT BURNER CIRCUIT WHEN AC IS ENERGIZED.
 5. NOTICED BURNER START CHARGE 3/4" 30" TON SIZE 45 STANDARD 8 MODULAR HEATER UNITS W/STANDARD 24"PT. STANDARD GALVANIZED CONSTRUCTION, 3/4" REAR FLANGE, W/PER-IP ACTUATOR INCLUDED.
 6. LOW FRESH START - ALLOWS THE BURNER CIRCUIT TO ENERGIZE WHEN THE MODULATION CONTROL IS IN A LOW FRESH POSITION.
 7. GAS PRESSURE GAUGE - 0-35" 3/8" DIAMETER, 1/4" THREAD SIZE.
 8. GAS PRESSURE GAUGE - 0-15" 1/2" DIAMETER, 1/4" THREAD SIZE.
 9. COIL MODULE FOR SIZE 4 MODULAR FANS - 5,000 THRU 8,650 CFM (20 TON) - 2 CIRCUIT DX COIL, 4E21102H-S2-3048-03) D09M4 - NOT BUILT WITH OFF SIDE CONTROLS.
 10. CONDENSER AND CONDENSER DISCONNECT (UNLESS PROVIDED ON QUOTE) WILL BE INSTALLED, STARTED AND WARRANTED BY OTHERS. R410A REFRIGERANT AND PIPING BY OTHERS. ENSURE SHUT OFF VALVES FOR FILTER CHANGES, SIGHT GLASS, THERMAL EXPANSION VALVE, COIL HEAT/START COIL (4 E2030H-S2-3048-03) 10.20 TON, DUAL CIRCUIT CONDENSING UNIT, 3 PHASE 460V, AIR COOLED.
 11. INCLUDED: FACTORY INSTALLED CONDENSER DISCONNECT SWITCH, R410A REFRIGERANT AND PIPING BY OTHERS, 6-7 WEEK LEAD TIME, SHIPPING INCLUDED IN PRICE. SHIPS FROM TYLER, TX. SHIPS SEPARATE, FREIGHT INCLUDED. 3048/3048/3048/3048.
 12. COIL #12 R410A, DUAL CIRCUIT 20 TON, INCLUDES: FILTER DRYER, SIGHT GLASS, AND THERMAL EXPANSION VALVE FOR DX UNITS. INSTALLATION BY OTHERS. INCLUDES R410A TUV.
 13. INSTALLATION BY OTHERS. INCLUDES R410A TUV.
 14. SEPARATE LONAL WIRING PACKAGE FOR MAKE-UP AIR UNITS. OPTION MUST BE SELECTED WHEN MOUNTING UP ON PREWIRED PANEL OR WITH DCV PACKAGE. PROVIDES SEPARATE LONAL WIRING TO SUPPLY FAN. THIS LONAL SIGNAL MUST BE RUN BY ELECTRICIAN FROM DCV TO REAR SWITCH.
 15. NOTE: SUPPLY DUCT MUST BE INSTALLED TO MEET MACHINA STANDARDS. A MINIMUM STRAIGHT DUCT LENGTH EQUAL TO THREE TIMES THE SUPPLY DUCT EQUIVALENT DIAMETER MUST BE MAINTAINED DOWNSTREAM OF UNIT DISCHARGE UNLESS OTHERWISE SPECIFIED. DO NOT RELY ON UNIT TO SUPPORT DUCT IN ANY WAY.

SUPPLY SIDE HEATER INFORMATION:
WINTER TEMPERATURE = 30°F, TEMP. RISE = 30°F,
BTU/LH CALCULATED OFF STANDARD AIR DENSITY
OUTPUT BTU/LH AT ALTITUDE OF 500 FT. = 29655
INPUT BTU/LH AT ALTITUDE OF 0.0 FT. = 40287

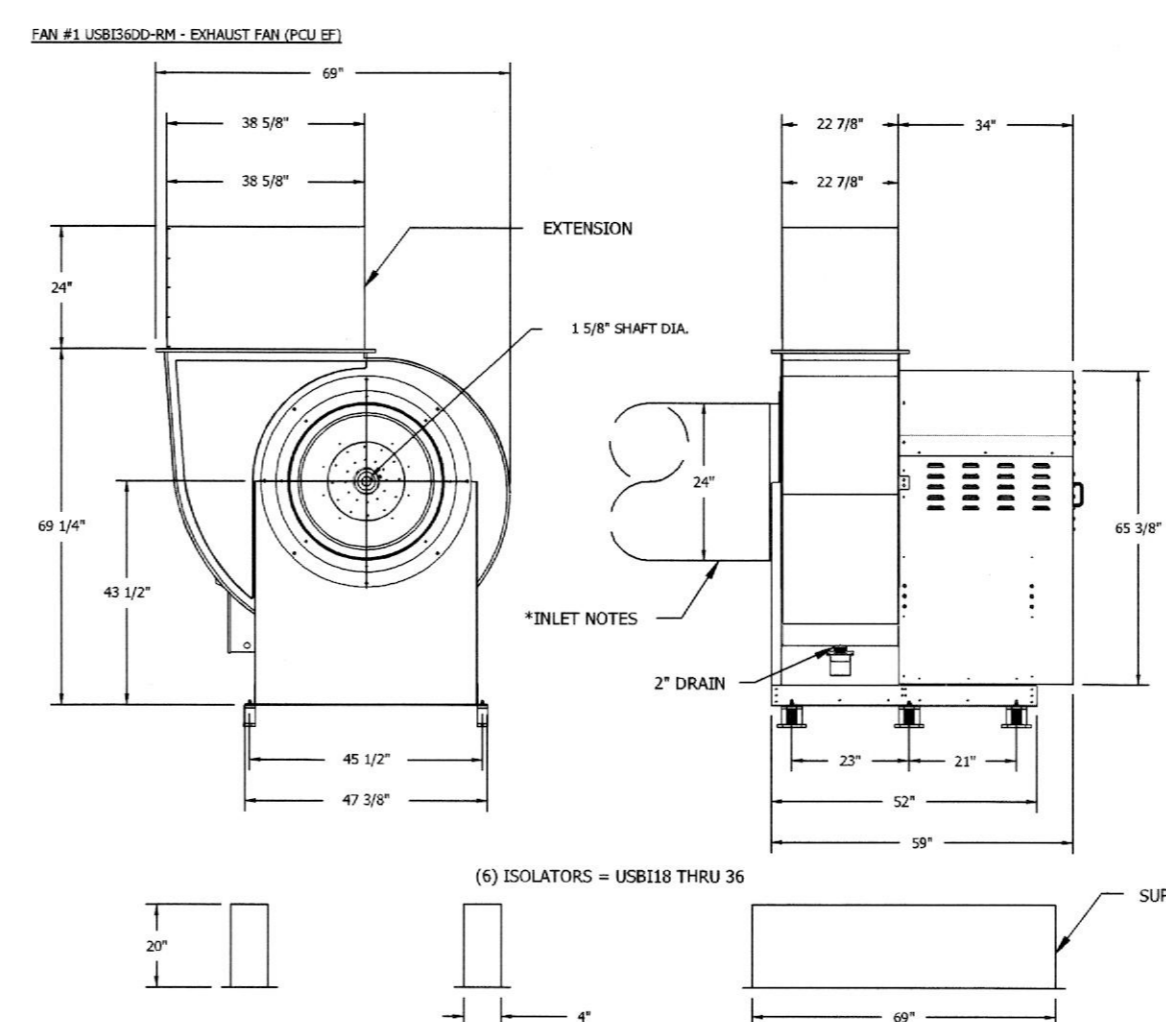
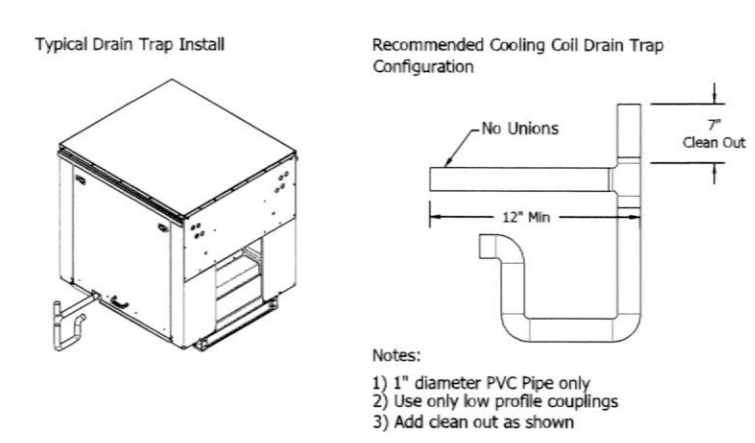
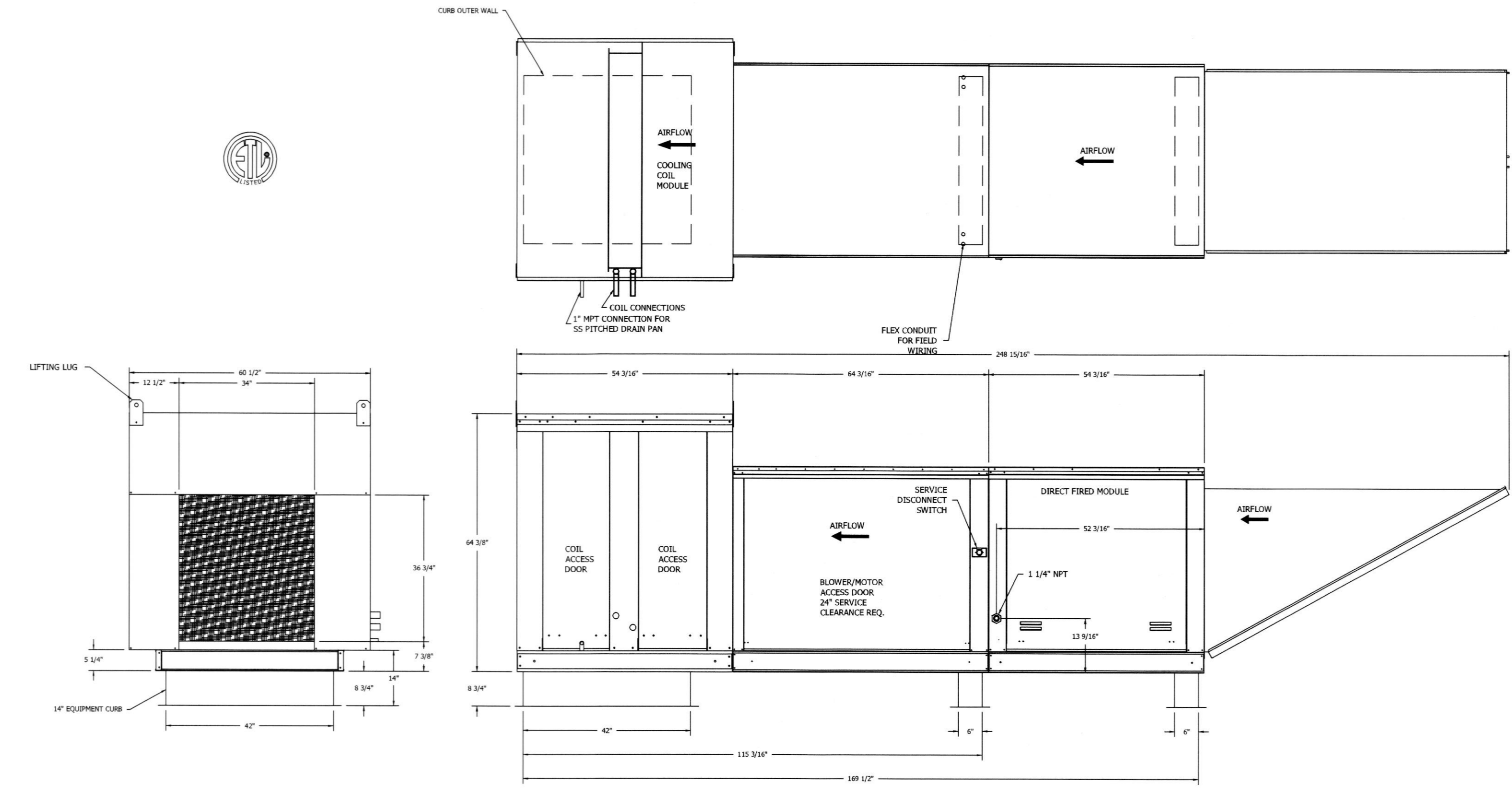

- FEATURES:**
- ROOF MOUNTED FANS
 - RESTAURANT MODEL
 - UL705
 - UL702 AND UL5-5645
 - HIGH HEAT OPERATION DIRECT DRIVE 350°F (176°C)
 - HIGH HEAT OPERATION BELT DRIVE 350°F (176°C)
 - HEAT SINKER
 - GREASE CLASSIFICATION TESTING
 - 2" DRAIN
 - MOTOR WEATHER COVER
 - FULLY SEALED SCROLL HOUSING
 - SCROLL ACCESS DOOR
 - FLANGE 1 1/4" - 11 THRU 20.
 - FLANGE 2" - 24 THRU 36.
- OPTIONS:**
- 8136 - 24" DISCHARGE EXTENSION
 - 81 - DISCHARGE ORIENTATION VERTICAL UPPER LEFT - LW INLET SIDE
 - 81B - INLET CONNECTION STANDARD 24" FLANGED GREASE DUCT.
 - UTILITY SET - GREASE CUP
 - UTILITY SET - SPRING VIBRATION ISOLATORS - BSS THRU 80K / EQUIVALENT
 - UTILITY SET - BECKHOFF/COX COVER BOX.

NORMAL TEMPERATURE TEST DIRECT DRIVE
EXHAUST FAN MUST OPERATE CONTINUOUSLY
WHILE EXHAUSTING AIR AT 350°F (176°C)
UNTIL ALL FAN PARTS HAVE REACHED
THERMAL EQUILIBRIUM, AND WITHOUT ANY
DETERIORATING EFFECTS TO THE FAN WHICH
WOULD CAUSE UNUSUAL OPERATION.

* INLET NOTES:
LENGTH OF THE STRAIGHT DUCT ON THE INLET TO BE 3 TIMES
THE EQUIVALENT DUCT DIAMETER BEFORE CONNECTING TO ANY
FITTINGS SUCH AS ELBOWS TO AVOID SYSTEM EFFECT.

1 EXHAUST HOOD AND FAN DETAILS

REVISIONS	NUMBER	DATE	DESCRIPTION
	1	10/19/18	PER HEALTH DEPARTMENT COMMENTS
	2	10/24/18	PER HEALTH DEPARTMENT COMMENTS

OZO RESTAURANT & LOCH BAR
HOUSTON, TEXAS

PROJECT TITLE:

DATE:	06/28
SCALE:	1/4"
DRAWN BY:	JR
DESIGNED BY:	JR
PAPER SIZE:	24x36
SLAB PENETRATION:	
SHEET:	