

THIS DRAWING IS THE PROPERTY OF INSYNC ARCHITECTURAL DESIGNS INC., UNAUTHORIZED USE OF ANY KIND, INCLUDING USE ON OTHER PROJECTS, IS PROHIBITED.

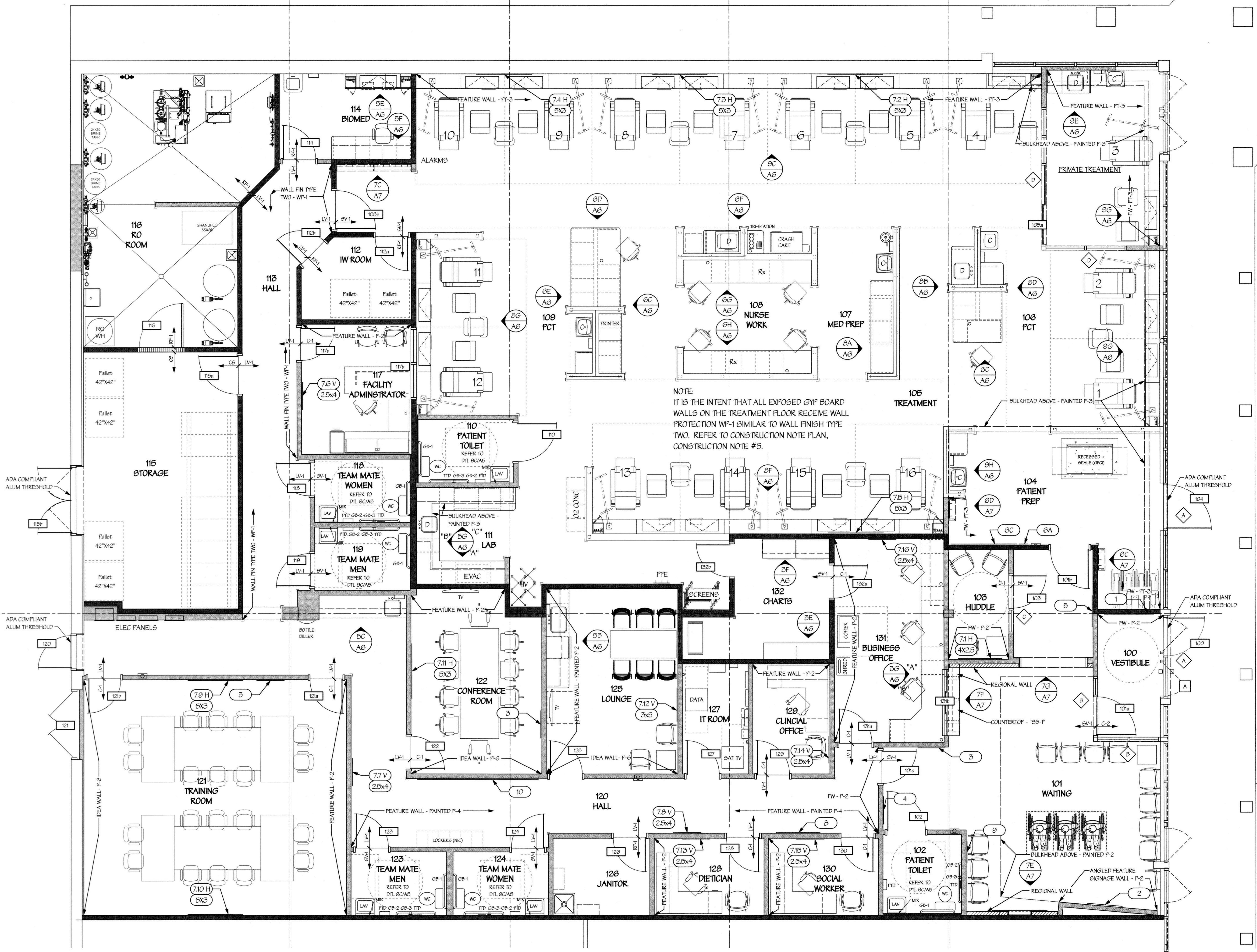

NOTE:  
IT IS THE INTENT THAT ALL EXPOSED GYP BOARD WALLS ON THE TREATMENT FLOOR RECEIVE WALL PROTECTION WP-1 SIMILAR TO WALL FINISH TYPE TWO. REFER TO CONSTRUCTION NOTE PLAN, CONSTRUCTION NOTE #5.

**GRAPHIC KEY PLAN**

1 WELCOME ENTRY (VINYL LETTERS)	7X H (SCENIC GRAPHIC (STETCHED CANVAS) X INDICATES THE NUMBER H = HORIZONTAL - V = VERTICAL SIZE INDICATES THE SIZE OF CANVAS)
2 DAVITA LOGO (CANVAS - SIZE 5'X2')	8 THE DAVITA WAY (CANVAS - SIZE 5'X2')
3 MISSION AND CORE VALUES (SENTRA BOARD)	9 "QUALITY OF LIFE" QUOTE (VINYL LETTERING)
4 RESOURCE WALL (WALL COVERING W/2 ACRYLIC SHELVES)	10 "QUALITY OF LIFE" 11" OF WALL SPACE
5 DAVITA LOGO (VINYL LETTERS)	QIP QUALITY INDICATOR PERFORMANCE (COORDINATE WITH DAVITA)
6 WALL OF FAME (VINYL LETTERING AND CORX BOARD)	QUOTES WALL AREA FOR MESSAGING OR QUOTES (COORDINATE WITH DAVITA)

**TOILET ROOM ACCESSORIES**

MARK	DESCRIPTION	MODEL NO *	102 PUBLIC TOILET	110 PATIENT TOILET	118 TEAM MATE WOMEN	119 TEAM MATE MEN	123 TEAM MATE MEN	124 TEAM MATE WOMEN
PTD	PAPER TOWEL DISPENSER	2502-15	ONE	ONE	ONE	ONE	ONE	ONE
TTD	TOILET TISSUE DISPENSER	8241-50	ONE	ONE	ONE	ONE	ONE	ONE
GB-1	GRAB BAR	832-2 001-36	ONE	ONE	ONE	ONE	ONE	ONE
GB-2	GRAB BAR	832-2 001-42	ONE	ONE	ONE	ONE	ONE	ONE
GB-3	GRAB BAR - VERTICAL	832-2 001-18	ONE	ONE	ONE	ONE	ONE	ONE
MIR	MIRROR (18"X26")	781-1836	ONE	ONE	ONE	ONE	ONE	ONE

\* MODEL NUMBERS SHOWN ARE BY BRADLEY  
\*\* COORDINATE INSTALLATION LOCATION WITH OWNER

U.O.N. PROVIDE QUANTITIES OF ACCESSORIES AS NOTED AT EACH TOILET ROOM, SEE TOILET ROOM DETAILS, & SECTIONS FOR MOUNTING LOCATIONS & HEIGHTS, PROVIDE ALL MISC. WALL BLOCKING REQ'D FOR INSTALLATION. SEE CONSTRUCTION NOTE #3 FOR ADDITIONAL REQUIRED ITEMS.

**9E FLOOR PLAN**  
Scale: 1/4" = 1'-0"

REFER TO SHEET A11 FOR ROOM FINISH SCHEDULE AND FINISH MATERIALS  
REFER TO SHEET A2 FOR DIMENSIONAL PLAN  
REFER TO SHEET A3 FOR CONSTRUCTION NOTES  
REFER TO SHEET A4 FOR CEILING PLAN  
REFER TO SHEET A4 FOR DOOR SCHEDULE

**GENERAL NOTES:**  
OWNER WILL PROVIDE INTERIOR SIGNAGE TO BE MOUNTED BY THE CONTRACTOR. COORDINATE WITH OWNER.

REFER TO CONSTRUCTION NOTES FOR NEW FIRE EXTINGUISHERS. A MINIMUM OF THREE FIRE EXTINGUISHERS ARE TO BE PROVIDED. CONTRACTOR TO REVIEW LOCATIONS WITH CODE OFFICIAL TO INSURE PLACEMENT OF THESE UNITS MEETS CODE REQUIREMENTS. CONTRACTOR SHALL PROVIDE ADDITIONAL FIRE EXTINGUISHERS AS MAY BE DETERMINED BY THIS REVIEW.

ALL ACCESSIBLE CONTROLS, OPERATING MECHANISMS AND HARDWARE SHALL COMPLY WITH SECTION 309 OF ICC/ANSI A117.1.

**Davita**  
DaVita Healthcare Partners, Inc.  
2000 16th Street  
Denver, CO 80202

**DAVISON VAN ORDEN**  
ARCHITECT  
DAVID A. LIDKOW, ARCHITECT  
1831 N 12TH WAY  
SCOTTSDALE, ARIZONA 85259  
480-94-3335 FAX 480-94-0209

TENANT RENOVATIONS FOR:  
**DaVita Dialysis**  
**Lake Hefner - #02085**  
6917 N. May Ave.,  
Oklahoma City, OK 73116

**FLOOR PLAN GRAPHIC AND TOILET SCHEDULES**

STATE OF OKLAHOMA  
DAVID A. LIDKOW  
1741  
Scottsdale  
Arizona  
LICENSED ARCHITECT

PROJECT NO. 10989

**A1**