

THIS DRAWING IS THE PROPERTY OF INSYNC ARCHITECTURAL DESIGNS INC., UNAUTHORIZED USE OF ANY KIND, INCLUDING USE ON OTHER PROJECTS, IS PROHIBITED.

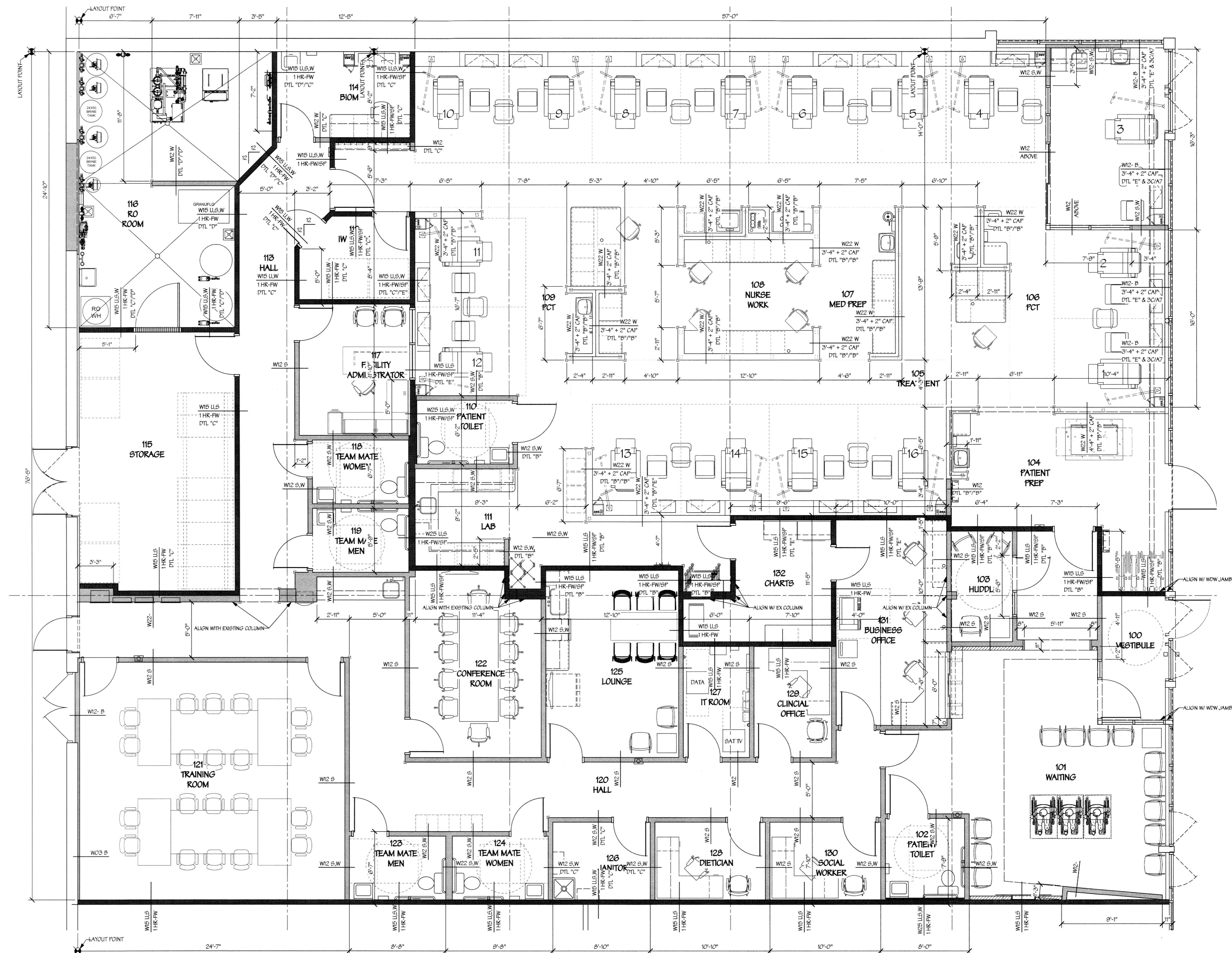

WALL TYPES;

GENERAL NOTES:

- UNLESS OTHERWISE NOTED, ALL WALL STUDS AND GWS SHALL EXTEND MIN 6" ABOVE FINISHED CEILING AND BE BRACED TO STRUCT ABV @ 48" O.C.
- APPLIED FINISHES ARE SHOWN ON THE FINISH SCHEDULE.
- PROVIDE WOOD / PLYWOOD BLOCKING IN WALL AS REQ'D TO INSTALL CASEWORK AND WALL MOUNTED ACCESSORIES SUCH AS TV MOUNTING BRACKETS
- INSULATION MATERIALS SHALL COMPLY WITH CODE REQUIREMENTS - FLAME SPREAD NO MORE THAN 25 AND SMOKE-DEVELOPED INDEX NO MORE THAN 450
- UNLESS OTHERWISE NOTED, ALL GYP BOARD ON ALL WALLS SHALL BE MOLD / MOISTURE RESISTANT GYPSUM BOARD. SUFFIX LOCATIONS WITH A "W" INDICATE WET WALL LOCATIONS. REFER TO DETAIL ONE ON SHEET A2 FOR REQUIRED WALL DETAILS.

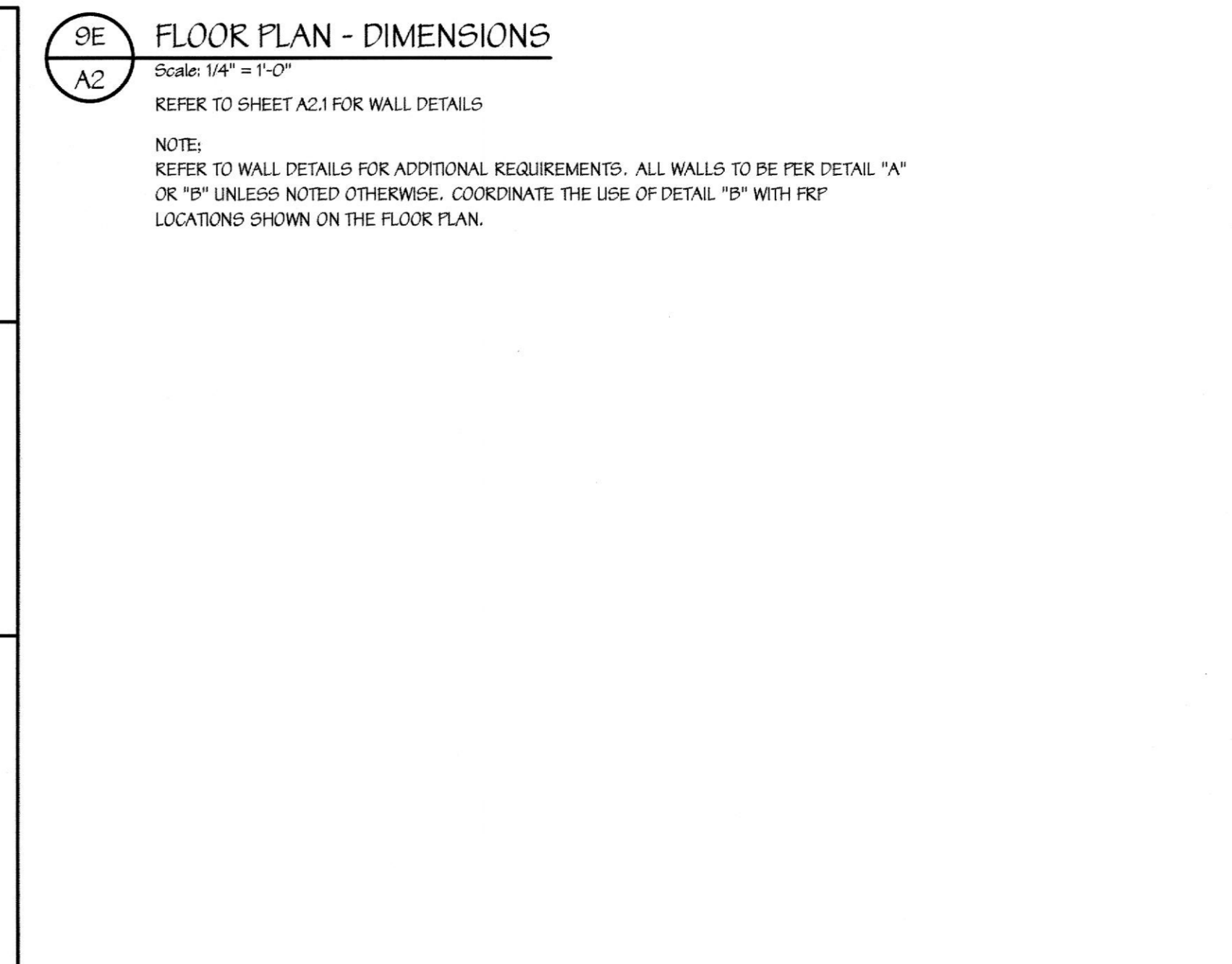
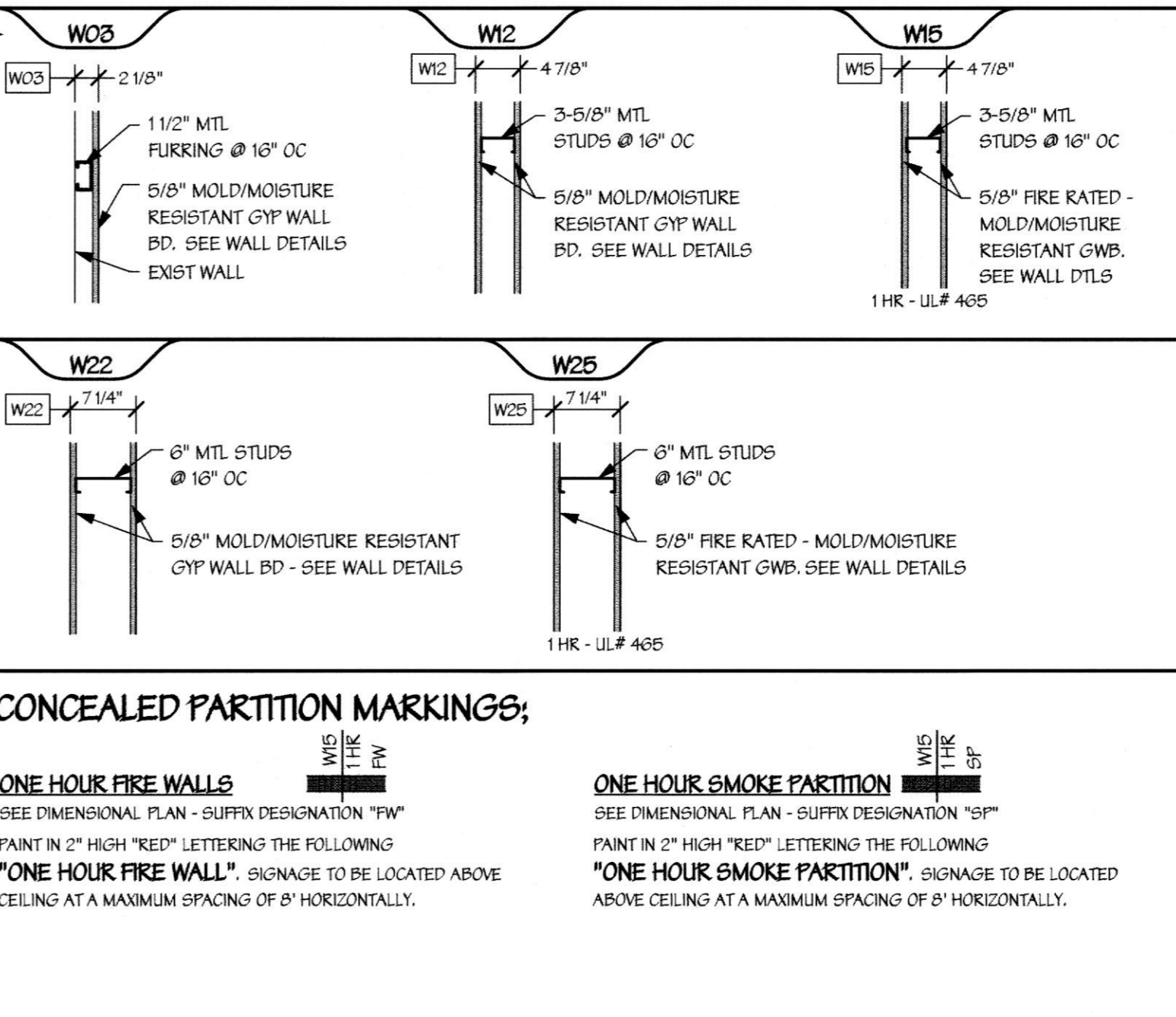
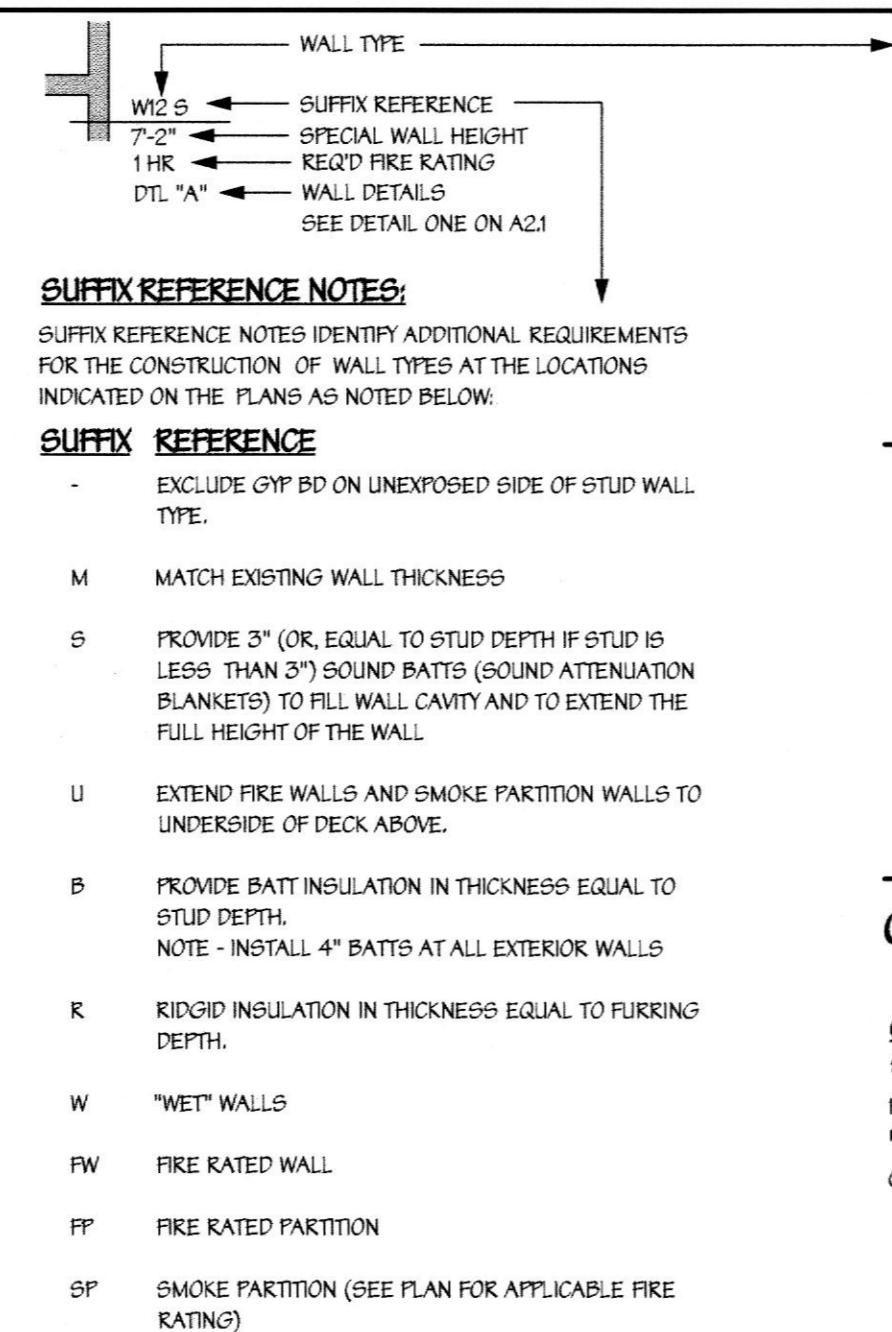

Davita
DaVita Healthcare Partners, Inc.
200 16th Street
Denver, CO 80202

DAVID A. LERKOW, ARCHITECT
11811 N. 112TH WAY
SCOTTSDALE, ARIZONA 85259
480-548-2000 FAX 480-548-0209

DAVISON VAN ORBEN
11811 N. 112TH WAY
SCOTTSDALE, ARIZONA 85259
480-548-2000 FAX 480-548-0209

DAVITA
c/o DaVita Healthcare Partners, Inc.
2000 16th Street
Denver, CO 80202

DaVita Dialysis
Lake Heffner - #02085
6917 N. May Ave.
Oklahoma City, OK 73116

DIMENSION PLAN WALL TYPES

5/14/17
A2