

TOILET ROOM ACCESSORIES			102 PUBLIC TOILET	116 PATIENT DRESS / TOILET	115 TEAMATE TOILET	121 TEAMATE TOILET	205 TOILET
MARK	DESCRIPTION	MODEL NO *					
PTD	PAPER TOWEL DISPENSER	B-359	ONE	ONE	ONE	ONE	ONE
TTD	TOILET TISSUE DISPENSER	B-4286	ONE	ONE	ONE	ONE	ONE
GB-1	GRAB BAR	B-5806x36	ONE	ONE	ONE	ONE	ONE
GB-2	GRAB BAR	B-5806x42	ONE	ONE	ONE	ONE	ONE
GB-3	GRAB BAR - VERTICAL	B-5806x24	ONE	ONE	ONE	ONE	ONE
MIR	MIRROR (18"X33"H)	B-165-2430	ONE	ONE	ONE	ONE	ONE
TSC	TOILET SEAT COVER**	B-4221	ONE	ONE	ONE	ONE	ONE
FND	FEMININE NAPKIN DISPENSER**	B-270	ONE	ONE	ONE	ONE	ONE
* MODEL NUMBERS SHOWN ARE BY BOBRICK WASHROOM EQUIPMENT							
** COORDINATE INSTALLATION LOCATION WITH OWNER							
<p>UNION PROVIDE QUANTITIES OF ACCESSORIES AS NOTED AT EACH TOILET ROOM, SEE TOILET ROOM DETAILS, & SECTIONS FOR MOUNTING LOCATIONS & HEIGHTS, PROVIDE ALL MISC. WALL BLOCKING REQ'D. FOR INSTALLATION.</p> <p>SEE CONSTRUCTION NOTE #3 FOR ADDITIONAL REQUIRED ITEMS.</p>							

ROOM FINISH SCHEDULE:									
Room #	Scheduled Name	Floor Fin	Base Type	Wall Fin	Ceiling Type	Ceiling Ht	Trim	Special	Notes
100	VESTIBULE	SV-WD-1	RB	PT-1	AC	9'-0"	PT-4	-	-
101	WAITING	SV-WD-1	RB	PT-1	AC	9'-0"	PT-4	-	-
102	PUBLIC TOILET	SV-WD-1	SV	WALL TYPE ONE *	AC	9'-0"	PT-4	-	* 52" HIGH WAINSCOT / USE WR_GWB
103	PASSAGE	SV-1	RB	PT-1	AC	9'-0"	PT-4	BULKHEADS; PT-1	NOTE #1
104	ACCESS COORDINATORS	SV-2	RB	PT-1	AC	9'-0"	PT-4	-	NOTE #1
105	MEDICAL RECORDS	SV-2	RB	PT-1	AC	9'-0"	PT-4	-	-
106	LOUNGE	SV-2	RB	PT-1	AC	9'-0"	PT-4	-	NOTE #1
107	JANITOR	SV-2	SV	PT-2	GWB/PT-5	9'-0"	PT-4	-	-
108	COMPUTER/TELEPHONE	SV-2	RB	PT-1	AC	9'-0"	PT-4	-	-
109	OXYGEN	SV-2	RB	PT-1	GWB/PT-5*	9'-0"	PT-4	-	* REFER TO BC/A6
110	ELECTRICAL / MED VACUUM	SV-2	RB	PT-1	AC-1	9'-0"	PT-4	-	-
111	PHYSICIAN OFFICE	SV-2	RB	PT-1	AC	9'-0"	PT-4	-	NOTE #1
112	NURSE CONSULT	SV-2	RB	PT-1	AC	9'-0"	PT-4	-	NOTE #1
113	EXAMINATION / MULTIPURPOSE	SV-2	RB	PT-1	AC	9'-0"	PT-4	-	NOTE #1
114	TEAMMATE LOCKERS	SV-2	RB	PT-1	AC	9'-0"	PT-4	-	NOTE #1
115	TEAMMATE TOILET	SV-2	SV	WALL TYPE ONE *	AC	9'-0"	PT-4	GWB/PT-5 CLG AT SHOWER	* 52" HIGH WAINSCOT / USE WR_GWB
116	PATIENT TOILET/DRESS	SV-2	SV	WALL TYPE ONE *	AC	9'-0"	PT-4	-	* 52" HIGH WAINSCOT / USE WR_GWB
117	PREP/HOLDING	SV-1	RB	PT-1	AC	9'-0"	PT-4	-	NOTE #1
118	PREP/HOLDING	SV-1	RB	PT-1	AC	9'-0"	PT-4	-	NOTE #1
119	RECOVERY	SV-1	RB	PT-1	AC	9'-0"	PT-4	-	NOTE #1
120	RECOVERY	SV-1	RB	PT-1	AC	9'-0"	PT-4	-	NOTE #1
121	TEAMMATE TOILET	SV-2	SV	WALL TYPE ONE *	AC	9'-0"	PT-4	-	* 52" HIGH WAINSCOT / USE WR_GWB
122	NURSE CONTROL / WORK	SV-1	RB	PT-1	AC	9'-0"	PT-4	BULKHEADS; PT-3	-
123	SEMI-RESTRICTED PASSAGE	SV-2	SV	PT-1	AC-1	9'-0"	PT-4	-	NOTE #1
124	DOCUMENTATION AREA	SV-2	SV	PT-1	AC-1	9'-0"	PT-4	-	NOTE #1
125	JANITOR	SV-2	SV	PT-1	GWB/PT-5	9'-0"	PT-4	-	-
126	O.R. ONE - CLASS "B"	SSV	SSV	PT-2*	GWB/PT-5	9'-0"	PT-4	-	*SCRUBBABLE WALL FIN
127	O.R. TWO - CLASS "B"	SSV	SSV	PT-2*	GWB/PT-5	9'-0"	PT-4	-	*SCRUBBABLE WALL FIN
128	O.R. THREE - CLASS "B"	SSV	SSV	PT-2*	GWB/PT-5	9'-0"	PT-4	-	*SCRUBBABLE WALL FIN
129	CLEAN WORK	SV-2	SV	PT-1	AC-1	9'-0"	PT-4	-	-
130	SOILED WORK AREA	SV-2	SV	PT-1	AC-1	9'-0"	PT-4	-	-
131	TRASH	SV-2	SV	PT-1	GWB/PT-5	9'-0"	PT-4	-	-
132	CLEAN STORAGE	SV-2	SV	PT-1	AC-1	9'-0"	PT-4	-	-
133	SOILED HOLDING	SV-2	SV	PT-1	GWB/PT-5	9'-0"	PT-4	-	-
201	RECEIVING STORAGE	SV-2	RB	PT-1	AC-1	9'-0"	PT-4	-	-
202	LOUNGE	SV-2	RB	PT-1	AC	9'-0"	PT-4	-	NOTE #1
203	PASSAGE	SV-1	RB	PT-1	AC	9'-0"	PT-4	-	-
204	SITE MANAGER	SV-2	RB	PT-1	AC	9'-0"	PT-4	-	NOTE #1
205	TOILET	SV-2	SV	WALL TYPE ONE *	AC	9'-0"	PT-4	-	* 52" HIGH WAINSCOT / USE WR_GWB
206	ADMINISTRATION ROOM	SV-1	RB	PT-1	AC	9'-0"	PT-4	-	-
207	STORAGE / NETWORK	SV-2	RB	PT-1	AC	9'-0"	PT-4	-	-
208	EXAMINATION	SV-2	RB	PT-1	AC	9'-0"	PT-4	-	NOTE #1
209	OFFICE	SV-2	RB	PT-1	AC	9'-0"	PT-4	-	NOTE #1

NOTES:
ALL FINISHES SHALL BE IN ACCORDANCE WITH IBC 803.1, CLASS B; FLAME SPREAD 25-75; SMOKE-DEVELOPED 0-450

ALL FLOOR FINISHES SHALL BE SLIP RESISTANT IN ACCORDANCE WITH IBC 1003.2.6

NOTE #1:
REFER TO FLOOR PLAN FOR FEATURE WALL LOCATIONS. REFER TO WALL FINISH FOR FEATURE WALL PAINT COLOR

ROOM FINISH MATERIALS (INITIAL SELECTIONS PENDING DOCTOR'S APPROVAL)

FLOOR FINISH:
PT-1 = CARPET - NOT USED ON THIS PROJECT
SV-WD-1 = SHEET VINYL WOOD WITH 30" WIDE BORDER
 FIELD - Shaw NatureLife Wood II, Style: 0002V, Color: Light Maple, #05304
 BORDER - Shaw NatureLife Wood II, Style: 0002V, Color: Fumed Wenge, #02421
SV-WD-2 = SHEET VINYL WOOD (NO BORDER)
 Shaw NatureLife Wood II, Style: 0002V, Color: Light Maple, #05304
SV-1 = SHEET VINYL - WITH BORDER (SEE PLAN FOR LOCATIONS AND FEATURE IN-LAY);
 12" WIDE BORDER IN HALLS & SEE PLAN FOR OTHER LOCATIONS (18" WIDE BORDER UNO)
 FIELD - Forto Marmoleum, Style: Vvace, Color: Surprising Storm, #3420
 BORDER - Forto Marmoleum, Style: Real, Color: Graphite, #3040
 FEATURE IN-LAY - Forto Marmoleum, Style: Real, Color: Barley, #2707
SV-2 = SHEET VINYL - (NO BORDER)
 Forto Marmoleum, Style: Vvace, Color: Surprising Storm, #3420
SSV = SEAMLESS/WELDED SEAM SHEET VINYL -
 Armstrong Medlinch - ColorArt w/ Diamond ID
 Color: Silver Gray #84187, (To be used in conjunction w/ Matching Armstrong Weld Bead)

WALL FINISH:
PT-1 = PAINTED - PRIMARY PAINT ONE - Sherwin Williams; Color: "Toque White" #SW7003 - Egg Shell
PT-2 = PAINTED - EPOXY - Sherwin Williams; 3479 Water-Based Epoxy; Color: "Light French Grey" #SW0055 - Gloss
PT-3 = PAINTED - FEATURE PAINT - Sherwin Williams; Color: "Classic French Gray" #SW0077 - Egg Shell
PT-4 = DOOR FRAMES - SEE DOORS/FRAMES
PT-5 = CEILING - Sherwin Williams - Ceiling White
OR-1 = STAIN GRADE WOOD CHAIR RAIL, 4" HIGH - Stained to match wood doors.
PL-1 = PLASTIC LAMINATE FEATURE WALL - PLAS LAM "B" Formica 7012-55 "Amber Maple" Matte Finish

DOORS / FRAMES:
DOORS = Algoma Hardwoods, Sliced White Birch
 Stained to Match Cabinet Laminate
DOOR FRAME PAINT COLOR:
PT-4 = PAINTED - SHERWIN WILLIAMS - COLOR TO BE SELECTED - Gloss
DOOR HARDWARE = BRUSHED NICKEL

SPECIALTY ITEMS
 ROLLER SHADES - EQUAL TO TECHMATIC WINDOW SHADES. FABRIC TO BE SHEERWEAVE PW 3500 WITH 5% OPENNESS - PW 3555-UG4 5% "ASH". OPERATOR TO BE STAINLESS STEEL OPERATOR LOCATED ON THE NON-OBSTRUCTED SIDE OF OPENING. PROVIDE ALL HARDWARE REQUIRED FOR A COMPLETE INSTALLATION INCLUDING FACIAS WITH ENDCAPS. FACIA TO BE CLEAR ANODIZED.
 DOOR AND WALL PROTECTION (CONTACT NATIONAL ACCOUNT SALES REPRESENTATIVE INFRO CORPORATION TEL: 800-214-7749)
 CORNER GUARDS - InPro - "CHINO" #0255
 DOOR GUARDS - InPro - "CHINO" #0255

BASE TYPE:
RS = RUBBER STRAIGHT - Kopppe TP 7P122 1/8", TPR Rubber Color: "Dark Gray" 150
RC = RUBBER COVE - Kopppe TP 7P122 1/8", TPR Rubber Color: "Dark Gray" 150
SV = 6" HIGH SHEET VINYL - INTEGRAL COVE BASE
 WITH 3/4" RADIUS COVE AND CONTINUOUS ALUMINUM CAP.
SSV = 6" HIGH SEAMLESS/WELDED SEAM SHEET VINYL - INTEGRAL COVE BASE
 WITH 3/4" RADIUS COVE AND CONTINUOUS ALUMINUM CAP.

WALL FINISH TYPES
SEE FINISH MATERIALS LISTING

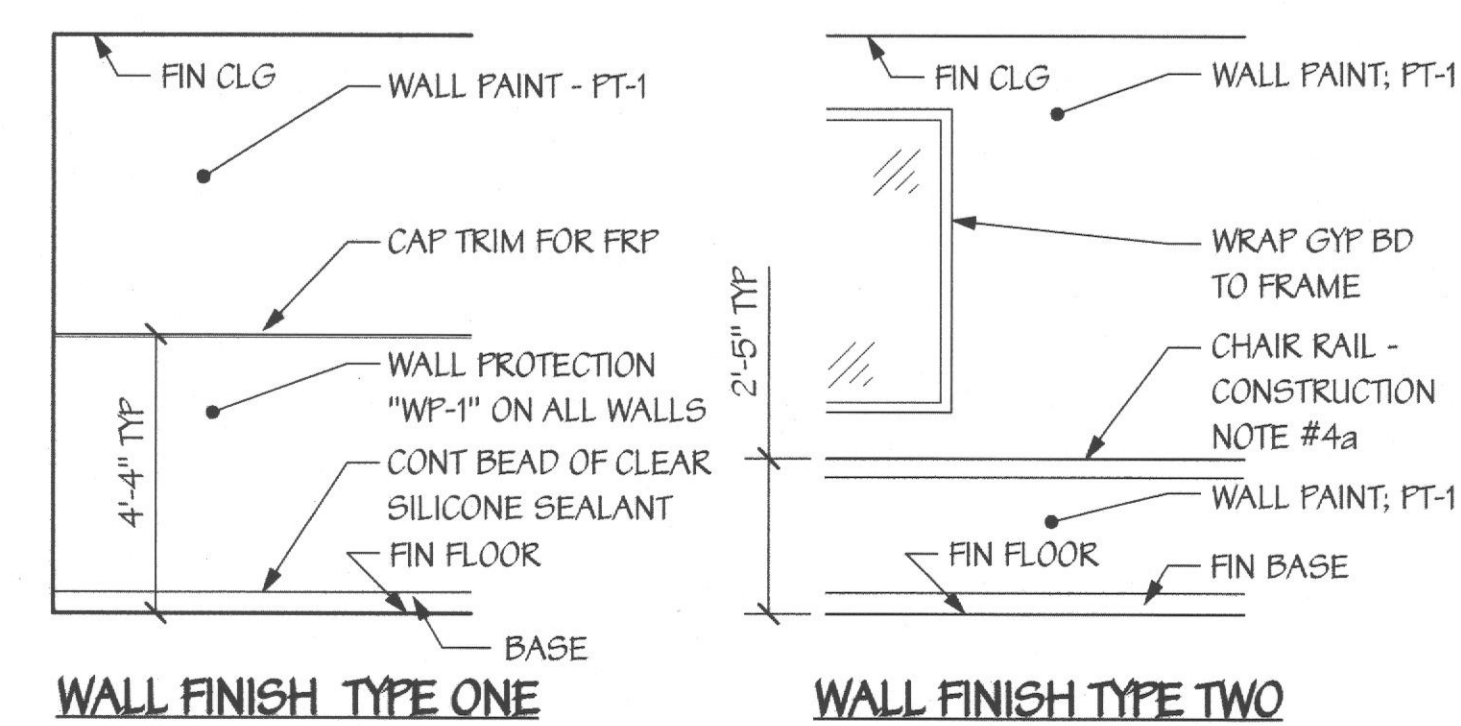

CEILING TYPE:
AC = TYPICAL ACCOUSTICAL TILE (2'X4')
AC-1 = SCRUBBABLE ACCOUSTICAL TILE (2'X4')
 INSTALLED WITH HOLD DOWN CLIPS
GWB/PT = GYPSUM WALL BOARD / PAINTED

PLASTIC LAMINATE:
 PROVIDE THE FOLLOWING LAMINATE COLORS PER THE INT. ELEVATIONS:
PLAS LAM "A" - COUNTERTOPS -
 Formica 537-55 "Graphite" Matte Finish
PLAS LAM "B" - CABINETS -
 Formica 7012-55 "Amber Maple" Matte Finish

WALL PROTECTION -
WP-1 INFRO - RIGID SHEET WALL PROTECTION - "CHINO" #0255
WP-2 FRP - VERITY - MARLITE FRP "SILVER" #145
CUBICAL CURTAIN FABRIC - FROM 100% FR POLYESTER CUBICLE FABRIC - VAPOR, EYKON DESIGN RESOURCES; COLOR - HALO #CHA-02. PROVIDE NYLON MESH "BONE" (CONTACT JEFF GRELL @ SUGARBUSH MARKETING AND MFG 760-598-9715)

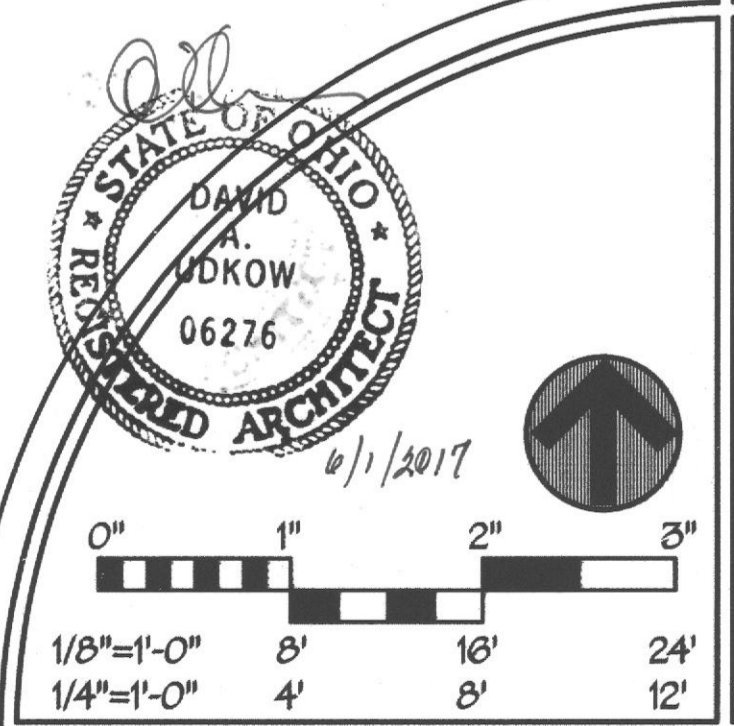

ROOM FINISH SCHEDULE / MATERIALS		
REV#	DATE	DESCRIPTION

NOTE: CONTRACTOR AND SUB-CONTRACTORS SHALL VISIT THIS BUILDING AND TENANT AREA AND BE FAMILIAR WITH ALL THE EXISTING CONDITIONS PRIOR TO CONTRACT AWARD