

FLOOR PLAN - CONSTRUCTION NOTES - PART TWO
 Scale: 1/4" = 1'-0"
 REFER TO SHEET A11 FOR ROOM FINISH SCHEDULE AND FINISH MATERIALS
 REFER TO SHEET A2 FOR DIMENSIONAL PLAN
 REFER TO SHEET A3 FOR CONSTRUCTION NOTES PLAN
 REFER TO SHEET A3.1 FOR CONSTRUCTION NOTES
 REFER TO SHEET A4 FOR CEILING PLAN
 REFER TO SHEET A4 FOR DOOR SCHEDULE

FLOOR PLAN - CONSTRUCTION NOTES - PART ONE
 Scale: 1/4" = 1'-0"
 REFER TO SHEET A11 FOR ROOM FINISH SCHEDULE AND FINISH MATERIALS
 REFER TO SHEET A2 FOR DIMENSIONAL PLAN
 REFER TO SHEET A3 FOR CONSTRUCTION NOTES PLAN
 REFER TO SHEET A3.1 FOR CONSTRUCTION NOTES
 REFER TO SHEET A4 FOR CEILING PLAN
 REFER TO SHEET A4 FOR DOOR SCHEDULE

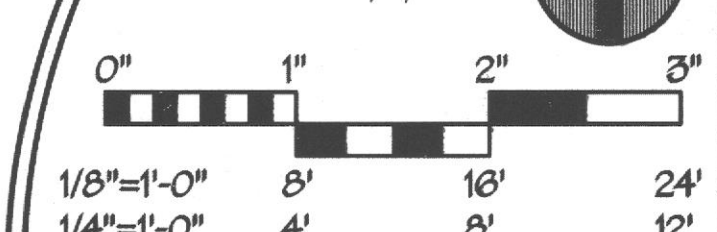
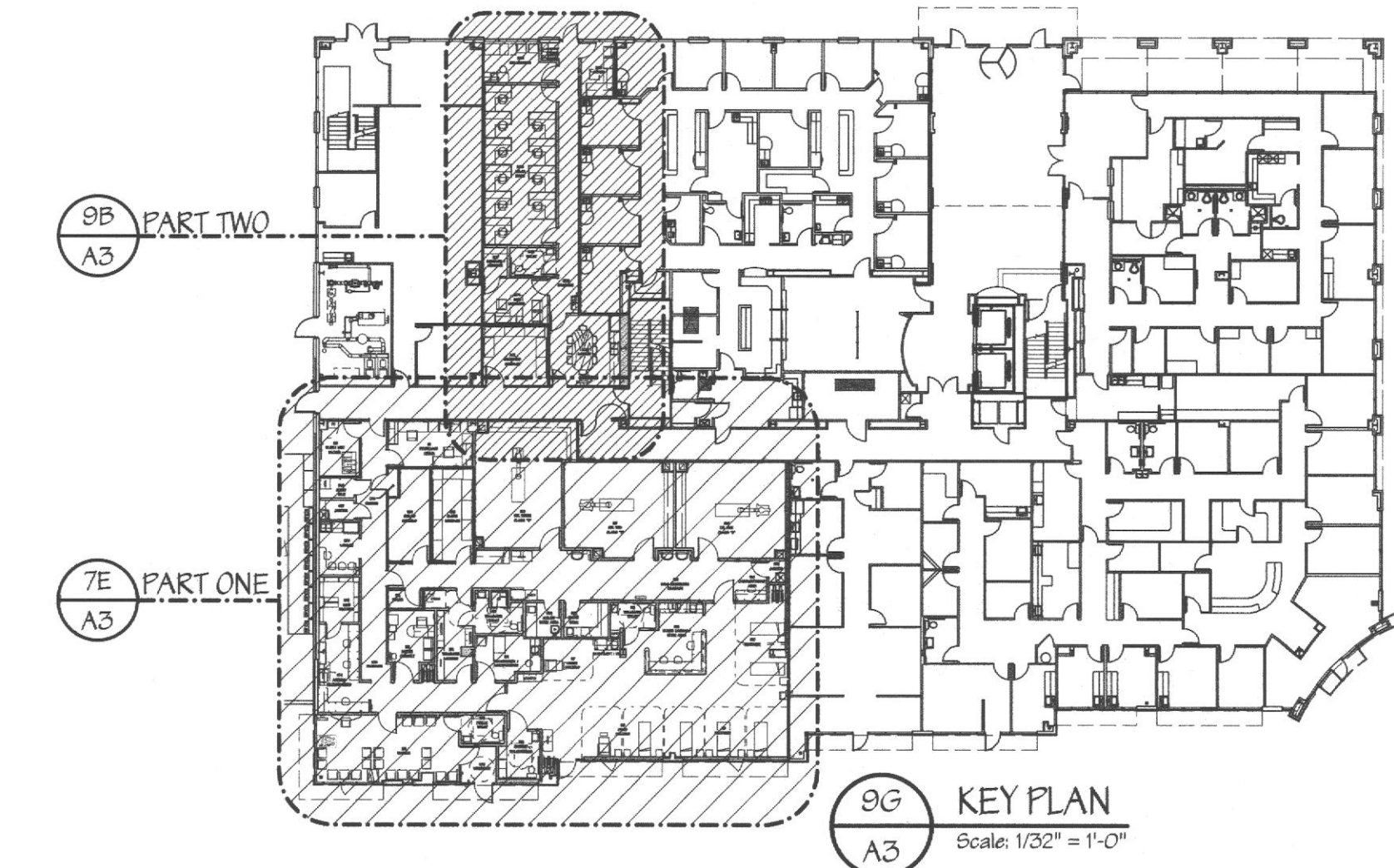

FLOOR PLAN - CONSTRUCTION NOTES

REVISIONS		DRAWING NO.
REV#	DATE	DESCRIPTION

TENANT RENOVATIONS FOR:
LIFELINE Access Center
 4805 Montgomery Rd.,
 Cincinnati, OH 45212

DRAWING NO. **A3**
 SHEET OF
 DATE 6/20/17
 DRAWN BY
 JOB NUMBER
 CHECKED BY 11232

ISSUED FOR BUILDING PERMIT

d p c e
 don perm consulting engineer

1301 Solana Blvd., 4th Fl.
 Building 1, Suite 702
 Phone: 817-410-8558
 Fax: 817-251-8411

Lifeline Project Manager
In Syn c
 1215 Old Fayetteville Road
 Office 410-462-8006
 Whiteford, MD 21160
 Fax 410-462-8046

David A. Udkow, Architect
 11891 North 113th Way
 Scottsdale, AZ 85259
 Office 480-614-5385
 Fax 480-614-0208
 Email - davidudkow@cox.net

NOTE: CONTRACTOR AND SUB-CONTRACTORS SHALL VISIT THIS BUILDING AND TENANT AREA AND BE FAMILIAR WITH ALL THE EXISTING CONDITIONS PRIOR TO CONTRACT AWARD