



711 N. FIELDER RD.  
 ARLINGTON, TX 76012  
 PH: (817) 635-5696  
 FAX: (817) 635-5699

**DAWSON VAN ORDEN**  
 ARCHITECT  
 1205 OLD FLYVILLE ROAD  
 WILKINSON, MD 21890  
 PH: 410-462-8006  
 FAX: 410-462-8046

**Lifeline Project Manager**  
**In Sync**  
 1205 Old Flyville Road  
 Wilkinson, MD 21890  
 Office: 410-462-8006  
 Fax: 410-462-8046

**Vascular Surgery  
 Center of Central  
 Arkansas**  
 11771 Maumelle Blvd  
 North Little Rock, AR 72113



REVISIONS

'A'	ISSUE	DATE
'B'	ISSUE	DATE
'C'	ISSUE	DATE
'D'	ISSUE	DATE
'E'	ISSUE	DATE
'F'	ISSUE	DATE
'G'	ISSUE	DATE
'H'	ISSUE	DATE

FLOOR PLAN  
 WALL TYPES  
 NOTES

SHEET NUMBER

**A1**

**ROOM FINISH MATERIALS FROM ORIGINAL PROJECT REQUIREMENTS NEW MATERIALS TO MATCH AS CLOSE AS POSSIBLE:**

**FLOOR FINISH:**  
 CPT = CARPET - Shaw Contract Group, Style: Emotion Tile #583043  
 Color: Floating Reedy, #4000  
 SV-WD = SHEET VINYL - Shaw LQ NaturalLife  
 Style: 0000V, Color: American Cherry, #000303  
 SV = SHEET VINYL - Shaw LQ NaturalLife  
 Style: 0000V, Color: Continental Sand, #0732N  
 (Both SV-WD and SV to have Heat Waxed Seams)  
 SOV = SEAMLESS WELDED SEAM SHEET VINYL -  
 Armstrong Modgrid - Color: Desert Sand #8430  
 (To be used in conjunction w/ Matching Armstrong Weld Bead)

**CEILING TYPE:**  
 AC = TYPICAL ACCOUSTICAL TILE (2'x4')  
 AC-1 = SCRIBABLE ACCOUSTICAL TILE (2'x4')  
 INSTALLED WITH HOLD DOWN CLIPS  
 GWB/PF = GYPSUM WALL BOARD / PAINTED

**PLASTIC LAMINATE:**  
 PROVIDE THE FOLLOWING LAMINATE COLORS PER THE INT. ELEVATIONS:  
 FLAS LAM "A" - COUNTERTOPS -  
 Formica 2626-46  
 "Titanium" Exchange Finish  
 FLAS LAM "B" - CABINETS -  
 Formica 7245-68  
 "Vivid Figured Anigre" Matte Finish

**DOORS / FRAMES:**  
 DOORS = Algoma Handmade, Solid White Birch  
 Stained to Match Cabinet Laminate  
 DOOR FRAME PAINT COLOR:  
 PFC = PAINTED - SHERWIN WILLIAMS - ALYD  
 PAINT "SILVER-BRITE ALUMINUM PAINT"

**SPECIALTY ITEMS:**  
 DOOR AND WALL PROTECTION (CONTACT NATIONAL ACCOUNT SALES REPRESENTATIVE IN/PO CONSTRUCTION TEL: 800-234-7749)  
 CORNER GUARDS - InPro Custom #0239  
 DOOR GUARDS - InPro Custom #0239  
 WALL GUARDS - InPro Tempair #0264 with Outrigger Inset

**BASE TYPE:**  
 RB = RUBBER STRAIGHT - Koppo TP 77122 1/8"  
 TPK Rubber Color: "Blackskin" 130  
 RC = RUBBER COVE - Koppo TP 77122 1/8"  
 TPK Rubber Color: "Blackskin" 130  
 SV = 4" HIGH SHEET VINYL-INTRIGRAL COVE BASE WITH 3/4" RADIUS COVE AND CONTINUOUS ALUMINUM CAP.  
 SOV = SEAMLESS WELDED SEAM SHEET VINYL-INTRIGRAL COVE 6" HIGH WITH 3/4" RADIUS COVE AND CONTINUOUS ALUMINUM CAP.

**WALL FINISH:**  
 FT-A = PAINTED - PRIMARY PAINT - Benjamin Moore Color: "Natural Linen" #906 - Egg Shell  
 FT-B = PAINTED - FEATURE PAINT ONE - Benjamin Moore Color: "Stillwater" #260 - Egg Shell  
 FT-C = PAINTED - FEATURE PAINT TWO - Benjamin Moore Color: "Jackson Tan" #914-6 - Egg Shell  
 FT-D = PAINTED - EPXY - Benjamin Moore, Super-Gloss HP Acrylic Epoxy, Color: "White Down" #970  
 FT-E = CEILING - Benjamin Moore - Ceiling White  
 CR-1 = STAIN GRADE WOOD CHAIR RAIL, 4" HIGH Stained to match wood tone.

**PL-1 PLASTIC LAMINATE FEATURE WALL**  
 Formica 7245-68  
 "Vivid Figured Anigre" Matte Finish

REFER TO FLOOR PLAN FOR LOCATIONS OF FEATURE WALLS

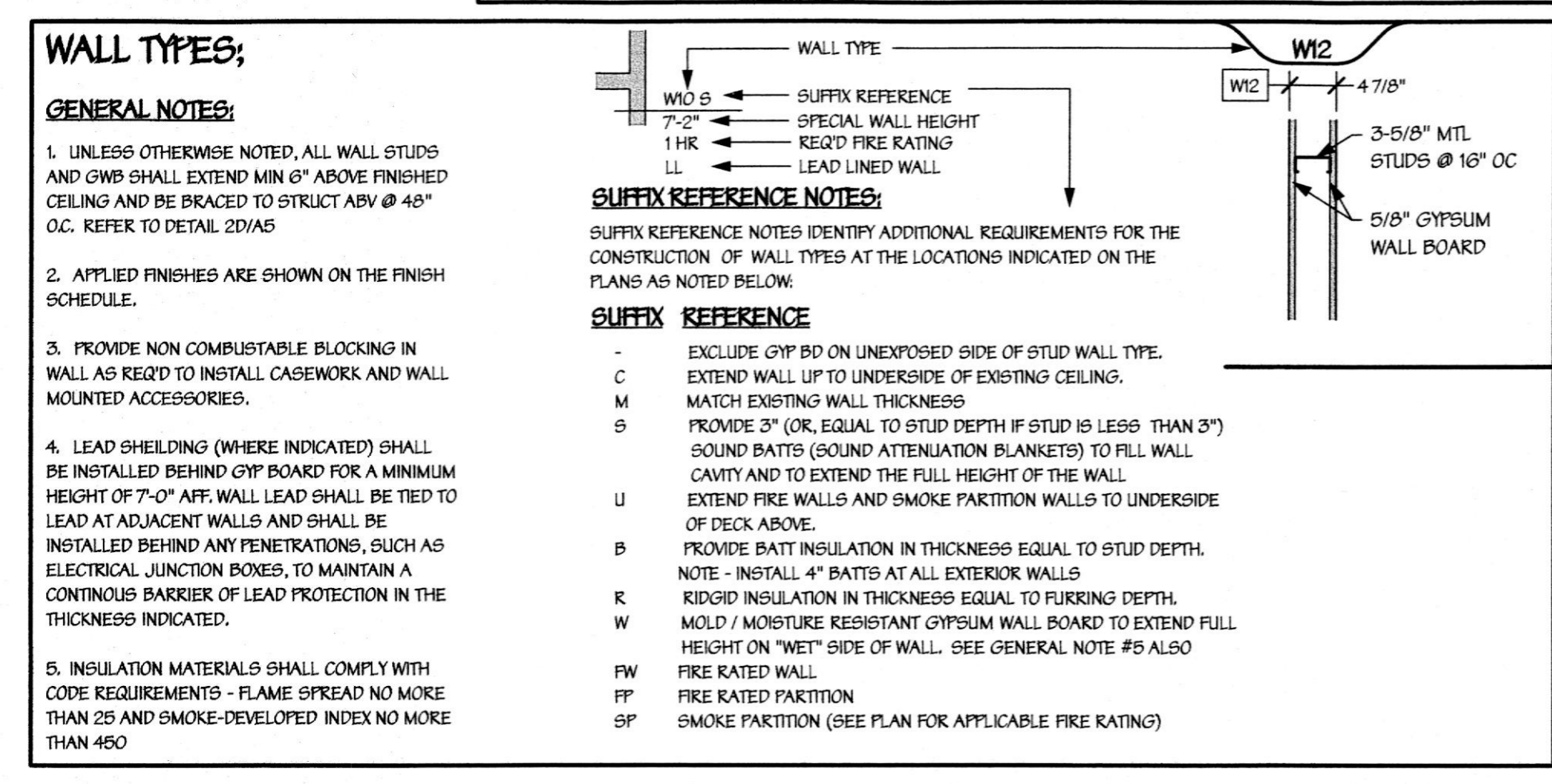

**CONSTRUCTION NOTES**

27 CONSTRUCTION NOTE DESIGNATION

NOTE - CONTRACTOR SHALL REFER TO THE ORIGINAL CONSTRUCTION / PERMIT DRAWINGS FOR THIS PROJECT (DATED 9/25/14) FOR THE ORIGINAL PROJECT REQUIREMENTS, PARTICULARLY WHEN THE FOLLOWING NOTES INDICATE "MATCH EXISTING"

- ALIGN NEW WALL WITH EXISTING WALL. BLEND NEW WORK INTO EXISTING TO CREATE A SMOOTH AND UNIFORM APPEARANCE. NEW WALL TO EXTEND TO UNDERSIDE OF EXISTING CEILING PER WALL SUFFIX "C"
- PAINT NEW WALL AND ADJACENT EXISTING WALL FROM CORNER TO CORNER TO MATCH EXISTING. INSTALL NEW FLOOR BASE MATCHING EXISTING. INSTALL NEW FRP MATCHING EXISTING.
- NEW CORNER GUARD TO MATCH EXISTING
- NEW WOOD DOOR AND HM FRAME TO MATCH EXISTING. DOOR TO BE 3'-0" WIDE BY 7'-0" HIGH AND SHALL HAVE A NARROW SIDELIGHT PANEL MATCHING OTHER EXISTING DOORS WITH NARROW SIDELIGHT PANELS. HARDWARE SHALL MATCH EXISTING AND SHALL INCLUDE A DOOR CLOSURE AND CYLINDER LOCK EQUAL TO TRILGLOY DL2775 BY ALARM LOCK. LOCK SHALL BE PROVIDED WITH PASSAGE MODE/FUNCTION AND OTHER HARDWARE FOR A COMPLETE INSTALLATION. FINISH DOOR AND FRAME TO MATCH EXISTING. REFER TO TITLE SHEET, SPECIAL REQUIREMENTS FOR ORIGINAL CONSTRUCTION DRAWINGS. REFER TO THESE DRAWINGS FOR THE "MATCH EXISTING" REQUIREMENTS. THE HARDWARE FOR THIS DOOR SHALL MATCH THE EXISTING TYPE "B" HARDWARE REQUIREMENTS.
- INSTALL MEDICAL VACUUM PUMP IN THIS ROOM. NOTE THAT ROUGH-INS FOR THIS EQUIPMENT WERE INSTALLED AND SHOULD BE READY FOR THE INSTALLATION OF THIS EQUIPMENT. THE MEDICAL PUMP SHALL BE AS FOLLOWS:  
 MEDICAL VACUUM EQUIPMENT SHALL BE SIMILAR TO OHIO MEDICAL HEALTHCARE® SYSTEM MODEL NO 6300B-12V PACKAGED SYSTEM - 3 HP ELECTRIC MOTOR DRIVEN PUMPS, A 60 GALLON RECEIVER AND A UL LISTED DUPLEX ELECTRICAL CONTROL SYSTEM MOUNTED IN A NEMA 12 ENCLOSURE. ALL SYSTEM COMPONENTS SHALL BE INSTALLED FOR A COMPLETE INSTALLATION AND PER MANUFACTURER'S RECOMMENDATIONS AND STANDARD DETAILS.  
 A. FOR MOTOR PROTECTION, THE EQUIPMENT SHOULD NOT BE OPERATED IN AN AMBIENT TEMPERATURE ABOVE 104°F.  
 B. EQUIPMENT CONFORMS TO THE NATIONAL ELECTRICAL CODE.  
 C. THE SYSTEM SHALL MEET THE CURRENT IFC AND NFPA 99 REQUIREMENTS.  
 D. SYSTEM MUST BE CERTIFIED BY AN APPROVED MEDICAL GAS CERTIFICATION COMPANY AFTER INSTALLATION"
- ADD A SECOND MEDICAL VACUUM OUTLET ADJACENT TO THE EXISTING MEDICAL VACUUM OUTLET IN THIS AREA. NEW OUTLET TO MATCH EXISTING AND INCLUDE SLIDE. THE INTENT IS THAT THE PROCEDURE ROOM HAVE A TOTAL OF THREE MEDICAL VACUUM OUTLETS. TIE INTO EXISTING SYSTEM PER NFPA REQUIREMENTS AND HAVE SYSTEM RECERTIFIED MEETING REQUIREMENTS OF 2012 NFPA 99.
- ADD TWO ADDITIONAL MEDICAL VACUUM OUTLETS ADJACENT TO THE EXISTING MEDICAL VACUUM OUTLET IN THIS AREA. NEW OUTLET TO MATCH EXISTING AND SHALL INCLUDE SLIDE. THE INTENT IS THAT EACH RECOVERY BAY HAVE A TOTAL OF THREE MEDICAL VACUUM OUTLETS. TIE INTO EXISTING SYSTEM PER NFPA REQUIREMENTS AND HAVE SYSTEM RECERTIFIED MEETING REQUIREMENTS OF 2012 NFPA 99.
- REFER TO DEMOLITION PLAN FOR REMOVAL OF EXISTING SCRUB SINK IN THIS AREA. REFER TO PLUMBING PLANS FOR INSTALLATION OF NEW SINK. REINSTALLED EXISTING STAINLESS STEEL SHELF AND PAPER TOWEL DISPENSER. REWORK FRP AND CORNER GAUDES AND PAINT WALL AS REQUIRED TO MATCH EXISTING AND CREATE A "LIKE NEW" APPEARANCE.
- REFER TO DEMOLITION PLAN FOR REMOVAL OF EXISTING CEILING TILES IN THIS AREA. INSTALL NEW CEILING TILES TYPE "AC-1" MATCHING EXISTING TILES USED IN CLEAN ROOM.
- REFER TO ELECTRICAL DRAWINGS FOR NEW OUTLET IN THIS AREA FOR CRASH CART.
- 6" DIAMETER STEEL BOLLARDS FILLED WITH CONCRETE AROUND GENERATOR TO PROTECT FROM TRAFFIC. PROVIDE A MINIMUM OF 8, SPACED MAXIMUM OF 4' AND LOCATED 4' FROM EXPOSED (TO TRAFFIC) SIDE OF GENERATOR. BOLLARDS ARE TO EXTEND A MIN OF 42" BELOW GRADE AND BE 42" HIGH. STEEL SHALL BE GALVANIZED. PROVIDE SMOOTH BOLLARD POST SLEEVE, 6" HDPE DOME TOP IN YELLOW TO MATCH ITEM #19F238819YL BY GLOBAL INDUSTRIAL.
- REFER TO ELECTRICAL DRAWINGS FOR NEW TRANSFER SWITCH IN THIS AREA.
- REFER TO ELECTRICAL DRAWINGS FOR NEW GENERATOR STATUS ANNUNCIATOR PANEL. CONTRACTOR TO COORDINATE WITH OWNER FOR EXACT LOCATION OF THIS PANEL. REVIEW DURING BIDDING PERIOD TO MAKE SURE OWNER'S PREFERRED LOCATION IS COVERED IN CONTRACT PRICE.
- NEW CONCRETE PAD FROM MINIMUM 3,500 PSI CONCRETE. REFER TO DETAIL ON ELECTRICAL DRAWINGS. NEW PAD TO BE LEVEL AND HAVE A SMOOTH FINISH. COORDINATE SIZE WITH GENERATOR AND MANUFACTURER'S RECOMMENDATIONS.
- REFER TO ELECTRICAL DRAWINGS FOR NEW GENERATOR DISCONNECT. CONTRACTOR TO COORDINATE WITH LANDLORD AND OWNER FOR EXACT LOCATION OF THIS PANEL. REVIEW DURING BIDDING PERIOD TO MAKE SURE PREFERRED LOCATION IS COVERED IN CONTRACT PRICE. CAREFULLY REMOVE EXISTING CONSTRUCTION AS REQUIRED TO INSTALL NEW ELECTRICAL CONDUITS AND ASSOCIATED WORK. ALL WORK TO BE COORDINATED WITH LANDLORD. SEAL ALL NEW PENETRATIONS TO CREATE A WEATHER TIGHT INSTALLATION. ALL WORK TO THE EXTERIOR OF THE BUILDING TO BE TO LANDLORD'S SATISFACTION.

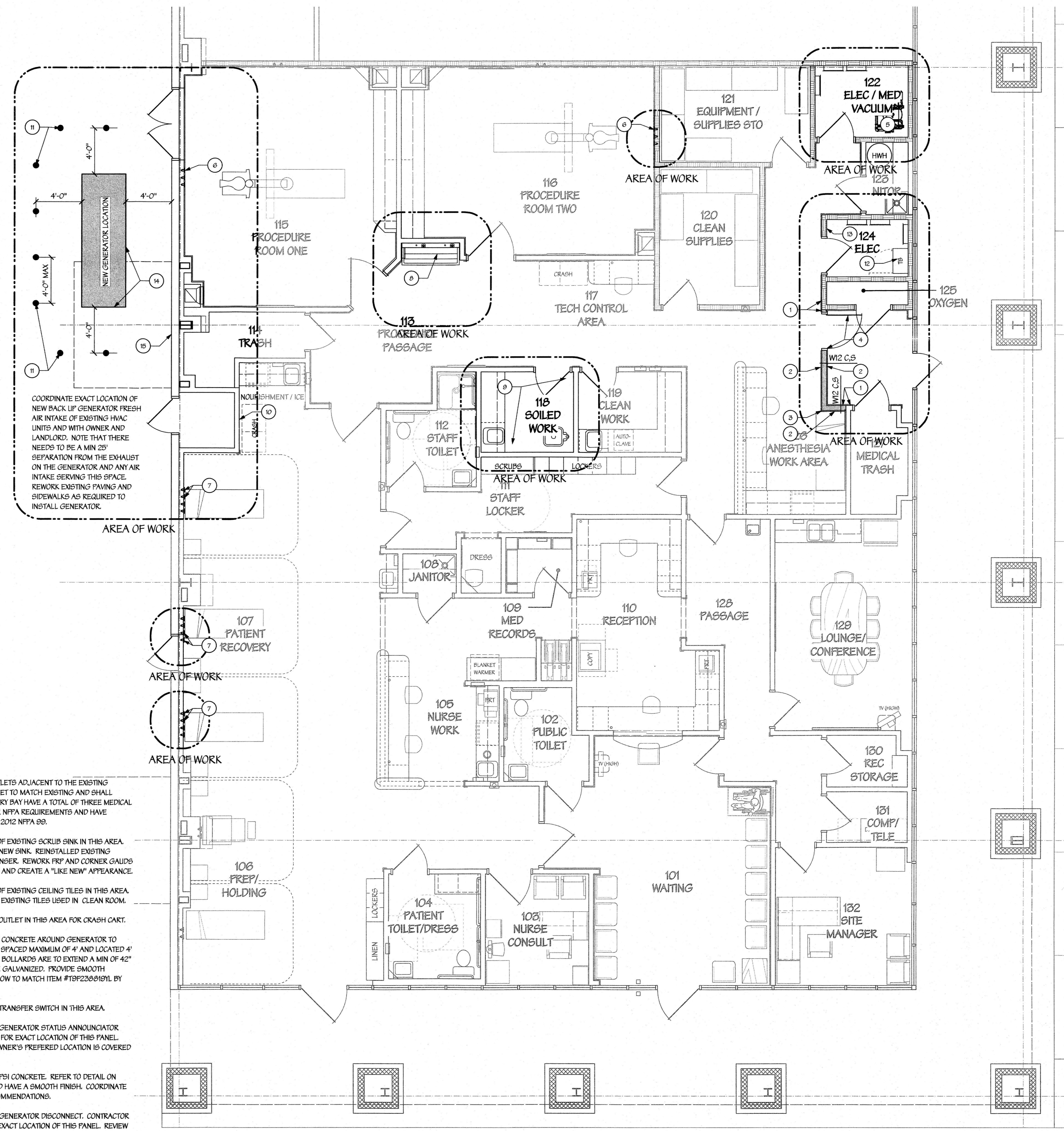

**5F FLOOR PLAN**  
 Scale: 1/4" = 1'-0"

**GENERAL NOTES:**  
 ALL UNDER FLOOR PLUMBING ROUGH-INS, DEMOLITION AND OTHER LOUD WORK SHALL BE DONE DURING OFF-HOURS AND CAREFULLY COORDINATED WITH LANDLORD TO INSURE MINIMAL DISRUPTION TO ADJACENT SPACES.

ALL ACCESSIBLE CONTROLS, OPERATING MECHANISMS AND HARDWARE SHALL COMPLY WITH SECTION 309 OF ICC/ANSI A117.1.

NOTE: CONTRACTOR AND SUB-CONTRACTORS SHALL VISIT THIS BUILDING AND TENANT AREA AND BE FAMILIAR WITH ALL THE EXISTING CONDITIONS PRIOR TO CONTRACT AWARD