



711 N. FIELDER RD.  
ARLINGTON, TX 76012  
PH: (817) 635-5696  
FAX: (817) 635-5699

655 Westport Parkway  
Suite 300  
Grapevine, Texas 76051  
Phone: 817-410-2859  
Fax: 817-251-8411

**d p c e**  
don penn consulting engineer

Lifeline Project Manager  
**In5ync**

Whiteford, MD 21160  
1215 Old Frysedale Road  
Office 410-462-8006  
Fax 410-462-8046

**ACCESS CENTER  
LIFELINE**  
1171 Maumelle Blvd  
North Little Rock, AR 72113



REVISIONS

NO.	ISSUE DATE	DESCRIPTION
1		ISSUE DATE
2		ISSUE DATE
3		ISSUE DATE
4		ISSUE DATE
5		ISSUE DATE
6		ISSUE DATE
7		ISSUE DATE
8		ISSUE DATE
9		ISSUE DATE

**FLOOR PLAN AND ROOM SCHEDULE**

SHEET NUMBER

**A1**

**ROOM FINISH SCHEDULE:**

Room #	Scheduled Name	Floor Fin	Base Type	Wall Fin	Ceiling Type	Ceiling Ht	Trim	Special	Notes
101	WAITING	SV	KC	WALL TYPE TWO	AC	2'-0"	PT-F		NOTE #1
102	PUBLIC TOILET	SV	KC	WALL TYPE ONE	AC	2'-0"	PT-F		NOTE #1
103	NURSE CONSULT	SV	KC	PT-A	AC	2'-0"	PT-F		NOTE #1
104	PATIENT TOILET/DRESS	SV	KC	WALL TYPE ONE	AC	2'-0"	PT-F		*2" HIGH WAINECOT / USE WK UWB
105	NURSE WORK	SV	KC	PT-A	AC	2'-0"	PT-F		NOTE #1
106	PREP/HOLDING	SV	KC	PT-A	AC	2'-0"	PT-F		NOTE #1
107	PATIENT RECOVERY	SV	KC	PT-A	AC	2'-0"	PT-F		NOTE #1
108	JANITOR	SV	KC	PT-A	AC	2'-0"	PT-F		*EFCO / SCKURABLE
109	MEDICAL RECORDS	SV	KC	PT-A	AC	2'-0"	PT-F		NOTE #1
110	RECEPTION	SV	KC	PT-A	AC	2'-0"	PT-F		NOTE #1
111	STAFF LOCKERS	SV	KC	PT-A	AC	2'-0"	PT-F		NOTE #1
112	STAFF TOILET	SV	SV	WALL TYPE ONE	AC	2'-0"	PT-F		*2" HIGH WAINECOT / USE WK UWB
113	PROCEDURE PASSAGE	SV	SV	PT-A	AC	2'-0"	PT-F		NOTE #1
114	TRASH	SV	SV	PT-A	AC	2'-0"	PT-F		NOTE #1
115	PROCEDURE ROOM ONE	SV	SV	PT-A	AC	2'-0"	PT-F		*EFCO / SCKURABLE
116	PROCEDURE ROOM TWO	SV	SV	PT-A	AC	2'-0"	PT-F		*EFCO / SCKURABLE
117	TECH CONTROL AREA	SV	SV	PT-A	AC	2'-0"	PT-F		NOTE #1
118	SOILED WORK AREA	SV	SV	PT-F	AC	2'-0"	PT-F		*EFCO / SCKURABLE
119	CLEAN WORK AREA	SV	SV	PT-F	AC	2'-0"	PT-F		*EFCO / SCKURABLE
120	CLEAN SUPPLIES	SV	SV	PT-A	AC	2'-0"	PT-F		
121	EQUIPMENT / SUPPLIES STO	SV	SV	PT-A	AC	2'-0"	PT-F		
122	ELEC / MED VACUUM	SV	SV	PT-A	AC	2'-0"	PT-F		
123	JANITOR	SV	SV	PT-A	AC	2'-0"	PT-F		*EFCO / SCKURABLE
124	ELEC	SV	SV	PT-A	AC	2'-0"	PT-F		
125	OXYGEN	SV	SV	PT-A	AC	2'-0"	PT-F		
126	ANESTHESIA WORK AREA	SV	SV	PT-A	AC	2'-0"	PT-F		*1" H.KATED CLR 2" S/S (SEE DETL 20' AS)
127	MEDICAL TRASH	SV	SV	PT-A	AC	2'-0"	PT-F		NOTE #1
128	PASSAGE	SV	SV	PT-A	AC	2'-0"	PT-F		NOTE #1
129	LOUNGE/CONFERENCE	SV	SV	PT-A	AC	2'-0"	PT-F		NOTE #1
130	REC STORAGE	SV	SV	PT-A	AC	2'-0"	PT-F		
131	COMP/TELE	SV	SV	PT-A	AC	2'-0"	PT-F		
132	SITE MANAGER	SV	SV	PT-A	AC	2'-0"	PT-F		NOTE #1

NOTES:  
ALL FINISHES SHALL BE IN ACCORDANCE WITH IPC 2001 CLASS B FLAME (SPREAD 20-75, SMOKE-DEVELOPED 0-40)  
ALL FLOOR FINISHES SHALL BE SLIP RESISTANT IN ACCORDANCE WITH IPC 2002.20

**ROOM FINISH MATERIALS:**

**FLOOR FINISH:**  
CCT = CARPET - Show Contract Carpet, Etchle Embrace Tile #30245  
CCT4 = Carpet (Berber) #30327  
EWWD = SHEET VINYL WALL - Show L2 Nonantidote  
EFLR = SHEET VINYL - Show L2 Nonantidote  
EFLR3 = SHEET VINYL - Show L2 Nonantidote  
EFLR4 = SHEET VINYL - Show L2 Nonantidote  
EFLR5 = SHEET VINYL - Show L2 Nonantidote  
EFLR6 = SHEET VINYL - Show L2 Nonantidote  
EFLR7 = SHEET VINYL - Show L2 Nonantidote  
EFLR8 = SHEET VINYL - Show L2 Nonantidote  
EFLR9 = SHEET VINYL - Show L2 Nonantidote  
EFLR10 = SHEET VINYL - Show L2 Nonantidote  
EFLR11 = SHEET VINYL - Show L2 Nonantidote  
EFLR12 = SHEET VINYL - Show L2 Nonantidote  
EFLR13 = SHEET VINYL - Show L2 Nonantidote  
EFLR14 = SHEET VINYL - Show L2 Nonantidote  
EFLR15 = SHEET VINYL - Show L2 Nonantidote  
EFLR16 = SHEET VINYL - Show L2 Nonantidote  
EFLR17 = SHEET VINYL - Show L2 Nonantidote  
EFLR18 = SHEET VINYL - Show L2 Nonantidote  
EFLR19 = SHEET VINYL - Show L2 Nonantidote  
EFLR20 = SHEET VINYL - Show L2 Nonantidote  
EFLR21 = SHEET VINYL - Show L2 Nonantidote  
EFLR22 = SHEET VINYL - Show L2 Nonantidote  
EFLR23 = SHEET VINYL - Show L2 Nonantidote  
EFLR24 = SHEET VINYL - Show L2 Nonantidote  
EFLR25 = SHEET VINYL - Show L2 Nonantidote  
EFLR26 = SHEET VINYL - Show L2 Nonantidote  
EFLR27 = SHEET VINYL - Show L2 Nonantidote  
EFLR28 = SHEET VINYL - Show L2 Nonantidote  
EFLR29 = SHEET VINYL - Show L2 Nonantidote  
EFLR30 = SHEET VINYL - Show L2 Nonantidote  
EFLR31 = SHEET VINYL - Show L2 Nonantidote  
EFLR32 = SHEET VINYL - Show L2 Nonantidote  
EFLR33 = SHEET VINYL - Show L2 Nonantidote  
EFLR34 = SHEET VINYL - Show L2 Nonantidote  
EFLR35 = SHEET VINYL - Show L2 Nonantidote  
EFLR36 = SHEET VINYL - Show L2 Nonantidote  
EFLR37 = SHEET VINYL - Show L2 Nonantidote  
EFLR38 = SHEET VINYL - Show L2 Nonantidote  
EFLR39 = SHEET VINYL - Show L2 Nonantidote  
EFLR40 = SHEET VINYL - Show L2 Nonantidote  
EFLR41 = SHEET VINYL - Show L2 Nonantidote  
EFLR42 = SHEET VINYL - Show L2 Nonantidote  
EFLR43 = SHEET VINYL - Show L2 Nonantidote  
EFLR44 = SHEET VINYL - Show L2 Nonantidote  
EFLR45 = SHEET VINYL - Show L2 Nonantidote  
EFLR46 = SHEET VINYL - Show L2 Nonantidote  
EFLR47 = SHEET VINYL - Show L2 Nonantidote  
EFLR48 = SHEET VINYL - Show L2 Nonantidote  
EFLR49 = SHEET VINYL - Show L2 Nonantidote  
EFLR50 = SHEET VINYL - Show L2 Nonantidote  
EFLR51 = SHEET VINYL - Show L2 Nonantidote  
EFLR52 = SHEET VINYL - Show L2 Nonantidote  
EFLR53 = SHEET VINYL - Show L2 Nonantidote  
EFLR54 = SHEET VINYL - Show L2 Nonantidote  
EFLR55 = SHEET VINYL - Show L2 Nonantidote  
EFLR56 = SHEET VINYL - Show L2 Nonantidote  
EFLR57 = SHEET VINYL - Show L2 Nonantidote  
EFLR58 = SHEET VINYL - Show L2 Nonantidote  
EFLR59 = SHEET VINYL - Show L2 Nonantidote  
EFLR60 = SHEET VINYL - Show L2 Nonantidote  
EFLR61 = SHEET VINYL - Show L2 Nonantidote  
EFLR62 = SHEET VINYL - Show L2 Nonantidote  
EFLR63 = SHEET VINYL - Show L2 Nonantidote  
EFLR64 = SHEET VINYL - Show L2 Nonantidote  
EFLR65 = SHEET VINYL - Show L2 Nonantidote  
EFLR66 = SHEET VINYL - Show L2 Nonantidote  
EFLR67 = SHEET VINYL - Show L2 Nonantidote  
EFLR68 = SHEET VINYL - Show L2 Nonantidote  
EFLR69 = SHEET VINYL - Show L2 Nonantidote  
EFLR70 = SHEET VINYL - Show L2 Nonantidote  
EFLR71 = SHEET VINYL - Show L2 Nonantidote  
EFLR72 = SHEET VINYL - Show L2 Nonantidote  
EFLR73 = SHEET VINYL - Show L2 Nonantidote  
EFLR74 = SHEET VINYL - Show L2 Nonantidote  
EFLR75 = SHEET VINYL - Show L2 Nonantidote  
EFLR76 = SHEET VINYL - Show L2 Nonantidote  
EFLR77 = SHEET VINYL - Show L2 Nonantidote  
EFLR78 = SHEET VINYL - Show L2 Nonantidote  
EFLR79 = SHEET VINYL - Show L2 Nonantidote  
EFLR80 = SHEET VINYL - Show L2 Nonantidote  
EFLR81 = SHEET VINYL - Show L2 Nonantidote  
EFLR82 = SHEET VINYL - Show L2 Nonantidote  
EFLR83 = SHEET VINYL - Show L2 Nonantidote  
EFLR84 = SHEET VINYL - Show L2 Nonantidote  
EFLR85 = SHEET VINYL - Show L2 Nonantidote  
EFLR86 = SHEET VINYL - Show L2 Nonantidote  
EFLR87 = SHEET VINYL - Show L2 Nonantidote  
EFLR88 = SHEET VINYL - Show L2 Nonantidote  
EFLR89 = SHEET VINYL - Show L2 Nonantidote  
EFLR90 = SHEET VINYL - Show L2 Nonantidote  
EFLR91 = SHEET VINYL - Show L2 Nonantidote  
EFLR92 = SHEET VINYL - Show L2 Nonantidote  
EFLR93 = SHEET VINYL - Show L2 Nonantidote  
EFLR94 = SHEET VINYL - Show L2 Nonantidote  
EFLR95 = SHEET VINYL - Show L2 Nonantidote  
EFLR96 = SHEET VINYL - Show L2 Nonantidote  
EFLR97 = SHEET VINYL - Show L2 Nonantidote  
EFLR98 = SHEET VINYL - Show L2 Nonantidote  
EFLR99 = SHEET VINYL - Show L2 Nonantidote  
EFLR100 = SHEET VINYL - Show L2 Nonantidote

**WALL FINISH:**  
PT-A = PAINTED - PRIMAID PAINT  
Program Master Color: "Normal Light" #335 - Egg Shell  
PT-F = PAINTED - FEATURE PAINT ONE  
Program Master Color: "Shiloh" #302 - Egg Shell  
PT-C = PAINTED - FEATURE PAINT TWO  
Program Master Color: "Cocktail" #331 - Egg Shell  
PT-D = PAINTED - EFCO  
Program Master: "Super Dry" #1 Acrylic Epoxy  
Color: "White" (Dart #2)  
PT-E = CEILING  
Program Master: "Cotton White"

**DOORS / FRAMES:**  
DOORS = Aegion Hardwood, Blood White Finish  
Cabinets: Aegion Cabinet Laminate  
DOOR FRAME PAINT COLOR:  
PT-F = PAINTED - SHERWIN WILLIAMS - ALKID  
PAINT SILVER-BRITE ALUMINUM PAINT

**CEILING TYPE:**  
AC = TYPICAL ACCEUSTICAL TILE (2'x4')  
AC-1 = SCKURABLE ACCEUSTICAL TILE (2'x4')  
INSTALLED WITH 1/2" DOWN CLIPS  
CWB-PT = GYPSUM WALL BOARD - PAINTED

**PLASTIC LAMINATE:**  
PROVIDE THE FOLLOWING LAMINATE COLORS PER THE (REF. ELEVATIONS):  
FLAS-LAM "A" - COUNTERTOPS - Formica 2522-40  
"Tropicana" Etchings Finish  
FLAS-LAM "B" - CABINETS - Formica 2292-50  
"Vital Flavored Anigre" Matte Finish

**SPECIALTY ITEMS:**  
FURNITURE - 2017A000

**DOOR AND WALL PROTECTION:**  
CONTACT NATIONAL ACCOUNT SALES REPRESENTATIVE INFO: CONSTRUCTION TEL: 800-228-7949  
CORNER GUARDS - Info: Corinac #22250  
DOOR GUARDS - Info: Corinac #22250  
WALL GUARDS - Info: Tempcoat #2624 with Optimal Inset

**WALL PROTECTION - FRP - MAKITE FRP "SILVER" #340**  
CORNER CURTAIN PAPER - FROM L201, ALUCA FR POLYESTER CURTICLE FABRIC - Taka-Ten (Order Part), COLOR - Hawthorn  
NYLON MESH "EVAL" (CONTACT JEFF SKELL #81028) RUBBER MARKET - AND MFG: (502-666-8715)

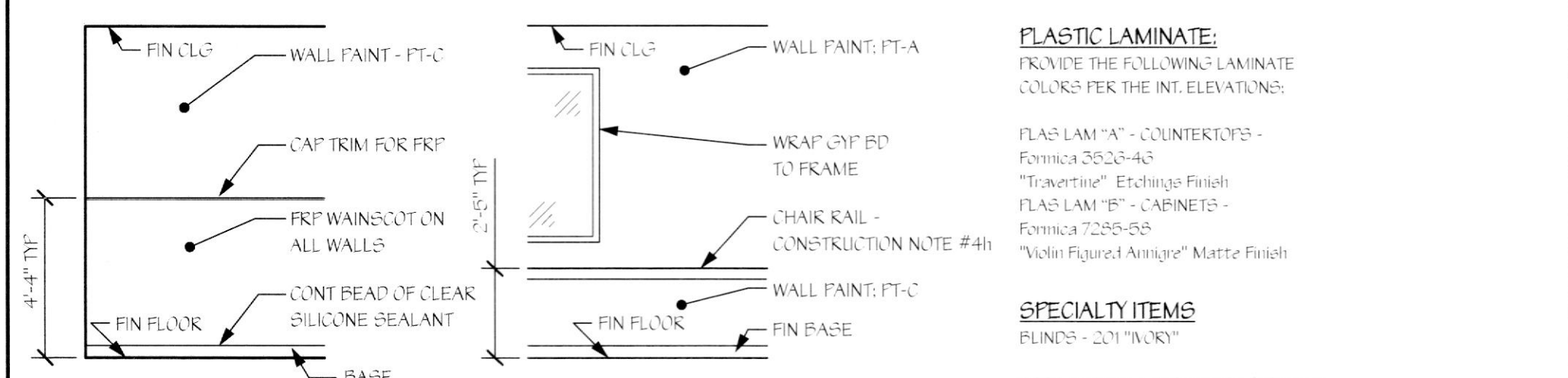

**TOILET ROOM ACCESSORIES:**

MARK	DESCRIPTION	MODEL NO. *	102 PUBLIC TOILET	104 PATIENT DRESS / TOILET	102 TEAM MATE TOILET
PTD	PAPER TOWEL DISPENSER	B-2550	ONE	ONE	ONE
TTD	TOILET TISSUE DISPENSER	B-4288	ONE	ONE	ONE
CPB-1	CSKAP BAK	B-5503A3	ONE	ONE	ONE
CPB-2	CSKAP BAK	B-5503A4	ONE	ONE	ONE
CPB-3	CSKAP BAK - VERTICAL	B-5503A24	ONE	ONE	ONE
MIR	MIRROR (6"X6"X12")	B-405-2430	ONE	ONE	ONE
TSC	TOILET SEAT COVER**	B-4221	ONE	ONE	ONE
FRN	FRAMING WAFER DISPENSER**	B-212	ONE	ONE	ONE

\*\* MODEL NUMBERS SHOWN ARE BY FOPROCK WASHROOM EQUIPMENT

\*\*\* COORDINATE INSTALLATION LOCATION WITH OWNER

NO. IN QUANTITIES OF ACCESSORIES AS NOTED AT EACH TOILET ROOM. SEE TOILET ROOM DETAILS & SECTIONS FOR MOUNTING LOCATIONS & HEIGHTS. PROVIDE ALL MEC WALL BLOCKING REQ'D FOR INSTALLATION.

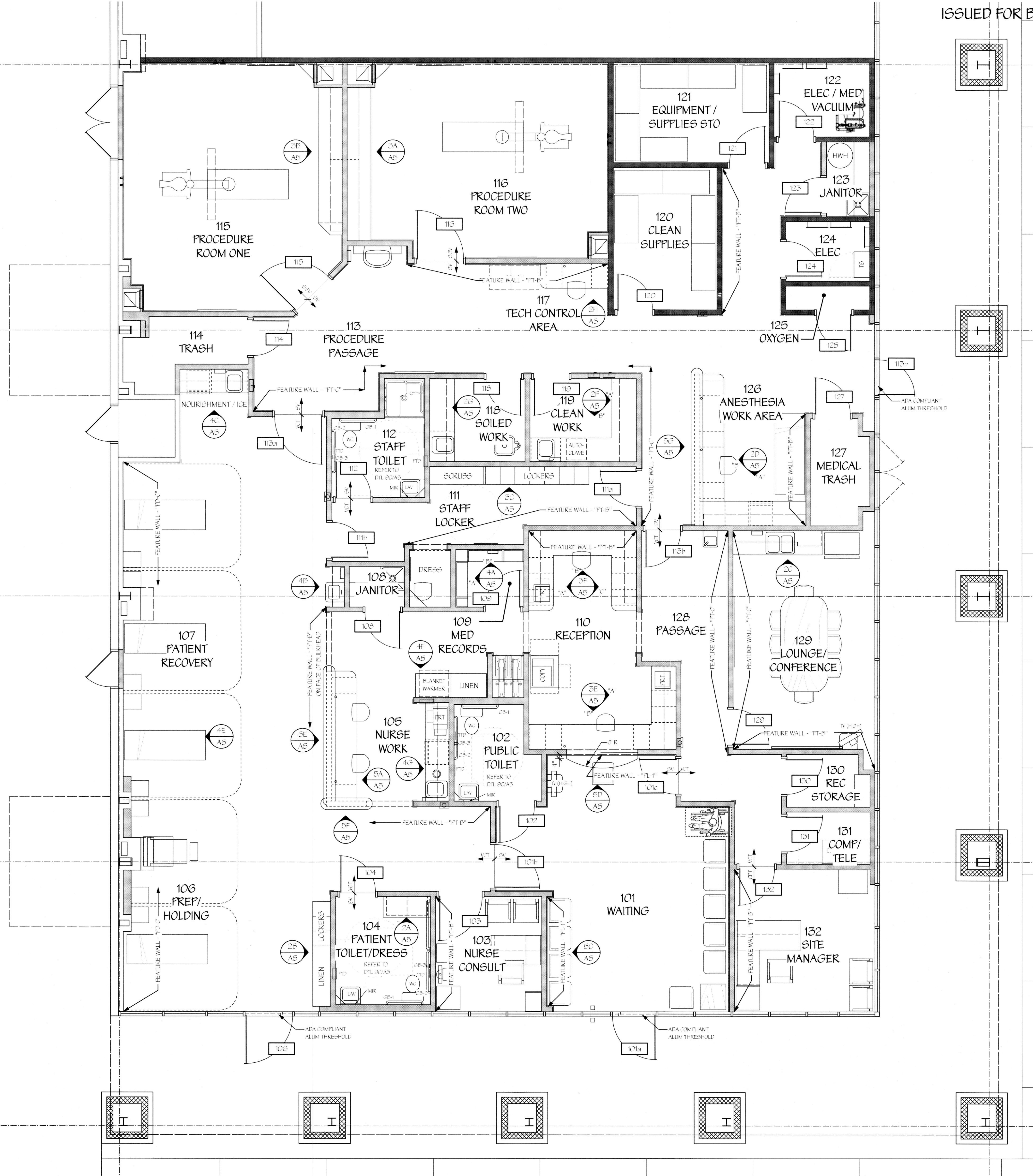

**TOILET ROOM ACCESSORIES:**

MARK	DESCRIPTION	MODEL NO. *	102 PUBLIC TOILET	104 PATIENT DRESS / TOILET	102 TEAM MATE TOILET
PTD	PAPER TOWEL DISPENSER	B-2550	ONE	ONE	ONE
TTD	TOILET TISSUE DISPENSER	B-4288	ONE	ONE	ONE
CPB-1	CSKAP BAK	B-5503A3	ONE	ONE	ONE
CPB-2	CSKAP BAK	B-5503A4	ONE	ONE	ONE
CPB-3	CSKAP BAK - VERTICAL	B-5503A24	ONE	ONE	ONE
MIR	MIRROR (6"X6"X12")	B-405-2430	ONE	ONE	ONE
TSC	TOILET SEAT COVER**	B-4221	ONE	ONE	ONE
FRN	FRAMING WAFER DISPENSER**	B-212	ONE	ONE	ONE

\*\* MODEL NUMBERS SHOWN ARE BY FOPROCK WASHROOM EQUIPMENT

\*\*\* COORDINATE INSTALLATION LOCATION WITH OWNER

NO. IN QUANTITIES OF ACCESSORIES AS NOTED AT EACH TOILET ROOM. SEE TOILET ROOM DETAILS & SECTIONS FOR MOUNTING LOCATIONS & HEIGHTS. PROVIDE ALL MEC WALL BLOCKING REQ'D FOR INSTALLATION.

NOTE: CONTRACTOR AND SUB-CONTRACTORS SHALL VISIT THIS BUILDING AND TENANT AREA AND BE FAMILIAR WITH ALL THE EXISTING CONDITIONS PRIOR TO CONTRACT AWARD

**GENERAL NOTES:**  
ALL UNDER FLOOR FLUMING, ROUGH-IN'S, DEMOLITION AND OTHER LIQUID WORK SHALL BE DONE DURING OFF-HOURS AND CAREFULLY COORDINATED WITH LANDLORD TO INSURE MINIMAL DISRUPTION TO ADJACENT SPACES.  
OWNER WILL PROVIDE INTERIOR SIGNAGE TO BE MOUNTED BY THE CONTRACTOR. COORDINATE WITH OWNER.  
REFER TO CONSTRUCTION NOTES FOR NEW FIRE EXTINGUISHERS. A MINIMUM OF FOUR FIRE EXTINGUISHERS ARE TO BE PROVIDED. CONTRACTOR TO REVIEW LOCATIONS WITH CODE OFFICIAL TO INSURE PLACEMENT OF THESE UNITS MEETS CODE REQUIREMENTS. CONTRACTOR SHALL PROVIDE ADDITIONAL FIRE EXTINGUISHERS AS MAY BE DETERMINED BY THIS REVIEW.  
ALL ACCESSIBLE CONTROLS, OPERATING MECHANISMS AND HARDWARE SHALL COMPLY WITH SECTION 502 OF ICD/ANSI A117.1.

**FLOOR PLAN**  
Scale: 1/4" = 1'-0"  
REFER TO SHEET A2 FOR DIMENSIONAL PLAN  
REFER TO SHEET A3 FOR CONSTRUCTION NOTES  
REFER TO SHEET A4 FOR DEMOLITION PLAN  
REFER TO SHEET A4 FOR DOOR SCHEDULE  
REFER TO SHEET A4 FOR CEILING