

CONSTRUCTION NOTES

27 CONSTRUCTION NOTE DESIGNATION

GENERAL NOTE: CAREFULLY SAW CUT EXISTING SLAB AS REQUIRED TO INSTALL NEW UNDERSLAB PLUMBING. PATCH SLAB WITH 3,500 PSI CONCRETE IN THICKNESS MATCHING EXISTING SLAB FOLLOWING INSTALLATION OF NEW UNDERSLAB PIPING. CONTRACTOR SHALL CAREFULLY COORDINATE NEW MIN DESIGN WITH THE REQUIREMENTS OF THE FLOORING CONTRACTOR TO INSURE THAT MOISTURE CONTENT AND ALCALI FLOORING PREPARATION TESTS MEET FLOORING MANUFACTURER'S RECOMMENDATIONS.

ALL INTERIOR FINISHES SHALL COMPLY WITH THE CLASSIFICATION REQUIREMENTS OUTLINED IN APPLICABLE SECTIONS OF THE INTERNATIONAL BUILDING CODE FOR THE AREAS BEING INSTALLED.

OWNER WILL PROVIDE APPROXIMATE SO VARIOUS TYPES OF INTERIOR SIGNAGE DEVICES (INCLUDING SIGNAGE FOR TOILETS), WHICH ARE TO BE INSTALLED BY THE CONTRACTOR. CONTRACTOR SHALL COORDINATE THE DELIVERY AND INSTALLATION WITH OWNER.

1 PROVIDE THE FOLLOWING APPLIANCES. REMOVE ALL PACKING MATERIAL / INSTALL AND VERIFY EACH APPLIANCE IS OPERATING PROPERLY.

a. FULL SIZE GE (OR APPROVED EQUAL) REFRIGERATOR - LARGE UNIT THAT WILL FIT INTO 36" WIDE SPACE. UNIT TO BE OVER UNDER (NOT SIDE BY SIDE). FREEZER CAB TO BE EITHER TOP OR BOTTOM. UNIT SHALL HAVE AN ICE MAKER AND WATER DISPENSER.

b. NOT USED ON THIS PROJECT

c. MICROWAVE - 1000 WATT GE (OR APPROVED EQUAL) MICROWAVE THAT WILL FIT IN THE SPACE SHOWN ON THE INTERIOR ELEVATIONS (ABOUT 22" WIDE X 16" HIGH X 14" DEEP).

d. UNDER COUNTER REFRIGERATOR - LOCKABLE "MEDICATION" UNDERCOUNTER REFRIGERATOR. SUMMIT 5.5 CU FT FROST FREE ALL REFRIGERATOR WITH LOCK. CONTRACTOR MAY CONTACT THE DAVIDA VENDOR - STEVE ZINDLELL - SUMMIT APPLIANCE DIVISION, FILM STORAGE INC. 770 GARRISON AVE, BROWN NY 10474 - FAX 761-842-5095 FOR DAVIDA FINISHING. THIS IS THEIR ITEM FEEL.

e. WALL MOUNTED COMBINATION TV/CR/DVD - 32" TO 35" FLAT SCREEN SONO (OR APPROVED EQUAL) TV WITH A COMBINATION DVD/CD/PC (EITHER BUILT-IN OR ATTACHED). PROVIDE WALL MOUNTING BRACKET DESIGNED FOR SELECTED TV AND DVD/CD UNIT AND THAT PROVIDES MOVEMENT TO ALLOW TV TO FACE ALL PARTS OF ROOM. MOUNT HIGH ON THE WALL IN THE CORNER INDICATED. COORDINATE EXACT LOCATION WITH OWNER. PROVIDE BLOCKING FOR WALL BRACKET.

f. WALL MOUNTED TV - 32" TO 35" FLAT SCREEN SONO (OR APPROVED EQUAL) TV. PROVIDE WALL MOUNTING BRACKET DESIGNED FOR SELECTED TV THAT PROVIDES MOVEMENT TO ALLOW TV TO FACE ALL PARTS OF ROOM. MOUNT HIGH ON THE WALL IN THE CORNER INDICATED. COORDINATE EXACT LOCATION WITH OWNER. PROVIDE BLOCKING FOR WALL BRACKET.

2 NURSE CALL SYSTEM. REFER TO ELECTRICAL DRAWINGS FOR COMPONENT SPECIFICATIONS. ALL COMPONENTS TO BE PROVIDED BY EXTERIOR SYSTEMS - CONTACT GEORGE POWERS AT 800-843-8351 (gpowe@gepsys.com). THE FOLLOWING COMPONENTS ARE TO BE PROVIDED AT THE DESIGNATED LOCATIONS:

a. POSITION HELP CALL ON PENDENT WITH LINEN CUP.

b. WALL MOUNTED CALL SWITCH ACTIVATED BY PULL ON CHORD.

c. EMERGENCY CALL ("CODE BLUE") WALL MOUNTED CALL BUTTON WITH HINGED "ELBOW PLATE" TO FACILITATE EMERGENCY ACTIVATION.

d. ENUNCIATOR / HELP / CALL PANEL.

3 PROVIDE THE FOLLOWING ACCESSORY ITEMS. INSTALL PER MANUFACTURER'S RECOMMENDATIONS.

a. COAT HOOK EQUAL TO B552 BY BOBRICK TO BE MOUNTED ON THE ROOM SIDE OF DOOR, IN CENTER OF DOOR AT A HEIGHT OF 4'-5" AFF.

b. PAPER TOWEL DISPENSER EQUAL TO MODEL B-2321 BY BOBRICK WASHROOM EQUIPMENT ADJACENT TO SINK (REFER TO CASEWORK ELEVATIONS) COORDINATE EXACT MOUNTING WITH OWNER.

c. 24"x30" HIGH MIRROR (BOBRICK B-135). MOUNT TOP OF MIRROR AT 5'-5" AFF.

d. 48" LONG GRAB BAR SIMILAR TO TOILET ROOM GRAB BARS. MOUNT AT 34" TO CENTER OF RAIL.

e. 8" DEEP X 48" LONG STAINLESS STEEL SHELF EQUAL TO B235 BY BOBRICK. MOUNT SHELF TO PLASTIC LAMINATE BACK SPLASH, CENTERED HORIZONTALLY WITH TOP OF SHELF AT 4'-5" AFF.

f. MOP AND BROOM HOLDER - EQUAL TO TPE B-223/24 BY BOBRICK. MOUNT AT 5'-0" AFF.

g. 5 1/2" x 5 1/2" GLASS CORNER SHELF EQUAL TO FRESCA OTTIMO BATHROOM CORNER SHELF WITH RAILING.

4 PROVIDE THE FOLLOWING PLASTIC LAMINATE SHELVES, WALL CAPS AND SIMILAR ITEMS. LAMINATE COLOR SHALL BE "B" UNLESS NOTED OTHERWISE:

a. 1 1/4" AND 2" DEEP PLAS LAMINATE CHAIR RAIL. CHAIR RAIL TO BE 1 1/4" AND 2" DEEP WITH PLAS LAMINATE "B". REFER TO WALL FINISH TYPE TWO.

b. 2 - 16" DEEP PLAS LAMINATE SHELVES WITH ADJUSTABLE SHELF HARDWARE W/ MINIMUM OF THREE ADJUSTABLE SHELF STANDARDS - 3" LONG. TOP OF SHELF STANDARDS TO BE 15" FROM FINISH CEILING.

5 PROVIDE FIBERGLASS REINFORCED PANEL (FRP) WALL PROTECTION WAINSCOT AS MANUFACTURED BY MARLITE OR APPROVED EQUAL. COLOR SHALL BE INTEGRAL WITH PANEL AND PANELS SHALL HAVE A PEBBLE FINISH. INSTALL ON TOP OF WALL BASE AND CAULK JOINT BETWEEN BASE AND BOTTOM OF FRP. INSTALL VERTICAL DIVIDER BARS, TOP HORIZONTAL TRIM AND INSIDE CORNER TRIM PIECES MANUFACTURED BY WALL PANEL MANUFACTURE TO MATCH PANELS. PANELS AND TRIM SHALL BE INSTALLED PER MANUFACTURER'S RECOMMENDATIONS AND STANDARD DETAILS. REFER TO ROOM FINISH SCHEDULE FOR COLOR SELECTION. REFER TO THE FOLLOWING SUFFIX FOR ADDITIONAL REQUIREMENTS.

a. 51 1/2" HIGH WAINSCOT ALONG WALLS INDICATED. MOUNT 48" HIGH SHEET OF FRP PER DETAIL 09/A2. CAULK TOP TRIM BETWEEN WALL AND TRIM. IT IS THE INTENT THAT THIS WAINSCOT BE CONTINUOUS ALONG WALLS BETWEEN NOTES.

b. SAME AS 5a AROUND ENTIRE WHEELCHAIR ALCOVE. CUT AROUND BOTTOM OF CABINETS.

c. SIMILAR TO 5a ON WALLS BEHIND AND NEXT TO SINK. EXTEND 4" FROM CORNER.

6 PROVIDE THE FOLLOWING IFC DOOR AND WALL PROTECTION SYSTEMS PRODUCTS BY INFRO CORPORATION AT SUFFIX LOCATIONS INDICATED. SEE ROOM FINISH SCHEDULE FOR COLOR SELECTIONS. INSTALL PER MANUFACTURER'S RECOMMENDATIONS WITH ALL ACCESSORIES REQUIRED FOR A COMPLETE INSTALLATION.

a. MODEL #3345 CORNER GUARDS (90 DEGREE AND 135 DEGREE AS REQUIRED) IFC DOOR AND WALL PROTECTION SYSTEMS BY INFRO CORPORATION AT LOCATIONS INDICATED. UNITS SHALL BE 48" LONG WITH 3" LEGS. MOUNTED AT TOP OF WALL BASE.

b. SIMILAR TO CORNER GUARD UNITS ABOVE WITH ONE AT EACH WALL CORNER SIZED TO COVER END OF WALL WITHOUT OVERLAPPING.

c. FRAME PROTECTOR GUARDS - 4002-04-DP-040 IFC DOOR AND WALL PROTECTION SYSTEMS BY INFRO CORPORATION AT LOCATIONS INDICATED.

7 OXYGEN SYSTEM COMPONENTS AT THE LOCATIONS INDICATED BELOW. REFER TO OXYGEN PLAN SHEET AS:

a. MED GAS SYSTEM MASTER ALARM

b. OXYGEN VACUUM SYSTEM ONE VALVE BOXES

c. OXYGEN STATION OUTLET @ ABOUT 44" AFF (SHOULD BE IN LINE WITH ELECTRICAL OUTLETS)

d. VACUUM STATION OUTLET @ ABOUT 44" AFF (SHOULD BE IN LINE WITH ELECTRICAL OUTLETS)

8 PROVIDE HEAVY DUTY WHITE WIRE SHELF UNITS IN THE CONFIGURATIONS AND LOCATIONS INDICATED AS FOLLOWS. PROVIDE ADEQUATE BLOCKING IN WALL TO SUPPORT ANCHORS. PROVIDE MID SPAN SUPPORT AS REQUIRED.

a. TWO HEAVY DUTY 18" DEEP WHITE WIRE SHELVES MOUNTED PER DETAIL 30/A4 FOR FULL LENGTH BETWEEN WALLS.

9 FLUSH PADDLE FOR POWER ASSISTED DOOR OPENER. PADDLE SHALL HAVE "HC" MARKINGS. COORDINATE WITH HARDWARE SCHEDULE. EXTERIOR DOOR CONTROL DIAGRAM 02/A4 AND ELECTRICAL DRAWINGS. COORDINATE EXACT LOCATIONS WITH OWNER. REFER TO NOTE #18 FOR DOOR BELL PER ELECTRICAL DRAWINGS.

a. FLUSH PADDLE FOR POWER ASSISTED DOOR OPENER MOUNTED IN WALL. PADDLE SHALL NOT HAVE "HC" MARKINGS. COORDINATE WITH HARDWARE SCHEDULE AND ELECTRICAL DRAWINGS. COORDINATE EXACT LOCATIONS WITH OWNER.

b. FLUSH PADDLE FOR POWER ASSISTED DOOR OPENER AT MAIN ENTRY DOOR. MOUNT IN WALL ABOVE COUNTER. PADDLE SHALL HAVE "HC" MARKINGS. COORDINATE WITH HARDWARE SCHEDULE. EXTERIOR DOOR CONTROL DIAGRAM 02/A4 AND ELECTRICAL DRAWINGS. COORDINATE EXACT LOCATIONS WITH OWNER.

c. PROVIDE ALUMINUM FEDESTAL MOUNTED TO EXISTING CONCRETE SLAB WHICH IS DESIGNED TO ACCOMMODATE HC ACCESS DOOR FLUSH PADDLE. PADDLE TO BE MOUNTED IN FEDESTAL. REFER TO NOTE #18 FOR DOOR BELL PER ELECTRICAL DRAWINGS ABOVE DOOR PADDLE IN FEDESTAL.

10 PROVIDE GYP BOARD CASSED OPENING PER INTERIOR ELEVATIONS.

11 PROVIDE HEAVY DUTY COMMERCIAL GRADE ALUMINUM SLIDING TRACK DESIGNED FOR TWO INDEPENDENT SECTIONS OF GLASS. TRACK SHALL BE ON ALL FOUR SIDES OF OPENING. RECESS BOTTOM TRACK INTO COUNTERTOP SUCH THAT TOP EDGE OF TRACK IS FLUSH WITH TOP OF COUNTERTOP. INSTALL TWO EQUAL SIZED SLIDING GLASS PANELS IN OPENING. GLASS EDGES SHALL BE GROUND SMOOTH AND MEETING SECTIONS SHALL OVERLAP A MINIMUM OF 1/2". PROVIDE LOCKING DEVICE(S) TO SECURE GLASS IN A CLOSED POSITION. PROVIDE RUBBER STOPS IN ALUMINUM FRAME AND HANDLES MOUNTED TO INSIDE FACE OF GLASS TO ALLOW OPENING OF GLASS FROM ANY DIRECTION.

12 PROVIDE 2" DIAMETER CABLE ACCESS HOLE IN COUNTER. PROVIDE PLASTIC GROMMET WITH CABLE COVER. COORDINATE EXACT LOCATION WITH OWNER.

13 CENTER WALL ON EXISTING WINDOW MULLION. PROVIDE BREAK METAL COVER OVER END OF WALL TO MATCH EXISTING STOREFRONT FRAMING.

14 COORDINATE INSTALLATION OF OWNER PROVIDED EQUIPMENT.

15 CONTRACTOR TO INSTALL OWNER PROVIDED BULLETIN BOARD OR MARKER BOARD. COORDINATE WITH OWNER.

16 CLEAN EXISTING WINDOWS AND FRAME, INSIDE AND OUTSIDE. INSTALL DARK TINTED UV PROTECTION FILM OVER GLASS PER MANUFACTURER'S RECOMMENDATIONS. INSTALL 1" METAL HORIZONTAL MINI BLINDS EQUAL TO LEVOLOR KIVIERA FAMILY PRODUCTS WITH OPERATING WANDS LOCATED TOWARD CENTER OF ROOM AND NOT OBSTRUCTED BY ABUTTING GYP BOARD WALLS. SEE ROOM FINISH SCHEDULE FOR "BLINDS" COLOR SELECTION. REFER TO NOTE #40 FOR REQUIREMENTS FOR EXISTING GWS ADJACENT, ABOVE AND BELOW THE WINDOWS.

17 PROVIDE HOSPITAL CURTAIN SYSTEM, INCLUDING TRACK AND ALL NECESSARY HARDWARE FOR A COMPLETE INSTALLATION EQUAL TO THE PRODUCTS OF IMPERIAL FASTENER COMPANY, MODEL IFC-85 CURTAIN TRACK WITH IFC-100 ROLLER CARRIERS. SEE ROOM FINISH SCHEDULE FOR "CURTAIN CURTAIN FABRIC" MATERIAL SELECTION. CURTAIN SHALL BE PROVIDED WITH #42 (FINE) MESH THAT EXTENDS 18" BELOW CEILING AND THAT IS 70% OPEN AND SHALL HANG TO 6" ABOVE FINISH FLOOR PER NFPA 13 SECTION 6.5.5.2. PROVIDE TIE BACK(S) AT DRESSING ROOM. PROVIDE SINK WALL MOUNTED TRACK THAT IS DESIGNED TO MOUNT DIRECTLY TO CEILING. COLOR SHALL BE WHITE. INSTALL PER RECOMMENDATIONS OF MANUFACTURER.

18 INSTALL DOOR BELL SYSTEM PER ELECTRICAL DRAWINGS. NOTE THAT THERE ARE TWO DOOR BELLS REQUIRED AND EACH SHOULD HAVE A DISTINCT RING. MOUNT ADJACENT TO POWER DOOR PADDLE AS APPLICABLE (REFER TO DTL 02/A4).

19 12" WIDE WRITING SURFACE PER DETAIL 09/A5. REFER TO INTERIOR ELEVATIONS.

20 WORK NEW WALL AGAINST EXISTING STOREFRONT FRAMING. PROVIDE BREAK METAL COVER ON END OF WALL IN FINISHED AREAS. REFER TO NOTE #24 FOR ADDITIONAL REQUIREMENTS.

21 SECURITY SWITCH FOR ENTRY DOOR. REFER TO DETAIL 02/A4.

22 INSTALL DOUBLE HEAVY GAUGE BULK STUDS AT THE BOTH JAMBS OF DOOR FRAME AND EXTEND CONTINUOUS FROM FLOOR SLAB TO ROOF STRUCTURE ABOVE. PROVIDE 45 DEGREE LATERAL BRACING FROM JUST ABOVE CEILING TO ROOF STRUCTURE ABOVE RUNNING PERPENDICULAR TO THE DIRECTION OF WALL IN BOTH DIRECTIONS.

23 BULKHEAD ABOVE PER DETAIL 02/A5. BULKHEAD HEIGHT AT 7'-0" AT "SIM" LOCATIONS. REFER TO REFLECTED CEILING PLAN.

24 REFER TO NOTE #18 FOR BLINDS. MAKE SURE BLINDS HAVE BEEN INSTALLED AND REMAIN CLOSED TO CONCEAL NEW WORK. REFER TO DIMENSION PLAN ON SHEET A5 FOR WINDOW INFILL. MAKE SURE CONCEALED SPACE IN THIS AREA OF THE WINDOWS IS VENTED TO CEILING SPACE.

25 INSTALL OWNER PROVIDED LOCKING MEDICINE CABINET INSIDE CABINET. COORDINATE WITH OWNER.

26 PATIENT TABLE AND EQUIPMENT. ELECTRICAL OUTLETS, LIGHTS AND OXYGEN SYSTEM ARE LAID OUT BASED ON THIS EQUIPMENT ARRANGEMENT. CONTRACTOR SHALL VERIFY WITH ARCHITECT/OWNER PRIOR TO WORK IN THIS AREA FOR ANY CHANGES TO THIS ARRANGEMENT.

27 REFER TO CEILING PLAN AND LIGHT FIXTURE DETAIL FOR INSTALLATION OF SUPPORT FOR OWNER PROVIDED CONTRACTOR INSTALLED OVERHEAD PROCEDURE LIGHT. REFER TO ELECTRICAL FOR WIRING REQUIREMENTS.

28 PROVIDE FIRE EXTINGUISHER AND CABINET. CABINET SHALL BE ACADAMY #1027-W-10 AS PRODUCED BY JLL INDUSTRIES, BLOOMINGTON, MN. FIRE EXTINGUISHER SHALL BE "COSMIC 10E" AS PRODUCED BY JLL INDUSTRIES, BLOOMINGTON, MN. MOUNT SUCH THAT THE CENTERLINE OF FULL HANDLE IS AT 53" ABOVE FINISH FLOOR. VERIFY WITH LOCAL CODE AUTHORITIES PRIOR TO INSTALLATION.

29 PROVIDE KEY BOX EQUAL TO MIM INDUSTRIES HIGH-SECURITY LOCKING KEY CABINET, 60-KET, 12 1/8" H X 10 1/2" W X 3" D AVAILABLE FROM OFFICE DEPOT. ITEM # 307280 (<http://www.officedepot.com/LINKURLtoLevel=5&L=1507280>) TO BE MOUNTED TO THE WALL WHERE INDICATED. PROVIDE 60" SLOTTED RACK-STYLE SNAP-HOOK KEY TAGS - WHITE". ALL KEYS, INCLUDING LOCKER AND CABINET KEYS SHALL BE HUNG IN THIS CABINET BY THE CONTRACTOR WITH TYPED PERMANENT LABELS ON KEYS AND CORRESPONDING HANGING LOCATION IN BOX.

30 DRINKING FOUNTAIN. REFER TO MECHANICAL. COORDINATE WITH PERMIT OFFICE SUCH THAT INSTALLED UNIT MEETS LOCAL HC REQUIREMENTS.

31 REFER TO INTERIOR ELEVATIONS FOR CABINET WORK AT SINK. FINISH ENDS ON ADJOINING CABINETS. EXTEND FLOORING AND BASE INTO SINK AREA. PIPING TO BE INSTALLED TO MEET ADA CLEARANCE REQUIREMENTS SIMILAR TO DETAIL 02/A5.

32 INSTALL MINIMUM 5 MIL POLY VAPOR BARRIER BEHIND GYP BOARD AROUND PERIMETER OF ROOM INCLUDING ALL WALLS AND CEILING. POLY TO BE "BEHIND" LEAD SHIELDING WHERE APPLICABLE.

33 EXISTING DOOR AND FRAME TO REMAIN. REMOVE EXISTING HARDWARE AND PATCH HOLES. RENDER DOOR INFEREABLE WITH CLIP ANGLES INSTALLED ON THE INTERIOR SIDE. CAULK AROUND PERIMETER OF DOOR BETWEEN DOOR AND FRAME TO CREATE A WEATHERTIGHT SEAL. PAINT DOOR AND FRAME, INSIDE AND OUT.

34 CONTRACTOR TO INSTALL OWNER PROVIDED HC TOILET SIGNAGE. SIGN TO BE MOUNTED 5'-0" AFF TO CENTER OF SIGN AND EDGE OF SIGN SHALL BE 2" FROM DOOR FRAME.

35 CHAIR RAIL AROUND PERIMETER OF WAITING ROOM PER NOTE #4b. REFER TO WALL TYPE TWO AND ROOM FINISH SCHEDULE FOR WALL FINISH ABOVE AND BELOW CHAIR RAIL.

36 PROVIDE 8"x3/4" BC PLYWOOD MOUNTING BOARD FROM 6" ABOVE FINISH FLOOR FOR FULL LENGTH OF WALL. PAINT TO MATCH ADJACENT WALLS.

37 REMOVE EXISTING STOREFRONT IN THIS AREA. TURN REMOVED STOREFRONT / DOORS OVER TO LANDLORD. PROVIDE NEW STOREFRONT SYSTEM TO MATCH EXISTING STOREFRONT SYSTEM EXCEPT THAT 1" INSULATED GLASS WITH UV PROTECTION SHALL BE INSTALLED. INSTALL NEW DOOR WHERE APPLICABLE PER DOOR SCHEDULE. DOOR TO MATCH EXISTING. INSTALL 1" METAL HORIZONTAL MINI BLINDS EQUAL TO LEVOLOR KIVIERA FAMILY PRODUCTS WITH OPERATING WANDS LOCATED TOWARD CENTER OF ROOM AND NOT OBSTRUCTED BY ABUTTING GYP BOARD WALLS. SEE ROOM FINISH SCHEDULE FOR "BLINDS" COLOR SELECTION. REFER TO NOTE #40 FOR REQUIREMENTS FOR EXISTING GWS ADJACENT, ABOVE AND BELOW THE WINDOWS.

38 NEW ROOFTOP EXHAUST FAN. REFER TO MECHANICAL PLANS FOR LOCATION AND SETTING REQUIREMENTS. CURS TO BE WORKED INTO EXISTING ROOFING PER ROOFING MANUFACTURER'S RECOMMENDATIONS TO MAINTAIN EXISTING ROOFING WARRANTY. COORDINATE WITH LANDLORD AND USE LANDLORD'S ROOFING COMPANY IF REQUIRED BY EXISTING ROOFING WARRANTY.

39 NEW HVAC CONDENSING UNIT ON ROOF. REFER TO MECHANICAL PLANS FOR LOCATION AND SETTING REQUIREMENTS. CURS TO BE WORKED INTO EXISTING ROOFING PER ROOFING MANUFACTURER'S RECOMMENDATIONS TO MAINTAIN EXISTING ROOFING WARRANTY. COORDINATE WITH LANDLORD AND USE LANDLORD'S ROOFING COMPANY IF REQUIRED BY EXISTING ROOFING WARRANTY.

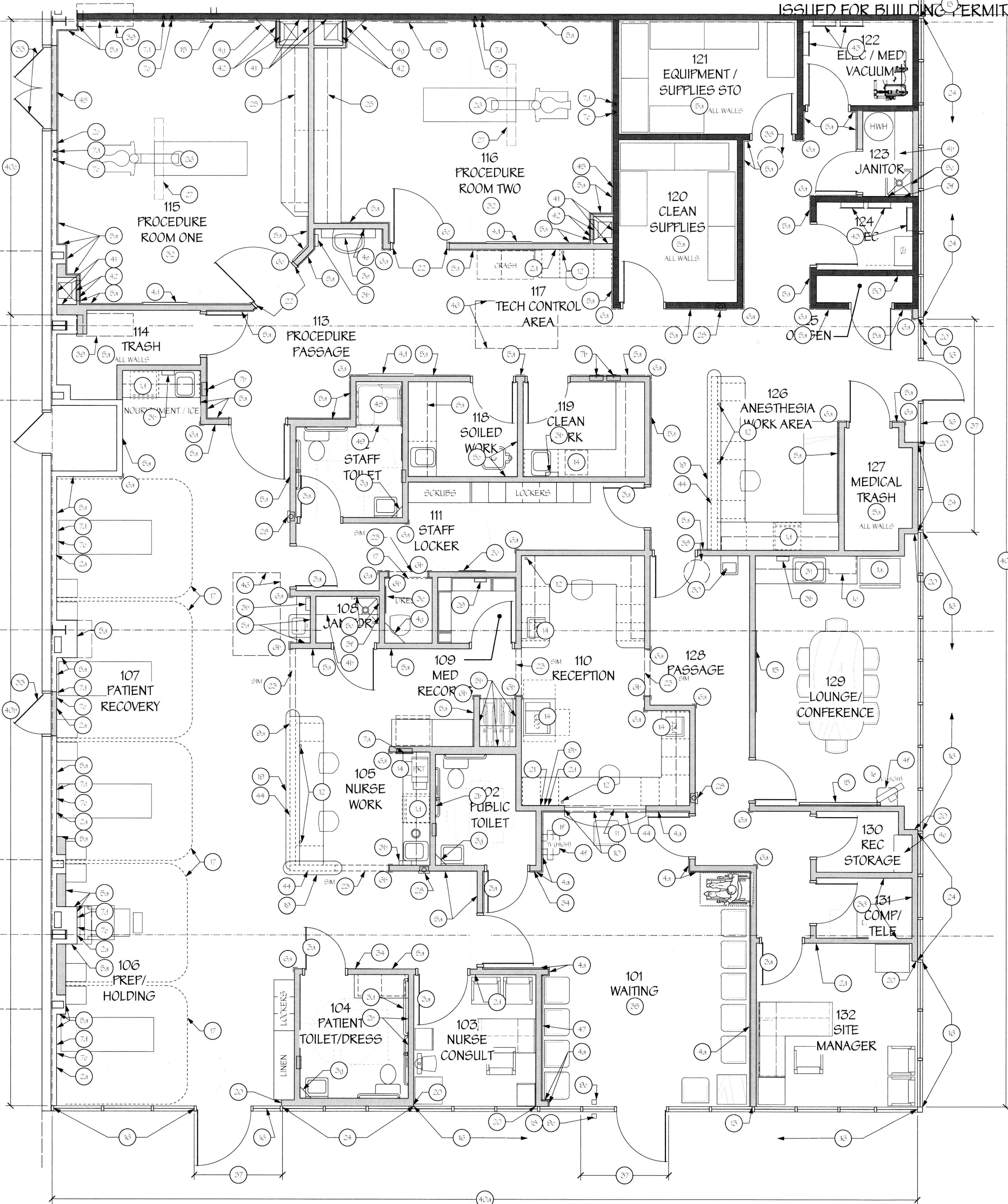

FLOOR PLAN - CONSTRUCTION NOTES
SCALE: 1/4" = 1'-0"

- 40 EXISTING WALL TO REMAIN. REFER TO FOLLOWING SUFFIX FOR REQUIREMENTS. SEE WALL SCHEDULE FOR OTHER WALL REQUIREMENTS.
 - a. EXISTING EXTERIOR WALL ABOVE STOREFRONT. REWORK EXISTING GYP BOARD AS REQUIRED TO INSTALL NEW ELECTRICAL WORK AND BLOCKING. PATCH GYP BOARD FOR A SMOOTH UNIFORM APPEARANCE IN PREPARATION OF INSTALLATION OF NEW FINISHES.
 - i. EXISTING EXTERIOR WALL. REWORK EXISTING GYP BOARD AS REQUIRED TO INSTALL NEW ELECTRICAL WORK AND BLOCKING. PATCH GYP BOARD FOR A SMOOTH UNIFORM APPEARANCE IN PREPARATION OF INSTALLATION OF NEW FINISHES.
 - c. REFER TO DEMOLITION PLAN FOR REMOVAL OF EXISTING GYP BOARD IN PROCEDURE ROOM. AFTER ALL NEW ELECTRICAL AND PLUMBING WORK HAS BEEN INSTALLED, INSTALL NEW BATT INSULATION AND INSTALL ONE LAYER OF 5/8" GWS W/ 1/16" LEAD BACKING OVER EXISTING WALL STUDS. LEAD TO EXTEND TO 7'-0" AFF. SIMILAR TO WALL TYPE W15.
- 41 EXTEND WALL LEAD (1/16" SHEET LEAD TO 7'-0" AFF) BEHIND RETURN AIR DUCT CHASE AND THE LEAD INTO LEAD LINED GYP BOARD FOR A CONTINUOUS BARRIER.
- 42 REFER TO MECHANICAL DRAWINGS FOR LOW RETURN AIR DUCT AND 18"x30" RETURN AIR GRILL TO BE MOUNTED WITH BOTTOM 6" AFF.
- 43 ELECTRICAL PANELS PER ELECTRICAL DRAWINGS.
- 44 REFER TO ELEVATIONS 5D, 5E, 5F & 5G/A5 FOR PLAS LAMINATE WALL PROTECTION UNDER COUNTERTOP.
- 45 24" X 32" PLYWOOD BACKING IN THIS AREA FOR OWNER INSTALLED FAX SYSTEM. REFER TO ELECTRICAL DRAWINGS FOR OUTLET AND DATA JACK TO BE INSTALLED IN THIS AREA AT 48" AFF. COORDINATE EXACT PLACEMENT WITH OWNER.
- 46 NEW HVAC UNIT HUNG FROM UNDERSIDE OF STRUCTURE ABOVE. COORDINATE LOCATION WITH MECHANICAL DRAWINGS AND LOCATE SUCH THAT EASY ACCESS IS PROVIDED FOR MAINTENANCE AND FOR CHANGING THE FILTERS. HANG FROM UNISTRUT ATTACHED TO BOTTOM OF FRAMING ABOVE. UNIT TO BE HUNG FROM A MINIMUM OF THREE ROOF FURLINS.
- 47 REFER TO DETAIL 5C/A5 FOR PLAS LAMINATE FEATURE WALL.
- 48 REFER TO MECHANICAL PLANS FOR SHOWER. CAREFULLY CHIP AWAY EXISTING CONCRETE DECK AS REQUIRED TO INSTALL SHOWER UNIT TO MEET ADA/HC REQUIREMENTS (MAX 1/2" THRESHOLD) AND PATCH SLAB WITH EQUAL THICKNESS 3,000 PSI CONCRETE. COORDINATE GYP BOARD WALL ENCLOSURE DIMENSIONS WITH ROUGH-IN DIMENSIONS FOR SHOWER UNIT.
- 49 PROVIDE A WHITE SHOWER CURTAIN, WITH PLASTIC RINGS, AT HC SHOWER.
- 50 2-2x6 BOARD ACROSS BACK WALL. REFER TO DETAIL ON OXYGEN PLAN - SHEET A3. INSTALL HOOKS AND CHAIN TO HOLD OXYGEN TANKS IN PLACE. COORDINATE WITH OWNER FOR THE INSTALLATION OF FLOOR PROTECTION MAT BELOW TANKS.

ISSUED FOR BUILDING PERMIT

DATE: 07/24/2014
JOB NO: 11216
DRAWN: STAFF
CHECKED: CM

CM
CORTLAND MORGAN ARCHITECT

711 N. FIELDER RD.
ARLINGTON, TX 76012
PH: (817) 635-5696
FAX: (817) 635-5699

635 Westport Parkway
Suite 300
Grapevine, Texas 76051
Phone: 817-410-2858
Fax: 817-251-9411

d p c e
don penn - consulting engineer

Lifeline Project Manager
In Sync
1215 Old Fayetteville Road
Whiteford, MD 21160
Office 410-462-5005 Fax 410-462-5046

ACCESS CENTER LIFELINE
11771 Maumelle Blvd
North Little Rock, AR 72115

REVISIONS

'A'	ISSUE DATE
'B'	ISSUE DATE
'C'	ISSUE DATE
'D'	ISSUE DATE
'E'	ISSUE DATE
'F'	ISSUE DATE
'G'	ISSUE DATE
'H'	ISSUE DATE
'I'	ISSUE DATE
'J'	ISSUE DATE

FLOOR PLAN / CONSTRUCTION NOTES

SHEET NUMBER **A3**

NOTE: CONTRACTOR AND SUB-CONTRACTORS SHALL VISIT THIS BUILDING AND TENANT AREA AND BE FAMILIAR WITH ALL THE EXISTING CONDITIONS PRIOR TO CONTRACT AWARD