



711 N. FIELDER RD.
ARLINGTON, TX 76012
PH: (817) 635-5696
FAX: (817) 635-5699

435 Westport Parkway
Suite 300
Grapevine, Texas 76051
Phone: 817-410-2858
Fax: 817-251-8411

Lifeline Project Manager
In Sync
1215 Old Fayetteville Road
Whiteford, MD 21160
Office: 410-462-5046

ACCESS CENTER
LIFELINE
11771 Maunelle Blvd
North Little Rock, AR 72115



REVISIONS table with columns for issue number, date, and description.

DETAILS
SHEET NUMBER

A5

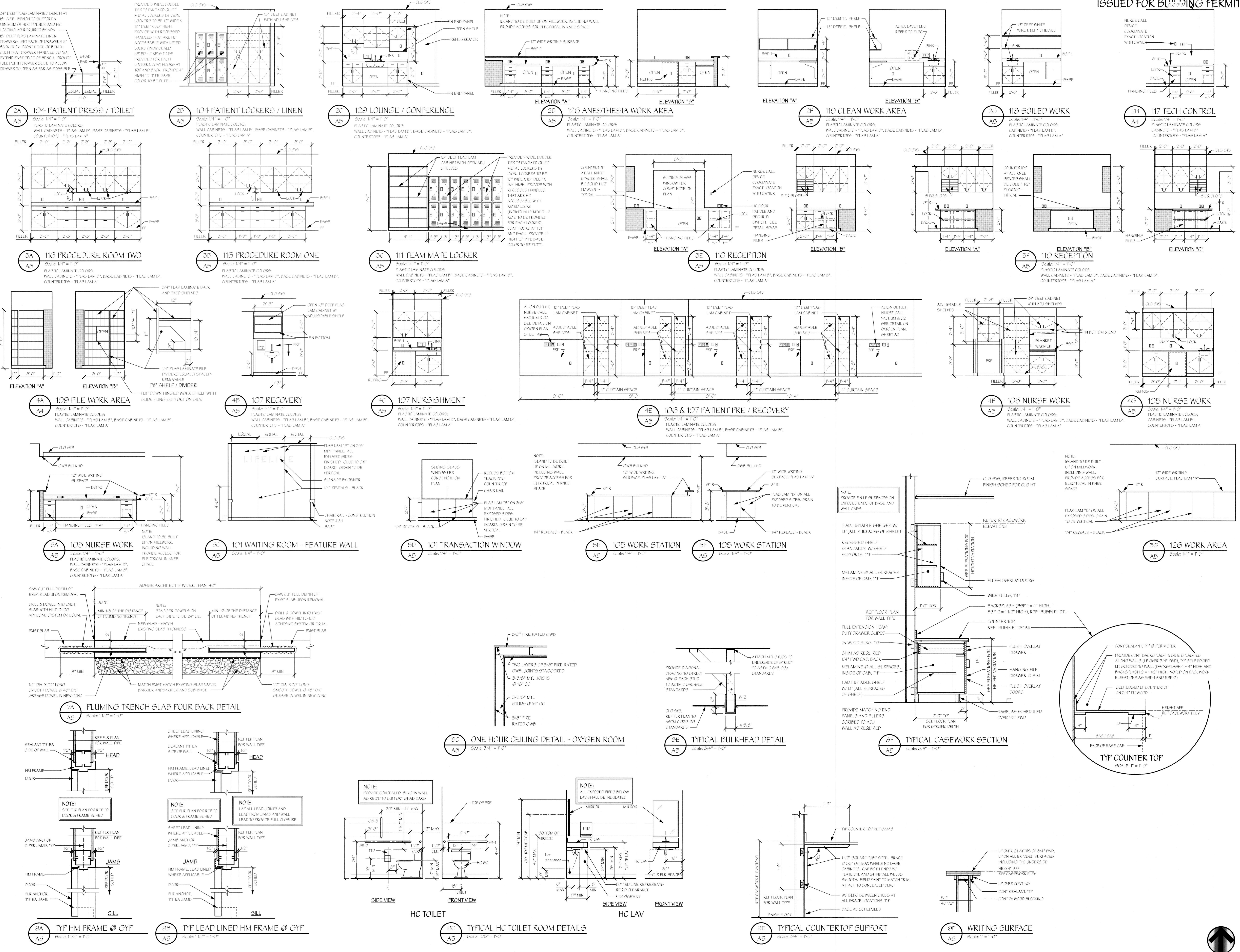

NOTE: CONTRACTOR AND SUB-CONTRACTORS SHALL VISIT THIS BUILDING AND TENANT AREA AND BE FAMILIAR WITH ALL THE EXISTING CONDITIONS PRIOR TO CONTRACT AWARD

A B C D E F G H