

A B C D E F G H

6
5
4
3
2
1

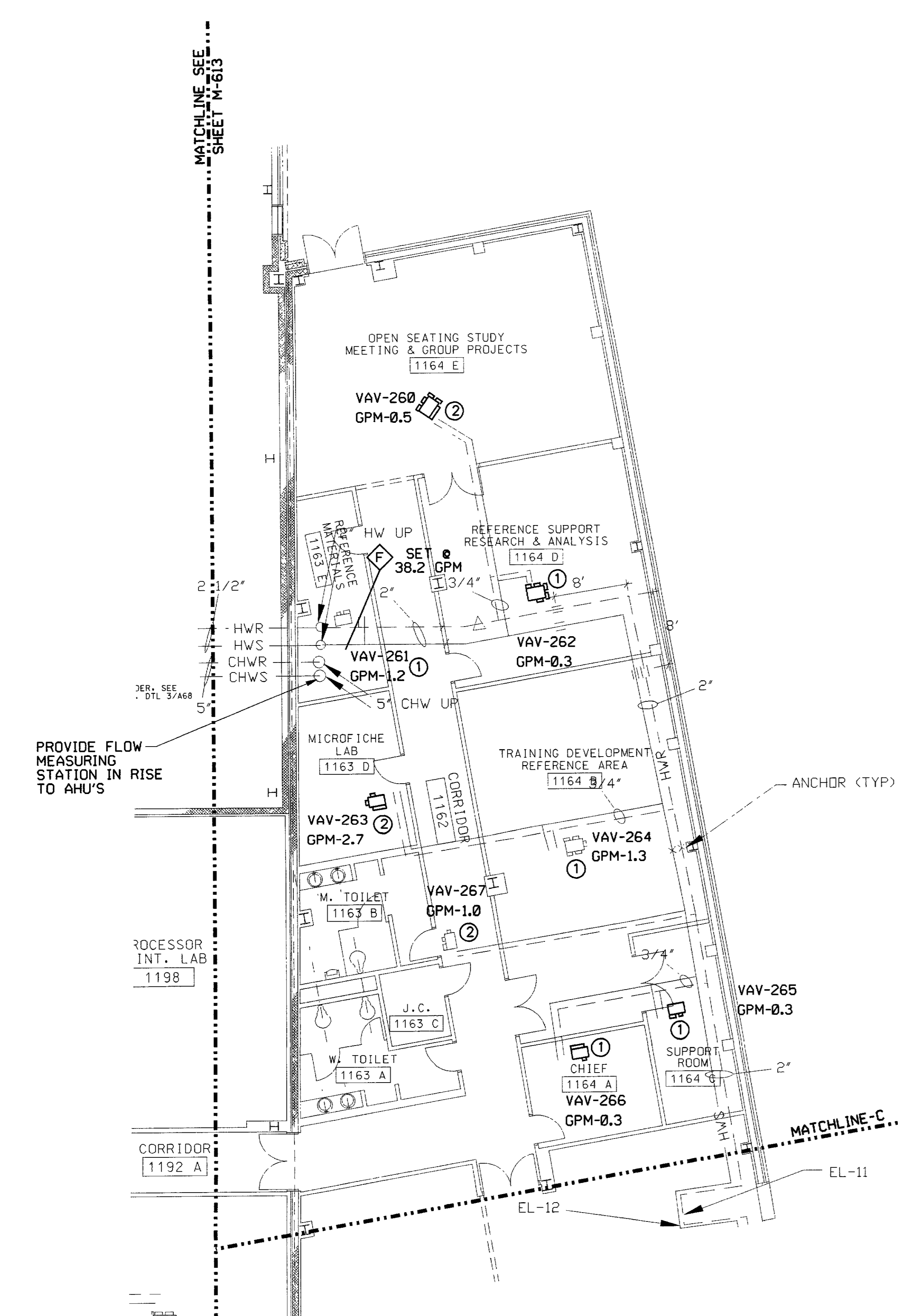

ZONE No. 5 - 1st FLOOR HVAC PIPING

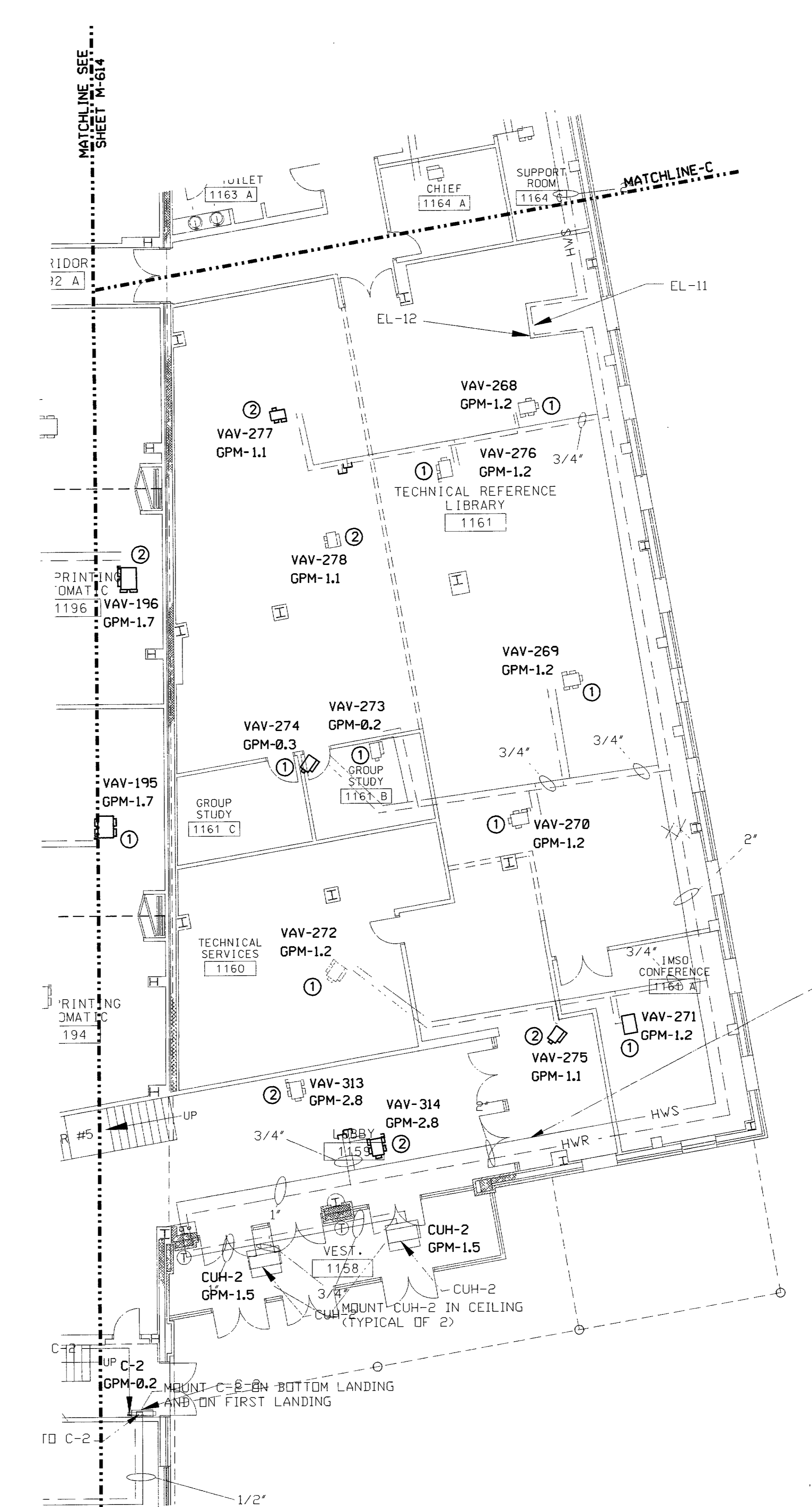
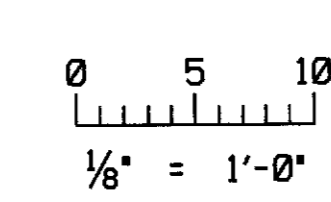

ZONE No. 6 - 1st FLOOR HVAC PIPING

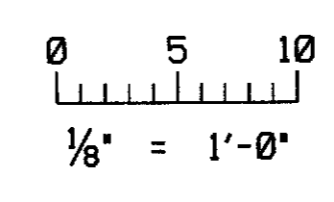

- NOTE(S):
- ① REBALANCE EXISTING HOT WATER REHEAT COIL FLOW TO INDICATED REQUIREMENTS. SEE SCHEDULE.
 - ② NEW HWS/R TO NEW DUCT HTG. COIL OR NEW VAV BOX. BALANCE REHEAT COIL TO INDICATED REQUIREMENTS.
 - ③ NEW HOT WATER SUPPLY & RETURN TO NEW AHU. NEW PIPE AND ROOF PENETRATION AT EACH COIL.

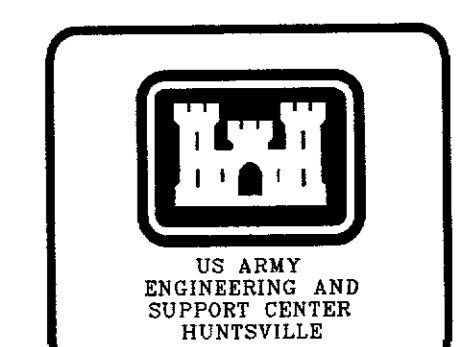
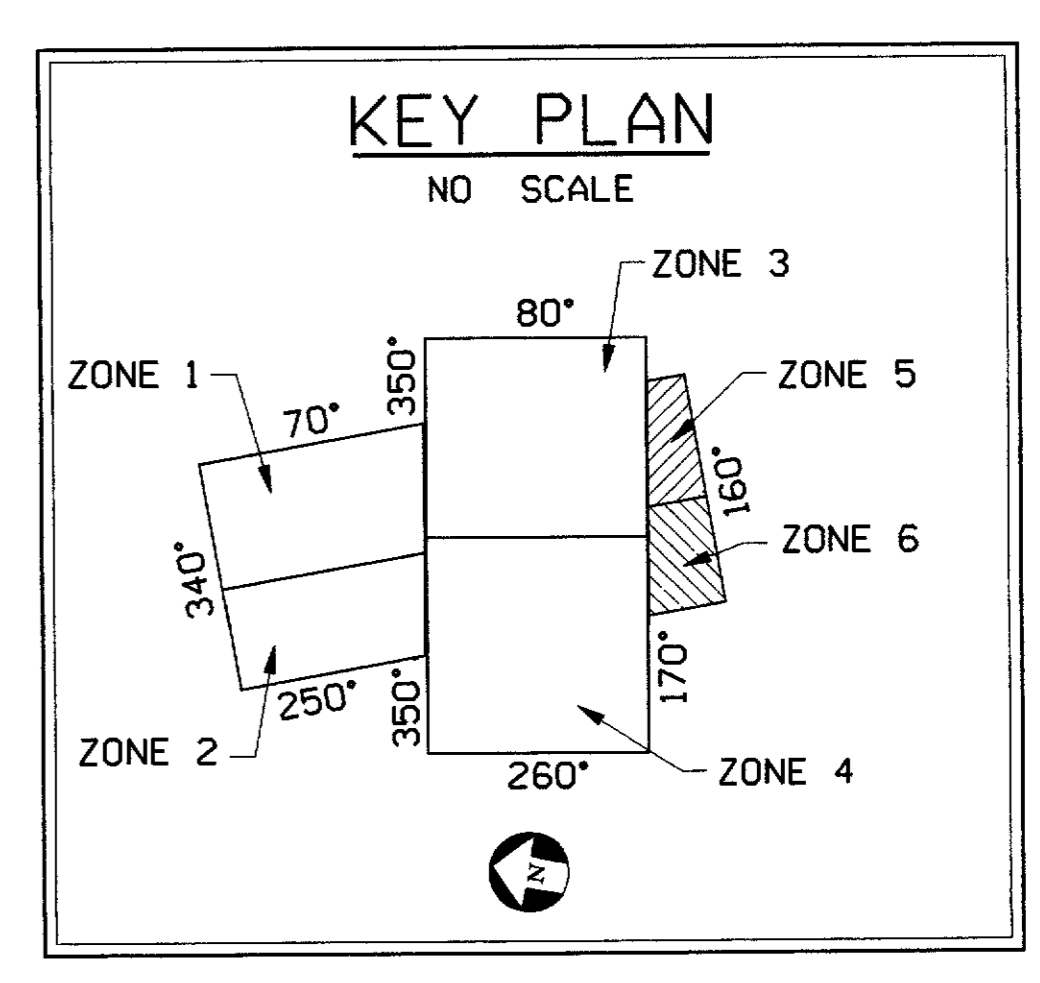

Description	Symbol	Date	Appr.

Date: 02/27/04	Checked by: WTT
CADD File Name: J12.MXD	Dwn by: ICT
ICT Project No. 203121	DAC/AB7-03-D-0006
Per Date: 02/27/04	Approved by: Chief, Proj. Mgmt. Division
Plot Scale: 1/8" = 1'-0"	

DEFENSE INFORMATION SCHOOL MARYLAND
FT. MEADE
ZONE 5 & 6 - 1st FLOOR HW PIPING

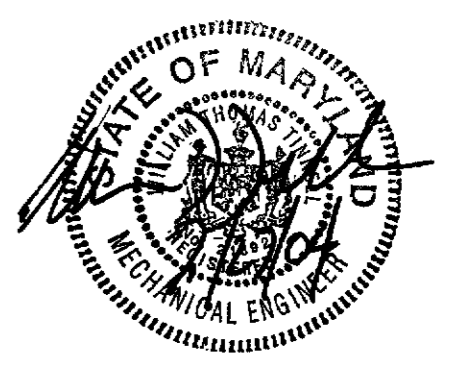

THESE DOCUMENTS HAVE BEEN PREPARED PRIMARILY BASED ON INFORMATION PROVIDED BY OTHERS. I.C. THOMASSON HAS NOT VERIFIED THE ACCURACY OF ALL INFORMATION PROVIDED BY OTHERS. SEE LIMIT OF LIABILITIES STATEMENT ON COVER SHEET.

Sheet reference number:
M-615