

F. S. D. NEWEL . CAP, SOFFIT MOLD

House for
 Mr & Mrs Francis Jencks.
 RIDERWOOD - BALD.

JOB	SHEET	DATE	BY
117	10	4-8-38	J.H.F.

WRENN, LEWIS AND JENCKS
 ARCHITECTS
 118 W. MULBERRY STREET
 BALTIMORE, MD.

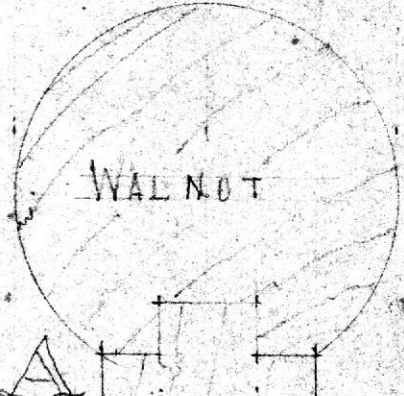
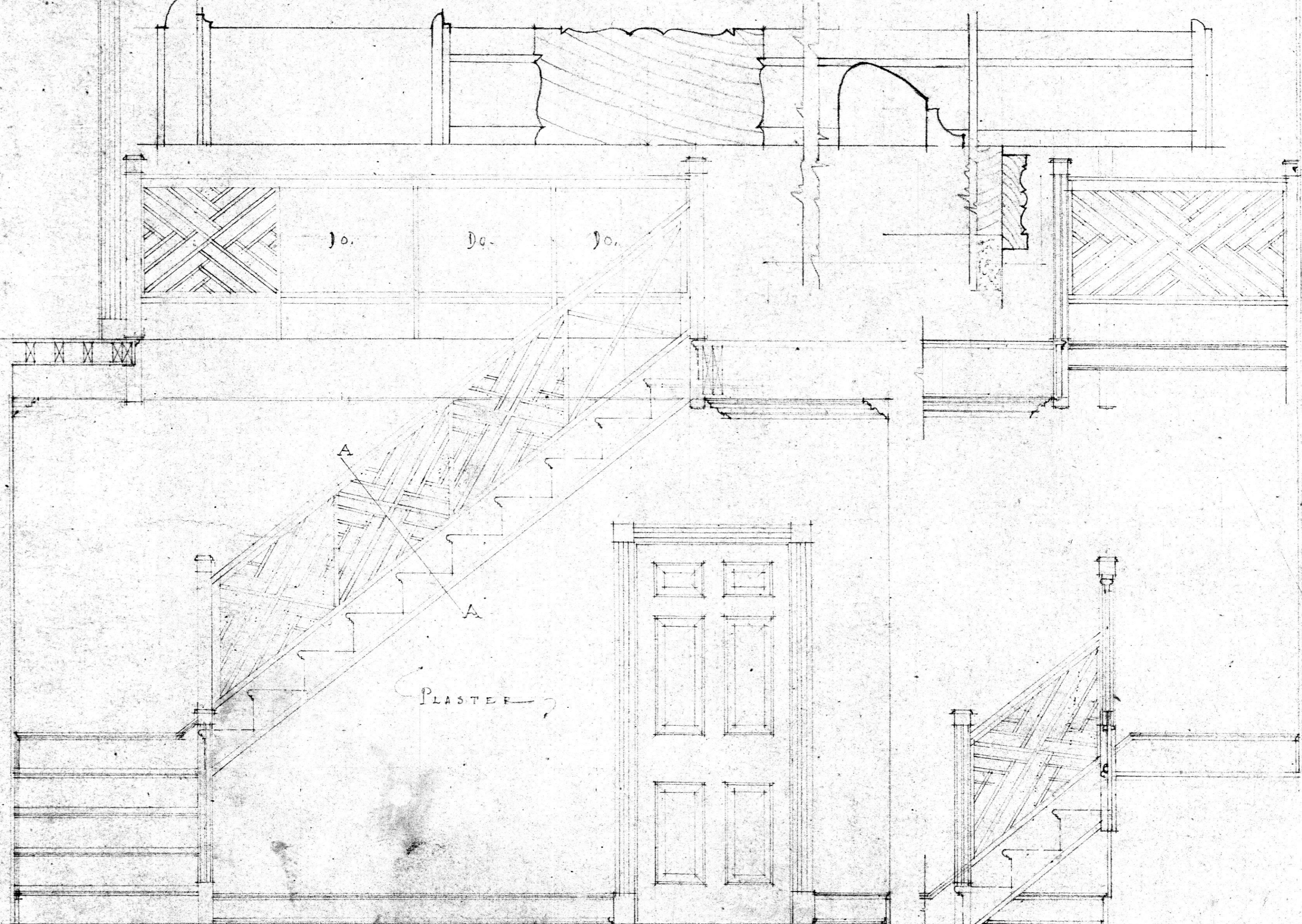

STAIRWAY - SCALE 3/4" = 1'-0" - SOUTH WALL

EAST WALL

LIVING ROOM & Dining Room Doors

