

F. S. D. NEWEL, CAP, SOFFIT MOLD

House for
MR & MRS FRANCIS JENCKS.
RIDERWOOD - D.D.

JOB	SHEET	DATE	BY
117	10	4-8-38	J.A.J.

WRENN, LEWIS AND JENCKS
ARCHITECTS
113 W. MULBERRY STREET
BALTIMORE, MD.

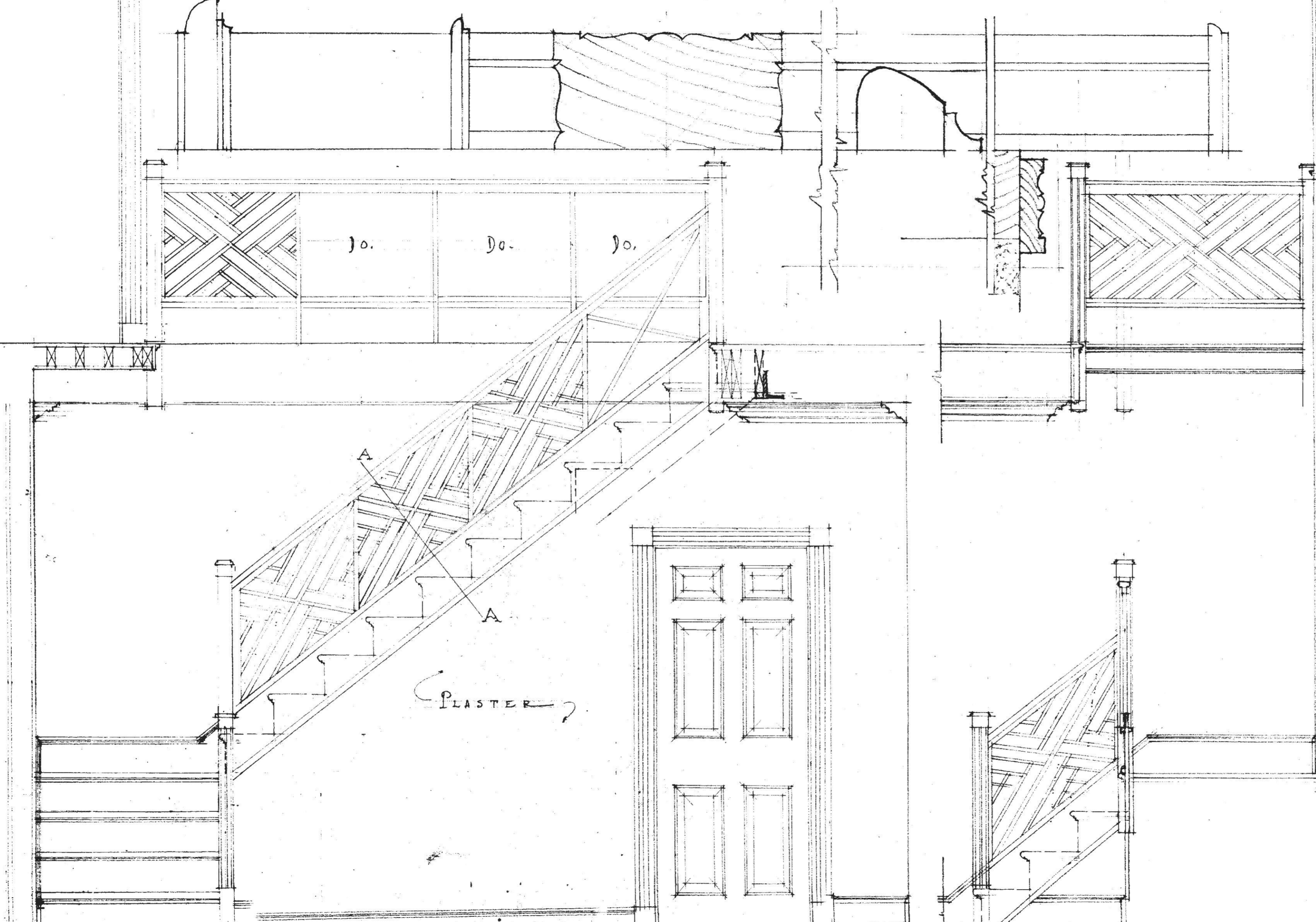

Jo. Do. Jo.

PLASTER

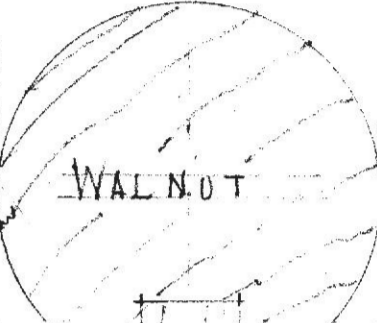

STAIRWAY - SCALE 3/4" = 1'-0" - SOUTH WALL

EAST WALL

LIVING ROOM & DINING ROOM DOORS