

FLOOR PLAN 1

1/8" = 1'-0"

NORTH

DEMOLITION PLAN 2

1/8" = 1'-0"

**DEMOLITION NOTES:**

1. ALL EXISTING COLUMNS AND BEAMS ARE TO REMAIN.
2. SEE MECHANICAL AND ELECTRICAL DRAWINGS FOR REMOVAL OF MECHANICAL, ELECTRICAL AND PLYMOUTH ITEMS.
3. BUILDING COMPONENTS SHOWN EXCEPT THOSE WITH AN "X" ARE TO BE REMOVED AND/OR SALVAGED AS NOTED.

**CONSTRUCTION NOTES:**

1. DIMENSIONS UNLESS NOTED OTHERWISE ALL STUD WALLS ARE DIMENSIONED TO FACE OF GYPSUM BOARD AND ALL W-2 ON TOP WALLS ARE DIMENSIONED TO FACE OF MASONRY.
2. FIRE RATING INFORMATION SEE FIRE PLANS, DRAWINGS A-1.
3. ALL DOOR OPENINGS LOCATED 2'-0" TO CENTERLINE UNLESS NOTED OTHERWISE.
4. PARTITIONS AND WALLS WITH DASHED LINE THIS SHALL BE ONE HOUR FIRE RATED CONSTRUCTION.
5. DOORS SHOWN THIS "I" ARE EXISTING TO REMAIN.
6. CONSTRUCTION SHOWN SHADDED IN SECTION THIS INDICATES EXISTING TO REMAIN.

FINISH SCHEDULE:

**FLOORS:**  
F-1 CARPET TILE (18'X18')  
F-2 CARPET  
F-3 VINYL TILE (12'X12')  
F-4 TERRAZZO TILE (12'X12)

**BASES:**  
B-1 VINYL COVE (4"H.)

**CEILING:**  
C-1 2'X2' ACOUSTICAL LAY-IN TILE  
C-2 2'X4' ACOUSTICAL LAY-IN TILE  
C-3 PAINTED GWB  
C-4 PAINTED EXPOSED

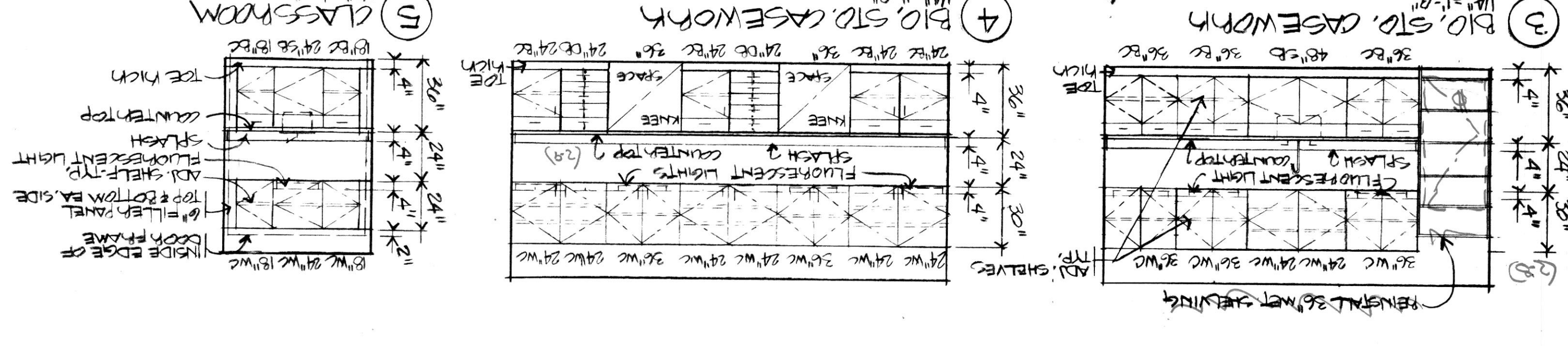

DATE: 06/28/11  
A-4  
PROJ NO: 9060  
DWG NO:

**PLANS**  
**CONSTRUCTION & DEMOLITION & LIBRARY**

**NOTRE DAME PREPARATORY SCHOOL**  
Townson, Maryland

**Address and Renovations to**

**KEY PLAN**

**REVISIONS**

No.	Date	Description
1		
2		
3		
4		
5		
6		
7		
8		
9		
10		
11		
12		
13		
14		
15		
16		
17		
18		
19		
20		
21		
22		
23		
24		
25		
26		
27		
28		
29		
30		
31		
32		
33		
34		
35		
36		
37		
38		
39		
40		
41		
42		
43		
44		
45		
46		
47		
48		
49		
50		

TOTAL SPECKS: 50  
EXTS PROVIDED: 2  
EXTS REQUIRED: 2  
DWT CAPACITY PROVIDED: 510 PH

**BUILDING CODE SUMMARY**

REFERENCES: 1989 IBC HPRA 101, 110, 111, 112, 113, 114, 115, 116, 117, 118, 119, 120, 121, 122, 123, 124, 125, 126, 127, 128, 129, 130, 131, 132, 133, 134, 135, 136, 137, 138, 139, 140, 141, 142, 143, 144, 145, 146, 147, 148, 149, 150, 151, 152, 153, 154, 155, 156, 157, 158, 159, 160, 161, 162, 163, 164, 165, 166, 167, 168, 169, 170, 171, 172, 173, 174, 175, 176, 177, 178, 179, 180, 181, 182, 183, 184, 185, 186, 187, 188, 189, 190, 191, 192, 193, 194, 195, 196, 197, 198, 199, 200, 201, 202, 203, 204, 205, 206, 207, 208, 209, 210, 211, 212, 213, 214, 215, 216, 217, 218, 219, 220, 221, 222, 223, 224, 225, 226, 227, 228, 229, 230, 231, 232, 233, 234, 235, 236, 237, 238, 239, 240, 241, 242, 243, 244, 245, 246, 247, 248, 249, 250, 251, 252, 253, 254, 255, 256, 257, 258, 259, 260, 261, 262, 263, 264, 265, 266, 267, 268, 269, 270, 271, 272, 273, 274, 275, 276, 277, 278, 279, 280, 281, 282, 283, 284, 285, 286, 287, 288, 289, 290, 291, 292, 293, 294, 295, 296, 297, 298, 299, 300, 301, 302, 303, 304, 305, 306, 307, 308, 309, 310, 311, 312, 313, 314, 315, 316, 317, 318, 319, 320, 321, 322, 323, 324, 325, 326, 327, 328, 329, 330, 331, 332, 333, 334, 335, 336, 337, 338, 339, 340, 341, 342, 343, 344, 345, 346, 347, 348, 349, 350, 351, 352, 353, 354, 355, 356, 357, 358, 359, 360, 361, 362, 363, 364, 365, 366, 367, 368, 369, 370, 371, 372, 373, 374, 375, 376, 377, 378, 379, 380, 381, 382, 383, 384, 385, 386, 387, 388, 389, 390, 391, 392, 393, 394, 395, 396, 397, 398, 399, 400, 401, 402, 403, 404, 405, 406, 407, 408, 409, 410, 411, 412, 413, 414, 415, 416, 417, 418, 419, 420, 421, 422, 423, 424, 425, 426, 427, 428, 429, 430, 431, 432, 433, 434, 435, 436, 437, 438, 439, 440, 441, 442, 443, 444, 445, 446, 447, 448, 449, 450, 451, 452, 453, 454, 455, 456, 457, 458, 459, 460, 461, 462, 463, 464, 465, 466, 467, 468, 469, 470, 471, 472, 473, 474, 475, 476, 477, 478, 479, 480, 481, 482, 483, 484, 485, 486, 487, 488, 489, 490, 491, 492, 493, 494, 495, 496, 497, 498, 499, 500.

810 Light Street Baltimore Maryland 21230  
Architects Planners Engineers  
**Gaudreau, Inc.**  
Baltimore