

CONNECTION NO.	VOLTS - PHASE	HTR (KW)	FAN (HP)	WIRE	CONDUIT	DEVICE	CIRCUIT NO.
C-1	EXISTING	-	-	EXISTING	EX	EX	20
C-2	EXISTING	-	-	EXISTING	EX	EX	24
CH-1	208V-3Ø	-	214 FLA	3Ø4/0-1Ø4GRD	2"	CT	18(8)
CH-2	208V-3Ø	-	214 FLA	3Ø4/0-1Ø4GRD	2"	CT	18(9)
P-1	208V-3Ø	-	15	3Ø4-1Ø8GRD	1"	MS	P-1,3,5
P-2	208V-3Ø	-	15	3Ø4-1Ø8GRD	1"	MS	P-2,4,6
P-3	208V-3Ø	-	10	3Ø6-1Ø10GRD	3/4"	MS	P-7,9,11
P-4	208V-3Ø	-	10	3Ø6-1Ø10GRD	3/4"	MS	P-8,10,12

- ### DRAWING NOTES
- EXISTING CHILLER CH-2 BEING REMOVED. DISCONNECT AND REMOVE EXISTING CONNECTION AND FEEDER/CIRCUIT BACK TO VOLTAGE SOURCE TO EXISTING CHILLER CH-1. REFER TO SCHEDULE OF MECHANICAL EQUIPMENT CONNECTION ON THIS SHEET FOR ADDITIONAL INFORMATION.
 - EXISTING CHILLER CH-1 BEING REMOVED. DISCONNECT AND REMOVE EXISTING CONNECTION AND FEEDER/CIRCUIT BACK TO VOLTAGE SOURCE TO EXISTING CHILLER CH-1. REFER TO SCHEDULE OF MECHANICAL EQUIPMENT CONNECTION ON THIS SHEET FOR ADDITIONAL INFORMATION.
 - DISCONNECT AND REMOVE CONNECTIONS TO EXISTING COMPRESSORS AND ASSOCIATED DISCONNECT SWITCH TO BE RELOCATED. MAINTAIN EXISTING CIRCUITS AND EXTEND TO NEW COMPRESSOR AND DISCONNECT SWITCH LOCATIONS AND MAKE ALL REQUIRED CONNECTIONS TO OPERATE AS BEFORE.
 - DISCONNECT AND REMOVE CONNECTIONS AND ASSOCIATED STARTER SERVING EXISTING PUMP P-1. REFER TO SCHEDULE OF MECHANICAL EQUIPMENT CONNECTION ON THIS SHEET FOR ADDITIONAL INFORMATION.
 - DISCONNECT AND REMOVE CONNECTIONS, STARTER AND CIRCUIT SERVING EXISTING PUMP P-2. REFER TO SCHEDULE OF MECHANICAL EQUIPMENT CONNECTIONS ON THIS SHEET FOR ADDITIONAL INFORMATION.
 - DISCONNECT AND REMOVE CONNECTIONS AND ASSOCIATED STARTER SERVING EXISTING PUMP P-3. REFER TO SCHEDULE OF MECHANICAL EQUIPMENT CONNECTION ON THIS SHEET FOR ADDITIONAL INFORMATION.
 - EXISTING SWITCHBOARD 400A FUSED DISCONNECT SWITCH SERVING EXISTING CHILLER CH-1. REPLACE EXISTING 150A FUSES WITH 200A FUSES AS RECOMMENDED BY THE REPLACEMENT CHILLER MANUFACTURER. REFER TO SCHEDULE OF MECHANICAL EQUIPMENT CONNECTIONS ON THIS SHEET FOR ADDITIONAL INFORMATION.
 - EXISTING SWITCHBOARD 400A FUSED DISCONNECT SWITCH SERVING EXISTING CHILLER CH-2. REPLACE EXISTING 350A FUSES WITH 200A FUSES AS RECOMMENDED BY THE REPLACEMENT CHILLER MANUFACTURER. REFER TO SCHEDULE OF MECHANICAL EQUIPMENT CONNECTIONS ON THIS SHEET FOR ADDITIONAL INFORMATION.
 - EXISTING ELECTRICAL SERVICE 2000A AND 1200A MAINS TO REMAIN.
 - EXISTING ELECTRICAL EQUIPMENT TO REMAIN.
 - EXISTING PULL BOX AND DISCONNECT SWITCHES BELOW PULL BOX TO REMAIN.
 - RELOCATE EXISTING COMBINATION STARTER/DISCONNECT SWITCH TO OPPOSITE SIDE OF COLUMN TO CLEAR REPLACEMENT CHILLER INSTALLATION.
 - EXISTING FUSED SWITCHBOARD TO REMAIN.
 - EXISTING COOLING TOWER DISCONNECT AND CONTROLLER TO REMAIN.
 - EXISTING 125 KW GENERATOR TO REMAIN.
 - EXISTING 15 KW GENERATOR TO REMAIN.
 - EXISTING VERTICAL GAS LINE SERVING GENERATOR TO REMAIN.
 - RECONNECT TO EXISTING FUSED SWITCH AND MAKE ALL REQUIRED CONNECTIONS.
 - DISCONNECT AND REMOVE EXISTING PANEL IN ITS ENTIRETY.
 - INSTALL VFD BY OTHERS. INTERCEPT EXISTING COOLING TOWER FEEDER AND MAKE ALL REQUIRED CONNECTIONS.
 - EXISTING SPARE 3Ø400A, 250V SWITCH SERVED FROM EXISTING SWITCHBOARD. PROVIDE 400A FUSES AND TWO (2) SETS OF 4Ø3Ø-1Ø3ØGRD IN 2" TO SERVE PANEL P. MAKE ALL CONNECTIONS AS REQUIRED.
 - PROVIDE PANEL P. REFER TO PANEL P SCHEDULE. THIS SHEET FOR ADDITIONAL INFORMATION.
 - EXTEND EXISTING CIRCUIT AS REQUIRED AND MAKE ALL REQUIRED CONNECTIONS.

PANEL P		SURFACE MOUNTED ENCLOSURE						
208/120 VOLTS 3 PHASE 4 WIRE 400 AMPERE MAIN LUGS ONLY ISC= 10,000 A.I.C.								
CKT No.	DESCRIPTION	P/Ø	AMP	DWG No.	DESCRIPTION	P/Ø	AMP	DWG No.
1		2						
3	PUMP P-1	3	100	4	PUMP P-2	3	100	
5		6						
7		8						
9	PUMP P-3	3	60	10	PUMP P-4	3	60	
11		12						
13		14						
15	SPARE	3	100	16	SPARE	3	60	
17		18						
19	EQUIPPED SPACE	1	-	20	EQUIPPED SPACE	1	-	
21	EQUIPPED SPACE	1	-	22	EQUIPPED SPACE	1	-	
23	EQUIPPED SPACE	1	-	24	EQUIPPED SPACE	1	-	
25	EQUIPPED SPACE	1	-	26	EQUIPPED SPACE	1	-	
27	EQUIPPED SPACE	1	-	28	EQUIPPED SPACE	1	-	
29	EQUIPPED SPACE	1	-	30	EQUIPPED SPACE	1	-	
31	EQUIPPED SPACE	1	-	32	EQUIPPED SPACE	1	-	
33	EQUIPPED SPACE	1	-	34	EQUIPPED SPACE	1	-	
35	EQUIPPED SPACE	1	-	36	EQUIPPED SPACE	1	-	
37	EQUIPPED SPACE	1	-	38	EQUIPPED SPACE	1	-	
39	EQUIPPED SPACE	1	-	40	EQUIPPED SPACE	1	-	
41	EQUIPPED SPACE	1	-	42	EQUIPPED SPACE	1	-	

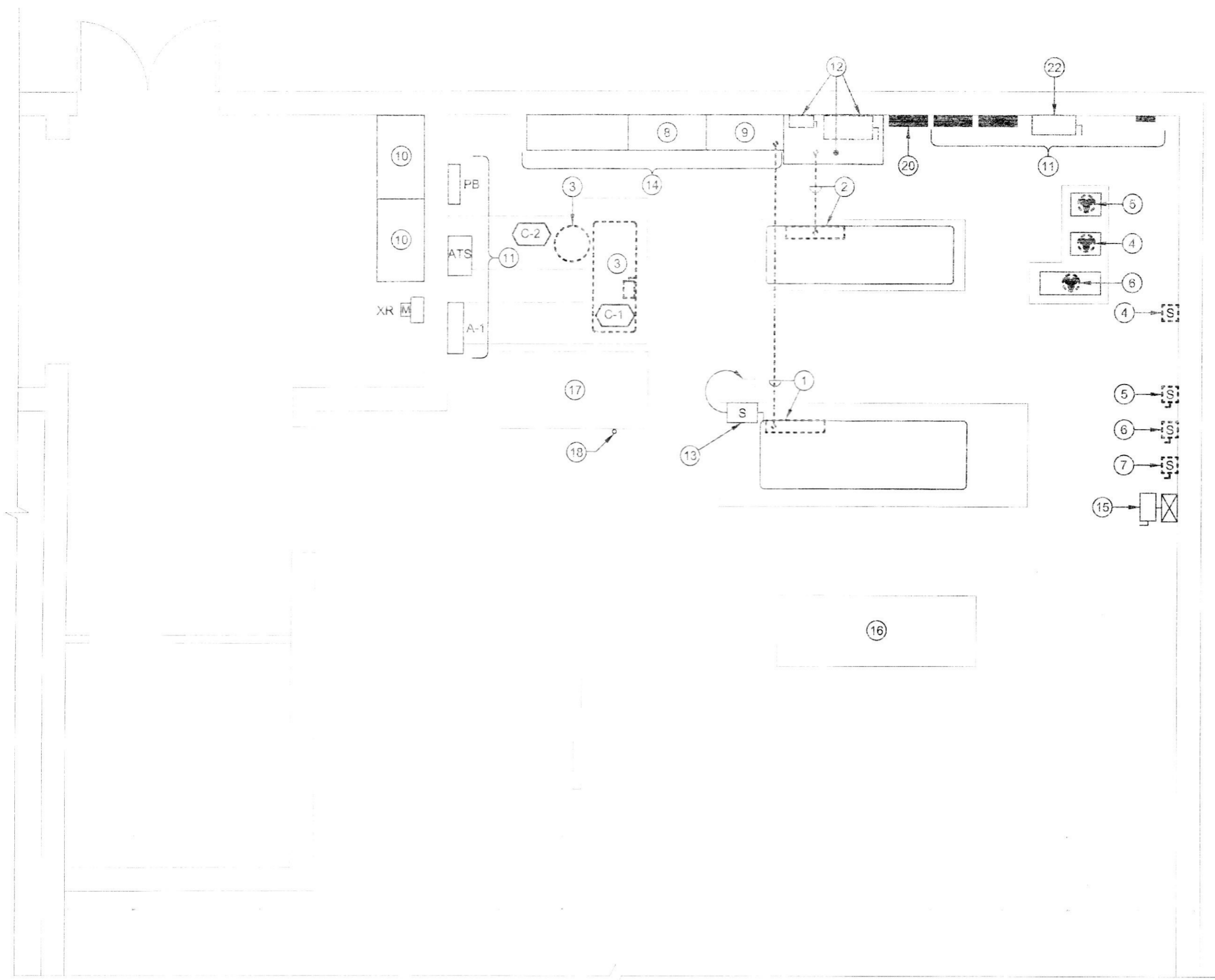

MECHANICAL ROOM PLAN - EXISTING CONDITIONS & DEMOLITION - ELECTRICAL
SCALE: 1/4" = 1'-0"

ELECTRICAL SYMBOLS LIST

- [Symbol] PANELBOARD 208/120 VOLTS, WALL MOUNT AT 6'-6" TO TOP.
- [Symbol] KILOWATT HOUR METER
- [Symbol] MAGNETIC STARTER, COMBINATION TYPE; WALL MOUNT AT 6'-0" TO TOP.
- [Symbol] MOTOR-SINGLE PHASE, THREE PHASE, HORSEPOWER AS NOTED
- [Symbol] DISCONNECT SWITCH-UNFUSED; WALL MOUNT AT 6'-0" TO TOP.
- [Symbol] DRAWING NOTE
- [Symbol] SPECIAL EQUIPMENT NUMBER, REFER TO "SCHEDULE OF MECHANICAL EQUIPMENT" CONNECTIONS ON EACH SHEET

ABBREVIATIONS

- A AMPERES
- A.I.C. AMPERES INTERRUPTING CAPACITY
- C CONDUIT
- CT COOLING TOWER
- EX EXISTING
- FLA FULL LOAD AMPES
- FSS FUSIBLE SAFETY SWITCH
- GRD GROUND
- HP HORSEPOWER
- KVA KILO-VOLT AMPERES
- KW KILO-WATT
- M.L.O. MAIN LUGS ONLY
- NO NUMBER
- Ø PHASE
- V VOLTS
- VFD VARIABLE FREQUENCY DRIVE
- XR EXISTING TO REMAIN

CONVENTIONS

- [Symbol] HEAVY AND SOLID LINES INDICATE NEW WORK
- [Symbol] LIGHT AND SOLID LINES INDICATE EXISTING TO REMAIN
- [Symbol] HEAVY AND DASHED LINES INDICATE REMOVE EXISTING

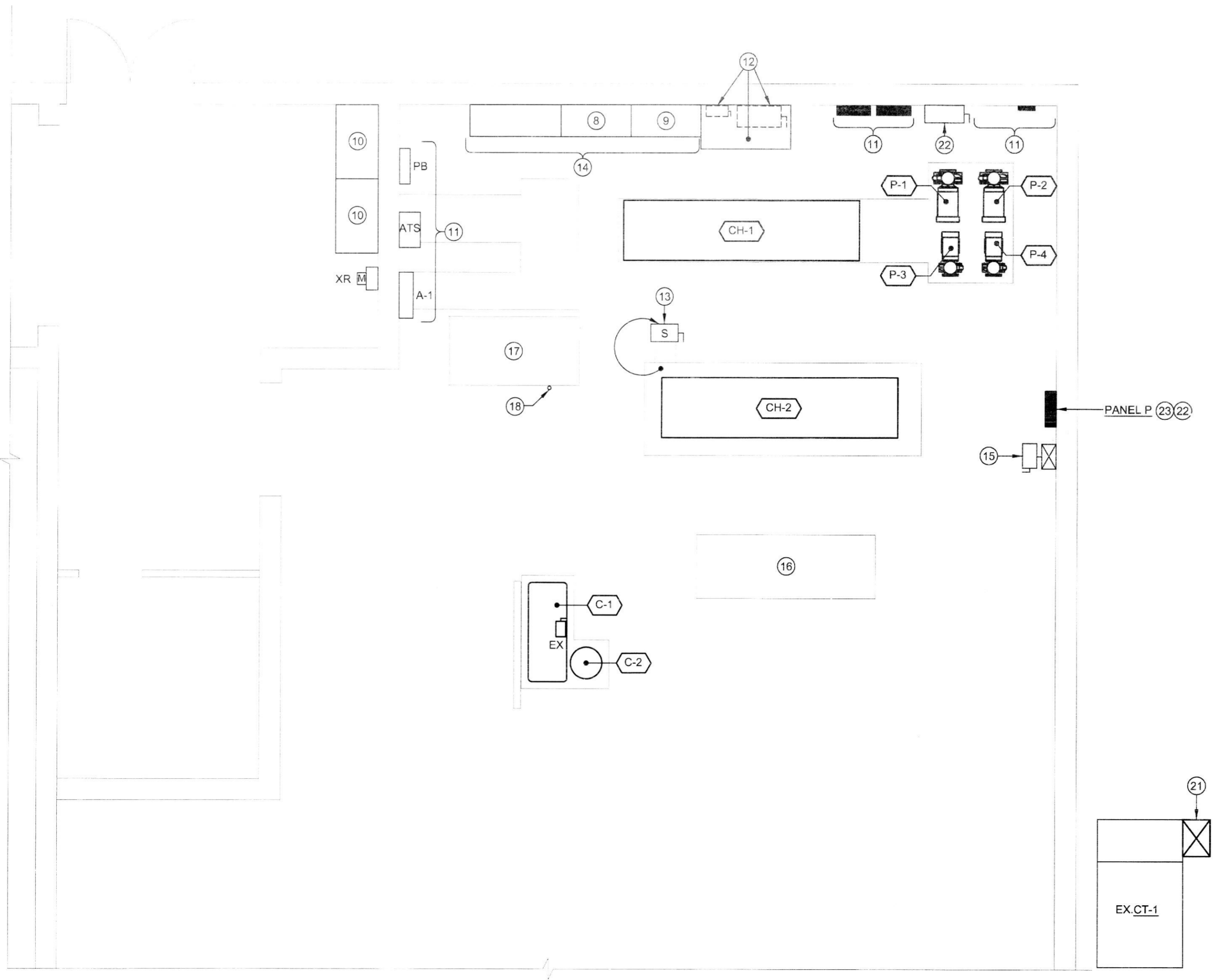

MECHANICAL ROOM PLAN - EXISTING CONDITIONS & NEW WORK - ELECTRICAL
SCALE: 1/4" = 1'-0"

NO.	DESCRIPTION	DATE

LAST REV:
PROJECT NO.: 14091A
DATE: 3/17/2015
SCALE: 1/4"=1'-0"
TITLE:
MECHANICAL RM
PLAN - EXISTING
CONDITIONS & NEW
WORK - ELECTRICAL

SHEET:
E
101

