

LOWER LEVEL
18'-4" x 14'-0"
NORTH
CONSTRUCTION

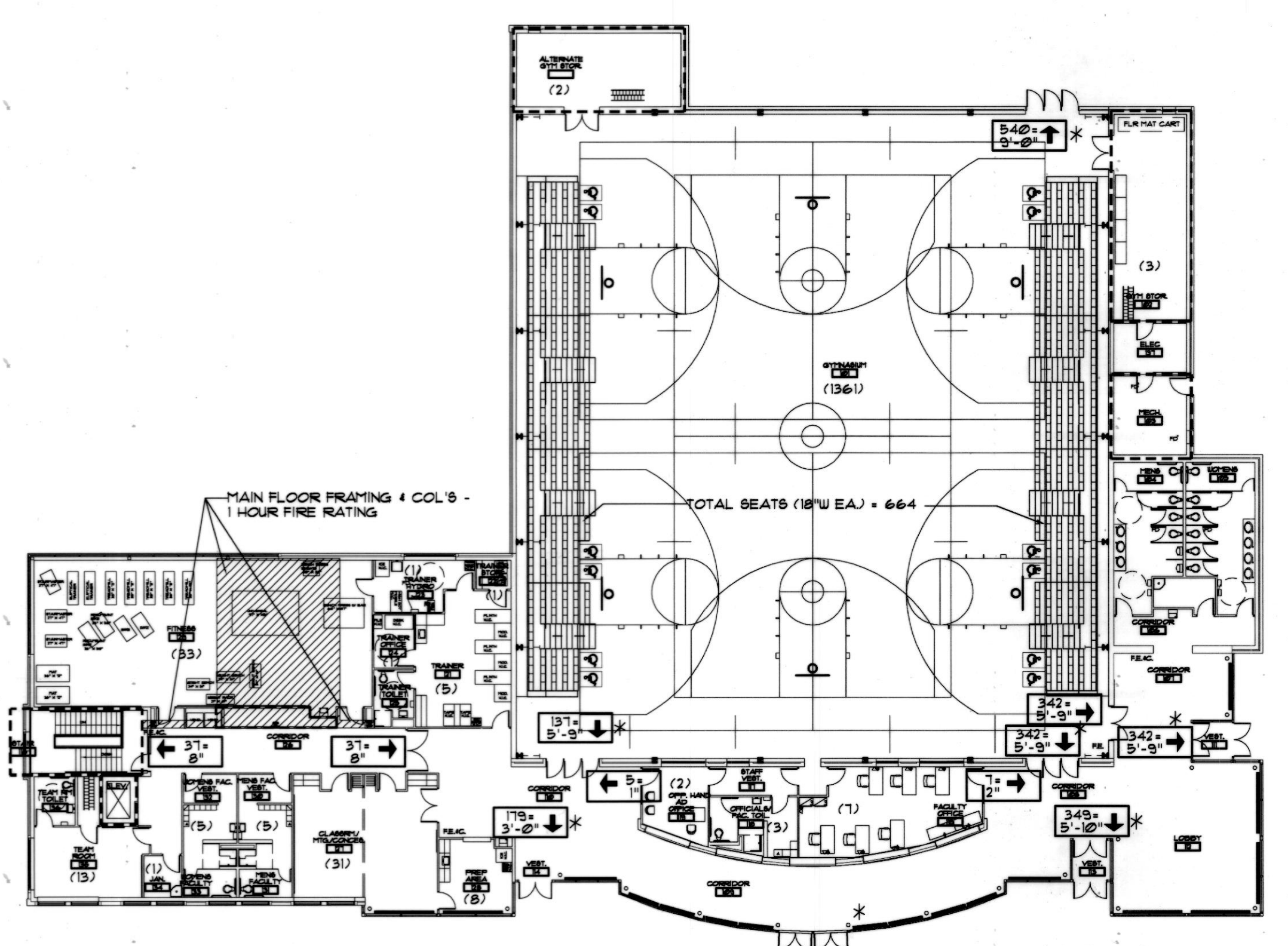

MAIN FLOOR
18'-4" x 14'-0"
NORTH
CONSTRUCTION

CODE REVIEW

A. CONSTRUCTION CLASSIFICATION: 2B PROTECTED NONCOMBUSTIBLE
THE BUILDING IS SEPARATED FROM THE EXISTING SCHOOL BY 30'-0".
THE BUILDING IS PROTECTED THROUGHOUT BY AN AUTOMATIC FIRE SUPPRESSION SYSTEM IN COMPLIANCE WITH NFPA.

B. GENERAL HEIGHT AND AREA LIMITATIONS

USE GROUP: A-4 ASSEMBLY

PER IBC TABLE 503:
HEIGHT MAX.: 2 STORIES OR 55'-0" HIGH
FLOOR AREA MAX.: 9,500 SF. PER FLR.

STORIES: 1 STORY + BASEMENT

HEIGHT (AVG. HT. OF ROOF): 34'-0"

5F. MAIN FLOOR 24,801 SF.

6F. LOWER LEVEL, INCL. ALTERNATE STOR. 6,103 SF.

IBC SECTION 506: AREA MODIFICATIONS

$$A_t = \left[\frac{A_t}{100} \right] + \left[\frac{A_b}{100} \right] = \text{ALLOW AREA PER FLOOR}$$

$A_t = 9,500$ IBC TABLE 503
 $A_b = 0$
 $I_f = 0$
 $I_b = 300$

$$9,500 + \left[\frac{9,500 \cdot 0}{100} \right] + \left[\frac{9,500 \cdot 300}{100} \right] = 38,000 \text{ SF.}$$

MAXIMUM AREA PER FLOOR WITH AREA INCREASE = 38,000 SF.
MAXIMUM HEIGHT WITH HEIGHT INCREASE = 3 STORIES OR 60'-0" HIGH

C. IBC TABLE 601: FIRE-RESIS. RATING REQUIREMENTS FOR BUILDING ELEMENTS

TYPE 2B

FRAME:	0
BEARING WALLS:	
EXTERIOR:	0
INTERIOR:	0
NON-BEARING WALLS & PARTITIONS:	
EXTERIOR:	0
INTERIOR:	0
FLOOR:	0
ROOF:	0

- D. PROTECTED AREAS
- | 1. | 2. | 3. | 4. | 5. | | |
|--------------|--|--------|----|----|--|--|
| IBC 302.1.1 | LAUNDRY ROOMS OVER 100' | 1 HOUR | | | | |
| IBC 302.1.1 | STORAGE ROOMS OVER 100' | 1 HOUR | | | | |
| IBC 1005.3.2 | VERTICAL EXIT ENCLOSURES | 1 HOUR | | | | |
| IBC 1011.4 | VERTICAL SHAFT ENCLOSURES (AND SUP. STRUCT.) | 1 HOUR | | | | |
| IBC 1011.4 | ELEVATOR SHAFT | 1 HOUR | | | | |

E. OCCUPANT LOAD - SEE KEY PLANS (XXX)

	FACTOR	LOAD
MIN. WIDTH REQUIRED, W/SPRINKLERING	Ø 2 IN/PERSON	SEE FLOOR PLANS
LOWER LEVEL		
LOCKER ROOMS	50 NSF/PERSON	58
EXERCISE ROOMS - NO EQPT.	(NFPA) 15 NSF/PERSON	83
ACC. STORAGE/MECHANICAL	300 NSF/PERSON	5
TOTAL		91
MAIN FLOOR		
GYMNASIUM - 2 WAYS TO CALCULATE LOAD		1361
1-ASSEMBLY UNCONCENTRATED	15 NSF/PERSON = 821	
2-ASSEMBLY W/ FIXED SEATING		
FIXED SEATING	10"/SEAT = 664	
REST OF GYM UNCONCENTRATED	15 NSF/PER. = 693	
TOTAL		1361
CLASSROOM AREA	20 NSF/PERSON	52
EXERCISE ROOMS - W/ EQPT.	50 NSF/PERSON	33
LOCKER ROOMS	50 NSF/PERSON	13
INPATIENT TREATMENT AREAS	240 NSF/PERSON	6
BUSINESS AREAS	100 NSF/PERSON	10
ACC. STORAGE/MECHANICAL	300 NSF/PERSON	9
TOTAL		1484

- E. GENERAL MEANS OF EGRESS
- | | |
|---|---|
| 1. MIN. EGRESS WIDTH: IBC 1003.2.3 | SEE PLANS |
| 2. AREA OF REFUGE: IBC 1003.2.13.2, NFPA 13.4.1 | SEE PLANS |
| 3. MIN. STAIRWAY WIDTH: IBC 1003.3.1 | MIN. STAIRWAY WIDTH PER OCCUPANT LOAD IS 8", HOWEVER, MIN. STAIRWAY WIDTH PER IBC 1003.3.3.1 IS 48" |

- F. EXIT ACCESS
- | | |
|--|--|
| 1. MIN. EXITS PER SPACE: IBC 1004.2.1 | THE GYMNASIUM AND LOCKER ROOMS ARE SPACES WITH OVER 50 OCCUPANTS AND SO REQUIRE 2 REMOTE MEANS OF EGRESS WITH PANIC HARDWARE. |
| 2. MAX. TRAVEL DISTANCE: IBC 1004.2.4, NFPA 12.2.6 | (IBC) 250 FT. W/ SPRINKLER SYSTEM (NFPA) 200 FT. W/ SPRINKLER SYSTEM |
| 3. MAX. COMMON PATH OF TRAVEL: IBC 1004.2.5 | 75 FT. |
| 4. MIN. CORRIDOR FIRE RATING: IBC 1004.3.2.1, NFPA 7.1.3.1, 12.3.6 | Ø |
| 5. MIN. CORRIDOR WIDTH: IBC 1004.3.2.2 | MIN. CORRIDOR WIDTH IS 12" FOR USE GROUP E SERVING OVER 100 OCCUPANTS, 44" MIN. ELSEWHERE, UNLESS SERVING LESS THAN 50 OCCUPANTS (36") |
| 5. MIN. STAIR WIDTH: IBC 1004.3.2.2, NFPA 7.3.3.1 | 3 PER PERSON = 12", THEREFORE 44" CLEAR BETWEEN HANDRAILS. ACTUAL DESIGN: 5'-2" |
| 6. MAX. DEAD END CORRIDOR: IBC 1004.3.2.3 | 20 FT. |

- G. EXITS
- | | |
|---|---|
| 1. MIN. EXITS PER FLOOR: IBC 1005.2.1 | THE MAIN FLOOR HAS MORE THAN 1000 OCCUPANTS AND IS REQUIRED TO HAVE 4 EXITS. THE LOWER LEVEL IS REQUIRED TO HAVE TWO EXITS. |
| 2. MIN. EXIT STAIRWAY ENCL.: IBC 1005.3.2 | 1 HOUR |

- H. REQUIRED SIGNS/POSTING
- | | |
|--|------------------------|
| A. POST OCCUPANT LOAD IN ASSEMBLY AREAS (IBC 1003.2.2.3) | GYMNASIUM |
| B. EXIT SIGNS (IBC 1003.2.10) | SEE ELECTRICAL |
| C. TACTILE STAIRWAY EXIT SIGNS (IBC 1003.2.10.3) | NEXT TO STAIR DOORS |
| D. ELEVATOR SIGNAGE (IBC 1003.2.13.6) | NEXT TO ELEVATOR DOORS |
| E. FLOOR NUMBER SIGN (IBC 1005.3.2.4) | NEXT TO STAIR DOORS |

- I. ACCESSIBILITY
- ALL TOILET ROOMS HAVE AT LEAST ONE ACCESSIBLE OF EACH TYPE FIXTURE
 - ALL SPACES ARE ON AN ACCESSIBLE ROUTE
 - RESCUE ASSISTANCE AREA NOT REQUIRED AT GRADE EXITS.

LEGEND

FE or FE.4.C Provide Fire Extinguisher
(XXX) INDICATES OCCUPANT LOAD FOR EGRESS
* INDICATES DOORS WITH PANIC DEVICES OR NO LOCKS
---- 1 HR. FIRE SEPARATION REQUIRED
- - - - - TWO-HOUR FIRE SEPARATION REQUIRED - UL, UL905 (2 HR PROVIDED)

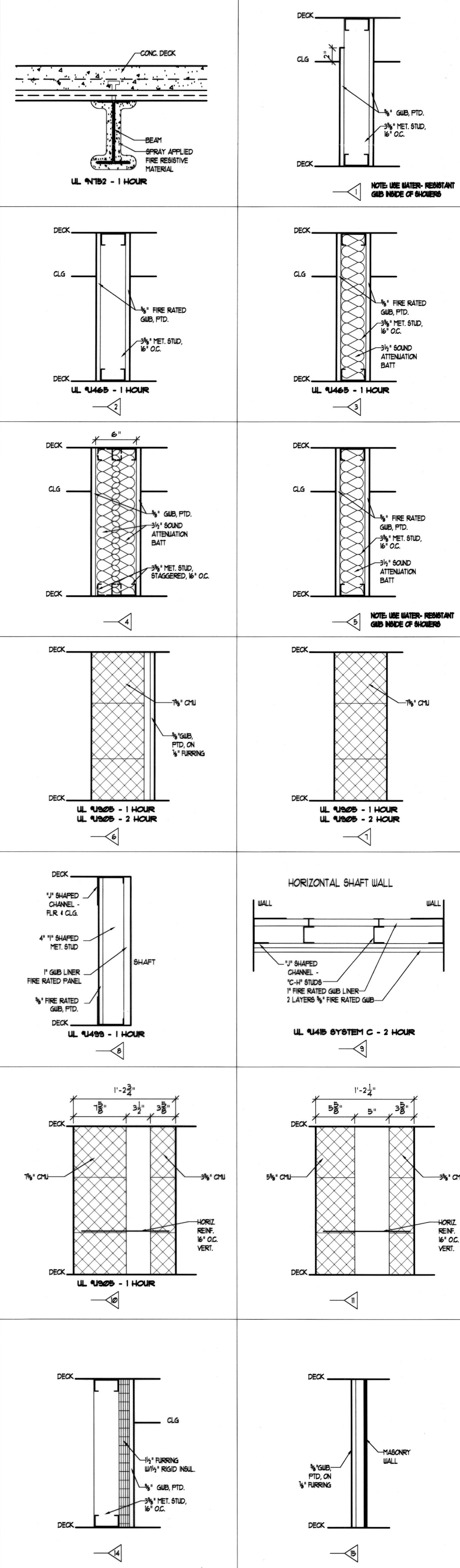

RUBELING & ASSOCIATES, INC.
ARCHITECTURE
INTERIOR DESIGN
401 JEFFERSON AVENUE
TOWSON, MARYLAND 21286-5308
410-337-5888
FAX: 410-337-2974

SPORT AND FITNESS CENTER
NOTRE DAME PREPARATORY SCHOOL
815 HAMPTON LANE
TOWSON, MARYLAND 21286

REVISIONS:

NO.	DESCRIPTION	DATE

LAST REV.:
PROJECT NO.: 02-021
DATE: 6-21-03
SCALE: 1/8" = 1'-0"
TITLE: CODE REVIEW

SHEET: A

001