

A B C D E F G H J K L M N P Q R S T U

DRAWING NOTES

- 150A EPDM
- 1500B ROOF MOUNTED EXHAUST FAN



**RUBELING & ASSOCIATES, INC.**  
ARCHITECTURE  
INTERIOR DESIGN  
401 JEFFERSON AVENUE  
TOWSON, MARYLAND 21286-5308  
410-287-2888  
FAX: 410-287-3274

SPORT AND FITNESS CENTER  
NOTRE DAME PREPARATORY SCHOOL

815 HAMPTON LANE  
TOWSON, MARYLAND 21286

REVISIONS:

NO.	DESCRIPTION	DATE
1	RECORD DWG.	05/05/05

LAST REV.:  
PROJECT NO.: 02-031  
DATE: 6-21-03  
SCALE: 1/8"=1'-0"  
TITLE: ROOF PLAN

SHEET: **A**  
**104**

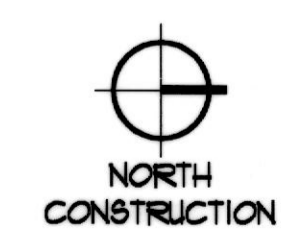
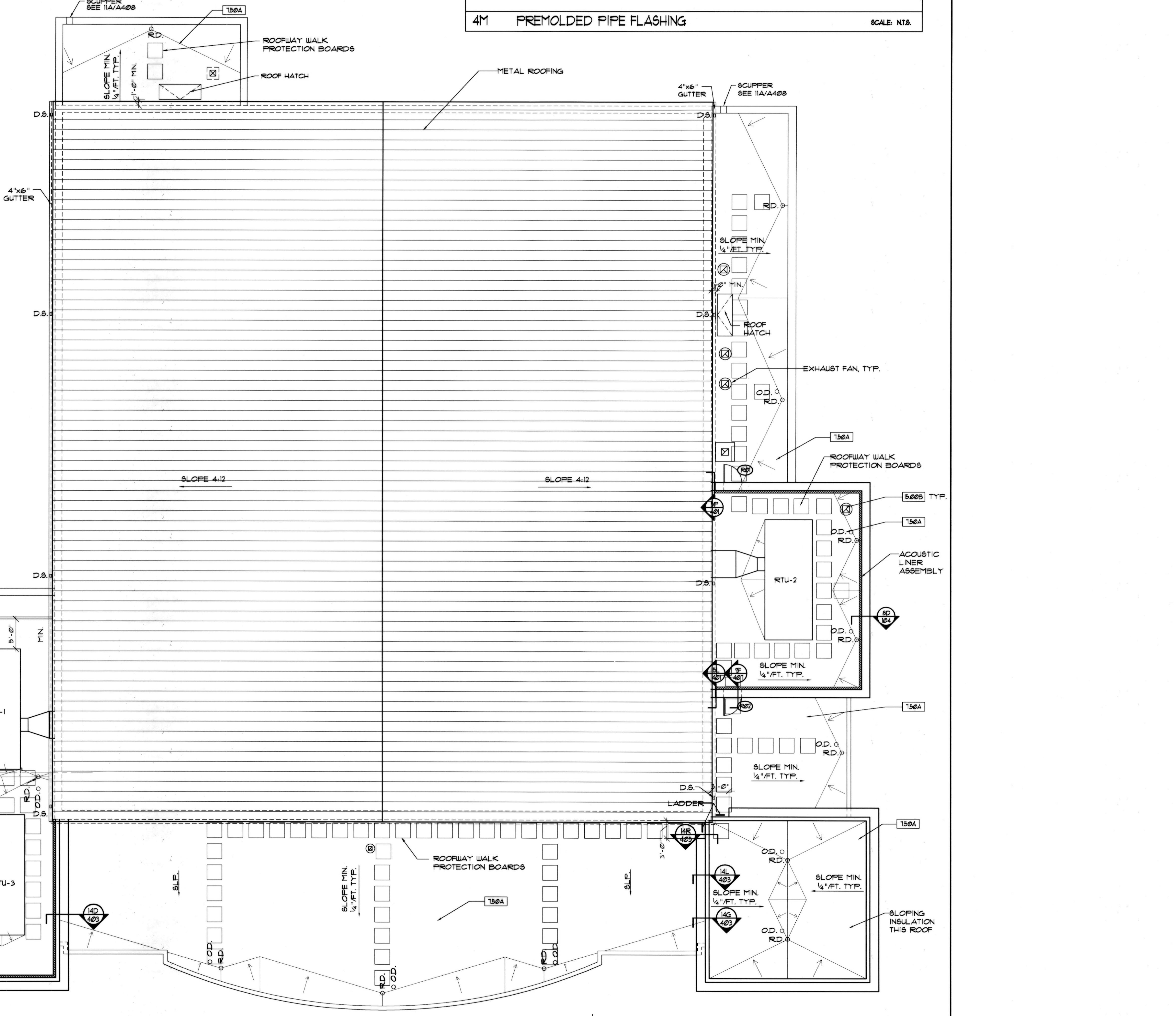
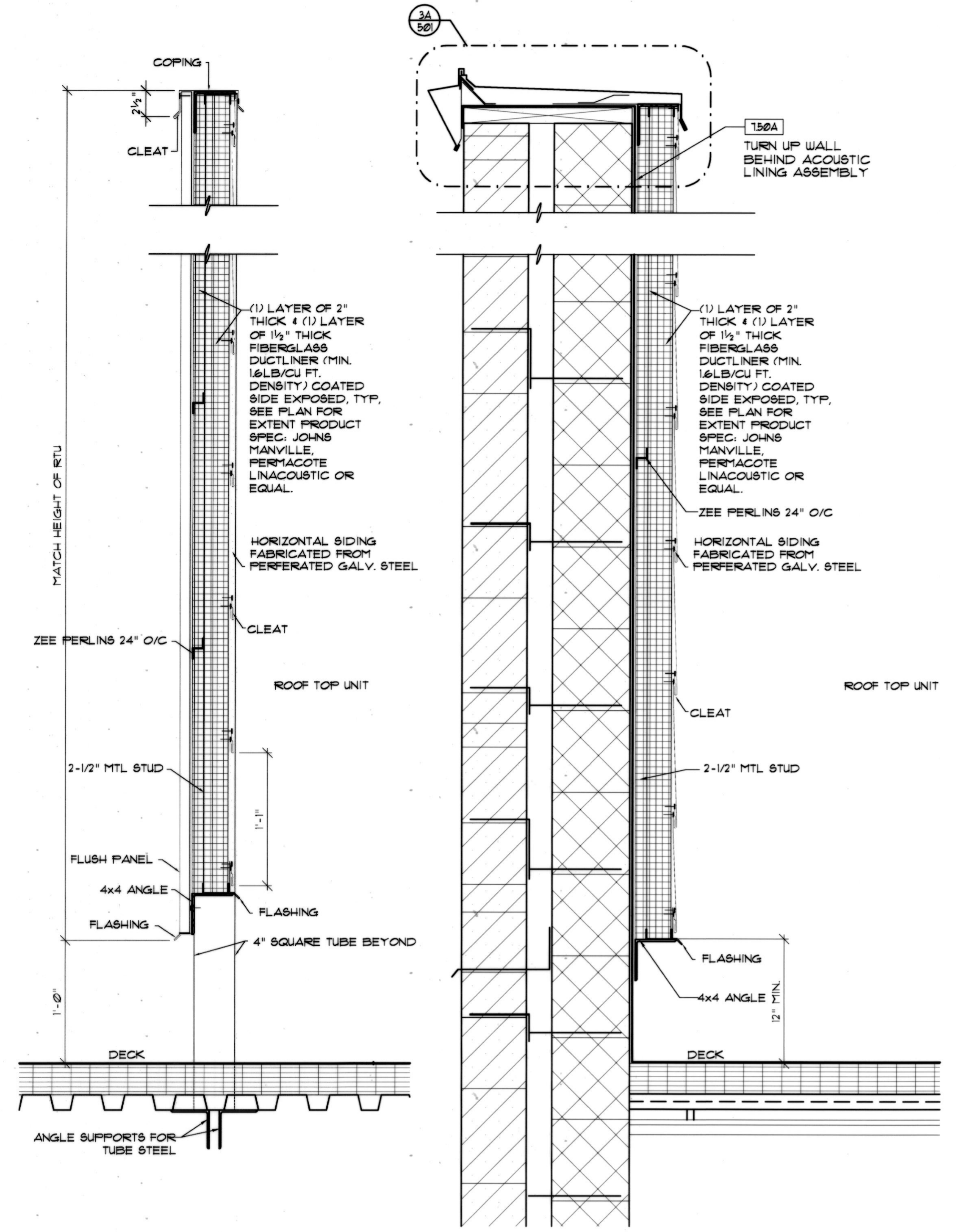
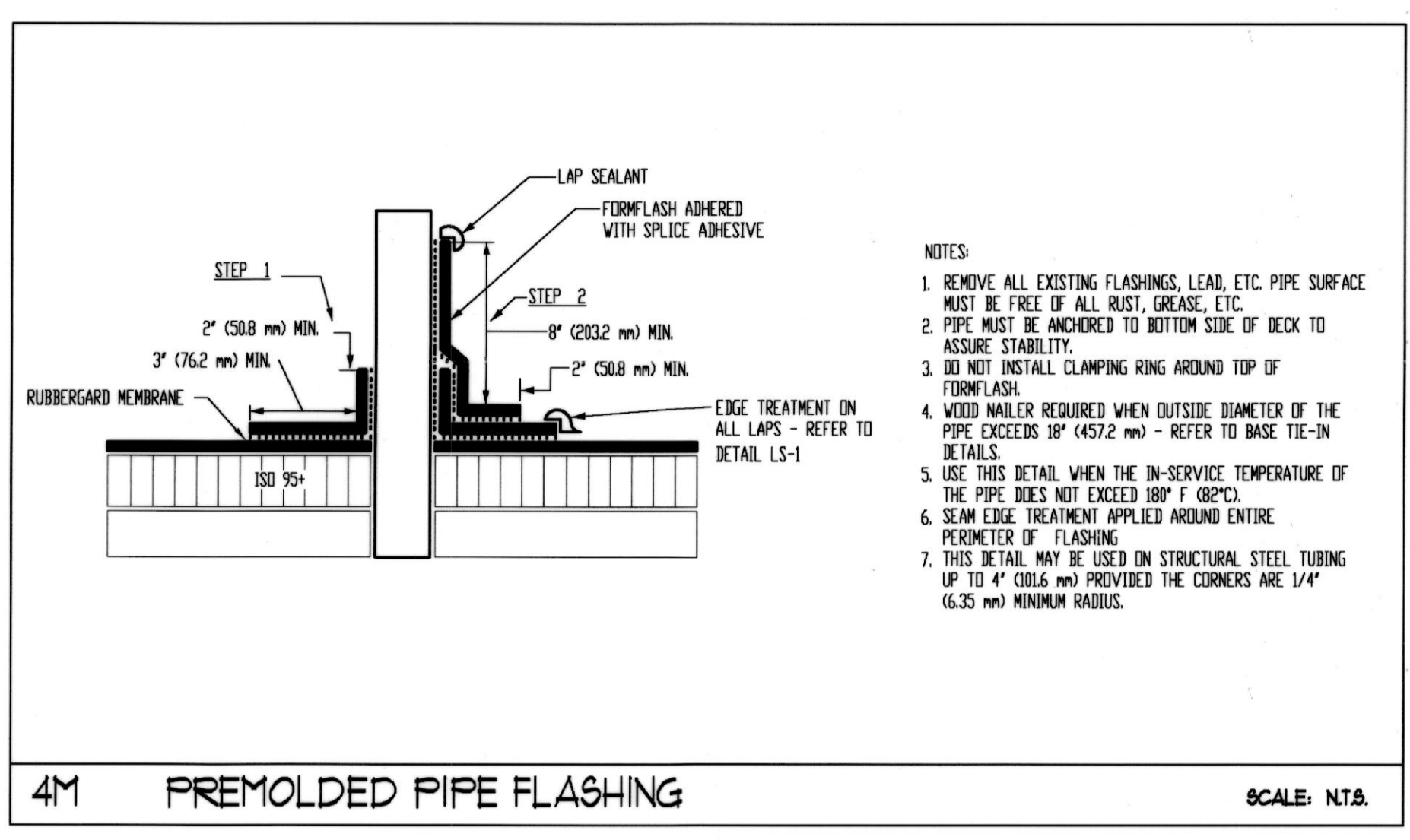

ROOF PLAN  
1/8" = 1'-0"  
NOTE: SEE A428 FOR ADDITIONAL ROOF DETAILS  
ADD ALTERNATE #3: Add the cost of the Sound Attenuation package to the roof top equipment.