

GENERAL NOTES:

- FOR SYMBOLS & ABBREVIATIONS SEE DWG. M000.
- ALL ABOVE CEILING SPACES ARE CONSIDERED RETURN AIR PLENUMS. ALL MATERIALS TO BE INSTALLED IN CEILING SPACES SHALL MEET FLAME SPREAD AND SMOKE DEVELOPMENT REQUIREMENTS FOR PLENUM APPLICATIONS.

FIRE SUPPRESSION NOTES:

- A CERTIFIED SPRINKLER CONTRACTOR SHALL MODIFY AND EXTEND THE EXISTING FIRE PROTECTION SPRINKLER SYSTEM TO PROVIDE A COMPLETE WET PIPE SPRINKLER SYSTEM TO ALL RENOVATED AREAS TO ACCOMMODATE PROPER SPRINKLER COVERAGE PER NFPA 13, ALL LOCAL APPLICABLE FIRE PROTECTION CODES AND THE LOCAL FIRE MARSHAL AND/OR THE AUTHORITY HAVING JURISDICTION. SPRINKLER CLASSIFICATION SHALL BE "LIGHT HAZARD" OR AS OTHERWISE NOTED. COORDINATE SPRINKLER HEADS WITH NEW CEILING LAYOUT AND ALL OTHER TRADES.
- THE CONTRACTOR SHALL OBTAIN ALL NECESSARY PERMITS AND FOLLOW ALL APPLICABLE CODES TO PERFORM THE WORK AS OUTLINED. ALL CERTIFICATES OF FINAL INSPECTION SHALL BE DELIVERED TO OWNER AT COMPLETION OF PROJECT.
- THE CONTRACTOR SHALL SUBMIT A LIST OF ALL MATERIALS AND EQUIPMENT TO BE UTILIZED ON THE PROJECT. CUT SHEETS AND EQUIPMENT DATA SHALL BE SUBMITTED FOR APPROVAL TO THE OWNER'S REPRESENTATIVE.
- THE CONTRACTOR SHALL VISIT JOBSITE PRIOR TO BID AND INCLUDE ANY SPECIAL PROVISIONS & CONDITIONS AFFECTING THE PROJECT.
- CONTRACTOR SHALL FIELD VERIFY EXACT LOCATION OF ALL PIPING, ETC., AND COORDINATE WITH OTHER TRADES PRIOR TO THE INSTALLATION OF NEW WORK.

NEW WORK REFERENCE NOTES:

- CONTRACTOR TO FIELD VERIFY LOCATION OF EXISTING PLUMBING PIPING FOR CONNECTION OF NEW PLUMBING FIXTURES IN THIS AREA.
- EXTEND 2" VTR TO 12" ABOVE ROOF; INSTALL FLASHING AND REPAIR ROOF.
- 3/4" DOMESTIC CW PIPING ROUTE IN 1ST FLOOR CEILING AND TIE INTO EXISTING DOMESTIC CW MAIN 1-1/2" OR LARGER.
- LOCATE EXISTING 4" SANITARY; SAWCUT AND DEMO CONCRETE FLOOR FROM EXISTING 4" SANITARY TO P-4 PLUMBING FIXTURE ROUTE AND LOCATION AS INDICATED ON DRAWING. CONNECT TO EXISTING 4" SANITARY, INSTALL SANITARY PIPING TO P-4 PLUMBING FIXTURE AS INDICATED ON DRAWING.
- TEWH-1 NEW CHROMONITE MODEL # M-40 INSTANT-FLOW MICRO TANKLESS ELECTRIC WATER HEATER, 208V, SINGLE PHASE OR EQUAL, MOUNTED UNDER SINK COUNTERTOP.
- GE 1/2 HORSEPOWER CONTINUOUS FEED DISPOSER MODEL #GFC525F OR EQUAL.
- P-7 PROVIDE AND INSTALL ICE MAKER WATER BOX; STAINLESS STEEL ICE MAKER BOX W/O.T.R. TURN SWEAT VALVE. BASIS OF DESIGN: GUY GRAY MODEL #SS1B1 OR EQUAL.
- HW FROM TANKLESS EWH-1 TO KITCHEN SINK FAUCET.
- P-4 PROVIDE AND INSTALL KITCHEN SINK MFG. BY ELKAY, GOURMET (LUSTERTONE) SINK MODEL #L2402522 WITH DELTA SINGLE HANDLE KITCHEN FAUCET MODEL #100-WF OR EQUAL; TRUEBRO ADA COMPLIANT BASIN GUARD/INSULATED SHIELD OR EQUAL. SINK INSTALLATION SHALL BE ADA COMPLIANT.
- SEE DWG. P100 FOR CONTINUATION.
- PROVIDE DOMESTIC HOT WATER AND WASTE CONNECTION THRU AIR GAP FITTING TO DISHWASHER P-5.
- 1/2" CW DN TO WATER COOLER P-7A.

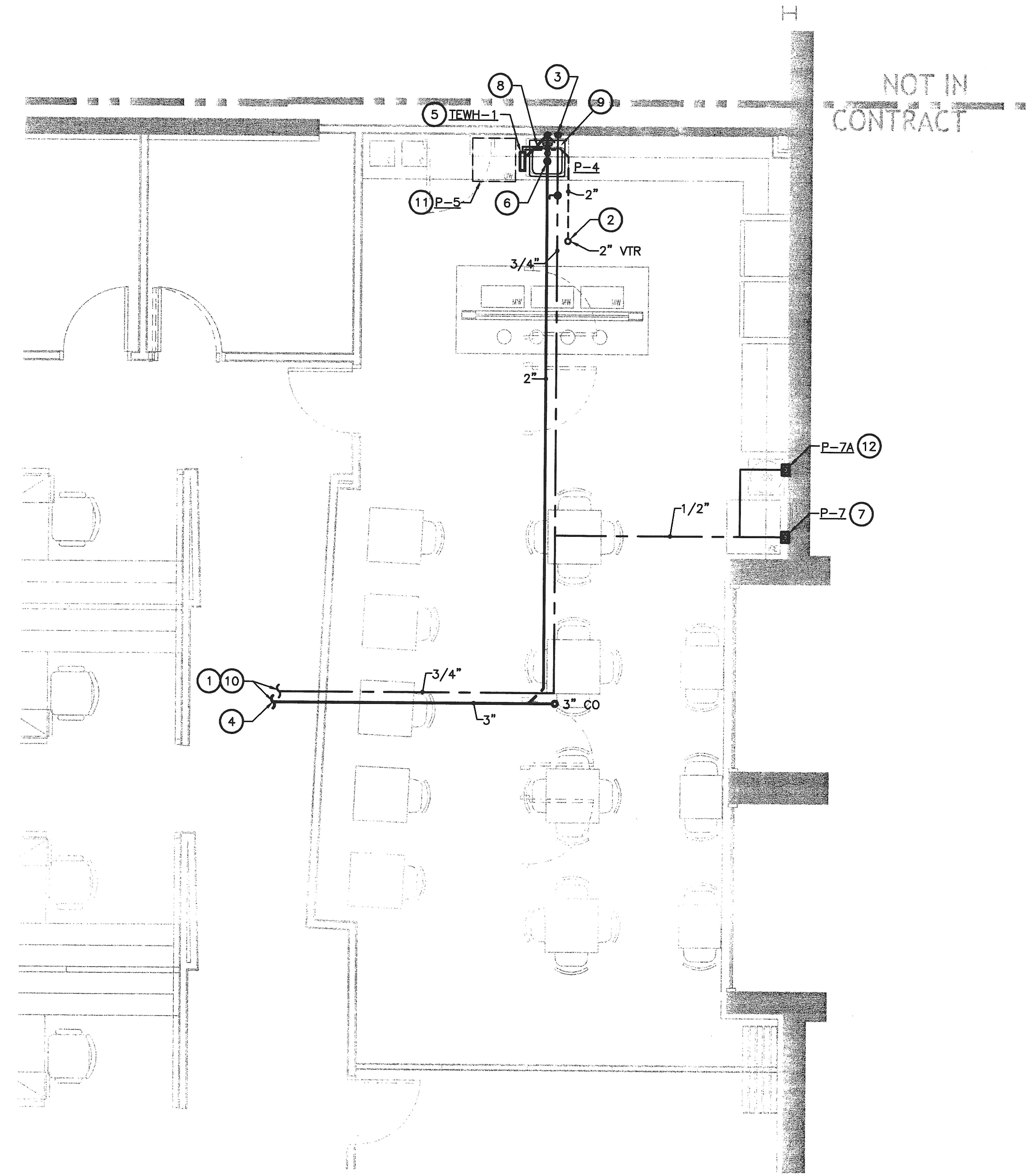

PART PLAN - PLUMBING
SCALE: 1/4"=1'-0"

DESIGN COLLECTIVE

ARCHITECTURE, PLANNING, INTERIORS
WWW.DESIGNCOLLECTIVE.COM

601 EAST PRATT STREET, SUITE 300
BALTIMORE, MARYLAND 21202
T: 410.685.6655 F: 410.539.6242

312 BLACKWELL STREET, SUITE 100
DURHAM, NORTH CAROLINA 27701
T: 919.381.9322 F: 919.381.9323

DESIGN COLLECTIVE, INC. ALL RIGHTS RESERVED

ISSUED FOR	DATE
BID SET	07.07.2011
PERMIT	07.15.2011

CONSULTANT
THIRTY CENTURY
ENGINEERING
CONSULTING ENGINEERS - PLANNERS
10710 GLEBOY ROAD
HUNT VALLEY, MD 21081
Phone: 443-589-2400 Fax: 443-589-2401

OWNER / DEVELOPER
Johns Hopkins Healthcare
6704 Curtis Court
Glen Burnie, MD 21060

PROJECT NAME
Johns Hopkins Healthcare Masterplan

PROJECT ADDRESS
6701 Curtis Court
Suite D
Glen Burnie, MD 21060
PROJECT MANAGEMENT
DCI Project No. 459-10-01

SEAL
"Professional Certification. I hereby certify that these documents were prepared or approved by me, and that I am a duly licensed professional engineer under the laws of the State of Maryland, License No. 33030
Expiration Date: 07-06-2012

SHEET TITLE
PART PLAN - PLUMBING

SCALE
AS SHOWN

SHEET NUMBER
P101

