

D1 1/4" = 1'-0" STAIR #1
SECOND LEVEL

D5 1/4" = 1'-0" STAIR #1
GROUND LEVEL

D0 1/4" = 1'-0" STAIR #1
BASEMENT LEVEL

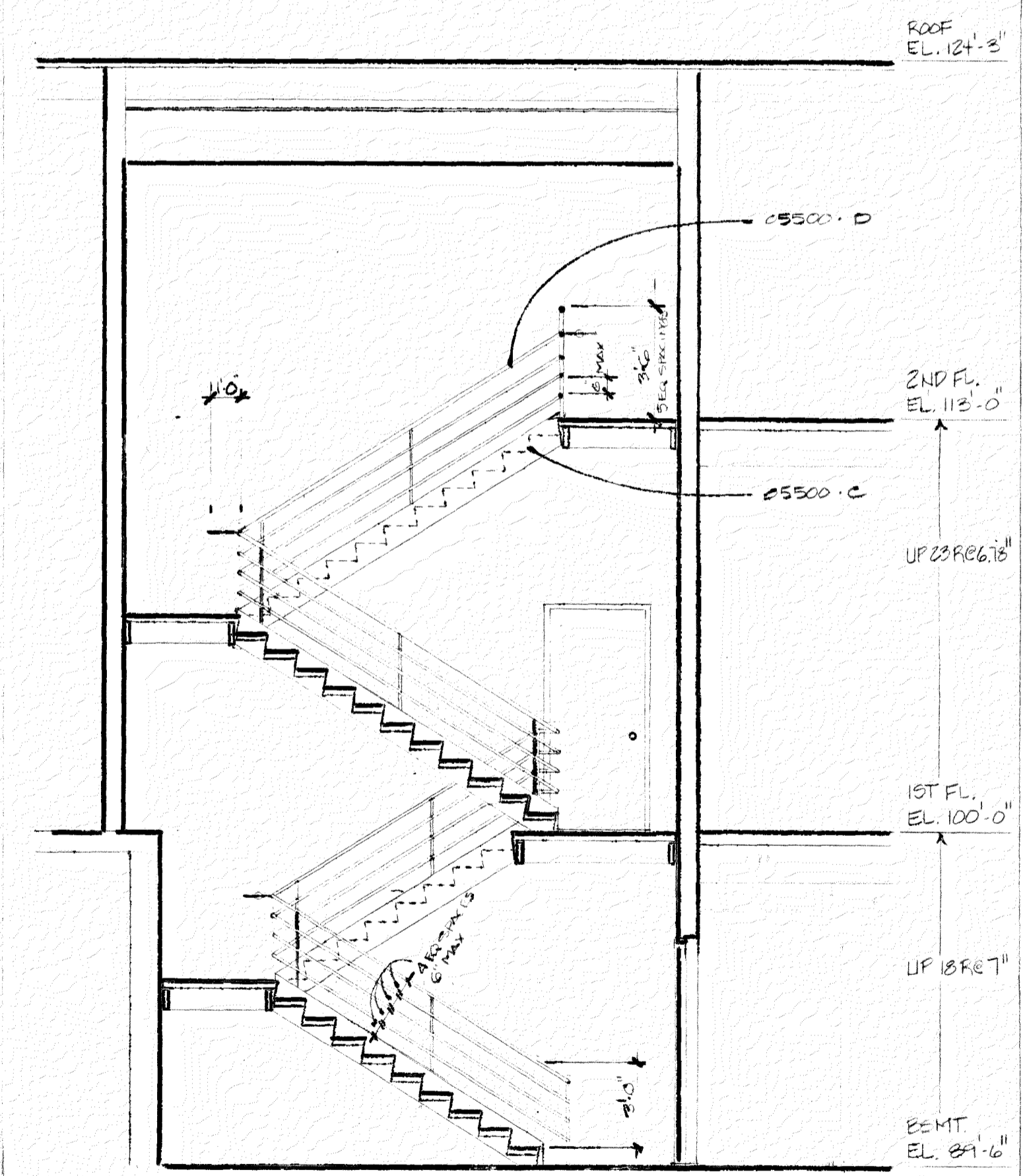

- | NO | DATE | REVISION |
|---------|------|---|
| 04200.A | | MASONRY INFILL IN EXISTING OPENING. USE DAMAGED OR REPAIRED MATCHING BRICK. EXISTING MASONRY WALL. |
| 04500.A | | CLEAN EXISTING LIMESTONE PANELS. REPOINT, RECAULK JOINTS.
CLEAN EXISTING TERRA COTTA MASONRY UNITS. REPOINT, REPAIR MASONRY COPING FOR WEATHERTIGHT SEAL. RECAULK. |
| 05000.A | | CLEAN & PAINT EXISTING STEEL SUPPORT STRUCTURE TO REMAIN. |
| 05500.A | | REPAIR & REPAINT EXISTING RETRACTABLE METAL STAIR.
1/2" GALVANIZED METAL PIPE RAIL PAINTED.
CONCRETE FILLED METAL PAN STAIR.
PAINTED METAL PIPE RAIL. |
| 06100.A | | 2X PRESSURE TREATED WOOD BLOCKING.
1/2" CDX PLYWOOD. |
| 07511.A | | BUILT-UP ASPHALT ROOFING. REMOVE EXIST ROOFING.
EXISTING GYPSUM PLANK DECK.
CONC. ROOF PAVERS.
PROVIDE CANT, FLASHING, COUNTER-FLASHING, & SEALANT AT ROOFING/VERTICAL WALL SURFACE CONNECTION. |
| 07600.A | | METAL GRAVEL STOP. MATCH EXISTING.
CONT. METAL CLEAT.
PREFORMED METAL FLASHING. |
| 07900.A | | CONT SEALANT. |
| 08110.A | | HOLLOW METAL DOOR. PAINTED. |
| 08410.A | | WIDE STILE ALUMINUM ENTRANCE DOORS, & SIDE LIGHTS - FINISH & COLOR TO MATCH ALUMINUM WINDOWS.
ALUMINUM TRANSOM ABOVE ENTRANCE. FINISH TO MATCH ALUMINUM ENTRANCE.
ALUMINUM JAMB EXTENSION - FINISH TO MATCH WINDOW SYSTEM. |
| 09250.A | | PATCH & REPAIR EXISTING PLASTER MARQUEE.
6" RADIUS LIGHT COVE - FIT TO CON - LEFT OR EQUAL. PROVIDE PREMANUFACTURED CORNERS. ALL EXPOSED ENDS TO BE 90 DEGREE MITERED RETURN.
GYPSUM BOARD.
3 5/8" METAL STUDS.
5/8" TYPE 'X' GYPSUM BOARD.
C-H STUD.
1" SHAFR WALL LINER PANEL.
7/8" FURRING CHANNELS.
2 1/2" METAL STUDS. |

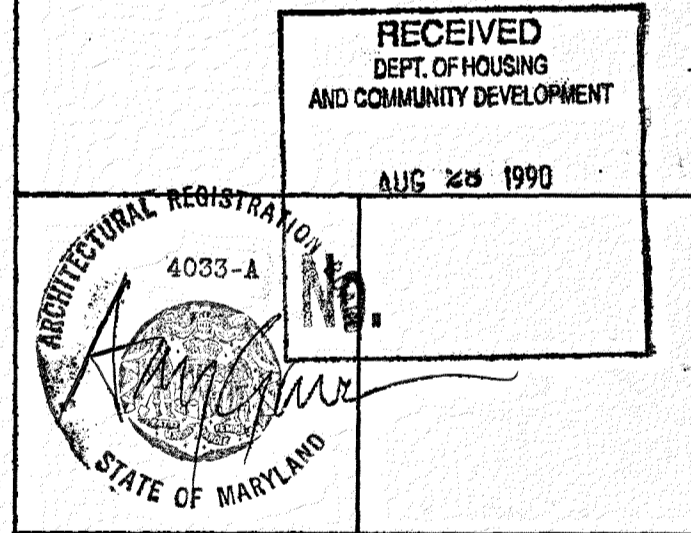

APPROVED
DIRECTOR - CONSTRUCTION & BUILDING INSPECTION
ELEC. MECH. CONST. FINAL ISSUED
SA. Wilpat SEP 14 1990

STAIR PLANS/ SECTION SHEET
OFFICES FOR THE BALTIMORE REGIONAL COUNCIL OF GOVERNMENTS
GREYHOUND STATION PROJECT

GOULD ARCHITECTS P.A.
518 N. Charles Street Baltimore, Maryland 21201
301-244-0070

3-20-90	DATE
	SCALE
	DRAWN
	BINDING ORDER

A6.1

L10 1/4" = 1'-0" STAIR #1
SECTION