



J. T. FISHMAN & ASSOCIATES
 ARCHITECTS-PLANNERS
 6 DORSET HILL COURT
 OWINGS MILLS, MARYLAND, 21117
 (410) 581-5800 FAX: (410) 286-1572
 PROFESSIONAL CERTIFICATION
 I CERTIFY THAT THESE DOCUMENTS WERE
 PREPARED OR APPROVED BY ME AND THAT I AM
 DULY LICENSED ARCHITECT UNDER THE LAWS OF
 LICENSE # 5425 EXP. DATE 09/17/19

GALLOWAY CREEK CONDOMINIUMS

1414 BURKE ROAD
 BOWLEYS QUARTERS-GALLOWAY CREEK
 BALTIMORE COUNTY, MARYLAND

THESE DRAWINGS ARE THE PROPERTY OF
 J. T. FISHMAN & ASSOCIATES. UNAUTHORIZED
 REPRODUCTION FOR ANY PURPOSE IS AN
 INFRINGEMENT UPON COPYRIGHT LAWS. VIOLATORS
 WILL BE SUBJECT TO PROSECUTION BY THE FULLEST
 EXTENT OF THE LAW.
 WRITTEN DIMENSIONS ON THESE DRAWINGS SHALL
 TAKE PRECEDENCE OVER SCALE DIMENSIONS.
 CONTRACTORS SHALL VERIFY & BE RESPONSIBLE
 FOR ALL DIMENSIONS AND CONDITIONS ON THE JOB.
 THIS OFFICE MUST BE NOTIFIED OF ANY VARIATION
 FROM THE DIMENSIONS AND CONDITIONS SHOWN BY
 THESE DRAWINGS.

CONTENT:
 SECOND & THIRD
 FLOOR PLANS

© 2018 J.T. FISHMAN & ASSOCIATES

NO.	DATE	ISSUE
1	11-28-18	BALTO CO COMMENTS

DATE: 8-20-2018

SCALE: AS NOTED

PROJECT NO.: 150101

A-1.2

SHEET 5 OF 19

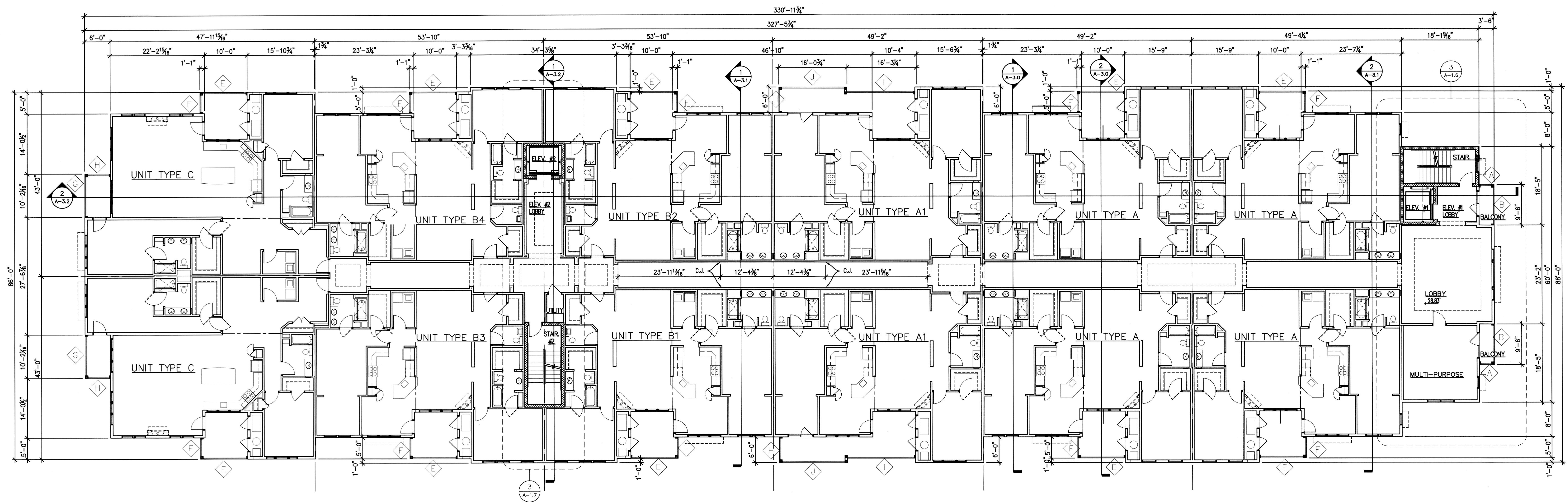

1 SECOND FLOOR PLAN
 A-1.2 3/32" = 1'-0"

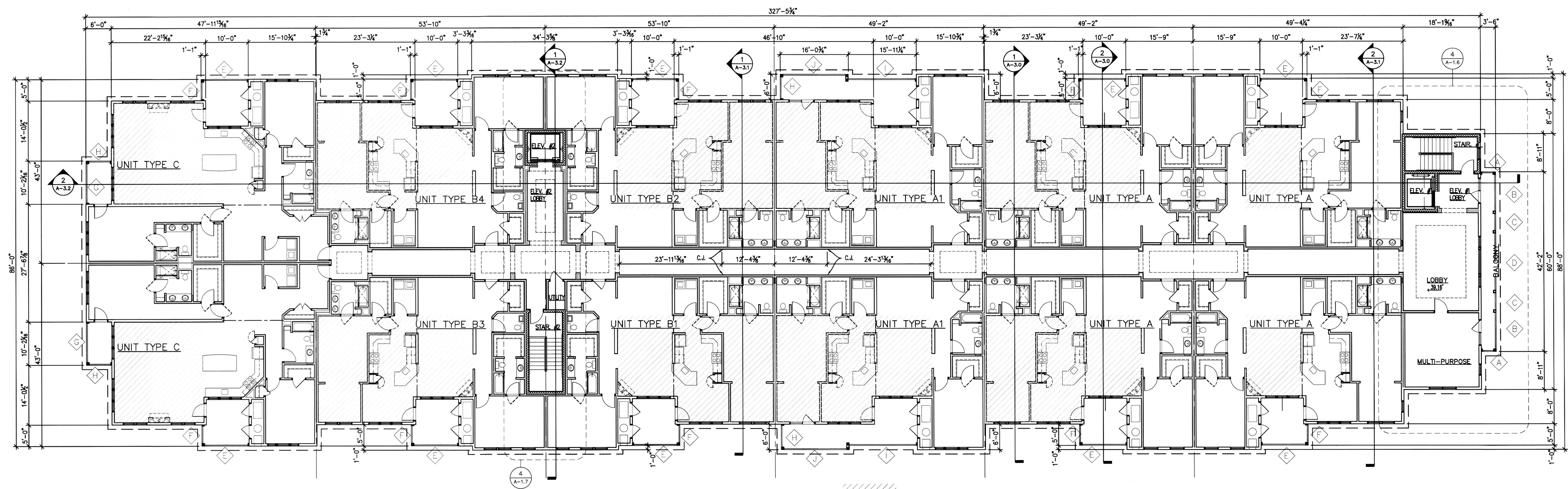

2 THIRD FLOOR PLAN
 A-1.2 3/32" = 1'-0"

/// DENOTES SLOPED CEILING
 ◊ -RAILING ELEVATION SEE SHEET 3.1